

NAVIGATIONAL AID COORDINATES (TAXIWAY LIGHTS)					
LIGHT No.	BASELINE	STATION	OFFSET	NORTHING	EASTING
T3-1*	TXY "C"	118+41.00	40.00' LT.	1151449.8856	832191.2396
T3-2	TXY "C"	118+41.00	35.00' LT.	1151454.2370	832193.7024
T3-3	TXY "C"	119+16.62	35.00' LT.	1151491.4825	832127.8957
T3-4	TXY "C"	120+32.39	35.00' LT.	1151548.5107	832027.1364
T3-5	TXY "C"	121+48.17	35.00' LT.	1151605.5389	831926.3771
T3-6	TXY "C"	121+99.22	35.00' LT.	1151641.6808	831878.4311
T3-7	TXY "C"	122+50.23	35.00' LT.	1151688.9563	831841.4992
T3-8	TXY "C"	123+01.24	35.00' LT.	1151744.1743	831818.0492
T3-9	TXY "C"	123+52.29	35.00' LT.	1151803.6296	831809.6759
T3-10	TXY "C"	124+18.57	35.00' LT.	1151869.9046	831809.0786
T3-11	TXY "C"	124+88.90	35.00' LT.	1151940.2330	831808.4447
T3-12	TXY "C"	125+09.00	40.00' LT.	1151960.2890	831803.2637
T3-13	TXY "C"	125+23.75	55.00' LT.	1151974.9032	831788.1314
T3-14	TXY "C"	125+29.25	75.00' LT.	1151980.2227	831768.0826
T3-15*	TXY "C"	125+88.00	75.00' LT.	1152038.9704	831767.5531
T3-16	TXY "C"	125+93.25	55.00' LT.	1152044.4004	831787.5050
T3-17	TXY "C"	126+08.00	40.00' LT.	1152059.2850	831802.3714
T3-18	TXY "C"	126+29.00	35.00' LT.	1152080.3292	831807.1819
T3-19	TXY "C"	123+33.50	35.00' LT.	1152284.8209	831805.3388
T3-20	TXY "C"	129+60.00	35.00' LT.	1152411.3158	831804.1987

NAVIGATIONAL AID COORDINATES (TAXIWAY LIGHTS)					
LIGHT No.	BASELINE	STATION	OFFSET	NORTHING	EASTING
T3-21	TXY "C"	130+10.00	35.00' LT.	1152461.3137	831803.7480
T3-22	TXY "C"	130+60.00	35.00' LT.	1152511.3117	831803.2974
T3-23	TXY "C"	131+10.00	35.00' LT.	1152561.3097	831802.8467
T3-24	TXY "C"	131+60.00	35.00' LT.	1152611.3076	831802.3961
T3-25	TXY "C"	132+10.00	35.00' LT.	1152661.3056	831801.9455
T3-26	TXY "C"	132+60.00	35.00' LT.	1152711.3036	831801.4948
T3-27*	TXY "C"	133+21.00	35.00' LT.	1152772.3011	831800.9450
T8-8	TXY "C"	129+60.00	91.00' RT.	1152412.4514	831930.1936
T8-9*	TXY "C"	128+33.50	74.00' RT.	1152285.8033	831914.3344
T3-51	TXY "C"	126+29.00	60.00' RT.	1152081.1854	831902.1781
T3-52	TXY "C"	125+59.09	60.00' RT.	1152011.2815	831902.8082
T3-53	TXY "C"	124+88.90	60.00' RT.	1151941.0893	831903.4408
T3-54	TXY "C"	123+52.29	60.00' RT.	1151804.4859	831904.6721
T3-55	TXY "C"	122+84.22	60.00' RT.	1151758.3884	831913.2294
T3-56	TXY "C"	122+16.24	60.00' RT.	1151718.0436	831936.9977
T3-57	TXY "C"	121+48.17	60.00' RT.	1151688.2152	831973.1706
T3-58	TXY "C"	120+32.40	60.00' RT.	1151631.1898	832073.9249
T3-59	TXY "C"	119+16.62	63.00' RT.	1151576.7697	832176.1669
T3-60	TXY "C"	118+80.62	72.50' RT.	1151567.3050	832212.1762
T3-61	TXY "C"	118+54.26	99.00' RT.	1151577.3864	832248.1643
T3-62	TXY "C"	118+44.62	135.00' RT.	1151603.9650	832274.2914

NAVIGATIONAL AID COORDINATES (GUIDANCE SIGNS)					
LIGHT No.	BASELINE	STATION	OFFSET	NORTHING	EASTING
TS3-1	TXY "C"	127+04.50	40.00' LT.	1152155.7811	831801.5017
TS3-5	TXY "C"	127+04.50	65.00' RT.	1152156.7274	831906.4974
TS3-6	TXY "C"	124+18.57	65.00' RT.	1151870.8075	831909.0745
TS3-7	TXY "C"	121+64.51	65.00' RT.	1151698.3219	831966.3905
TS3-9B	RWY 18-36	121+84.12	92.13' LT.	1151640.0660	832278.6284

NAVIGATIONAL AID COORDINATES (RUNWAY LIGHTS)					
LIGHT No.	BASELINE	STATION	OFFSET	NORTHING	EASTING
NS61*	RWY 18-36	121+84.12	87.13' LT.	1151640.1125	832283.6282

ELECTRICAL EQUIPMENT COORDINATES					
STRUCTURE	BASELINE	STATION	OFFSET	NORTHING	EASTING
SPLICE CAN	TXY "C"	118+38.75	49.00' LT.	1151440.9448	832188.7646
SPLICE CAN	TXY "C"	119+50.00	63.00' RT.	1151593.2135	832147.1134
MANHOLE	TXY "C"	120+39.44	55.00' RT.	1151630.3056	832065.3363
SPLICE CAN	TXY "C"	129+62.00	88.00' RT.	1152414.4243	831927.1757
SPLICE CAN	RWY 18-36	122+00.00	81.00' RT.	1151657.5607	832451.5985

LEGEND

- EXISTING PAVEMENT
- EXISTING LIGHTING CABLES
- ABANDONED ELECTRICAL CABLES
- EXISTING ELECTRICAL DUCT
- EXISTING STAKE MOUNTED TAXIWAY LIGHT
- EXISTING BASE MOUNTED TAXIWAY LIGHT
- EXISTING TAXIWAY GUIDANCE SIGN
- EXISTING BASE MOUNTED RUNWAY LIGHT
- EXISTING ELECTRICAL HANDHOLE
- PROPOSED PAVEMENT
- PROPOSED LIGHTING CABLES
- PROPOSED ELECTRICAL DUCT/DUCT EXTENSION
- PROPOSED STAKE MOUNTED TAXIWAY LIGHT
- PROPOSED BASE MOUNTED TAXIWAY LIGHT
- PROPOSED TAXIWAY GUIDANCE SIGN
- PROPOSED SPLICE CAN
- PROPOSED ELECTRICAL MANHOLE

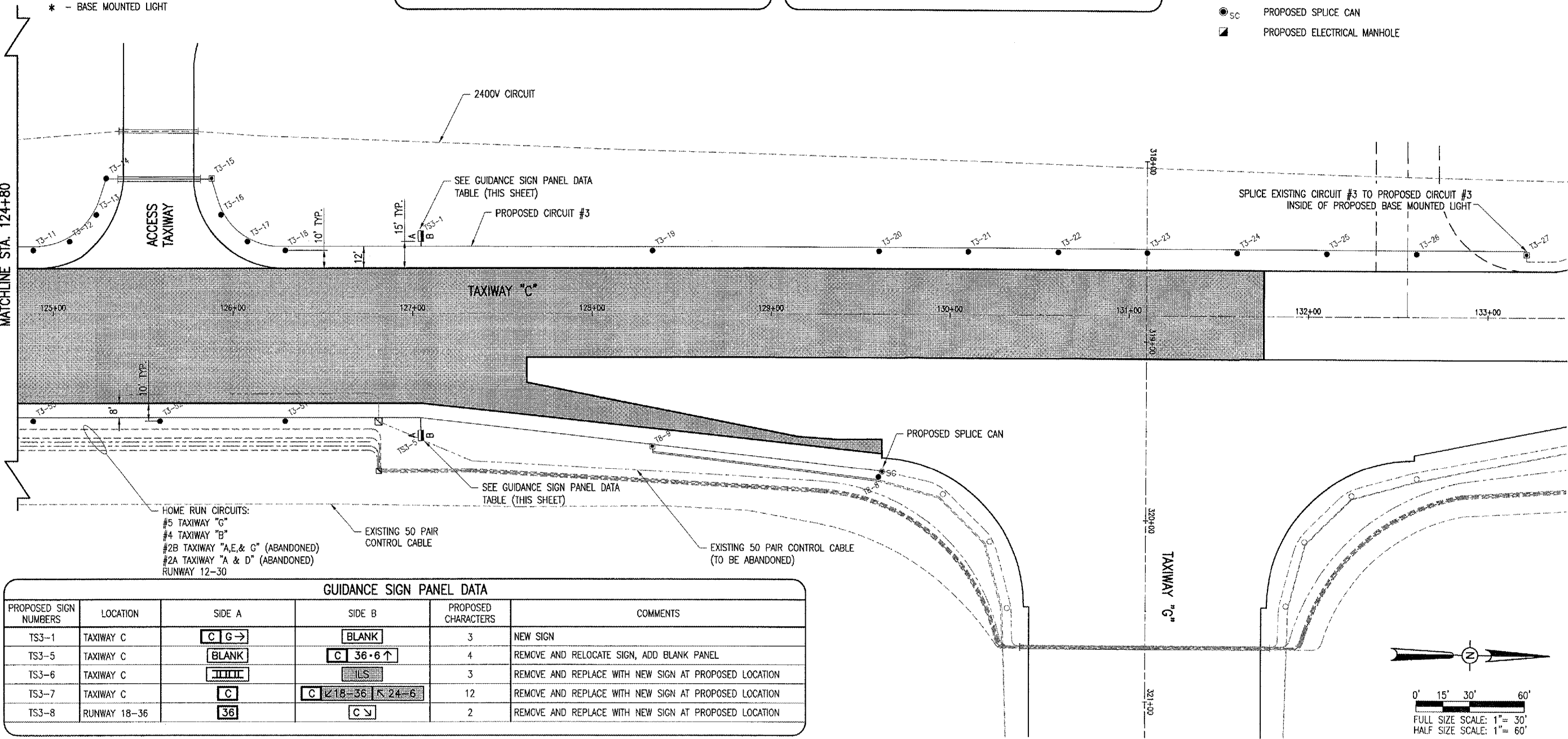

GUIDANCE SIGN PANEL DATA					
PROPOSED SIGN NUMBERS	LOCATION	SIDE A	SIDE B	PROPOSED CHARACTERS	COMMENTS
TS3-1	TAXIWAY C	C G →	BLANK	3	NEW SIGN
TS3-5	TAXIWAY C	BLANK	C 36 • 6 ↑	4	REMOVE AND RELOCATE SIGN, ADD BLANK PANEL
TS3-6	TAXIWAY C	IIIIII	ILS	3	REMOVE AND REPLACE WITH NEW SIGN AT PROPOSED LOCATION
TS3-7	TAXIWAY C	C	C 18-36 N 24-6	12	REMOVE AND REPLACE WITH NEW SIGN AT PROPOSED LOCATION
TS3-8	RUNWAY 18-36	36	C ↓	2	REMOVE AND REPLACE WITH NEW SIGN AT PROPOSED LOCATION

BY: _____

REVISION: _____

DATE: _____

HANSON
 Hanson Professional Services Inc.
 1525 South Sixth Street
 Springfield, Illinois 62703-2888
 Offices Nationwide

PROJECT: DECATUR AIRPORT
 ILL. PROJ.: DEC-3588 A.I.P. PROJ.: 3-17-00

FILE: 802-06TXD-0800
 DRAWING: R-142ELE.DWG
 SCALE: 1"=30'
 DATE: 02/24/06

LAYOUT: CCC 02/24/06
 DRAWN: CCC 02/24/06
 REVIEWED: WJM 03/31/06

TAXIWAY "C" RECONSTRUCTION

PROPOSED ELECTRICAL PLAN
 STA. 124+80 TO STA. 133+21

19
 19 of 56 sheets

APR 27, 2006 11:05 PM RAW
 I:\AIRPORTS\DECATUR\802-06TXD\AIRPORT\SHEETS\R-142ELE.DWG - Layout2