

I:\AIRPORTS\KEWANEE\810-06TXD\AIRPORT_SHEETS-SPLIT\R-152MRK.DWG - STA. 12+00 TO STA. 20+00

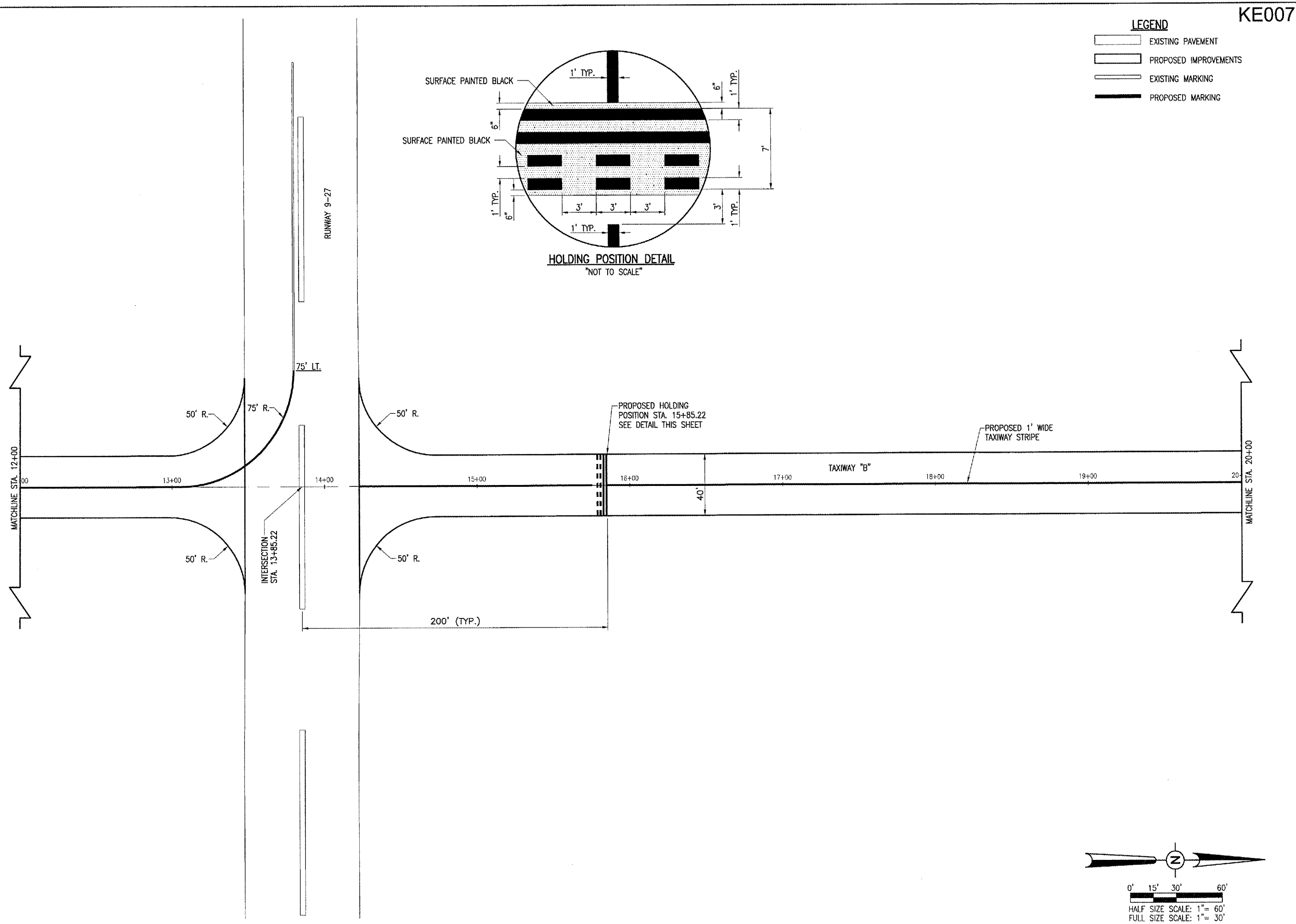

LEGEND

- EXISTING PAVEMENT
- PROPOSED IMPROVEMENTS
- EXISTING MARKING
- PROPOSED MARKING

KE007

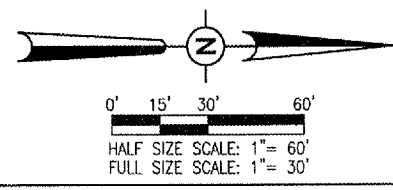

REVISION	DATE	BY

KEWANEE MUNICIPAL AIRPORT
KEWANEE, HENRY COUNTY, ILLINOIS

IL PROJ.: E2I-3533 A.I.P. PROJ.: 3-17-0058-810

Project No.	810-06TXD.0800
File Name	R-152MRK.DWG
Scale	1"=30'
Date	08/30/05
LAYOUT	R.A.W. 08/30/05
DRAWN	B.A.K. 08/30/05
REVIEWED	C.A.H. 04/27/06

HANSON

Hanson Professional Services, Inc.
 3125 Dandy Trail, Suite 100
 Indianapolis, Indiana 46214
 Offices Nationwide

OVERLAY TAXIWAYS AND APRON
PROPOSED MARKING PLAN
 STA. 12+00 TO STA. 20+00