

THE LOCATION, SIZE AND TYPE OF MATERIAL OF EXISTING UNDERGROUND UTILITIES INDICATED ON THE PLANS IS NOT REPRESENTED AS BEING ACCURATE, SUFFICIENT OR COMPLETE. IT SHALL BE THE CONTRACTOR'S RESPONSIBILITY TO DETERMINE THE ACTUAL LOCATION OF ALL SUCH FACILITIES, INCLUDING SERVICE CONNECTIONS TO UNDERGROUND UTILITIES. PRIOR TO CONSTRUCTION, THE CONTRACTOR SHALL NOTIFY THE UTILITY COMPANIES OF HIS OPERATIONAL PLANS AND SHALL OBTAIN FROM THE RESPECTIVE UTILITY COMPANIES DETAILED INFORMATION AND ASSISTANCE RELATIVE TO THE LOCATION OF THEIR FACILITIES AND THE WORKING SCHEDULE OF THE COMPANIES FOR REMOVAL OR ADJUSTMENT WHERE REQUIRED. IN THE EVENT AN UNEXPECTED UTILITY INTERFERENCE IS ENCOUNTERED DURING CONSTRUCTION, THE CONTRACTOR SHALL IMMEDIATELY NOTIFY THE UTILITY COMPANY OF JURISDICTION. THE ENGINEER SHALL ALSO BE IMMEDIATELY NOTIFIED. ANY SUCH MAINS AND SERVICES SHALL BE RESTORED TO SERVICE AT ONCE AND PAID FOR BY THE CONTRACTOR AT NO ADDITIONAL COST TO THE CONTRACT.

CALL J.U.L.I.E. FOR UTILITY INFORMATION AT 1-800-892-0123.

- LEGEND**
- EXISTING PAVEMENT
 - EXISTING BUILDINGS
 - EXISTING ELECTRICAL CABLES
 - EXISTING ELECTRICAL DUCT
 - PROPOSED IMPROVEMENTS
 - PROPOSED 1/C NO. 8, 5KV, U.G. CABLE IN U.D.
 - EXISTING ELECTRICAL TRANSFORMER
 - EXISTING ELECTRICAL PEDESTAL
 - EXISTING DUCT MARKERS
 - EXISTING CABLE MARKERS
 - EXISTING ROTATING BEACON
 - EXISTING ELECTRICAL HANDHOLE
 - EXISTING STAKE MOUNTED TAXIWAY LIGHT
 - EXISTING BASE MOUNTED TAXIWAY LIGHT
 - EXISTING WIND CONE
 - EXISTING WIND TEE
 - PROPOSED STAKE MOUNTED TAXIWAY LIGHT
 - PROPOSED BASE MOUNTED TAXIWAY LIGHT

NOTE
 ABANDONMENT AND/OR REMOVAL OF EXISTING RUNWAY OR TAXIWAY LIGHTING CABLES SHALL BE INCIDENTAL TO ITEM AR108158 1/C NO. 8, 5KV, U.G. CABLE IN U.D.

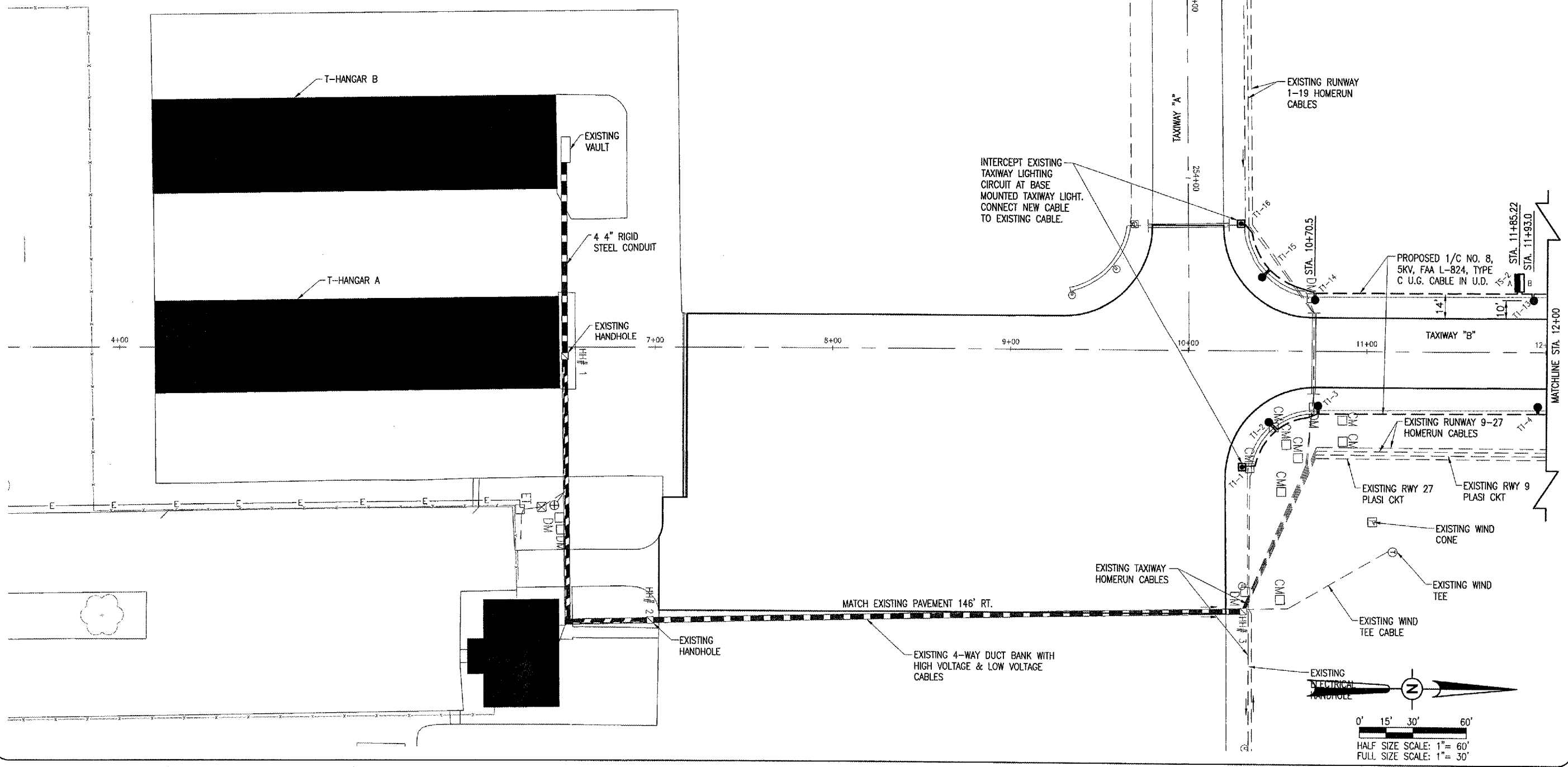

DATE	REVISION	BY

Kewanee Municipal Airport
Kewanee, Henry County, Illinois

IL PROJ.: E7I-3533 A.I.P. PROJ.: 3-17-0058-B10

HE Project No. 810-08TXD 0800	Drawn 08/02/05	Reviewed 04/27/06
Plan No. R-142ELE.DWG	R.A.W.	B.A.K.
Scale 1"=30'	08/02/05	08/02/05
Date 08/02/05	C.A.H.	04/27/06

HANSON
 Hanson Professional Services Inc.
 3126 Dandy Trail, Suite 100
 Indianapolis, Indiana 46214
 Offices Nationwide

OVERLAY TAXIWAYS AND APRON
PROPOSED ELECTRICAL PLAN
 STA. 4+00 TO STA. 12+00

