

STATE OF ILLINOIS
DEPARTMENT OF TRANSPORTATION

F.A.P. RTE.	SECTION	COUNTY	TOTAL SHEETS	SHEET NO.
302	34-2DR	HANCOCK	5	1
		ILLINOIS	CONTRACT NO. 72707	

FOR INDEX OF SHEETS, SEE SHEET NO. 2

**PROPOSED
HIGHWAY PLANS**

**FAP ROUTE 302 (IL 94, 110, 336)
SECTION 34-2DR**

**DRAINAGE
HANCOCK COUNTY**

C-96-070-23

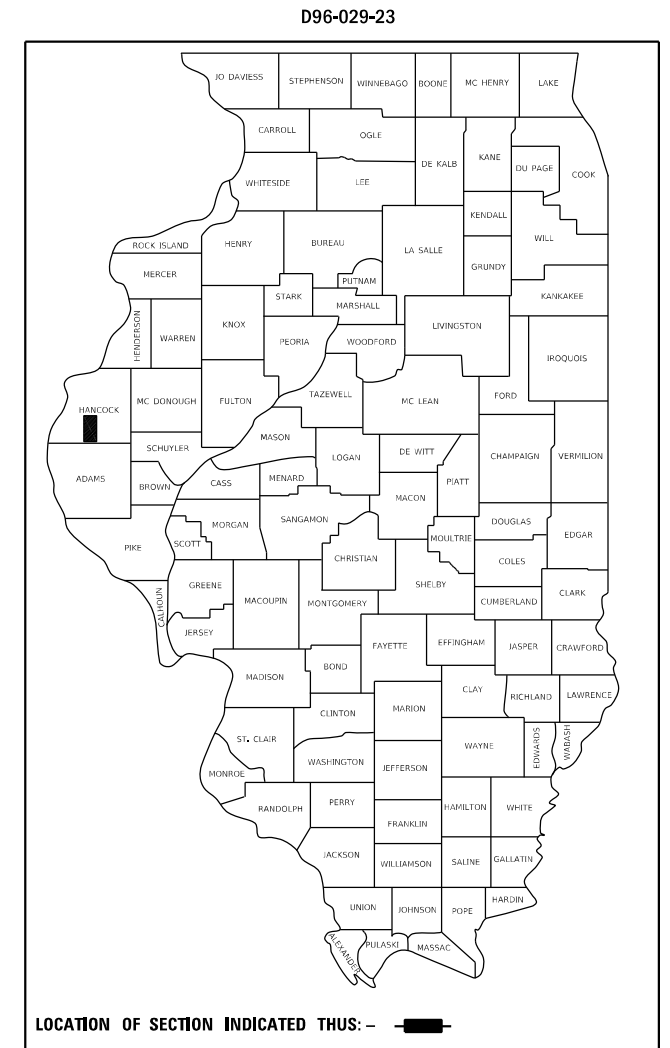

ADT = 1,550
SU = 80
MU = 200

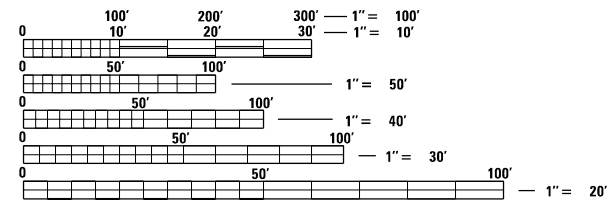

FULL SIZE PLANS HAVE BEEN PREPARED USING STANDARD ENGINEERING SCALES. REDUCED SIZED PLANS WILL NOT CONFORM TO STANDARD SCALES. IN MAKING MEASUREMENTS ON REDUCED PLANS, THE ABOVE SCALES MAY BE USED.

J.U.L.I.E.
JOINT UTILITY LOCATION INFORMATION FOR EXCAVATORS
1-800-892-0123
OR 811

PROJECT ENGINEER: MIKE HAMBY (217)524-7765
PROJECT MANAGER TIM SHARP (217)524-9160

CONTRACT NO. 72707

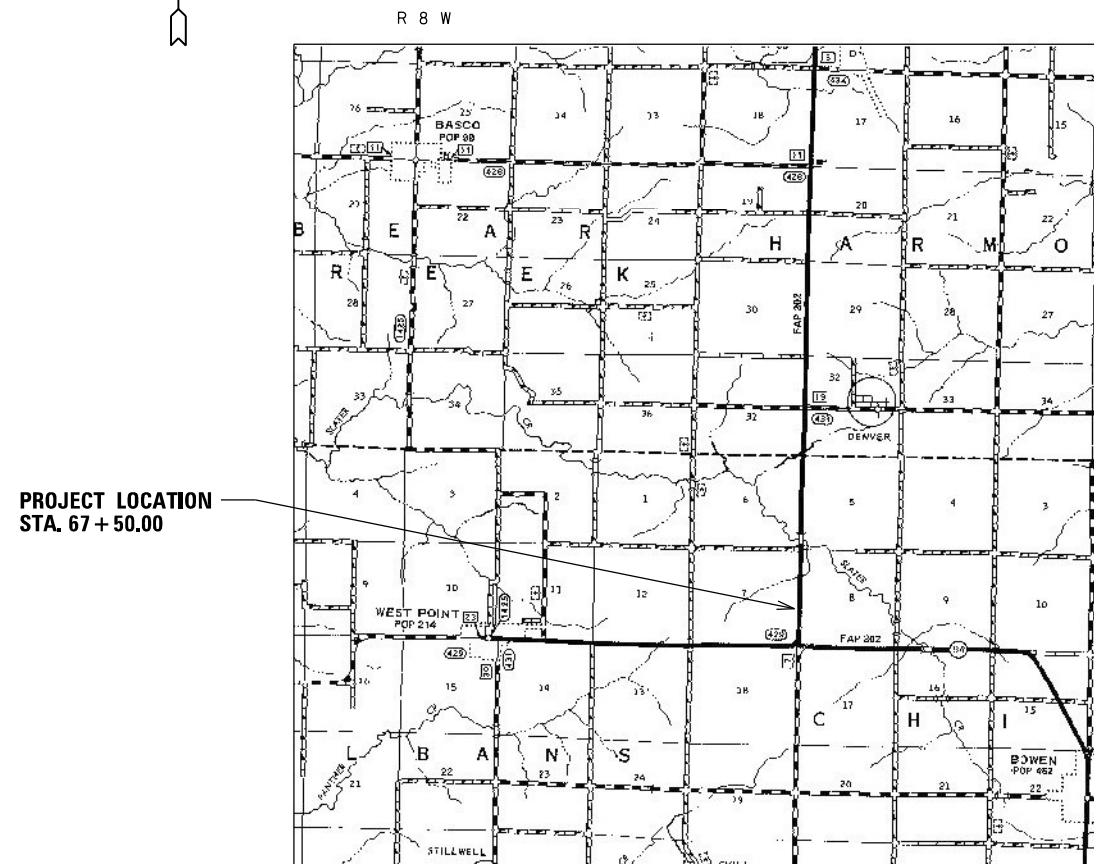

STATE OF ILLINOIS
DEPARTMENT OF TRANSPORTATION

SUBMITTED March 27 20 23

[Signature] REGIONAL ENGINEER

May 12, 2023 *[Signature]*
ENGINEER OF DESIGN AND ENVIRONMENT

May 12, 2023 *[Signature]*
DIRECTOR OF HIGHWAYS PROJECT IMPLEMENTATION



**PRINTED BY THE AUTHORITY
OF THE STATE OF ILLINOIS**

INDEX OF SHEETS

SHEET NO.	DESCRIPTION
1.	COVER SHEET
2.	INDEX OF SHEETS, STANDARDS, GENERAL NOTES & SIGNATURE
3.	SUMMARY OF QUANTITIES
4.	LOCATION MAP
5.	PLAN

STANDARDS

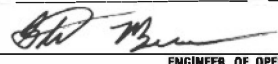
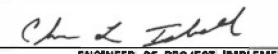
STANDARD NO.	DESCRIPTION
000001-08	STANDARD SYMBOLS, ABBREVIATIONS AND PATTERNS
001006	DECIMAL OF AN INCH AND OF A FOOT
701101-05	OFF-RD OPERATIONS, MULTILANE, 15'(4.5m) TO 24'(600mm) FROM PAVEMENT EDGE
701106-02	OFF-RD OPERATIONS, MULTILANE, MORE THAN 15'(4.5m) AWAY
701901-08	TRAFFIC CONTROL DEVICES

STATE OF ILLINOIS DEPARTMENT OF TRANSPORTATION DIVISION OF HIGHWAYS DISTRICT 6	
EXAMINED	March 31 20 23
 ENGINEER OF OPERATIONS	
EXAMINED	March 31 20 23
 ENGINEER OF PROJECT IMPLEMENTATION	
EXAMINED	March 31 20 23
 ENGINEER OF PROGRAM DEVELOPMENT	

REV. - MS

				0-02177-6026
				CONSTR. CODE
				100 STATE
				Hancock
CODE NO.	ITEM	UNIT	TOTAL QUANTITY	PIPE CULVERT
				0044
				RURAL
67100100	MOBILIZATION	L SUM	1	1
X5430454	SPRAY-APPLIED PIPE LINER 54"	FOOT	151	151

MODEL: D:\d\h\h\CONTRACT\MANT_CAD\72707 - FAP 302 (IL 94, 110, 336) - drainage - Hancock Co. (6-16-2023)\j\jans72707-ct-3500.dwg
 FILE NAME: S:\CONTRACT\MANT_CAD\72707 - FAP 302 (IL 94, 110, 336) - drainage - Hancock Co. (6-16-2023)\j\jans72707-ct-3500.dwg

USER NAME = Timothy.Sharp	DESIGNED - _____	REVISED - _____
	DRAWN - _____	REVISED - _____
PLOT SCALE = 2.0000' / in.	CHECKED - _____	REVISED - _____
PLOT DATE = 3/24/2023	DATE - _____	REVISED - _____

**STATE OF ILLINOIS
DEPARTMENT OF TRANSPORTATION**

SUMMARY OF QUANTITIES

SCALE: _____ SHEET ___ OF ___ SHEETS STA. _____ TO STA. _____

F.A.P. RTE.	SECTION	COUNTY	TOTAL SHEETS	SHEET NO.
302	34-ZDR	HANCOCK	5	3
			CONTRACT NO. 72707	
			ILLINOIS FED. AID PROJECT	

LOCATION OF PROJECT
 STA. 67+50.000
 9+700.600 LT



FILE NAME =	USER NAME = Timothy.Sharp	DESIGNED - _____	REVISED - _____
S:\CONTRMINT_CAD\72707 - FAP 302 (IL 94-110, 336) - drainage - Hancock Co.(6-16-2023)	DRAWN 2707-shr-4-location_map.dgn	CHECKED - _____	REVISED - _____
Default	PLOT SCALE = 60.0000' / in.	DATE - _____	REVISED - _____
	PLOT DATE = 3/24/2023		

**STATE OF ILLINOIS
 DEPARTMENT OF TRANSPORTATION**

LOCATION MAP

SCALE: _____ SHEET ____ OF ____ SHEETS STA. _____ TO STA. _____

F.A.P. RTE.	SECTION	COUNTY	TOTAL SHEETS	SHEET NO.
302	34-2DR	HANCOCK	5	4
CONTRACT NO. 72707				
ILLINOIS FED. AID PROJECT				

LOCATION OF PROJECT
 STA. 67+50.000
 9+700.600 LT



FILE NAME =	USER NAME = Timothy.Sharp	DESIGNED - _____	REVISED - _____
S:\CONTRMAINT_CAD\72707 - FAP 302 (IL 94, 110, 336) - drainage - Hancock Co.(6-16-2023)	DRAWN 2707-shr-5-plan.dgn	CHECKED - _____	REVISED - _____
Default	PLOT SCALE = 60.0000' / in.	DATE - _____	REVISED - _____
	PLOT DATE = 3/24/2023		

**STATE OF ILLINOIS
 DEPARTMENT OF TRANSPORTATION**

**LOCATION MAP
 PLAN**

SCALE: _____ SHEET ____ OF ____ SHEETS STA. _____ TO STA. _____

F.A.P. RTE.	SECTION	COUNTY	TOTAL SHEETS	SHEET NO.
302	34-2DR	HANCOCK	5	5
ILLINOIS FED. AID PROJECT			CONTRACT NO. 72707	