

STATE OF ILLINOIS
DEPARTMENT OF TRANSPORTATION

F.A.P. BTE.	SECTION	COUNTY	TOTAL SHEETS	SHEET NO.
95	16.71RS-2	EFFINGHAM	46	1
		ILLINOIS	CONTRACT NO. 74A88	

FOR INDEX OF SHEETS, SEE SHEET NO. 2

PROPOSED HIGHWAY PLANS

FAP ROUTE 95 (ILL 33)
SECTION (6,7)RS-2
PROJECT STP-ZBLE(375)
SMART OVERLAY
EFFINGHAM COUNTY

C-97-015-22

STATION EQUATIONS:

- 209 + 78.77 BK = 209 + 67.66 AH
- 314 + 45.17 BK = 314 + 13.07 AH
- 355 + 20.31 BK = 357 + 15.38 AH
- 412 + 78.37 BK = 412 + 74.63 AH
- 531 + 41.06 BK = 531 + 33.78 AH

BRIDGE OMISSION:

- STA 145 + 44 TO STA 147 + 81
- STA 422 + 94 TO STA 424 + 46
- STA 531 + 30 TO STA 532 + 43

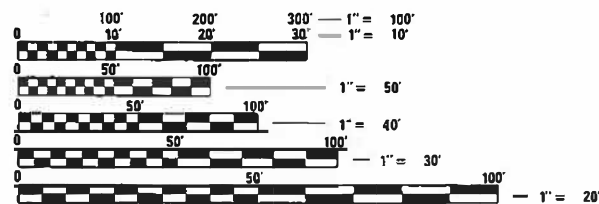

FULL SIZE PLANS HAVE BEEN PREPARED USING STANDARD ENGINEERING SCALES. REDUCED SIZED PLANS WILL NOT CONFORM TO STANDARD SCALES. IN MAKING MEASUREMENTS ON REDUCED PLANS, THE ABOVE SCALES MAY BE USED.

J.U.L.I.E.
JOINT UTILITY LOCATION INFORMATION FOR EXCAVATORS
1-800-892-0123
OR 811

PROJECT ENGINEER BRANDON HEMMEN
PROJECT MANAGER MATT BOWER

CONTRACT NO. 74A88

PROJECT BEGINS
STA 142 + 00

BRIDGE OMISSION
STR# 025-0101

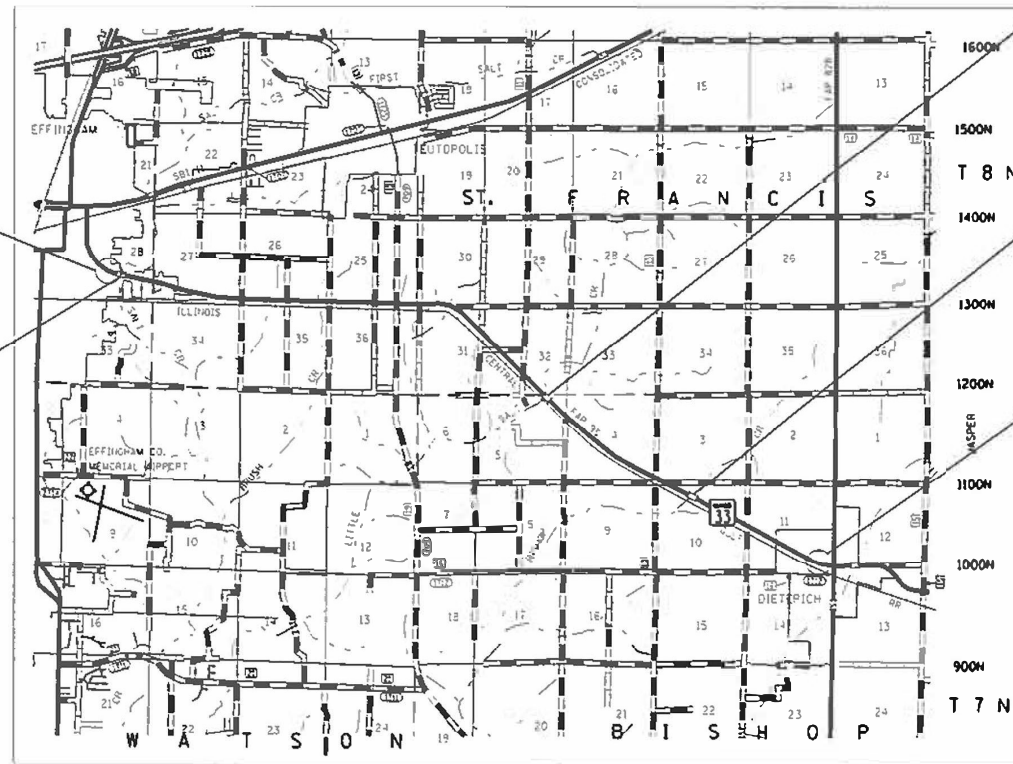

BRIDGE OMISSION
STR# 025-0082

BRIDGE OMISSION
STR# 025-0097

PROJECT ENDS
STA 621 + 71

GROSS LENGTH = 47784 FT. = 9.05 MILE
NET LENGTH = 47282 FT. = 8.96 MILE

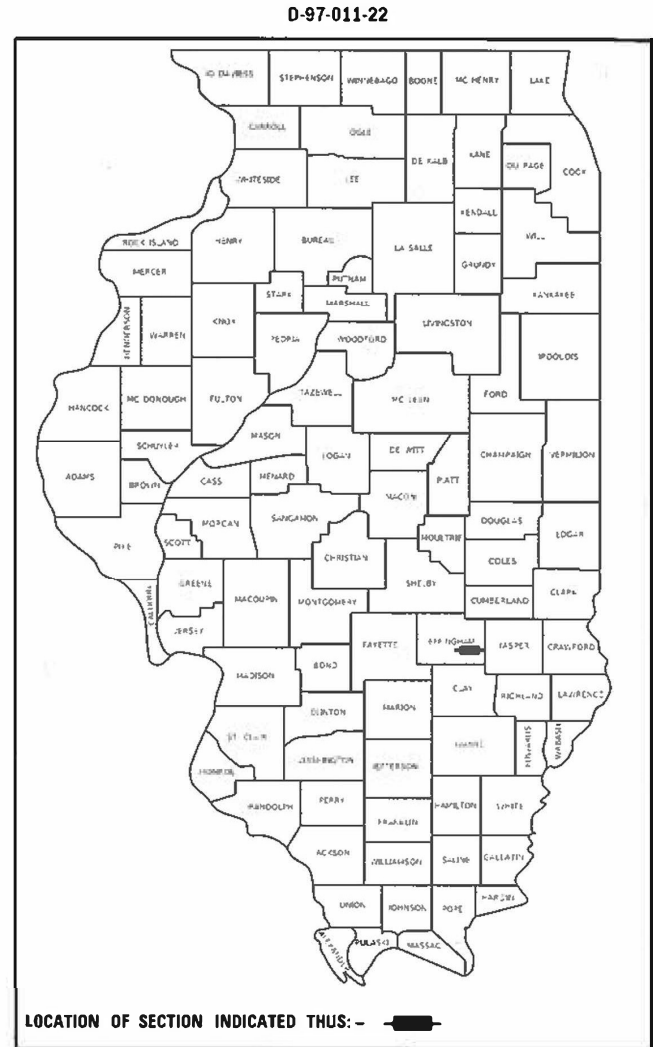

STATE OF ILLINOIS
DEPARTMENT OF TRANSPORTATION

SUBMITTED MARCH 29 2023
Jeffrey P. M... Regional Engineer
May 12, 2023
... Engineer of Design and Environment
May 12, 2023
... Director of Highways Project Implementation

PRINTED BY THE AUTHORITY
OF THE STATE OF ILLINOIS

INDEX OF SHEETS

SHEET NO.	ITEM
1	COVER SHEET
2	INDEX OF SHEETS & GENERAL NOTES
3-4	SUMMARY OF QUANTITIES
5 - 6	TYPICAL SECTIONS
7 - 9	SCHEDULE OF QUANTITIES
10 - 40	PLAN SHEETS
41 - 46	DISTRICT DETAILS

THE FOLLOWING STANDARDS ARE A PART OF THESE PLANS AND ARE INCLUDED AFTER SHEET NO. 39

STD. NO.	DESCRIPTION
000001-08	STANDARD SYMBOLS, ABBREVIATIONS AND PATTERNS
001006	DECIMAL OF AN INCH & OF A FOOT
442201-03	CLASS C AND D PATCHES
642006-01	SHOULDER RUMBLE STRIPS, 8 IN.
667101-02	PERMANENT SURVEY MARKERS
701001-02	OFF-RD OPERATIONS, 2L, 2W, MORE THAN 15' FROM PAVEMENT EDGE
701006-05	OFF-RD OPERATIONS, 2L, 2W, 15' TO 24" FROM PAVEMENT EDGE
701011-04	OFF-RD MOVING OPERATIONS, 2L,2W, DAY ONLY
701201-05	LANE CLOSURE, 2L, 2W, DAY ONLY, FOR SPEEDS ≥ 45 MPH
701301-04	LANE CLOSURE, 2L, 2W, SHORT TIME OPERATIONS
701306-04	LANE CLOSURE, 2L, 2W, SLOW MOVING OPERATIONS DAY ONLY, FOR SPEEDS ≥ 45 MPH
701311-03	LANE CLOSURE 2L, 2W, MOVING OPERATIONS - DAY ONLY
701501-06	URBAN LANE CLOSURE, 2L, 2W, UNDIVIDED
701901-08	TRAFFIC CONTROL DEVICES
780001-05	TYPICAL PAVEMENT MARKINGS
781001-04	TYPICAL APPLICATIONS RAISED REFLECTIVE PAVEMENT MARKERS

GENERAL NOTES

THIS PROJECT IS LOCATED ON FAP ROUTE 95 (ILL 33) IN EFFINGHAM COUNTY, FROM BIG SALT CREEK TO WEST OF PINE ST. IN DIETERICH. THE WORK CONSISTS OF PAVEMENT PATCHING, MILLING, HOT-MIX ASPHALT RESURFACING, HOT-MIX ASPHALT SHOULDERS, AGGREGATE WEDGE SHOULDERS, PAVEMENT MARKING, RUMBLE STRIPS, AND ANY OTHER WORK NECESSARY TO COMPLETE THIS SECTION.

ADDITIONAL ONE-WAY CRYSTAL RAISED REFLECTIVE PAVEMENT MARKERS WILL BE PLACED AT 40 FOOT CENTERS ALONG THE 6 INCH EDGLINES OF THE TURN LANES. ADDITIONAL ONE-WAY AMBER RAISED REFLECTIVE PAVEMENT MARKERS WILL BE PLACED AT 40 FOOT CENTERS ALONG EACH SIDE OF THE GORE AREAS. LOCATED AT 1775TH RD, 2100TH ST, AND 1100TH AVE.

LONGITUDINAL JOINT SEALANT SHALL BE PLACED ON THE MILLED SURFACE.

THE MATERIAL USED FOR AGGREGATE WEDGE SHOULDERS, TYPE B SHALL BE CRUSHED STONE, CRUSHED CONCRETE, OR RAP.

WHEN APPLYING SHORT TERM PAVEMENT MARKINGS, TEMPORARY TAPE SHALL BE USED ON THE SURFACE COURSE, AND PAINT SHALL BE USED ON MILLED SURFACES.

THE FOLLOWING RATES OF APPLICATION HAVE BEEN USED IN CALCULATING PLAN QUANTITIES:

HOT MIX ASPHALT	112 LBS/SQ YD/IN
AGGREGATE WEDGE SHOULDERS	2.05 TONS/CU YD

THE FOLLOWING MIXTURE REQUIREMENTS ARE APPLICABLE TO THIS PROJECT:

MIXTURE USE(S)	PG	DESIGN AIR VOIDS	MIXTURE COMPOSITION	FRICTION AGGREGATE	MIXTURE WEIGHT	QUALITY MANAGEMENT PROGRAM	SUBLOT SIZE
POLYMERIZED HMA SURFACE COURSE, IL-9.5, MIX "D", N90 (1 1/2")	SBS PG 70-22	4.0% @ N=90	IL - 9.5	MIXTURE D	N90	PFP	1000
CLASS "D" PAVEMENT PATCHING - HMA BINDER COURSE, IL-19.0, N90	PG 64-22	4.0% @ N=90	IL - 19.0	N/A	N90	QC/QA	3000

MODEL: Default
 FILE: \\blmfc-pw-beadley.com\FW\DOT\Documents\DOT Office\District 7\Project\74A88\CADD\DATA\CAD\Sheet\DOT74A88-std-standards.dgn

USER NAME = Jessica.Hille	DESIGNED -	REVISED -
	DRAWN -	REVISED -
PLOT SCALE = 100,0000 ' / in.	CHECKED -	REVISED -
PLOT DATE = 3/29/2023	DATE -	REVISED -

**STATE OF ILLINOIS
DEPARTMENT OF TRANSPORTATION**

**INDEX OF SHEETS, STANDARDS,
AND GENERAL NOTES**

SCALE: SHEET OF SHEETS STA. TO STA.

F.A.P. RTE.	SECTION	COUNTY	TOTAL SHEETS	SHEET NO.
95	(6,7)RS-2	EFFINGHAM	46	2
CONTRACT NO. 74A88				
ILLINOIS FED. AID PROJECT				

80% FED
20% STATE

80% FED
20% STATE

SUMMARY OF QUANTITIES			TOTAL QUANTITIES	CONSTRUCTION TYPE CODE		
CODE NO	ITEM	UNIT		RURAL 0005	URBAN 0005	
40600290	BITUMINOUS MATERIALS (TACK COAT)	POUND	108807	101139	7668	
40600370	LONGITUDINAL JOINT SEALANT	FOOT	49545	46137	3408	
40600990	TEMPORARY RAMP	SO YD	94	27	67	
40604164	POLYMERIZED HOT-MIX ASPHALT SURFACE COURSE, IL-9.5, MIX "D", N90	TON	13541	12587	954	
44000155	HOT-MIX ASPHALT SURFACE REMOVAL, 1 1/2"	SO YD	161195	149835	11360	
44201803	CLASS D PATCHES, TYPE II, 13 INCH	SO YD	571.8	529.3	42.5	
44201807	CLASS D PATCHES, TYPE III, 13 INCH	SO YD	16		16	
44201809	CLASS D PATCHES, TYPE IV, 13 INCH	SO YD	76.6		76.6	
48102100	AGGREGATE WEDGE SHOULDER, TYPE B	TON	1823	1738	85	
64200108	SHOULDER RUMBLE STRIPS, 8 INCH	FOOT	86369	80746	5623	
67000400	ENGINEER'S FIELD OFFICE, TYPE A	CAL MO	4	3	1	
67100100	MOBILIZATION	L SUM	1	0.9	0.1	
70100450	TRAFFIC CONTROL AND PROTECTION, STANDARD 701201	L SUM	1	0.9	0.1	

SUMMARY OF QUANTITIES			TOTAL QUANTITIES	CONSTRUCTION TYPE CODE		
CODE NO	ITEM	UNIT		RURAL 0005	URBAN 0005	
70100460	TRAFFIC CONTROL AND PROTECTION, STANDARD 701306	L SUM	1	0.9	0.1	
70102620	TRAFFIC CONTROL AND PROTECTION, STANDARD 701501	L SUM	1	0.9	0.1	
70107025	CHANGEABLE MESSAGE SIGN	CAL DA	28	14	14	
70300100	SHORT TERM PAVEMENT MARKING	FOOT	5275	4934	341	
70300150	SHORT TERM PAVEMENT MARKING REMOVAL	SO FT	1742	1629	113	
* 78000100	THERMOPLASTIC PAVEMENT MARKING - LETTERS AND SYMBOLS	SO FT	312	312		
* 78000200	THERMOPLASTIC PAVEMENT MARKING - LINE 4"	FOOT	26943	26943		
* 78000400	THERMOPLASTIC PAVEMENT MARKING - LINE 6"	FOOT	1062	1062		
* 78000600	THERMOPLASTIC PAVEMENT MARKING - LINE 12"	FOOT	578	578		
* 78001110	PAINT PAVEMENT MARKING - LINE 4"	FOOT	102847	90421	12426	
* 78011000	GROOVING FOR RECESSED PAVEMENT MARKING, LETTERS AND SYMBOLS	SO FT	312	312		
* 78011025	GROOVING FOR RECESSED PAVEMENT MARKING 5"	FOOT	26943	26943		

* SPECIALTY ITEM

REV. - MS

MODEL: Default
 FILE: M:\MS\p\bludct-cw-bentley.com\PROJECTS\DOT\Office\Dir\ct: 7\Project\74A88\CADD\DATA\CAD\Sheet\74A88-14-S00.dgn

USER NAME = Jessica.Hille	DESIGNED -	REVISED -
PLOT SCALE = 100.0000' / in.	DRAWN -	REVISED -
PLOT DATE = 3/29/2023	CHECKED -	REVISED -
	DATE -	REVISED -

STATE OF ILLINOIS
DEPARTMENT OF TRANSPORTATION

SUMMARY OF QUANTITIES

SCALE: SHEET OF SHEETS STA. TO STA.

F.A.P. RTE.	SECTION	COUNTY	TOTAL SHEETS	SHEET NO.
95	(6,7)RS-2	EFFINGHAM	46	3
CONTRACT NO. 74A88			ILLINOIS FED. AID PROJECT	

80% FED
20% STATE

SUMMARY OF QUANTITIES			TOTAL QUANTITIES	CONSTRUCTION TYPE CODE		
CODE NO	ITEM	UNIT		RURAL 0005	URBAN 0005	
* 78011035	GROOVING FOR RECESSED PAVEMENT MARKING 7"	FOOT	1062	1062		
* 78011065	GROOVING FOR RECESSED PAVEMENT MARKING 13"	FOOT	578	578		
* 78100100	RAISED REFLECTIVE PAVEMENT MARKER	EACH	799	756	43	
78300200	RAISED REFLECTIVE PAVEMENT MARKER REMOVAL	EACH	337	314	23	
Z0048665	RAILROAD PROTECTIVE LIABILITY INSURANCE	L SUM	1	1		
Z0049799	PROTECTING OR RESETTING SURVEY MARKERS	EACH	28	2	26	
Z0070202	SURVEY MARKER VAULT	EACH	1	1		

* SPECIALTY ITEM

MODEL: Default
FILE NAME: p:\bullet-paw-bee-fwy.com\FW\DOT\Documents\DOT Office\Director_T\Projects\74A88\CADD\data\CAD\SheetID74A88-sht-500.dgn

USER NAME = Jessica.Hille	DESIGNED -	REVISED -
PLOT SCALE = 100,0000' / in.	DRAWN -	REVISED -
PLOT DATE = 3/29/2023	CHECKED -	REVISED -
	DATE -	REVISED -

STATE OF ILLINOIS
DEPARTMENT OF TRANSPORTATION

SUMMARY OF QUANTITIES				
SCALE:	SHEET	OF	SHEETS	STA. TO STA.

F.A.P. RTE.	SECTION	COUNTY	TOTAL SHEETS	SHEET NO.
95	(6.7)RS-2	EFFINGHAM	46	4
CONTRACT NO. 74A88				
ILLINOIS FED. AID PROJECT				

PROPOSED TYPICAL CROSS SECTION

STA 147+81 TO STA 178+45
 STA 178+45 TO STA 209+79
 STA 209+68 TO STA 305+16
 STA 323+82 TO STA 355+20
 STA 357+15 TO STA 412+78
 STA 412+75 TO STA 422+94
 STA 424+94 TO STA 502+08
 STA 520+87 TO STA 531+30
 STA 532+37 TO STA 604+91

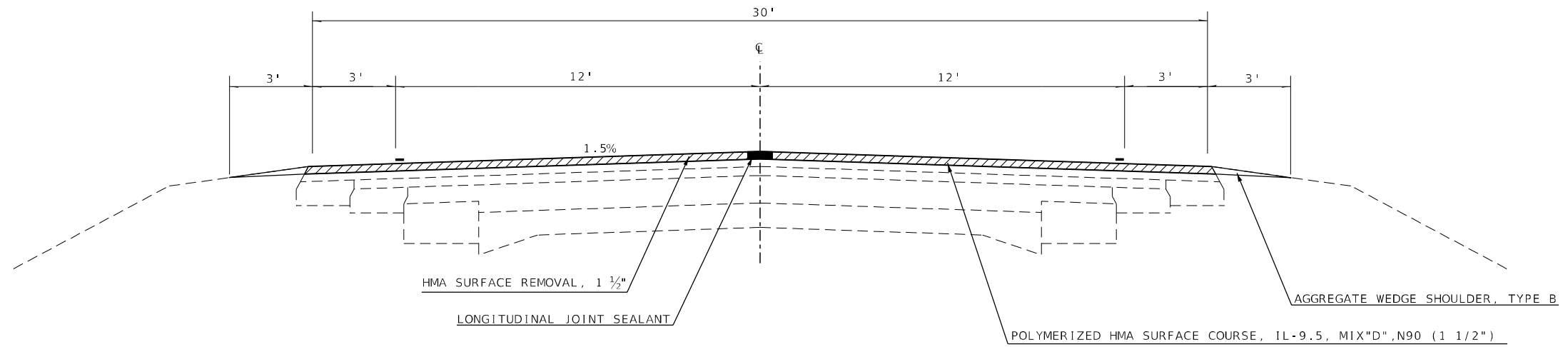

PROPOSED TYPICAL CROSS SECTION

STA 305+16 TO STA 310+76
 STA 310+76 TO STA 314+45
 STA 314+13 TO STA 314+88
 STA 314+88 TO STA 317+55
 STA 317+55 TO STA 320+20
 STA 320+20 TO STA 323+82
 STA 502+08 TO STA 506+88
 STA 506+88 TO STA 516+07
 STA 516+07 TO STA 520+87

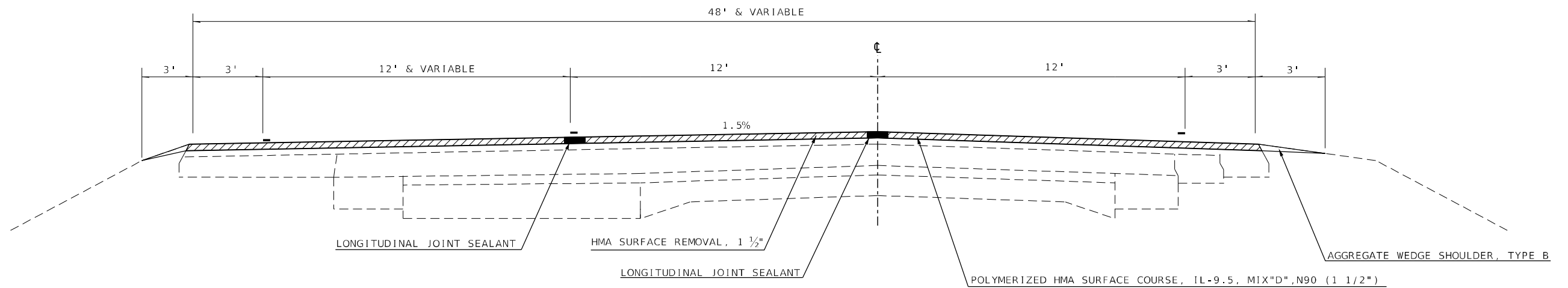

MODEL: Default
 FILE: \\naulc-pw-bentley.com\P\DOT\Documents\DOT_offices\Director_7\Project\74A88\CADD\DATA\CAD\Sheet\74A88-5-1-2.dgn

USER NAME = Jessica.Hille	DESIGNED -	REVISED -
	DRAWN -	REVISED -
PLOT SCALE = 100,0000' / in.	CHECKED -	REVISED -
PLOT DATE = 3/29/2023	DATE -	REVISED -

**STATE OF ILLINOIS
 DEPARTMENT OF TRANSPORTATION**

TYPICAL CROSS SECTIONS

SCALE: SHEET OF SHEETS STA. TO STA.

F.A.P. RTE.	SECTION	COUNTY	TOTAL SHEETS	SHEET NO.
95	(6,7)RS-2	EFFINGHAM	46	5
CONTRACT NO. 74A88				
ILLINOIS FED. AID PROJECT				

PROPOSED TYPICAL CROSS SECTION

STA 142+00 TO STA 145+44

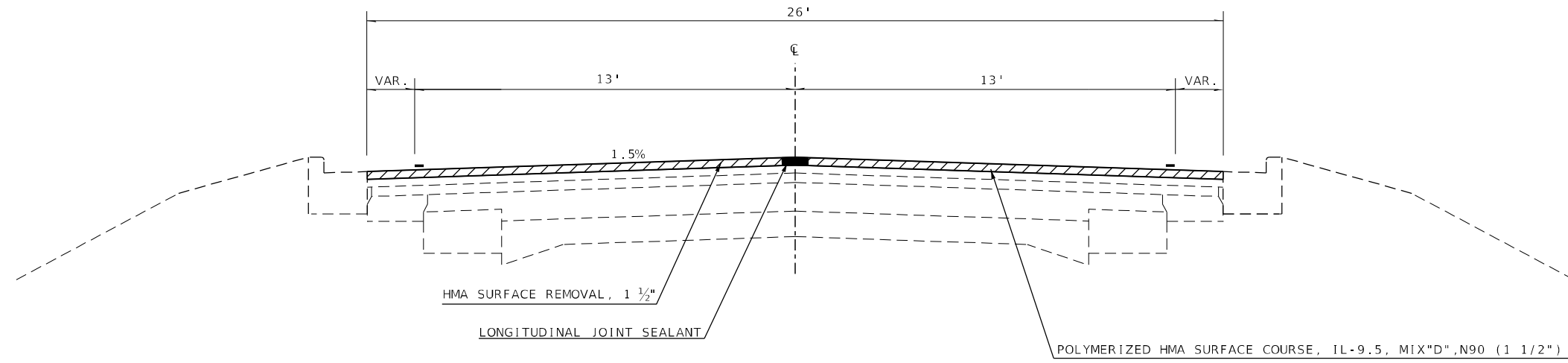

PROPOSED TYPICAL CROSS SECTION

STA 604+91 TO STA 621+71

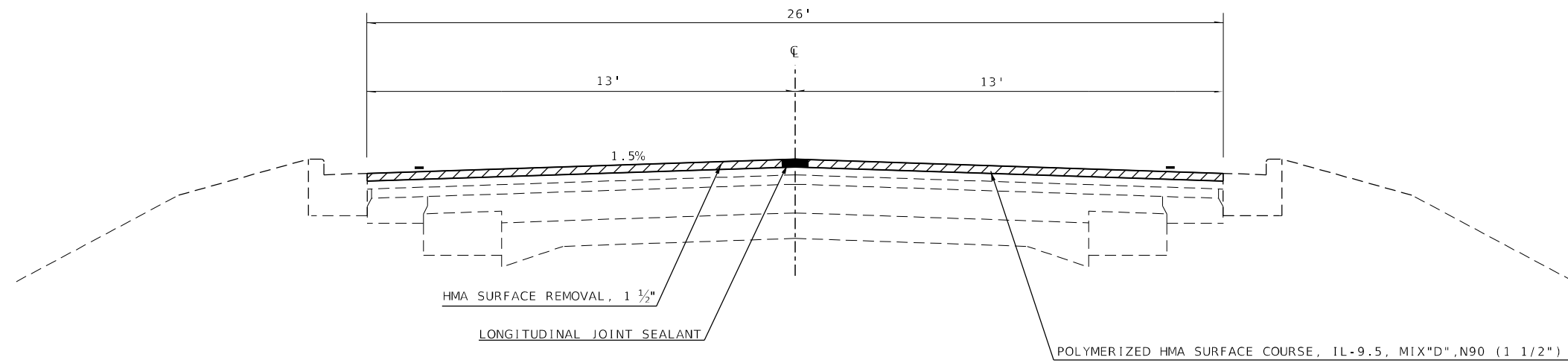

MODEL: Default
 FILE: \\mari-c:\pub\jst-cw-bee\paw.com\PIV\DOT\Documents\DOT Office\Dir\dir_7\Project\74A88\CADD\DATA\CAD\Sheet\74A88-std-hydr.cad.dgn

USER NAME = Jessica.Hille	DESIGNED -	REVISED -
	DRAWN -	REVISED -
PLOT SCALE = 100,0000' / in.	CHECKED -	REVISED -
PLOT DATE = 3/29/2023	DATE -	REVISED -

**STATE OF ILLINOIS
DEPARTMENT OF TRANSPORTATION**

TYPICAL CROSS SECTIONS

SCALE: SHEET OF SHEETS STA. TO STA.

F.A.P. RTE.	SECTION	COUNTY	TOTAL SHEETS	SHEET NO.
116	(6,7)RS-2	EFFINGHAM	46	6
CONTRACT NO. 74A88				
ILLINOIS FED. AID PROJECT				

STATION	TO	STATION	LENGTH FEET	PAVEMENT WIDTH FEET	SHOULDER WIDTH (LT&RT) FEET	AREA SQ FT	AREA SQ YD	BITUMINOUS MATERIALS (TACK COAT) 40600290 POUND	LONGITUDINAL JOINT SEALANT 40600370 FEET	TEMPORARY RAMP 40600990 SQ YD	POLYMERIZED HOT- MIX ASPHALT SURFACE COURSE, IL-9.5,MIX"D",N90 40604164 TON	HOT-MIX ASPHALT SURFACE REMOVAL, 1 1/2" 44000155 SQ YD	SHOULDER RUMBLE STRIPS, 8" 64200108 FEET
142+00.00		145+44.00	344	26	4.0	10320.0	1146.7	774.0	344.0	13.3	96.3	1146.7	0.0
145+44.00		147+81.00	237						BRIDGE OMISSION				
147+81.00		178+45.00	3064	24	6.0	91920.0	10213.3	6894.0	3064.0	13.3	857.9	10213.3	5623.0
URBAN TOTAL =								7668	3408	27	954	11360	5623
178+45.00		209+79.00	3134.0	24	6.0	94020.0	10446.7	7051.5	3134.0		877.5	10446.7	5780.0
209+79.00	=	209+68.00	-11.0						STATION EQUATION				
209+68.00		305+16.00	9548.0	24.0	6.0	286440.0	31826.7	21483.0	9548.0		2673.4	31826.7	18445.0
305+16.00		310+76.00	560.0	30.0	6.0	20160.0	2240.0	1512.0	1120.0		188.2	2240.0	1120.0
310+76.00		314+45.00	369.0	36.0	6.0	15498.0	1722.0	1162.4	738.0		144.6	1722.0	346.0
314+45.00	=	314+13.00	-32.0						STATION EQUATION				
314+13.00		314+88.00	75.0	36.0	3.0	2925.0	325.0	219.4	150.0		27.3	325.0	0.0
314+88.00		317+55.00	267.0	50.0	6.0	14952.0	1661.3	1121.4	801.0		139.6	1661.3	534.0
317+55.00		320+20.00	265.0	42.0	6.0	12720.0	1413.3	954.0	795.0		118.7	1413.3	530.0
320+20.00		323+82.00	362.0	30.0	6.0	13032.0	1448.0	977.4	724.0		121.6	1448.0	724.0
323+82.00		355+20.00	3138.0	24.0	6.0	94140.0	10460.0	7060.5	1096.0		878.6	10460.0	5881.0
355+20.00	=	357+15.00	195.0						STATION EQUATION				
357+15.00		412+78.00	5563.0	24.0	6.0	166890.0	18543.3	12516.8	5563.0		1557.6	18543.3	10639.0
412+78.00	=	412+75.00	-3.0						STATION EQUATION				
412+75.00		422+94.00	1019.0	24.0	6.0	30570.0	3396.7	2292.8	1019.0	13.3	285.3	3396.7	2005.0
422+94.00		424+46.00	152.0						BRIDGE OMISSION				
424+46.00		502+08.00	7714.0	24.0	6.0	231420.0	25713.3	17356.5	7714.0	13.3	2159.9	25713.3	15087.0
502+08.00		506+88.00	480.0	30.0	6.0	17280.0	1920.0	1296.0	960.0		161.3	1920.0	960.0
506+88.00		516+07.00	919.0	36.0	6.0	38598.0	4288.7	2894.9	1838.0		360.2	4288.7	1587.0
516+07.00		520+87.00	480.0	30.0	6.0	17280.0	1920.0	1296.0	960.0		161.3	1920.0	960.0
520+87.00		531+30.00	1043.0	24.0	6.0	31290.0	3476.7	2346.8	1043.0	13.3	292.0	3476.7	2086.0
531+30.00		532+43.00	113.0						BRIDGE OMISSION				
532+43.00		604+91.00	7254.0	24.0	6.0	217620.0	24180.0	16321.5	7254.0	13.3	2031.1	24180.0	14062.0
604+91.00		621+71.00	1680.0	26.0	0.0	43680.0	4853.3	3276.0	1680.0	13.3	407.7	4853.3	0.0
RURAL TOTAL =								101139	46137	67	12587	149835	80746
PROJECT TOTAL =								108807	49545	94	13541	161195	86369

STA.	TO	STA.	LENGTH FEET	WIDTH LT/RT FEET	AGGREGATE WEDGE SHOULDER, TYPE B TON
149+68.00		178+45.00	1867.0	6	85
URBAN TOTAL =					85
178+45.00		209+79.00	2842.0	6	129
209+79.00	=	209+68.00	STATION EQUATION		
209+68.00		314+45.00	10110.0	6	461
314+45.00	=	314+13.00	STATION EQUATION		
314+13.00		355+20.00	3766.0	6	172
355+20.00	=	357+15.00	STATION EQUATION		
357+15.00		412+75.00	5254.0	6	239
412+75.00	=	412+75.00	STATION EQUATION		
412+75.00		420+15.00	707.0	6	32
427+62.00		529+15.00	9722.0	6	443
529+15.00		534+40.00	BRIDGE OMISSION		
534+40.00		604+91.00	5729.0	6	261
RURAL TOTAL =					1738
PROJECT TOTAL =					1823

REV. - MS

MODEL: Default
 FILE NAME: P:\Illinois\Bentley.com\PROJECTS\74A88\CAD\DATA\CAD\Drawings\74A88-910-1.sch.dgn

USER NAME = Jessica.Hille	DESIGNED -	REVISED -	STATE OF ILLINOIS DEPARTMENT OF TRANSPORTATION	SCHEDULE OF QUANTITIES				F.A.P. RTE.	SECTION	COUNTY	TOTAL SHEETS	SHEET NO.
PLOT SCALE = 100.0000' / in.	DRAWN -	REVISED -						95	(6.7)RS-2	EFFINGHAM	46	7
PLOT DATE = 3/29/2023	CHECKED -	REVISED -		SCALE:				CONTRACT NO. 74A88				
	DATE -	REVISED -		SHEET OF SHEETS STA. TO STA.				ILLINOIS FED. AID PROJECT				

		LENGTH	NO PASSING ZONE	PAINT PAVEMENT MARKING - LINE 4"	THERMOPLASTIC PAVEMENT MARKING - LETTERS AND SYMBOLS	THERMOPLASTIC PAVEMENT MARKING - LINE 4"	THERMOPLASTIC PAVEMENT MARKING - LINE 6"	THERMOPLASTIC PAVEMENT MARKING - LINE 12"	GROOVING FOR RECESSED PAVEMENT MARKING, LETTERS AND SYMBOLS	GROOVING FOR RECESSED PAVEMENT MARKING 5"	GROOVING FOR RECESSED PAVEMENT MARKING 7"	GROOVING FOR RECESSED PAVEMENT MARKING 13"	SHORT-TERM PAVEMENT MARKING	SHORT TERM PAVEMENT MARKING REMOVAL	RAISED REFLECTIVE PAVEMENT MARKER	RAISED REFLECTIVE PAVEMENT MARKER REMOVAL		
				78001110	78000100	78000200	78000400	78000600	78011000	78011025	78011035	78011065	70300100	70300150	78100100	78300200		
STATION	TO	STATION	FEET	FEET	SQ FT	FEET	FEET	FEET	SQ FT	FEET	FEET	FEET	FEET	SQ FT	EACH	EACH		
142+00.00		145+44.00	344.0	WB NPZ	1118								34	11.4	4	4		
145+44.00		147+81.00	237.0						BRIDGE OMISSION									
147+81.00		149+58.00	177.0	WB NPZ	575								18	5.8	2	2		
149+58.00		149+92.00	34.0	SKIP DASH	77								3	1.1	0	0		
149+92.00		160+00.00	1008.0	EB NPZ	3276								101	33.3	13	5		
160+00.00		178+45.00	1845.0	DB NPZ	7380								185	60.9	23	11		
URBAN TOTAL =					12426								341	112	43	23		
178+45.00		201+83.00	2338.0	DB NPZ	9352								234	77.2	29	12		
201+83.00		208+85.00	702.0	WB NPZ	2282								70	23.2	9	3		
208+85.00		209+79.00	94.0	SKIP DASH	212								9	3.1	1	0		
209+79.00	=	209+68.00	-11.0						STATION EQUATION									
209+68.00		215+53.00	585.0	SKIP DASH	1316								59	19.3	7	3		
215+53.00		223+87.00	834.0	EB NPZ	2711								83	27.5	10	5		
223+87.00		229+90.00	603.0	SKIP DASH	1357								60	19.9	8	4		
229+90.00		235+87.00	597.0	WB NPZ	1940								60	19.7	7	2		
235+87.00		300+27.00	6440.0	SKIP DASH	14490								644	212.5	81	23		
300+27.00		305+07.00	480.0	EB NPZ	1560								48	15.8	6	2		
305+07.00		314+45.00	938.0	1775TH INT.		62	4974	125	201	62	4974	125	201	218	72.0	50	30	
314+45.00	=	314+13.00	-32.0						STATION EQUATION									
314+13.00		322+49.00	836.0	1775TH INT.		109	4284	483	158	109	4284	483	158	228	75.1	53	36	
322+49.00		328+19.00	570.0	WB NPZ	1853								57	18.8	7	1		
328+19.00		355+20.00	2701.0	SKIP DASH	6077								270	89.1	34	12		
355+20.00	=	357+15.00	195.0						STATION EQUATION									
357+15.00		400+52.00	4337.0	SKIP DASH	9758								434	143.1	54	14		
400+52.00		406+53.00	601.0	EB NPZ	1953								60	19.8	8	4		
406+53.00		407+73.00	120.0	SKIP DASH	270								12	4.0	2	0		
407+73.00		412+78.00	505.0	WB NPZ	1641								51	16.7	6	2		
412+78.00	=	412+75.00	-3.0						STATION EQUATION									
412+75.00		415+00.00	225.0	WB NPZ	731								23	7.4	3	0		
415+00.00		422+94.00	794.0	DASH	1787								79	26.2	10	4		
422+94.00		424+46.00	152.0						BRIDGE OMISSION									
424+46.00		497+90.00	7344.0	DASH	16524								734	242.4	92	43		
497+90.00		502+38.00	448.0	EB NPZ	1456								45	14.8	6	2		
502+38.00		520+81.00	1843.0	2100TH INT.		140	8548	454	219	140	8548	454	219	459	151.8	104	52	
520+81.00		525+10.00	429.0	WB NPZ	1394								43	14.2	5	0		
525+10.00		531+30.00	620.0	SKIP DASH	1395								62	20.5	8	2		
531+30.00		532+43.00	113.0						BRIDGE OMISSION									
532+43.00		585+00.00	5257.0	SKIP DASH	11828								526	173.5	66	28		
585+00.00		616+94.00	3194.0	SKIP DASH			7186.5				7186.5		319	105.4	80	18		
616+94.00		621+50.00	456.0	DB NPZ			1824.0				1824.0		46	15.0	11	11		
621+50.00		621+71.00	21.0	DIETERICH INT.			126.0				126.0		2	0.7	0	0		
RURAL TOTAL =					91887		312	26943	1062	578	312	26943	1062	578	4934	1629	756	314
PROJECT TOTAL =					102847		312	26943	1062	578	312	26943	1062	578	5275	1742	799	337

Model: Default
File: Mainfile - 10/11/2023
Project: 74A88 - CAD/PDF/Doc/Plan/Sheet/74A88 - Schedule

USER NAME = Jessica.Hille	DESIGNED -	REVISED -
PLOT SCALE = 100,0000' / in.	CHECKED -	REVISED -
PLOT DATE = 3/29/2023	DATE -	REVISED -

STATE OF ILLINOIS
DEPARTMENT OF TRANSPORTATION

SCHEDULE OF QUANTITIES			
SCALE:	SHEET	OF SHEETS	STA. TO STA.

F.A.P. RTE.	SECTION	COUNTY	TOTAL SHEETS	SHEET NO.
95	(6,7)RS-2	EFFINGHAM	46	8
			CONTRACT NO. 74A88	
ILLINOIS		FED. AID PROJECT		

PERMANENT SURVEY MARKERS

Point No.	Northing	Easting	STATION	OFFSET	DESC	PROPOSED PROTECT OR RESET
						IDOT DISK -FLUSH WITH PAVEMENT
100	888859.19	930846.13	172+63.44	0.00	PI KINK -ALUM. DISC	TYPE I - ALUM. DISK
101	888780.67	931203.46	176+29.35	0.0'	PC - ALUM. DISC	TYPE I - ALUM. DISK
102	888723.07	931465.46	178+97.56	12.53' LT	PI - ALUM. DISC	TYPE I - ALUM. DISK
103	888617.81	931712.18	181+64.21	0.00	PT - ALUM. DISC	TYPE I - ALUM. DISK
104	887996.54	933169.42	197+48.45	0.00	PC - ALUM. DISC	TYPE I - ALUM. DISK
105	887843.86	933871.27	204+70.94	0.00	PT - ALUM. DISC	TYPE I - ALUM. DISK
106	887831.30	934378.86	209+78.77 BK = 209+67.66 AH	0.00	POT/STA EQ. - ALUM. DISC	TYPE I - ALUM. DISK
125	887722.40	938186.29	247+76.42	14.29' RT	SECT. COR. - I.P. IN VAULT	IRON PIN IN VAULT
107	887703.84	939505.09	260+95.33	0.00	PI KINK - ALUM. DISC	TYPE I - ALUM. DISK
126	887670.30	940841.45	274+33.05	0.00	SECT. COR. - ALUM. DISC	TYPE I - ALUM. DISK
108	887569.14	944853.30	314+45.17 BK = 314+13.07 AH	0.00	POT/STA EQ. - ALUM. DISC	TYPE I - ALUM. DISK
109	887546.59	945744.47	323+04.51	0.00	PC - ALUM. DISC	TYPE I - ALUM. DISK
110	887538.38	946074.51	326+34.67	2.41' RT	PI - ALUM. DISC	TYPE I - ALUM. DISK
129	887539.71	946190.20	327+50.43	0.00	SECT. COR. - ALUM. DISC	TYPE I - ALUM. DISK
111	887539.58	946404.68	329+64.80	0.00	PT - ALUM. DISC	TYPE I - ALUM. DISK
112	887542.96	947293.55	338+53.62	0.00	SECT. COR. - ALUM. DISC	TYPE I - ALUM. DISK
130	887543.37	947364.80	339+25.01	0.00	PC - ALUM. DISC	TYPE I - ALUM. DISK
113	886920.56	948783.42	355+20.31 BK = 357+15.38 AH	0.00	PT/STA EQ. - ALUM. DISC	TYPE I - ALUM. DISK
114	884481.86	951007.94	390+16.07	0.00	PC - ALUM. DISC	TYPE I - ALUM. DISK
115	883210.67	952314.34	408+39.99	0.00	PT - ALUM. DISC +/- 2" DEEP	TYPE I - ALUM. DISK
116	882924.27	952646.22	412+78.37 BK = 412+74.63 AH	0.00	POT/STA EQ. - ALUM. DISC	TYPE I - ALUM. DISK
117	879595.75	956503.21	463+69.48	0.00	PC - ALUM. DISC	TYPE I - ALUM. DISK
118	877999.21	958854.21	492+17.51	0.00	PT - ALUM. DISC	TYPE I - ALUM. DISK
119	873697.15	967138.52	585+45.20	0.00	PC - ALUM. DISC	TYPE I - ALUM. DISK
120	873454.09	967608.57	590+74.46	0.92' LT	PI - ALUM. DISC	TYPE I - ALUM. DISK
121	873207.74	968077.14	596+03.72	0.00	PT - ALUM. DISC	TYPE I - ALUM. DISK
122	872342.89	969721.63	614+61.85	0.00	PC - ALUM. DISC	TYPE I - ALUM. DISK
123	872211.27	970240.98	620+02.52	0.00	PT - ALUM. DISC	TYPE I - ALUM. DISK
SURVEY MARKER VAULT TOTAL =						1
PROTECTING OR RESETTING TOTAL =						28

MODEL: Default
 FILE: \\malfc-pw-bentley.com\P\INDOT\Documents\IDOT_offices\Dir\rdt_7\Project\74A88\CADD\DATA\CAD\Sheet\ID74A88-5-1-2-3.dwg

USER NAME = Jessica.Hille	DESIGNED -	REVISED -
	DRAWN -	REVISED -
PLOT SCALE = 100,0000 ' / in.	CHECKED -	REVISED -
PLOT DATE = 3/29/2023	DATE -	REVISED -

STATE OF ILLINOIS
DEPARTMENT OF TRANSPORTATION

SCHEDULE OF QUANTITIES

SCALE: SHEET OF SHEETS STA. TO STA.

F.A.P. RTE.	SECTION	COUNTY	TOTAL SHEETS	SHEET NO.
95	(6,7)RS-2	EFFINGHAM	46	9
CONTRACT NO. 74A88				
ILLINOIS FED. AID PROJECT				

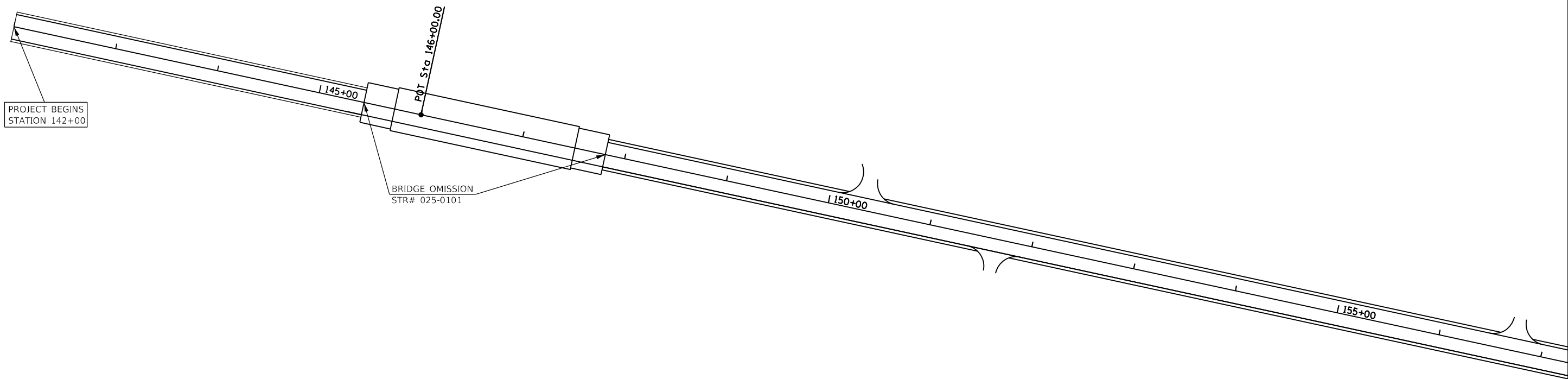

MODEL: Default
 FILE: hmlr12.pia\uldrct-cw-bead-fy.com\FW\DOT\Documents\DOT Offices\District 7\Projects\74A88\CADD\DATA\CAD\SheetID74A88-5-1.dgn

USER NAME = Jessica.Hille	DESIGNED -	REVISED -
	DRAWN -	REVISED -
PLOT SCALE = 100,0000' / in.	CHECKED -	REVISED -
PLOT DATE = 3/29/2023	DATE -	REVISED -

STATE OF ILLINOIS
DEPARTMENT OF TRANSPORTATION

PLAN SHEET			
SCALE:	SHEET	OF	SHEETS
	STA.	TO	STA.

F.A.P. RTE.	SECTION	COUNTY	TOTAL SHEETS	SHEET NO.
95	(6.7)RS-2	EFFINGHAM	46	10
CONTRACT NO. 74A88			ILLINOIS FED. AID PROJECT	

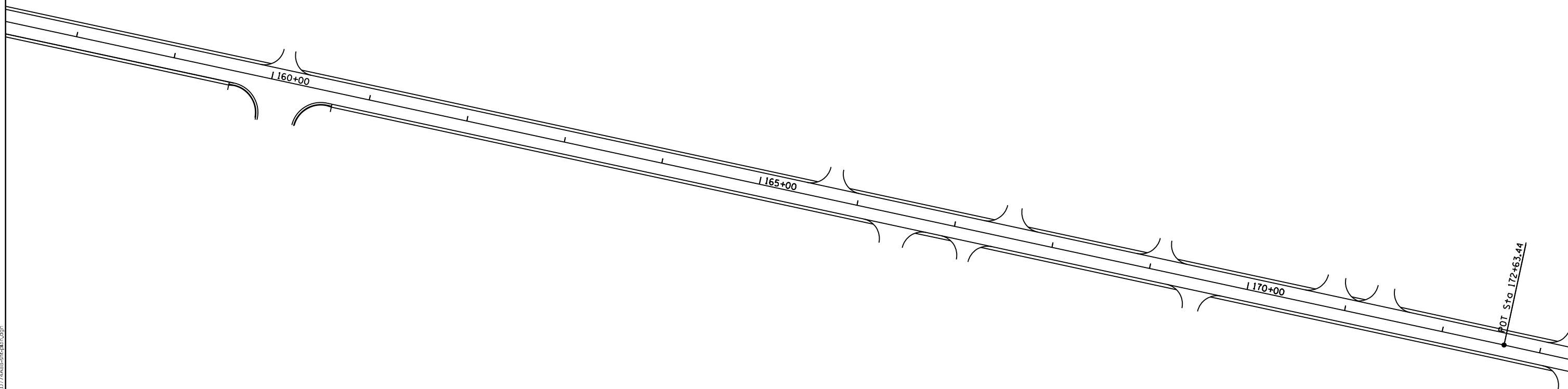

MODEL: Default
 FILE: hmlr12.pia\ultra-cw-bead-fy.com\P\I\DOT\Documents\DOT Offices\District 7\Projects\74A88\CADD\DATA\CAD\SheetID74A88-shd.dgn

USER NAME = Jessica.Hille	DESIGNED -	REVISED -
	DRAWN -	REVISED -
PLOT SCALE = 100,0000' / in.	CHECKED -	REVISED -
PLOT DATE = 3/29/2023	DATE -	REVISED -

STATE OF ILLINOIS
DEPARTMENT OF TRANSPORTATION

PLAN SHEET

SCALE: SHEET OF SHEETS STA. TO STA.

F.A.P. RTE.	SECTION	COUNTY	TOTAL SHEETS	SHEET NO.
95	(6.7)RS-2	EFFINGHAM	46	11
CONTRACT NO. 74A88				
ILLINOIS FED. AID PROJECT				

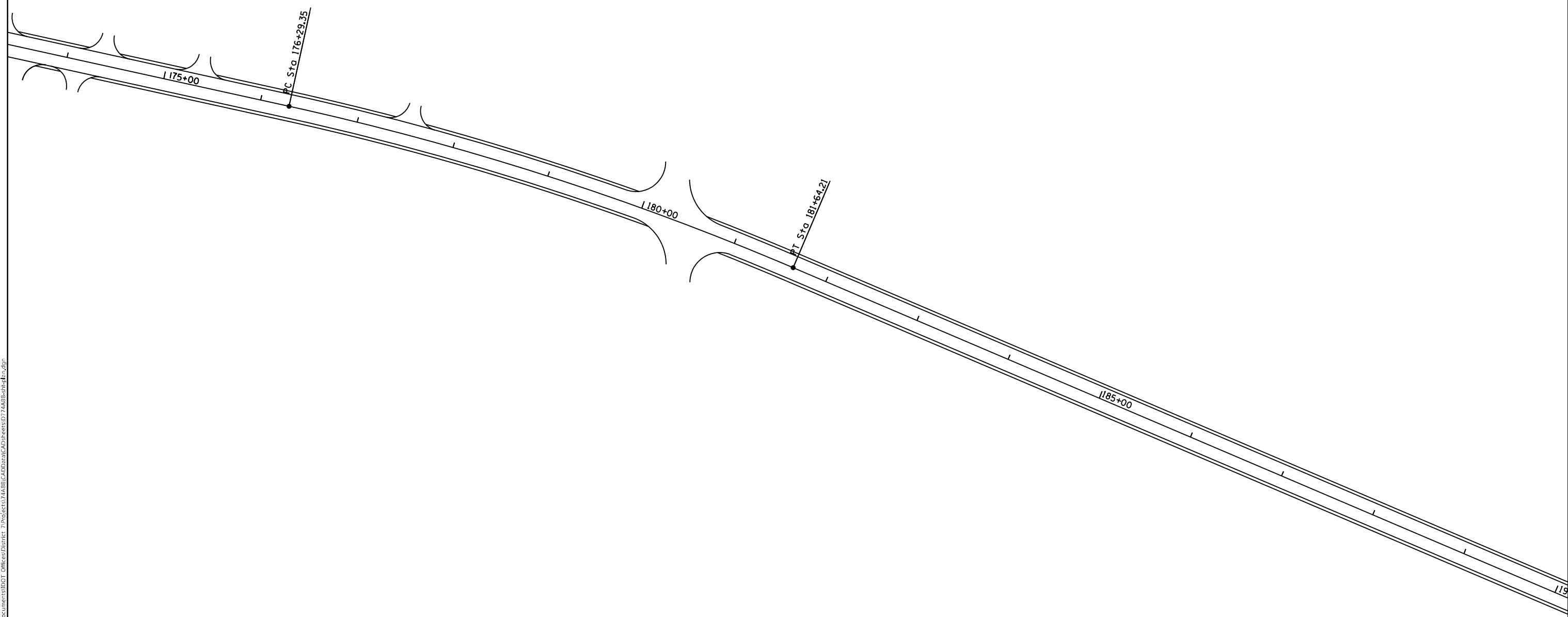

MODEL: Default
 FILE NAME: p:\ultra-cw-bee\paw.com\PIV\DOT\Documents\DOT Offices\Director_7\Projects\74A88\CADD\DATA\CAD\Sheet\74A88-46-12.dwg

USER NAME = Jessica.Hille	DESIGNED -	REVISED -
	DRAWN -	REVISED -
PLOT SCALE = 100,0000 ' / in.	CHECKED -	REVISED -
PLOT DATE = 3/29/2023	DATE -	REVISED -

STATE OF ILLINOIS
DEPARTMENT OF TRANSPORTATION

PLAN SHEET

SCALE: SHEET OF SHEETS STA. TO STA.

F.A.P. RTE.	SECTION	COUNTY	TOTAL SHEETS	SHEET NO.
95	(6.7)RS-2	EFFINGHAM	46	12
CONTRACT NO. 74A88				
ILLINOIS FED. AID PROJECT				

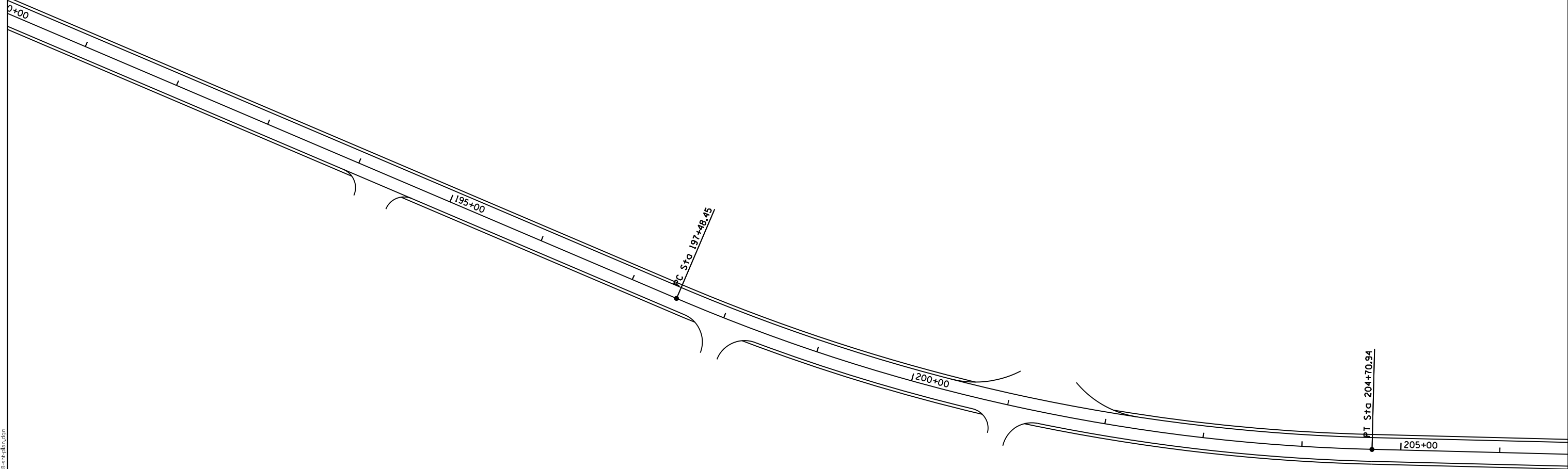

MODEL: Default
 FILE: \\mfe-pw-bentley.com\P\DOT\Documents\DOT Offices\District 7\Projects\74A88\CADD\DATA\CAD\Sheet\74A88-46.dgn

USER NAME = Jessica.Hille	DESIGNED -	REVISED -
	DRAWN -	REVISED -
PLOT SCALE = 100,0000' / in.	CHECKED -	REVISED -
PLOT DATE = 3/29/2023	DATE -	REVISED -

**STATE OF ILLINOIS
DEPARTMENT OF TRANSPORTATION**

PLAN SHEET

SCALE: SHEET OF SHEETS STA. TO STA.

F.A.P. RTE.	SECTION	COUNTY	TOTAL SHEETS	SHEET NO.
95	(6.7)RS-2	EFFINGHAM	46	13
CONTRACT NO. 74A88				
ILLINOIS FED. AID PROJECT				

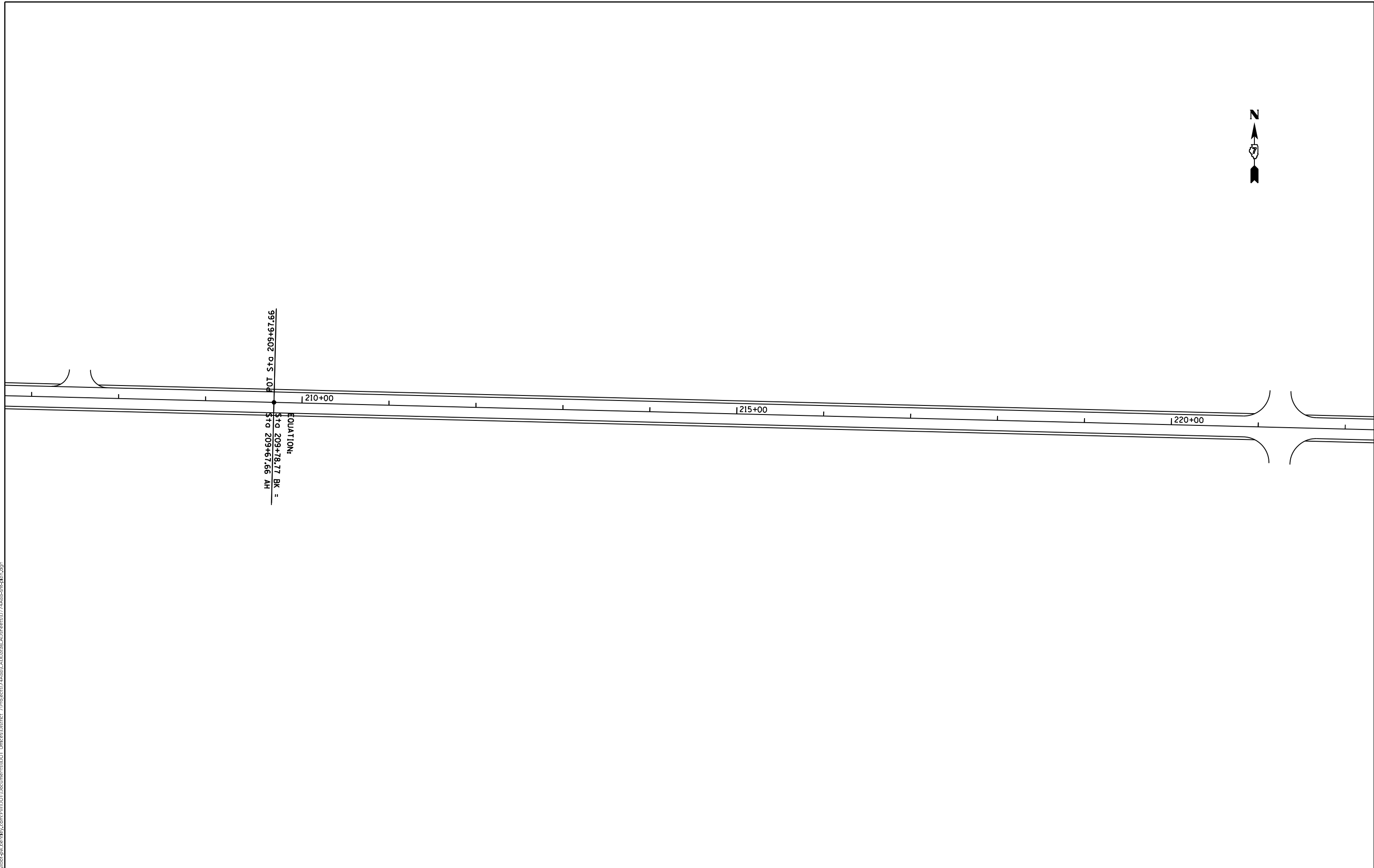

MODEL: Default
 FILE NAME: p:\ultra-cw-beadley.com\PIV\DOT\Documents\DOT Offices\District 7\Projects\74A88\CADD\DATA\CAD\Sheet\74A88-sheet14.dgn

USER NAME = Jessica.Hille	DESIGNED -	REVISED -
	DRAWN -	REVISED -
PLOT SCALE = 100,0000 ' / in.	CHECKED -	REVISED -
PLOT DATE = 3/29/2023	DATE -	REVISED -

**STATE OF ILLINOIS
DEPARTMENT OF TRANSPORTATION**

PLAN SHEET			
SCALE:	SHEET	OF	SHEETS
	STA.	TO	STA.

F.A.P. RTE.	SECTION	COUNTY	TOTAL SHEETS	SHEET NO.
95	(6.7)RS-2	EFFINGHAM	46	14
			CONTRACT NO. 74A88	
		ILLINOIS	FED. AID PROJECT	

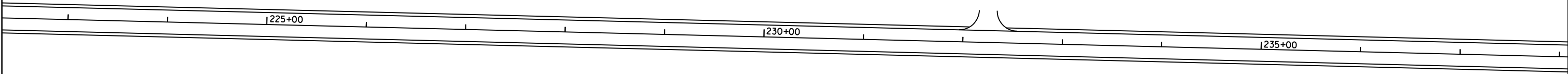

MODEL: Default
FILE: \\MAILSrv\pub\ldict-cw-bee\efw.com\PIV\DOT\Documents\DOT_offices\District_7\Project\74A88\CADD\data\CAD\sheet\ID74A88-sheet15.dgn

USER NAME = Jessica.Hille	DESIGNED -	REVISED -
	DRAWN -	REVISED -
PLOT SCALE = 100,0000 ' / in.	CHECKED -	REVISED -
PLOT DATE = 3/29/2023	DATE -	REVISED -

**STATE OF ILLINOIS
DEPARTMENT OF TRANSPORTATION**

PLAN SHEET			
SCALE:	SHEET	OF	SHEETS
	STA.		TO STA.

F.A.P. RTE.	SECTION	COUNTY	TOTAL SHEETS	SHEET NO.
95	(6.7)RS-2	EFFINGHAM	46	15
CONTRACT NO. 74A88				
ILLINOIS FED. AID PROJECT				

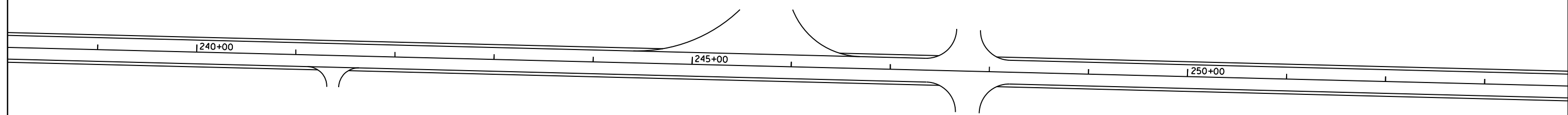

MODEL: Default
 FILE: \\mupc-pw-bentley.com\PW\DOT\Documents\DOT_offices\District_7\Project\74A88\CADD\DATA\CAD\SheetID74A88-5-16.dgn

	USER NAME = Jessica.Hille PLOT SCALE = 100,0000 ' / in. PLOT DATE = 3/29/2023	DESIGNED - DRAWN - CHECKED - DATE -	REVISED - REVISED - REVISED - REVISED -	STATE OF ILLINOIS DEPARTMENT OF TRANSPORTATION	PLAN SHEET	SCALE:	SHEET OF SHEETS STA. TO STA.	F.A.P. RTE. 95	SECTION (6.7)RS-2	COUNTY EFFINGHAM	TOTAL SHEETS 46	SHEET NO. 16	CONTRACT NO. 74A88 ILLINOIS FED. AID PROJECT
--	---	--	--	--	-------------------	--------	------------------------------	-------------------	----------------------	---------------------	--------------------	-----------------	---

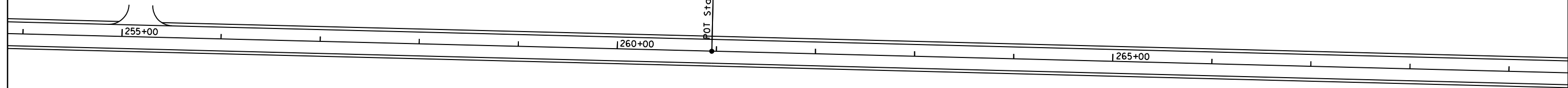

MODEL: Default
 FILE NAME: p:\ultra-cw-bea\paw.com\PIV\DOT\Documents\DOT_offices\District_7\Project\74A88\CADD\DATA\CAD\SheetID74A88-sheet.dgn

USER NAME = Jessica.Hille	DESIGNED -	REVISED -
	DRAWN -	REVISED -
PLOT SCALE = 100,0000 ' / in.	CHECKED -	REVISED -
PLOT DATE = 3/29/2023	DATE -	REVISED -

**STATE OF ILLINOIS
 DEPARTMENT OF TRANSPORTATION**

PLAN SHEET

SCALE: SHEET OF SHEETS STA. TO STA.

F.A.P. RTE.	SECTION	COUNTY	TOTAL SHEETS	SHEET NO.
95	(6.7)RS-2	EFFINGHAM	46	17
CONTRACT NO. 74A88				
ILLINOIS FED. AID PROJECT				

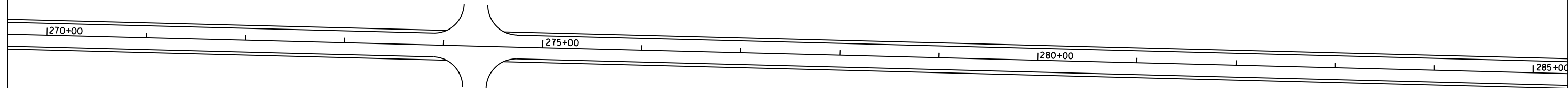

MODEL: Default
FILE: \\mupc-pw-bentley.com\PW\DOT\Documents\DOT Offices\District 7\Projects\74A88\CADD\Drawings\74A88-Subplan.dwg

USER NAME = Jessica.Hille	DESIGNED -	REVISED -
	DRAWN -	REVISED -
PLOT SCALE = 100,0000 ' / in.	CHECKED -	REVISED -
PLOT DATE = 3/29/2023	DATE -	REVISED -

**STATE OF ILLINOIS
DEPARTMENT OF TRANSPORTATION**

PLAN SHEET

SCALE: SHEET OF SHEETS STA. TO STA.

F.A.P. RTE.	SECTION	COUNTY	TOTAL SHEETS	SHEET NO.
95	(6.7)RS-2	EFFINGHAM	46	18
CONTRACT NO. 74A88				
ILLINOIS FED. AID PROJECT				

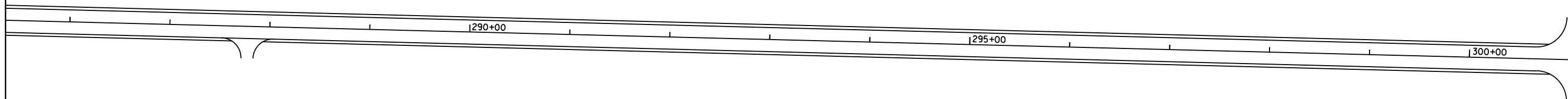

MODEL: Default
 FILE: \\mariya-pc\public\paw.bentley.com\PW\DOT\Documents\DOT Offices\District 7\Project\74A88\CADD\data\CAD\sheet\ID74A88-sheet.dgn

USER NAME = Jessica.Hille	DESIGNED -	REVISED -
	DRAWN -	REVISED -
PLOT SCALE = 100,0000 ' / in.	CHECKED -	REVISED -
PLOT DATE = 3/29/2023	DATE -	REVISED -

STATE OF ILLINOIS
DEPARTMENT OF TRANSPORTATION

PLAN SHEET

SCALE: SHEET OF SHEETS STA. TO STA.

F.A.P. RTE.	SECTION	COUNTY	TOTAL SHEETS	SHEET NO.
95	(6.7)RS-2	EFFINGHAM	46	19
CONTRACT NO. 74A88			ILLINOIS FED. AID PROJECT	

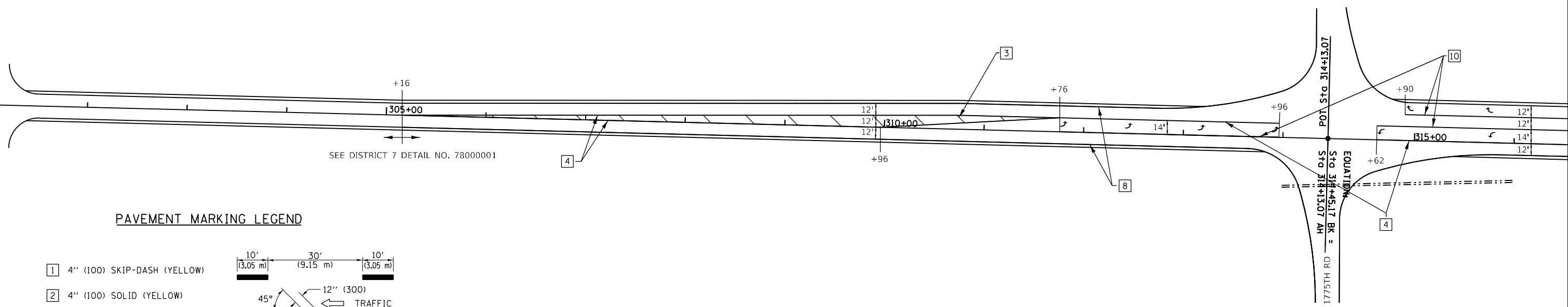

PAVEMENT MARKING LEGEND

- 1 4" (100) SKIP-DASH (YELLOW)
- 2 4" (100) SOLID (YELLOW)
- 3 12" (300) DIAGONAL (YELLOW)
- 4 4" (100) DOUBLE YELLOW (NARROW)
- 5 12" (300) SOLID WHITE
- 6 4" (100) DOUBLE YELLOW (WIDE)
- 7 6" (150) SKIP-DASH (WHITE)
- 8 4" (100) SOLID (WHITE)
- 9 12" (300) DIAGONAL (WHITE)
- 10 6" (150) SOLID (WHITE)
- 11 24" (600) STOP BAR (WHITE)
- 12 8" (200) SOLID (WHITE)
- 13 4" (100) PARKING WHITE

MODEL: Default
 FILE: hmlr_20230329.ctb
 PROJECT: 74A88\CD\Drawings\DOT\Office\Drawings\74A88\Sheet\74A88-Plan.dwg

USER NAME = Jessica.Hille	DESIGNED -	REVISED -
PLOT SCALE = 100,0000' / in.	DRAWN -	REVISED -
PLOT DATE = 3/29/2023	CHECKED -	REVISED -
	DATE -	REVISED -

**STATE OF ILLINOIS
DEPARTMENT OF TRANSPORTATION**

PLAN SHEET			
SCALE:	SHEET	OF	SHEETS
	STA.	TO	STA.

F.A.P. RTE.	SECTION	COUNTY	TOTAL SHEETS	SHEET NO.
95	(6.7)RS-2	EFFINGHAM	46	20
CONTRACT NO. 74A88				
ILLINOIS FED. AID PROJECT				

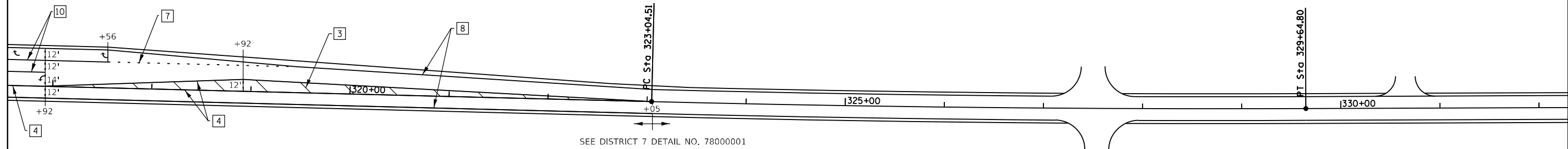

PAVEMENT MARKING LEGEND

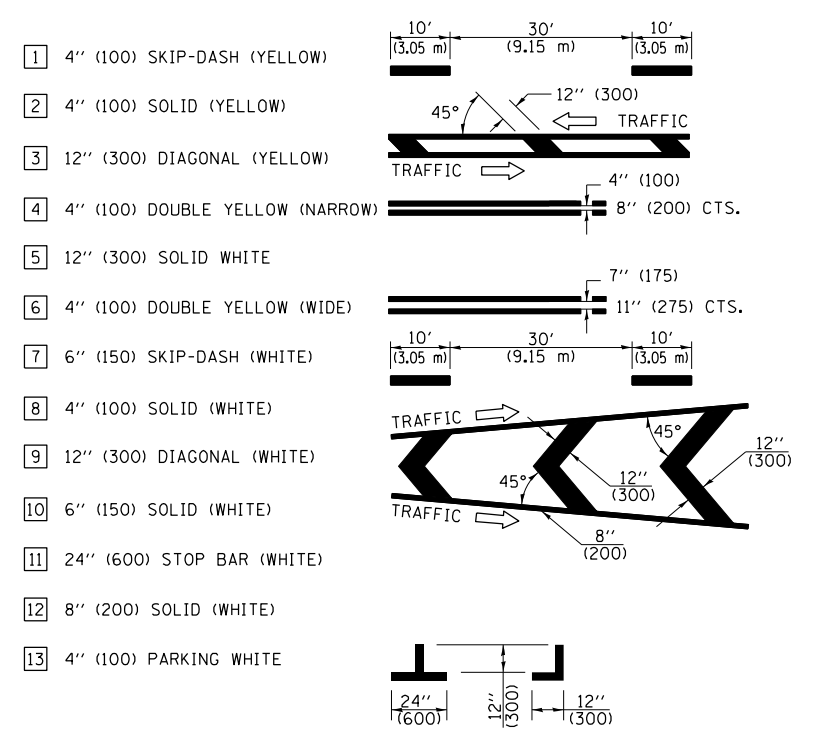

MODEL: Default
 FILE: \\na11e1-pw-bentley.com\PIV\DOT\Documents\DOT Offices\District 7\Projects\74A88\CADD\DATA\CAD\Sheet\74A88-Plan.dgn

USER NAME = Jessica.Hille	DESIGNED -	REVISED -
PLOT SCALE = 100,0000 ' / in.	DRAWN -	REVISED -
PLOT DATE = 3/29/2023	CHECKED -	REVISED -
	DATE -	REVISED -

**STATE OF ILLINOIS
DEPARTMENT OF TRANSPORTATION**

PLAN SHEET	
SCALE:	SHEET OF SHEETS STA. TO STA.

F.A.P. RTE.	SECTION	COUNTY	TOTAL SHEETS	SHEET NO.
95	(6,7)RS-2	EFFINGHAM	46	21
CONTRACT NO. 74A88				
ILLINOIS FED. AID PROJECT				

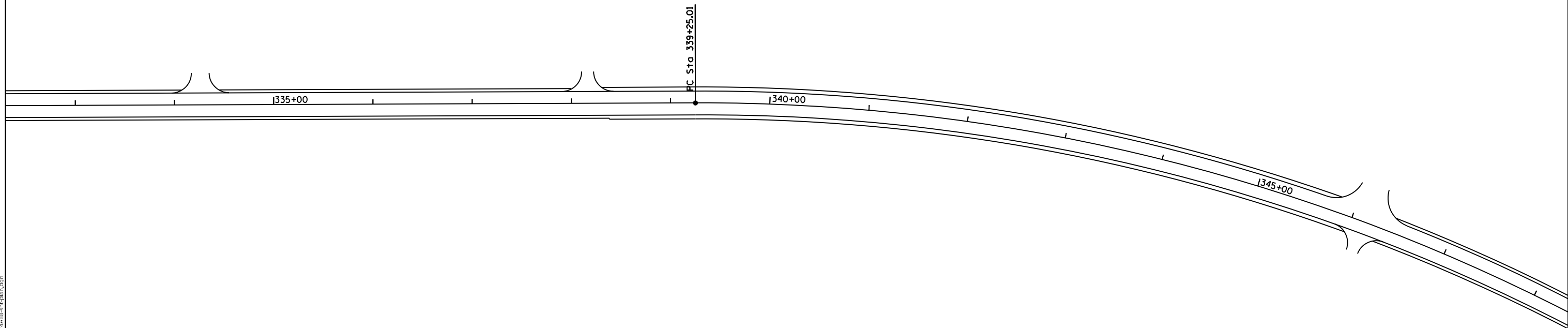

MODEL: Default
 FILE: \\mlls-pw-bentley.com\P\DOT\Documents\DOT Offices\District 7\Projects\74A88\CADD\DATA\CAD\SheetID74A88-25.dgn

USER NAME = Jessica.Hille	DESIGNED -	REVISED -
	DRAWN -	REVISED -
PLOT SCALE = 100,0000 ' / in.	CHECKED -	REVISED -
PLOT DATE = 3/29/2023	DATE -	REVISED -

STATE OF ILLINOIS
DEPARTMENT OF TRANSPORTATION

PLAN SHEET

SCALE: SHEET OF SHEETS STA. TO STA.

F.A.P. RTE.	SECTION	COUNTY	TOTAL SHEETS	SHEET NO.
95	(6.7)RS-2	EFFINGHAM	46	22
CONTRACT NO. 74A88				
ILLINOIS FED. AID PROJECT				

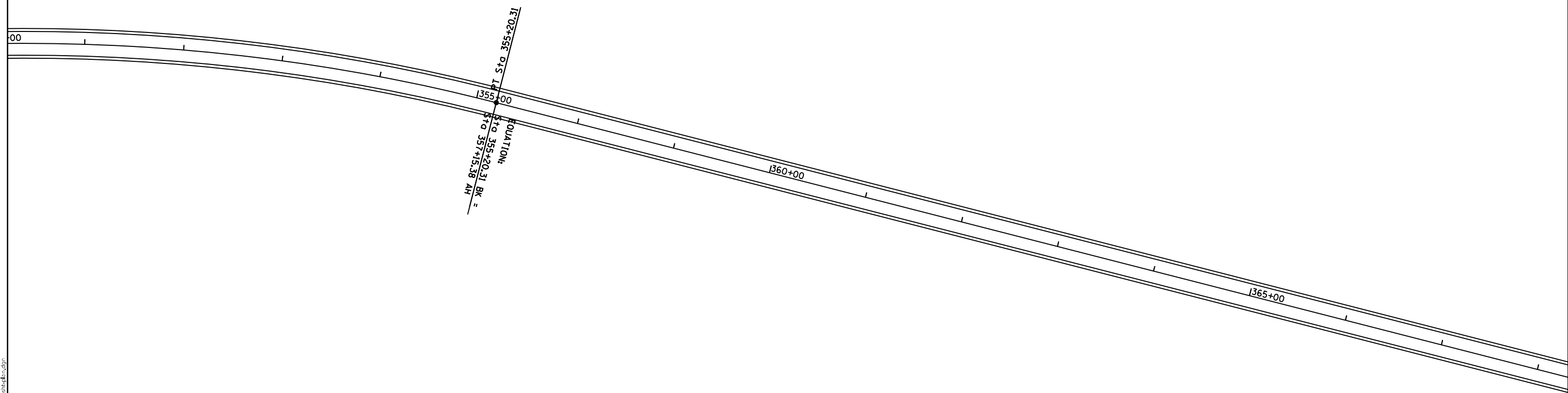

MODEL: Default
 FILE: hmlrte_74a88.dwg
 C:\Users\jshill\OneDrive\Documents\DOT\Projects\74A88\CADD\Drawings\74A88-Plan.dwg

USER NAME = Jessica.Hille	DESIGNED -	REVISED -
	DRAWN -	REVISED -
PLOT SCALE = 100,0000' / in.	CHECKED -	REVISED -
PLOT DATE = 3/29/2023	DATE -	REVISED -

STATE OF ILLINOIS
DEPARTMENT OF TRANSPORTATION

PLAN SHEET			
SCALE:	SHEET	OF	SHEETS
	STA.		TO STA.

F.A.P. RTE.	SECTION	COUNTY	TOTAL SHEETS	SHEET NO.
95	(6.7)RS-2	EFFINGHAM	46	23
CONTRACT NO. 74A88				
ILLINOIS FED. AID PROJECT				

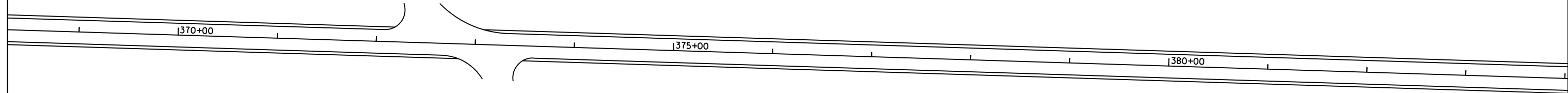
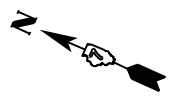

MODEL: Default
FILE: \\mlls-pw\ultra-pw-bea\pwy.com\PIV\DOT\Documents\DOT Offices\District 7\Projects\74A88\CADD\DATA\CAD\Sheets\74A88-46-24.dwg

USER NAME = Jessica.Hille	DESIGNED -	REVISED -
	DRAWN -	REVISED -
PLOT SCALE = 100,0000 ' / in.	CHECKED -	REVISED -
PLOT DATE = 3/29/2023	DATE -	REVISED -

**STATE OF ILLINOIS
DEPARTMENT OF TRANSPORTATION**

PLAN SHEET

SCALE: SHEET OF SHEETS STA. TO STA.

F.A.P. RTE.	SECTION	COUNTY	TOTAL SHEETS	SHEET NO.
95	(6.7)RS-2	EFFINGHAM	46	24
CONTRACT NO. 74A88				
ILLINOIS FED. AID PROJECT				

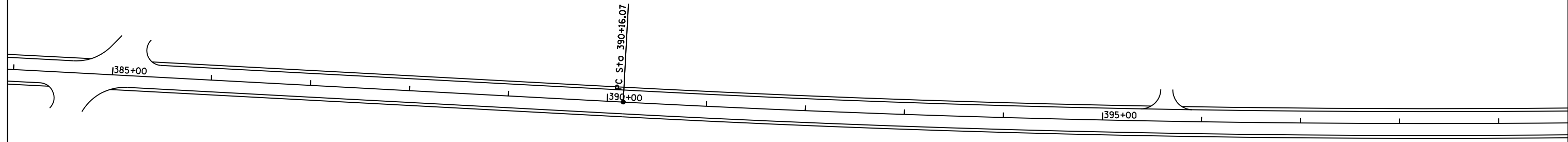
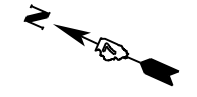

MODEL: Default
 FILE: \\mlls-pw-bentley.com\P\DOT\Documents\DOT Offices\District 7\Project\74A88\CADD\DATA\CAD\Sheet\74A88-5-Plan.dgn

USER NAME = Jessica.Hille	DESIGNED -	REVISED -
	DRAWN -	REVISED -
PLOT SCALE = 100,0000 ' / in.	CHECKED -	REVISED -
PLOT DATE = 3/29/2023	DATE -	REVISED -

STATE OF ILLINOIS
DEPARTMENT OF TRANSPORTATION

PLAN SHEET

SCALE: SHEET OF SHEETS STA. TO STA.

F.A.P. RTE.	SECTION	COUNTY	TOTAL SHEETS	SHEET NO.
95	(6.7)RS-2	EFFINGHAM	46	25
CONTRACT NO. 74A88				
ILLINOIS FED. AID PROJECT				

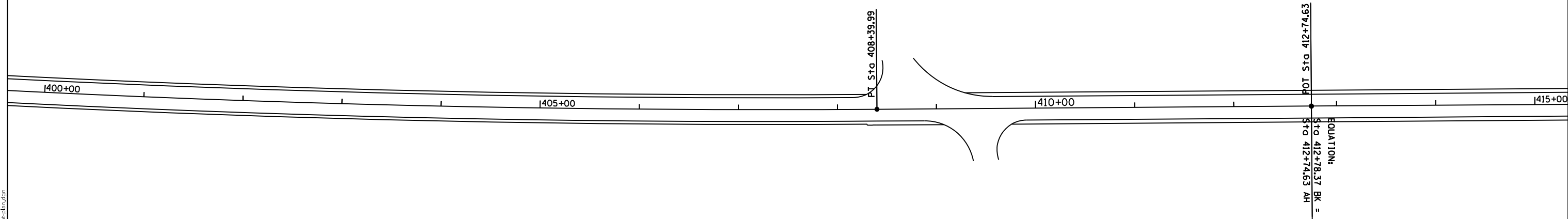

MODEL: Default
 FILE: \\mfrs-pw-bentley.com\PW\DOT\Documents\DOT Offices\Director_7\Project\74A88\CADD\DATA\CAD\Sheet\74A88-46.dgn

USER NAME = Jessica.Hille	DESIGNED -	REVISED -
	DRAWN -	REVISED -
PLOT SCALE = 100,0000 ' / in.	CHECKED -	REVISED -
PLOT DATE = 3/29/2023	DATE -	REVISED -

STATE OF ILLINOIS
DEPARTMENT OF TRANSPORTATION

PLAN SHEET			
SCALE:	SHEET	OF	SHEETS
	STA.	TO	STA.

F.A.P. RTE.	SECTION	COUNTY	TOTAL SHEETS	SHEET NO.
95	(6.7)RS-2	EFFINGHAM	46	26
CONTRACT NO. 74A88				
ILLINOIS FED. AID PROJECT				

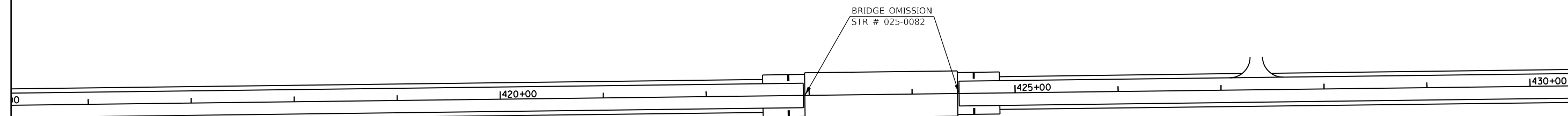
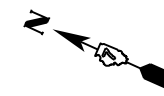

MODEL: Default
 FILE: \\mariya-pc\public\paw.bentley.com\P\I\DOT\Documents\DOT Offices\District 7\Project\74A88\CADD\DATA\CAD\Sheet\ID74A88-27.dgn

USER NAME = Jessica.Hille	DESIGNED -	REVISED -
	DRAWN -	REVISED -
PLOT SCALE = 100,0000 ' / in.	CHECKED -	REVISED -
PLOT DATE = 3/29/2023	DATE -	REVISED -

**STATE OF ILLINOIS
DEPARTMENT OF TRANSPORTATION**

PLAN SHEET

SCALE: SHEET OF SHEETS STA. TO STA.

F.A.P. RTE.	SECTION	COUNTY	TOTAL SHEETS	SHEET NO.
95	(6,7)RS-2	EFFINGHAM	46	27
CONTRACT NO. 74A88			ILLINOIS FED. AID PROJECT	

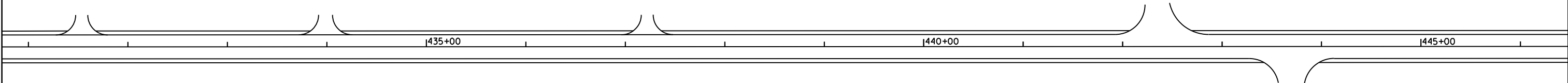

MODEL: Default
 FILE: \\mlls-pw-bentley.com\PW\DOT\Documents\DOT Offices\District 7\Projects\74A88\CADD\DATA\CAD\Sheets\74A88-5-Plan.dgn

USER NAME = Jessica.Hille	DESIGNED -	REVISED -
	DRAWN -	REVISED -
PLOT SCALE = 100,0000 ' / in.	CHECKED -	REVISED -
PLOT DATE = 3/29/2023	DATE -	REVISED -

STATE OF ILLINOIS
DEPARTMENT OF TRANSPORTATION

PLAN SHEET
 SCALE: SHEET OF SHEETS STA. TO STA.

F.A.P. RTE.	SECTION	COUNTY	TOTAL SHEETS	SHEET NO.
95	(6,7)RS-2	EFFINGHAM	46	28
CONTRACT NO. 74A88				
ILLINOIS FED. AID PROJECT				

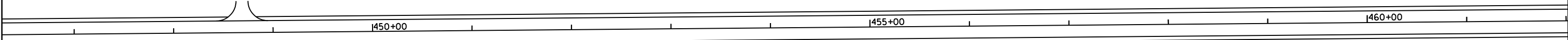

MODEL: Default
FILE: \\mupc-pw-bentley.com\PW\DOT\Documents\DOT Offices\District 7\Project\74A88\CADD\DATA\CAD\Sheet\74A88-2-Plan.dgn

USER NAME = Jessica.Hille	DESIGNED -	REVISED -
	DRAWN -	REVISED -
PLOT SCALE = 100,0000 ' / in.	CHECKED -	REVISED -
PLOT DATE = 3/29/2023	DATE -	REVISED -

**STATE OF ILLINOIS
DEPARTMENT OF TRANSPORTATION**

PLAN SHEET

SCALE: SHEET OF SHEETS STA. TO STA.

F.A.P. RTE.	SECTION	COUNTY	TOTAL SHEETS	SHEET NO.
95	(6,7)RS-2	EFFINGHAM	46	29
CONTRACT NO. 74A88				
ILLINOIS FED. AID PROJECT				

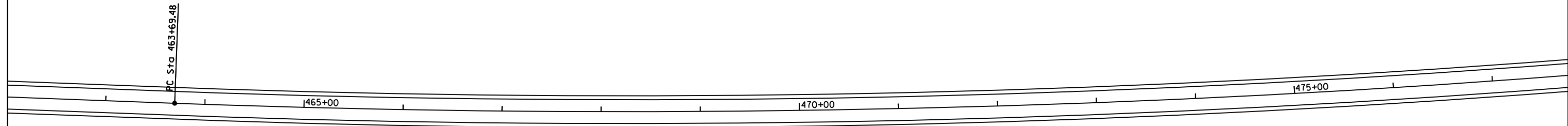

MODEL: Default
 FILE: \\mupc-pw-bentley.com\P\DOT\Documents\DOT Offices\District 7\Projects\74A88\CADD\DATA\CAD\Sheet\74A88-46.dgn

USER NAME = Jessica.Hille	DESIGNED -	REVISED -
	DRAWN -	REVISED -
PLOT SCALE = 100,0000 ' / in.	CHECKED -	REVISED -
PLOT DATE = 3/29/2023	DATE -	REVISED -

**STATE OF ILLINOIS
 DEPARTMENT OF TRANSPORTATION**

PLAN SHEET	
SCALE:	SHEET OF SHEETS STA. TO STA.

F.A.P. RTE.	SECTION	COUNTY	TOTAL SHEETS	SHEET NO.
95	(6.7)RS-2	EFFINGHAM	46	30
CONTRACT NO. 74A88				
ILLINOIS FED. AID PROJECT				

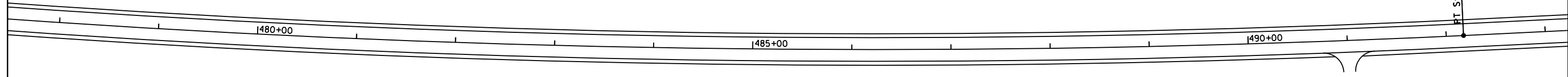

MODEL: Default
FILE NAME: p:\ultra-cw-bead\p\com\PIV\DOT\Documents\DOT_offices\District_7\Project\74A88\CADD\data\CAD\sheet\74A88-sheet-31.dgn

USER NAME = Jessica.Hille	DESIGNED -	REVISED -
	DRAWN -	REVISED -
PLOT SCALE = 100,0000 ' / in.	CHECKED -	REVISED -
PLOT DATE = 3/29/2023	DATE -	REVISED -

**STATE OF ILLINOIS
DEPARTMENT OF TRANSPORTATION**

PLAN SHEET

SCALE: SHEET OF SHEETS STA. TO STA.

F.A.P. RTE.	SECTION	COUNTY	TOTAL SHEETS	SHEET NO.
95	(6.7)RS-2	EFFINGHAM	46	31
CONTRACT NO. 74A88				
ILLINOIS FED. AID PROJECT				

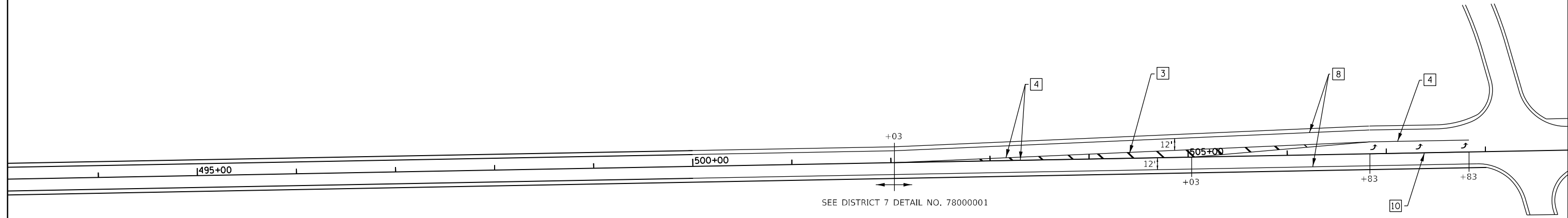

PAVEMENT MARKING LEGEND

- 1 4" (100) SKIP-DASH (YELLOW)
- 2 4" (100) SOLID (YELLOW)
- 3 12" (300) DIAGONAL (YELLOW)
- 4 4" (100) DOUBLE YELLOW (NARROW)
- 5 12" (300) SOLID WHITE
- 6 4" (100) DOUBLE YELLOW (WIDE)
- 7 6" (150) SKIP-DASH (WHITE)
- 8 4" (100) SOLID (WHITE)
- 9 12" (300) DIAGONAL (WHITE)
- 10 6" (150) SOLID (WHITE)
- 11 24" (600) STOP BAR (WHITE)
- 12 8" (200) SOLID (WHITE)
- 13 4" (100) PARKING WHITE

MODEL: Default
 FILE: \\na11e01.pva\uldest-pw-bee\pva.com\PIV\DOT\Documents\DOT Offices\Director_7\Projects\74A88\CADD\Drawings\74A88-Plan.dwg

USER NAME = Jessica.Hille	DESIGNED -	REVISED -
PLOT SCALE = 100,0000 ' / in.	DRAWN -	REVISED -
PLOT DATE = 3/29/2023	CHECKED -	REVISED -
	DATE -	REVISED -

**STATE OF ILLINOIS
DEPARTMENT OF TRANSPORTATION**

PLAN SHEET

SCALE: SHEET OF SHEETS STA. TO STA.

F.A.P. RTE.	SECTION	COUNTY	TOTAL SHEETS	SHEET NO.
95	(6,7)RS-2	EFFINGHAM	46	32
CONTRACT NO. 74A88				
ILLINOIS FED. AID PROJECT				

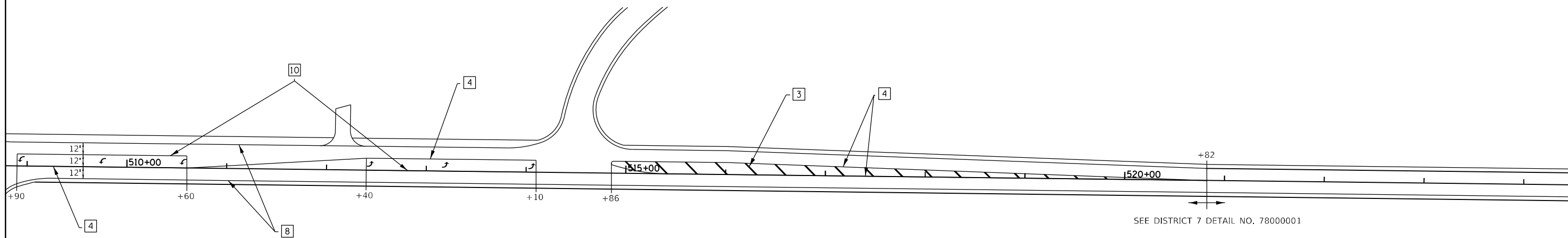
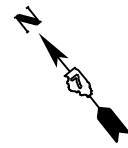

PAVEMENT MARKING LEGEND

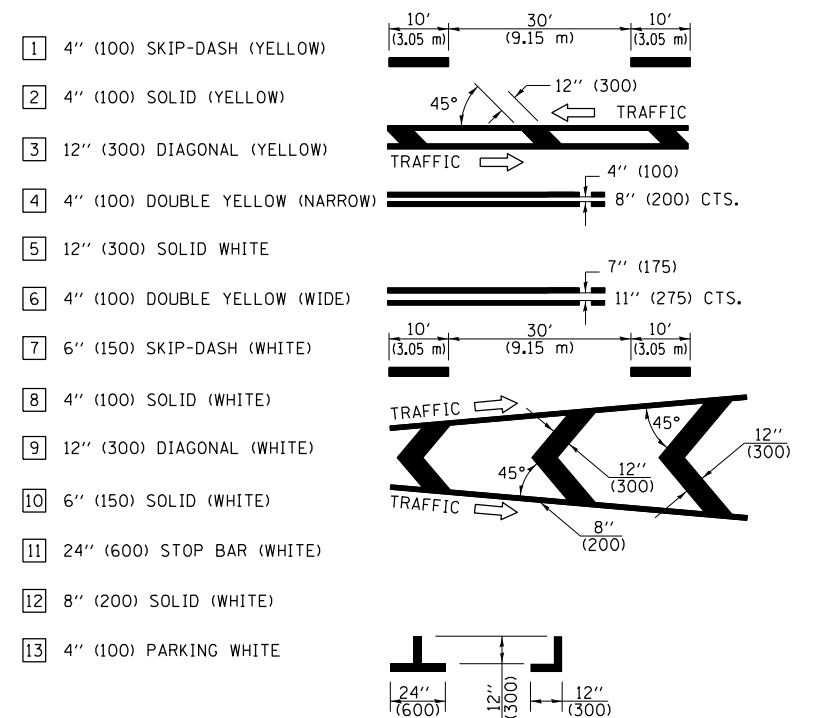

MODEL: Default
 FILE: \\malfp-pw\uldest-pw-beadefw.com\PIV\DOT\Documents\DOT Offices\District 7\Project\74A88\CADD\Drawings\74A88-Plan.dgn

USER NAME = Jessica.Hille	DESIGNED -	REVISED -
	DRAWN -	REVISED -
PLOT SCALE = 100,0000 ' / in.	CHECKED -	REVISED -
PLOT DATE = 3/29/2023	DATE -	REVISED -

**STATE OF ILLINOIS
DEPARTMENT OF TRANSPORTATION**

PLAN SHEET

SCALE: SHEET OF SHEETS STA. TO STA.

F.A.P. RTE.	SECTION	COUNTY	TOTAL SHEETS	SHEET NO.
95	(6,7)RS-2	EFFINGHAM	46	33
CONTRACT NO. 74A88				
ILLINOIS FED. AID PROJECT				

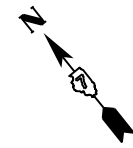

BRIDGE OMISSION
STR# 025-0097

EQUATION:
STO 531+41.06 BK =
STO 531+33.78 AH

MODEL: Default
 FILE: \\mupl-cw-beadley.com\P\W\DOT\Documents\DOT Offices\District 7\Projects\74A88\CADD\DATA\CAD\Sheets\74A88-epc-pln.dgn

USER NAME = Jessica.Hille	DESIGNED -	REVISED -
	DRAWN -	REVISED -
PLOT SCALE = 100,0000' / in.	CHECKED -	REVISED -
PLOT DATE = 3/29/2023	DATE -	REVISED -

STATE OF ILLINOIS
DEPARTMENT OF TRANSPORTATION

PLAN SHEET			
SCALE:	SHEET	OF	SHEETS
	STA.	TO	STA.

F.A.P. RTE.	SECTION	COUNTY	TOTAL SHEETS	SHEET NO.
95	(6,7)RS-2	EFFINGHAM	46	34
			CONTRACT NO. 74A88	
			ILLINOIS FED. AID PROJECT	

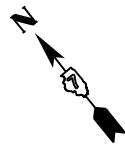

1545+00

1550+00

1555+00

MODEL: Default
FILE NAME: p:\ultra-cw-bea\paw.com\PIV\DOT\Documents\DOT_offices\District_7\Project\74A88\CADD\DATA\CAD\Sheet\74A88-5-Plan.dgn

USER NAME = Jessica.Hille	DESIGNED -	REVISED -
	DRAWN -	REVISED -
PLOT SCALE = 100,0000 ' / in.	CHECKED -	REVISED -
PLOT DATE = 3/29/2023	DATE -	REVISED -

**STATE OF ILLINOIS
DEPARTMENT OF TRANSPORTATION**

PLAN SHEET

SCALE: SHEET OF SHEETS STA. TO STA.

F.A.P. RTE.	SECTION	COUNTY	TOTAL SHEETS	SHEET NO.
95	(6,7)RS-2	EFFINGHAM	46	35
CONTRACT NO. 74A88				
ILLINOIS FED. AID PROJECT				

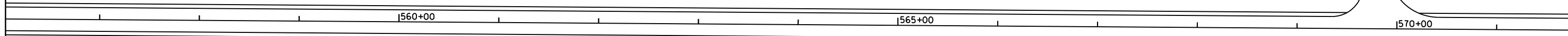
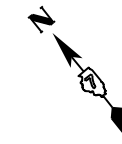

Model: Default
File: \\mlls-pw-bentley.com\PW\DOT\Documents\DOT_offices\District_7\Project\74A88\CADD\DATA\CAD\Sheet\74A88-46-36.dgn

USER NAME = Jessica.Hille	DESIGNED -	REVISED -
	DRAWN -	REVISED -
PLOT SCALE = 100,0000 ' / in.	CHECKED -	REVISED -
PLOT DATE = 3/29/2023	DATE -	REVISED -

**STATE OF ILLINOIS
DEPARTMENT OF TRANSPORTATION**

PLAN SHEET

SCALE: SHEET OF SHEETS STA. TO STA.

F.A.P. RTE.	SECTION	COUNTY	TOTAL SHEETS	SHEET NO.
95	(6,7)RS-2	EFFINGHAM	46	36
CONTRACT NO. 74A88			ILLINOIS FED. AID PROJECT	

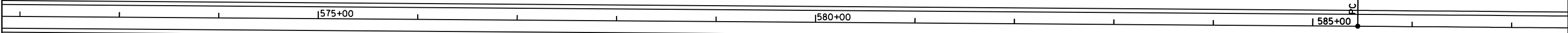

MODEL: Default
FILE: \\mupc-pw-bentley.com\PW\DOT\Documents\DOT_offices\District_7\Project\74A88\CADD\DATA\CAD\Sheet\74A88-45-20.dgn

USER NAME = Jessica.Hille	DESIGNED -	REVISED -
	DRAWN -	REVISED -
PLOT SCALE = 100,0000 ' / in.	CHECKED -	REVISED -
PLOT DATE = 3/29/2023	DATE -	REVISED -

**STATE OF ILLINOIS
DEPARTMENT OF TRANSPORTATION**

PLAN SHEET

SCALE: SHEET OF SHEETS STA. TO STA.

F.A.P. RTE.	SECTION	COUNTY	TOTAL SHEETS	SHEET NO.
95	(6,7)RS-2	EFFINGHAM	46	37
CONTRACT NO. 74A88				
ILLINOIS FED. AID PROJECT				

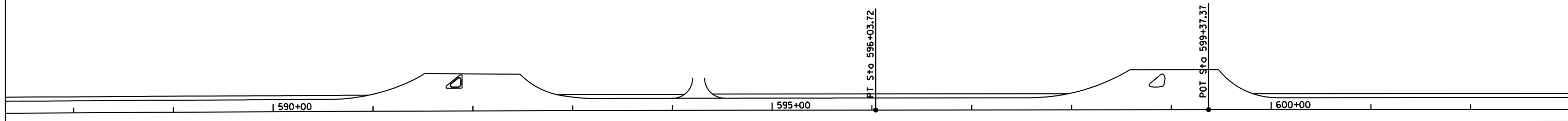
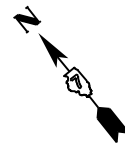

MODEL: Default
 FILE: \\mlls-pw-bentley.com\P\DOT\Documents\DOT_offices\District_7\Projects\74A88\CADD\DATA\CAD\SheetID74A88-sheet.dgn

USER NAME = Jessica.Hille	DESIGNED -	REVISED -
	DRAWN -	REVISED -
PLOT SCALE = 100,0000 ' / in.	CHECKED -	REVISED -
PLOT DATE = 3/29/2023	DATE -	REVISED -

STATE OF ILLINOIS
DEPARTMENT OF TRANSPORTATION

PLAN SHEET

SCALE: SHEET OF SHEETS STA. TO STA.

F.A.P. RTE.	SECTION	COUNTY	TOTAL SHEETS	SHEET NO.
95	(6,7)RS-2	EFFINGHAM	46	38
CONTRACT NO. 74A88			ILLINOIS FED. AID PROJECT	

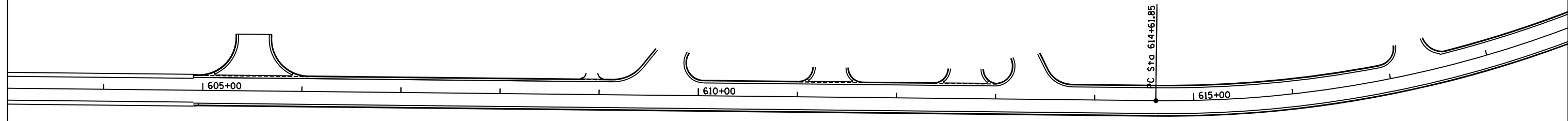
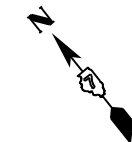

MODEL: Default
 FILE: \\mlls-pw\ulsec-pw-beadley.com\P\W\DOT\Documents\DOT Offices\District 7\Projects\74A88\CADD\DATA\CAD\Sheet\74A88-46-39.dgn

USER NAME = Jessica.Hille	DESIGNED -	REVISED -
	DRAWN -	REVISED -
PLOT SCALE = 100,0000 ' / in.	CHECKED -	REVISED -
PLOT DATE = 3/29/2023	DATE -	REVISED -

STATE OF ILLINOIS
DEPARTMENT OF TRANSPORTATION

PLAN SHEET

SCALE: SHEET OF SHEETS STA. TO STA.

F.A.P. RTE.	SECTION	COUNTY	TOTAL SHEETS	SHEET NO.
95	(6,7)RS-2	EFFINGHAM	46	39
CONTRACT NO. 74A88				
ILLINOIS FED. AID PROJECT				

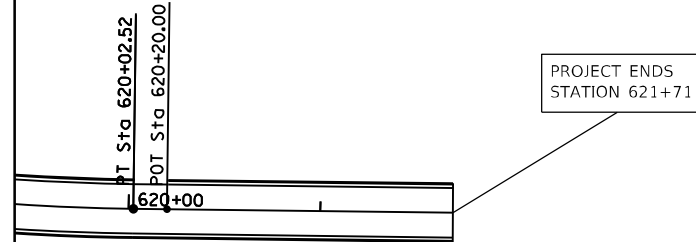

MODEL: Default
FILE: \\mailec-pw-bentley.com\PW\DOT\Documents\DOT Offices\District 7\Projects\74A88\CADD\data\CAD\sheet\74A88-sheet46.dgn

USER NAME = Jessica.Hille	DESIGNED -	REVISED -
	DRAWN -	REVISED -
PLOT SCALE = 100,0000 ' / in.	CHECKED -	REVISED -
PLOT DATE = 3/29/2023	DATE -	REVISED -

**STATE OF ILLINOIS
DEPARTMENT OF TRANSPORTATION**

PLAN SHEET	
SCALE:	SHEET OF SHEETS STA. TO STA.

F.A.P. RTE.	SECTION	COUNTY	TOTAL SHEETS	SHEET NO.
95	(6.7)RS-2	EFFINGHAM	46	40
CONTRACT NO. 74A88				
ILLINOIS FED. AID PROJECT				

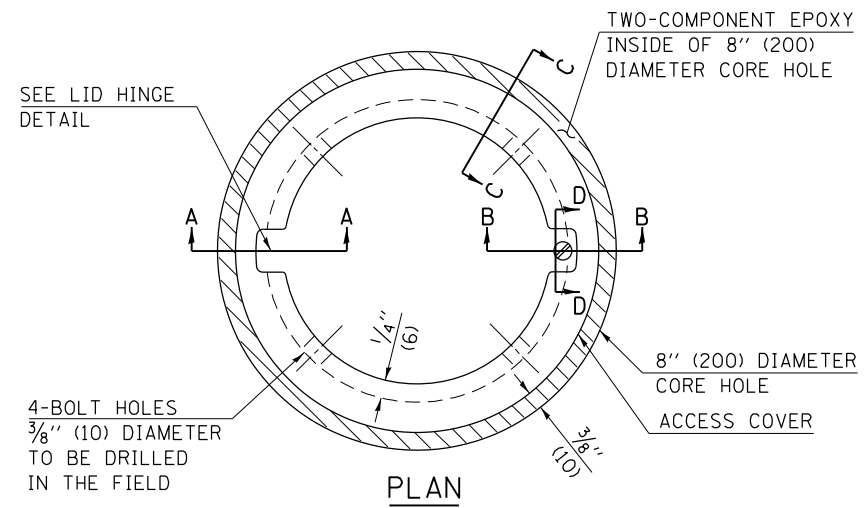

LEGEND

- ALUMINUM CASTING

- 5" (125) OR 6" (150) P.V.C. PIPE

- TWO-COMPONENT EPOXY

T = THICKNESS OF PAVEMENT STRUCTURE

H = THE THICKNESS OF THE SUB-BASE GRANULAR + 1" (25)

BILL OF MATERIAL

ALUMINUM CASTING OF THE DIMENSIONS AND SPECIFICATIONS SHOWN OR OTHER SUBJECT TO ENGINEER'S APPROVAL OF SHOP DRAWINGS, 4 EACH - 5/16" X 2" (M8 X 50) BOLTS WITH NUTS, EPOXY, 5" OR 6" (125 mm OR 150 mm) DIAMETER P.V.C. PIPE, SCHEDULE 40 (WHEN REQUIRED).

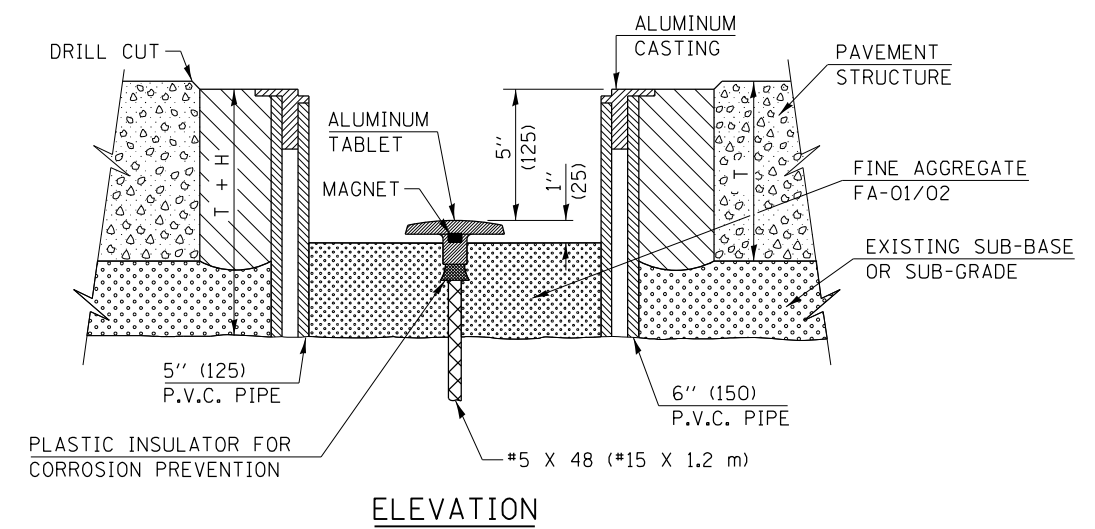
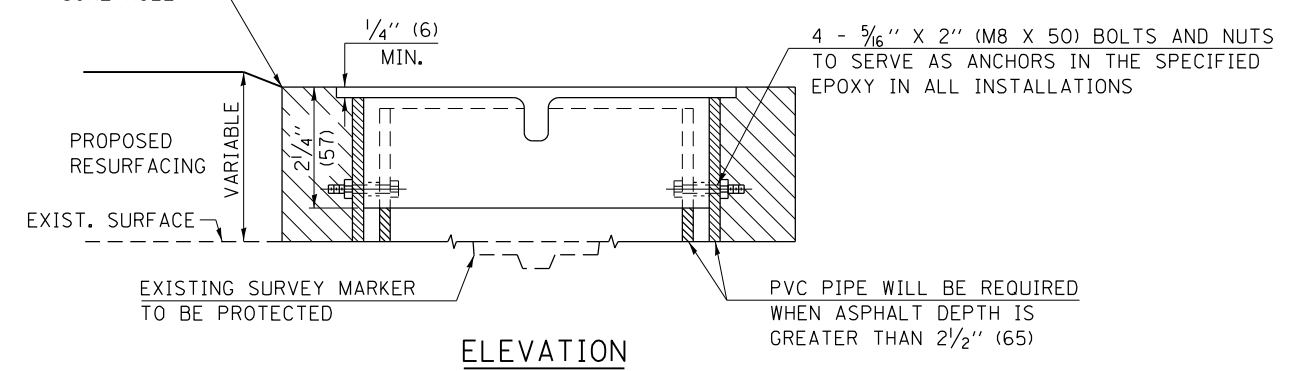
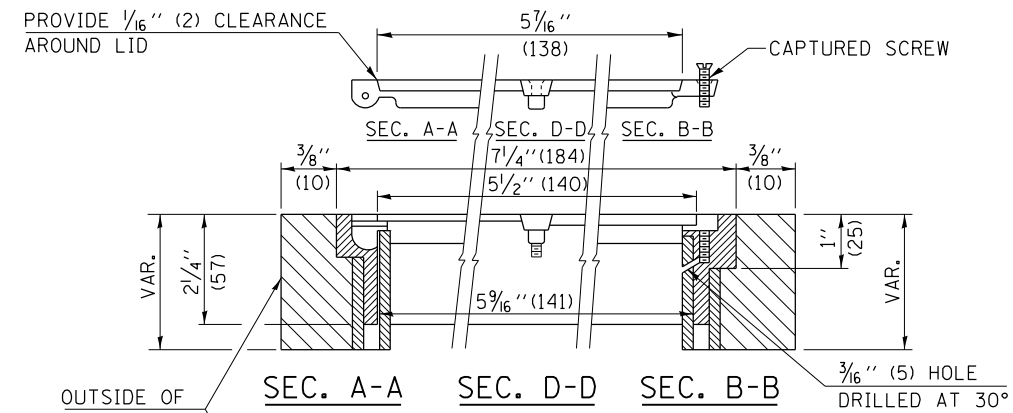
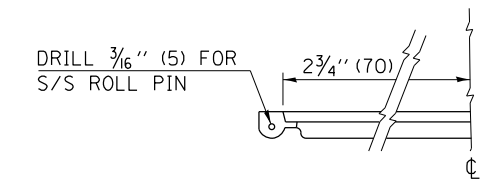
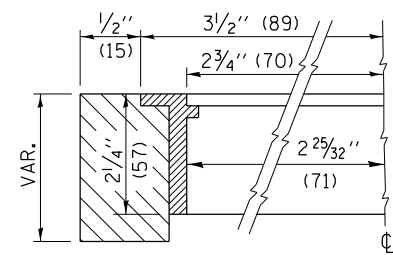

NOT TO SCALE

Note: All dimensions are in INCHES (millimeters) unless otherwise shown.

FILE NAME =	USER NAME = Jessica.Hille	DESIGNED -	REVISED - MAD 6-11
p:\dot-pw.bentley.com\PIWIDOT\Documents\DOT Offices\District 7\Projects\74488\CADD\Drawings\Drawings\74488-shd-details.dgn		CHECKED -	REVISED -
PLOT SCALE = 40.0000' / in.		DATE -	REVISED -
PLOT DATE = 3/29/2023			

STATE OF ILLINOIS
DEPARTMENT OF TRANSPORTATION

SURVEY MARKER VAULT			
SCALE: N/A	SHEET NO. 1 OF 1 SHEETS	STA.	TO STA.

DISTRICT 7 DETAIL NO. 20070202				
F.A.P. RTE.	SECTION	COUNTY	TOTAL SHEETS	SHEET NO.
95	(6,7)RS-2	EFFINGHAM	46	41
CONTRACT NO. 74488				
FED. ROAD DIST. NO. ILLINOIS FED. AID PROJECT				

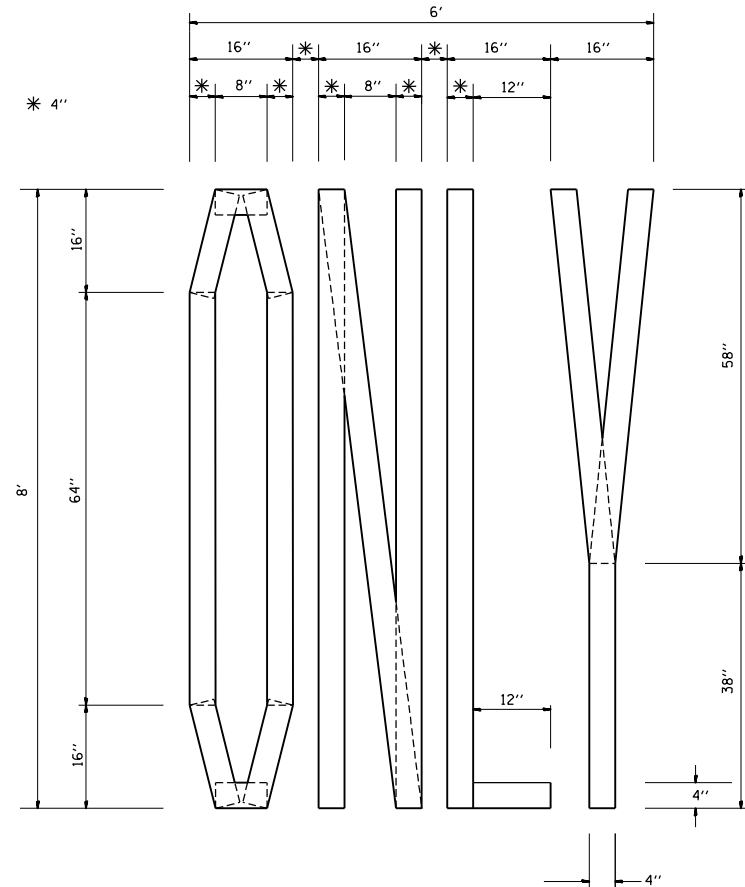

QUANTITY
 4" LINE = 63.2 ft.
 21.0 sq. ft.

SHORT TERM STOP BAR

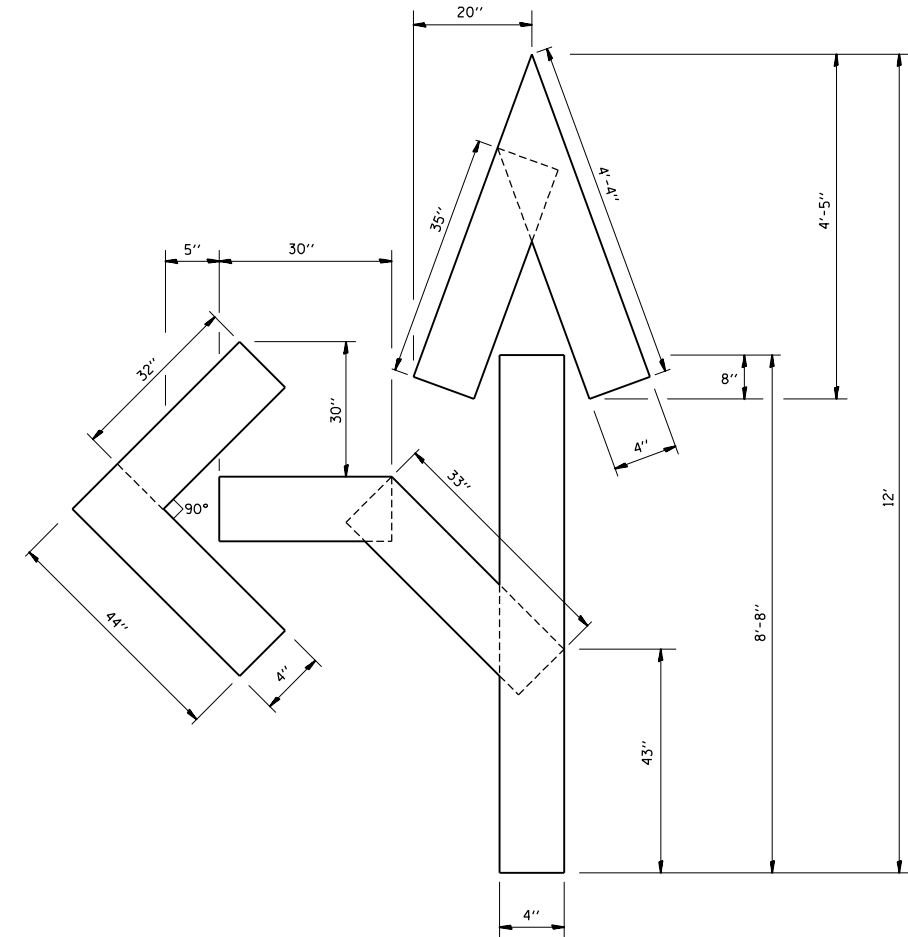

QUANTITY
 4" LINE = 27.5 ft.
 9.2 sq. ft.

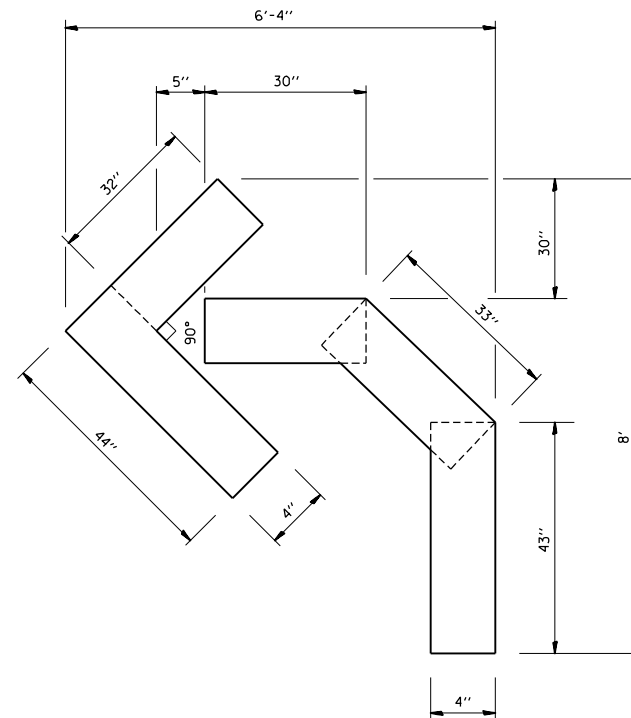

QUANTITY
 4" LINE = 15.2 ft.
 5.0 sq. ft.

MODEL: Default
 FILE: M:\MFC_Plan\Subect-pw-bead-fay.com\FW\DOT\Documents\DOT_Offices\Dir\drf_7\Project\74A88\CADD\DATA\CAD\Sheet\74A88-ht-decal.dgn

USER NAME = Jessica.Hille	DESIGNED -	REVISED -
PLOT SCALE = 40,0000 * / in.	DRAWN -	REVISED -
PLOT DATE = 3/29/2023	CHECKED -	REVISED -
	DATE -	REVISED -

STATE OF ILLINOIS
 DEPARTMENT OF TRANSPORTATION

PAVEMENT MARKING LETTERS AND SYMBOLS
 FOR TRAFFIC STAGING

SCALE: SHEET OF SHEETS STA. TO STA.

F.A.P. RTE.	SECTION	COUNTY	TOTAL SHEETS	SHEET NO.
95	(6,7)RS-2	EFFINGHAM	46	42
CONTRACT NO. 74A88				
ILLINOIS FED. AID PROJECT				

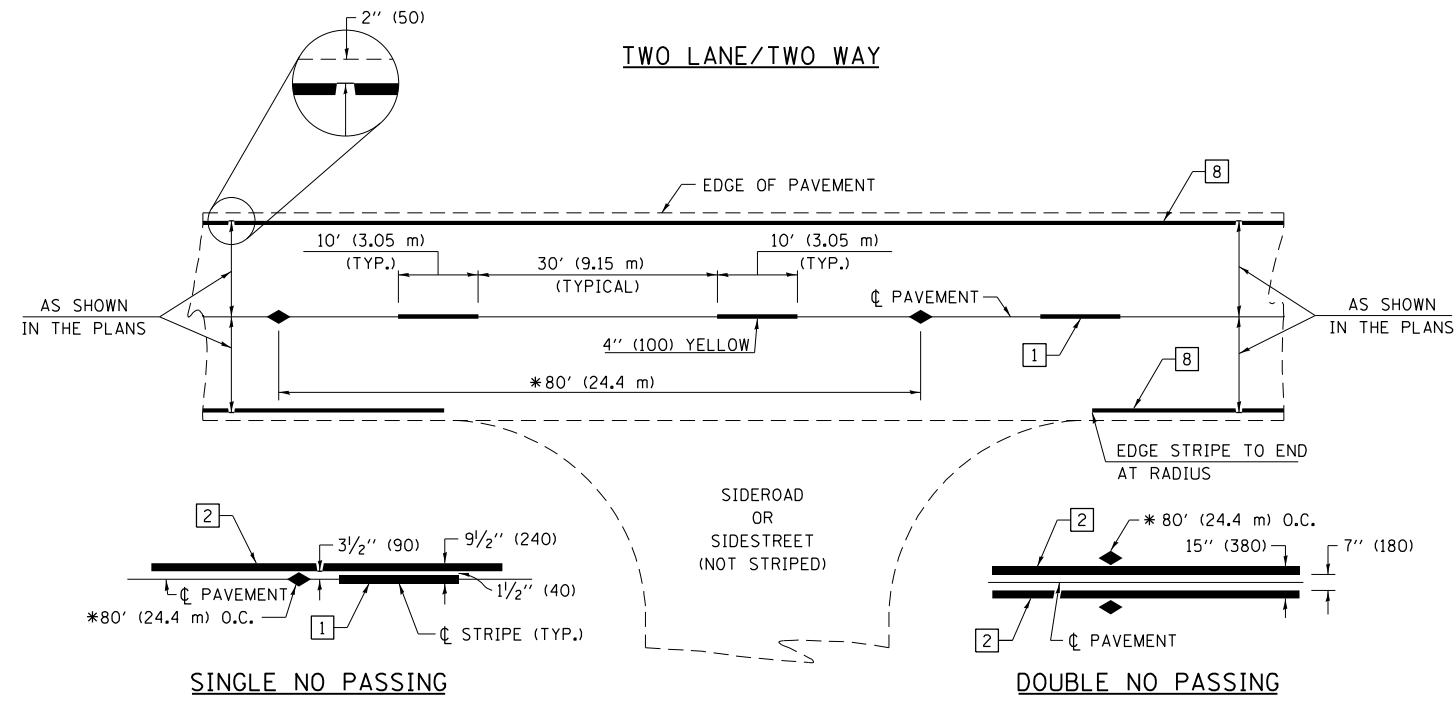

* REDUCE TO 40' (12.2 m) O.C. ON CURVES WITH POSTED OR ADVISORY SPEEDS OF 45 mph (70 km/h) OR LESS.

PAVEMENT MARKING LEGEND

- 1 4" (100) SKIP-DASH (YELLOW)
 - 2 4" (100) SOLID (YELLOW)
 - 3 12" (300) DIAGONAL (YELLOW)
 - 4 4" (100) DOUBLE YELLOW (NARROW)
 - 5 12" (300) SOLID WHITE
 - 6 RESERVED
 - 7 6" (150) SKIP-DASH (WHITE)
 - 8 4" (100) SOLID (WHITE)
 - 9 12" (300) DIAGONAL (WHITE)
 - 10 6" (150) SOLID (WHITE)
 - 11 24" (600) STOP BAR (WHITE)
 - 12 8" (200) SOLID (WHITE)
 - 13 4" (100) PARKING WHITE
-

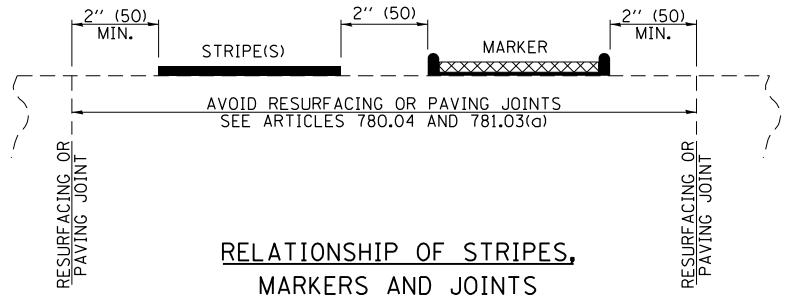

TYPICAL PAVEMENT MARKERS LEGEND

- ◆ TWO-WAY AMBER MARKER
- ▶ ONE-WAY AMBER MARKER
- ▷ ONE-WAY CRYSTAL MARKER

RAISED REFLECTIVE PAVEMENT MARKERS

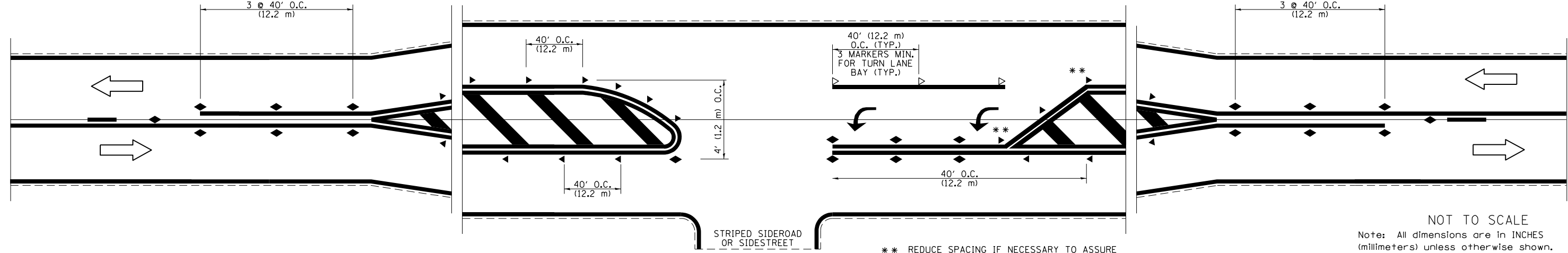

** REDUCE SPACING IF NECESSARY TO ASSURE MARKERS AT CORNER POINTS.

NOT TO SCALE
Note: All dimensions are in INCHES (millimeters) unless otherwise shown.

DISTRICT 7 DETAIL NO. 78000001

MODEL: Default FILE NAME: p:\p\dist-cw-benefy.com\FW\DOT\Documents\DOT Office\Director_7\Project\7488\CADD\Drawings\7488-Details\7488-Details.dgn

USER NAME = Jessica.Hille	DESIGNED -	REVISOR -
DRAWN -	REVISIONS -	
PLOT SCALE = 40,0000 */ in.	CHECKED -	REVISIONS -
PLOT DATE = 3/29/2023	DATE -	REVISIONS -

STATE OF ILLINOIS
DEPARTMENT OF TRANSPORTATION

PAVEMENT MARKING AND RAISED REFLECTIVE PAVEMENT MARKERS
(RURAL & URBAN APPLICATIONS)

SCALE: SHEET 1 OF 4 SHEETS STA. TO STA.

F.A.P. RTE.	SECTION	COUNTY	TOTAL SHEETS	SHEET NO.
95	(6,7)RS-2	EFFINGHAM	46	43
CONTRACT NO. 74A88				
ILLINOIS FED. AID PROJECT				

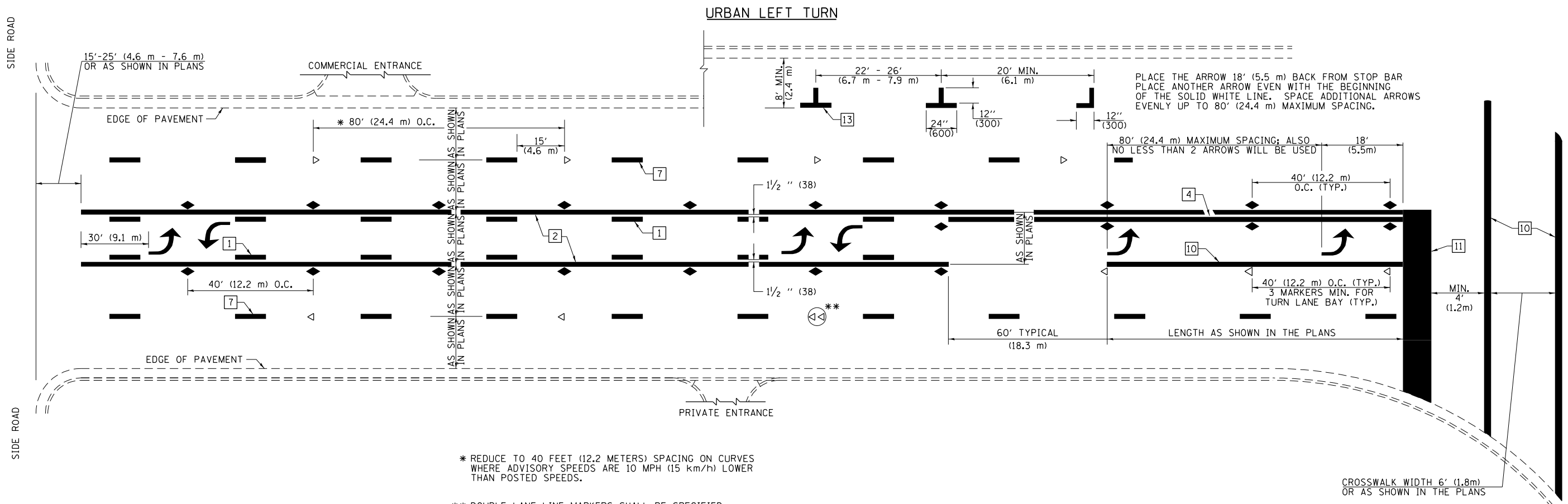

- * REDUCE TO 40 FEET (12.2 METERS) SPACING ON CURVES WHERE ADVISORY SPEEDS ARE 10 MPH (15 km/h) LOWER THAN POSTED SPEEDS.
- ** DOUBLE LANE LINE MARKERS SHALL BE SPECIFIED AND SPACED AS SHOWN IN HIGHWAY STANDARD 781001 FOR MULTI-LANE DIVIDED AND UNDIVIDED HIGHWAYS.

PAVEMENT MARKING LEGEND

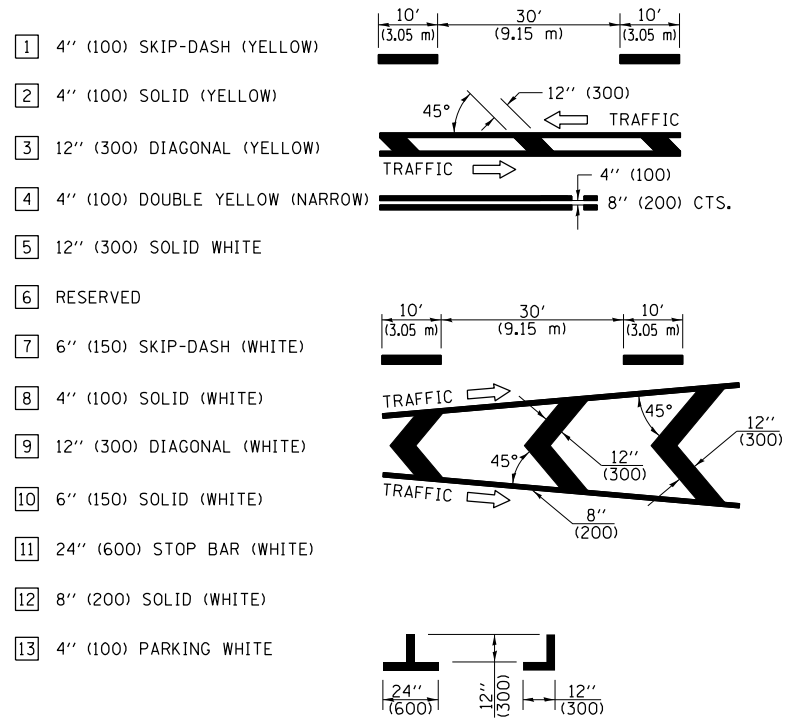

GENERAL NOTES

1. TURN ARROW PAIRS SHALL BE PLACED AT 250' (75 m) INTERVALS AND SHALL BE EVENLY SPACED BETWEEN BOTH ENDS OF THE BIDIRECTIONAL LEFT TURN LANE. USE A MINIMUM OF TWO PAIRS PER BLOCK.
2. THE SOLID YELLOW PAVEMENT MARKINGS [2] SHOULD GENERALLY START OR END NEAR THE RADIUS POINT OF EACH STREET RETURN EXCEPT WHERE ONE OR BOTH ENDS WOULD INCLUDE STOP BARS.
3. THE SKIP-DASH PAVEMENT MARKINGS [1] OR [7] SHOULD BE CENTERED BETWEEN BOTH ENDS OF EACH CITY BLOCK AND SHALL BE PLACED SO THEY LINE UP ACROSS FROM EACH OTHER.
4. USE LARGE ARROW SIZE FOR BOTH RURAL AND URBAN LOCATIONS. (SEE LAST PAGE OF SECTION 780x FOR SYMBOLS TABLE)
5. LANE LINE EXTENSIONS SHALL BE THE SAME COLOR AND WIDTH AS THE LANE LINE BEING EXTENDED.
6. ALL WHITE SKIP-DASH LINES SHALL BE 6'' IN WIDTH.

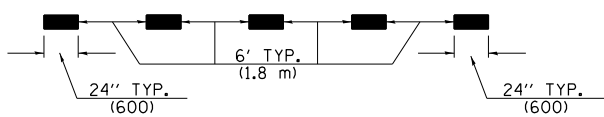

LANE LINE EXTENSIONS

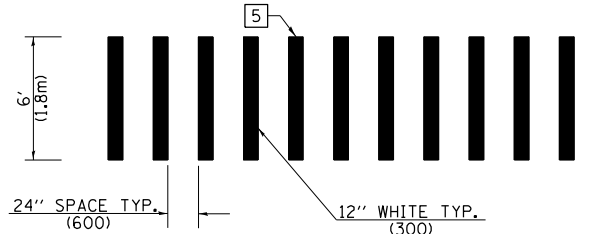

CROSSWALK DETAIL (DECATUR CITY LIMITS ONLY)

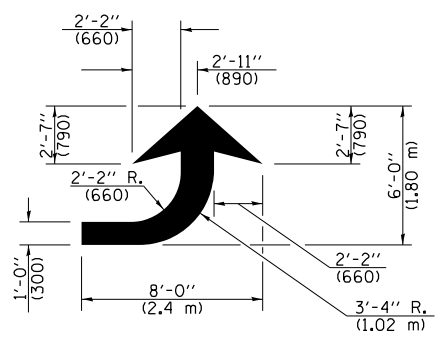

LEFT ARROW

REVERSE FOR RIGHT ARROW
AREA = 15.6 SQ. FT. (1.47 m²)
(WHITE)

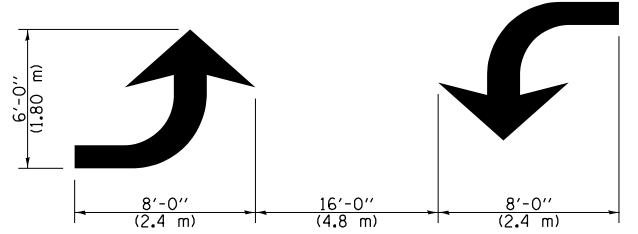

TYPICAL DOUBLE TURN ARROWS (WHITE)

NOT TO SCALE

Note: All dimensions are in INCHES (millimeters) unless otherwise shown.

DISTRICT 7 DETAIL NO. 7800001

USER NAME = Jessica.Hille	DESIGNED -	REVISED -
PLOT SCALE = 40,0000 * 1/ in.	DRAWN -	REVISED -
PLOT DATE = 3/29/2023	CHECKED -	REVISED -
	DATE -	REVISED -

**STATE OF ILLINOIS
DEPARTMENT OF TRANSPORTATION**

**PAVEMENT MARKING AND RAISED REFLECTIVE PAVEMENT MARKERS
(RURAL & URBAN APPLICATIONS)**

F.A.P. RTE.	SECTION	COUNTY	TOTAL SHEETS	SHEET NO.
95	(6,7)RS-2	EFFINGHAM	46	44
CONTRACT NO. 74A88				
ILLINOIS FED. AID PROJECT				

SCALE: SHEET 2 OF 4 SHEETS STA. TO STA.

MODEL: Default FILE NAME: p:\p\dist-new-beadefw.com\p\INDOT\Documents\DOT Office\Director_7\Project\74A88\CADD\Drawings\74A88-48-01.dgn

ISLAND

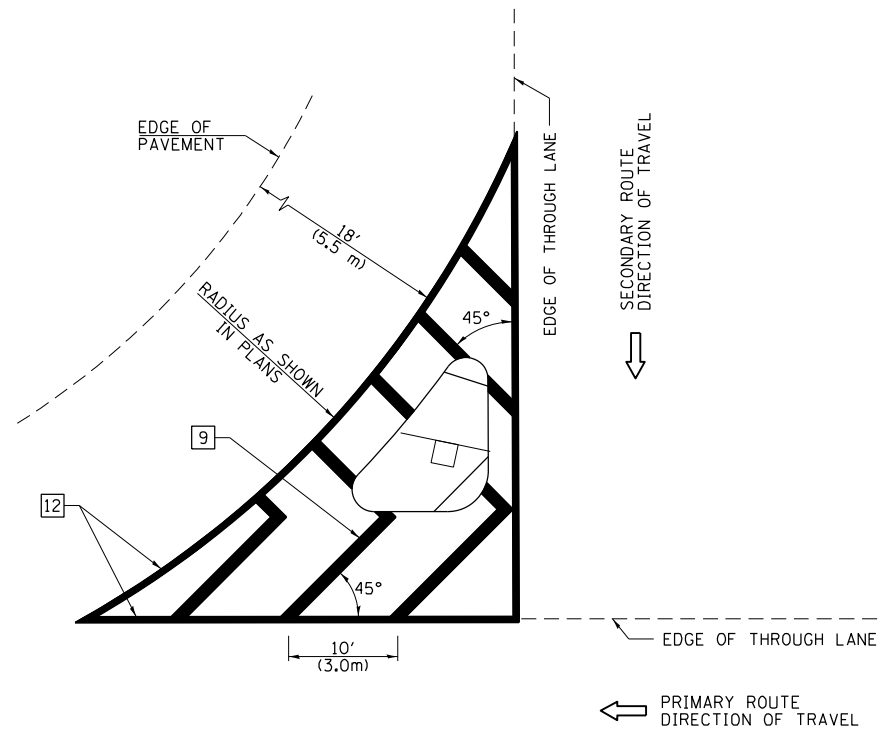

GENERAL NOTES

1. RAISED AND CORRUGATED MEDIANS SHALL BE OUTLINED WITH [2] IF PRESENT.
2. SOME OF THE INFORMATION INCLUDED WITH THIS DETAIL MAY NOT BE APPLICABLE TO THIS IMPROVEMENT.
3. PAVEMENT MARKINGS ARE TO BE EXTENDED THROUGH OMISSIONS WHEN APPLICABLE.
4. FINAL PAVEMENT MARKINGS SHALL BE IN PLACE PRIOR TO PLACING ANY RAISED REFLECTIVE PAVEMENT MARKERS.
5. THE FOLLOWING CRITERIA SHALL BE USED FOR SELECTING THE DIAGONAL PAVEMENT MARKING SPACING:

< 30 MPH (< 50 km/h)	15' (4.5 m)
30-45 MPH (50-75 km/h)	20' (6.0 m)
> 45 MPH (> 75 km/h)	30' (9.0 m)

PAVEMENT MARKING LEGEND

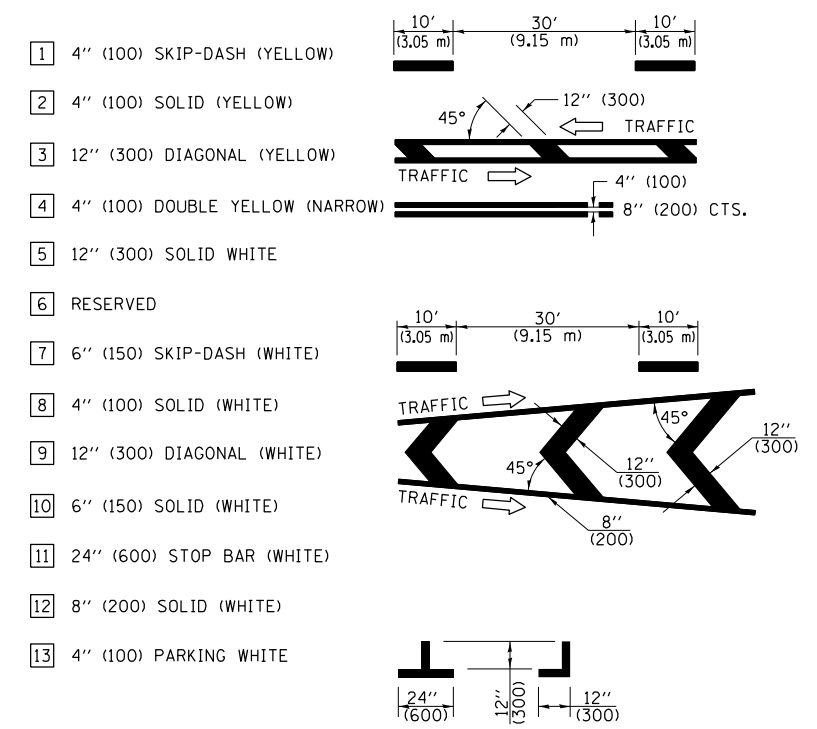

RURAL LEFT TURN STRIPING

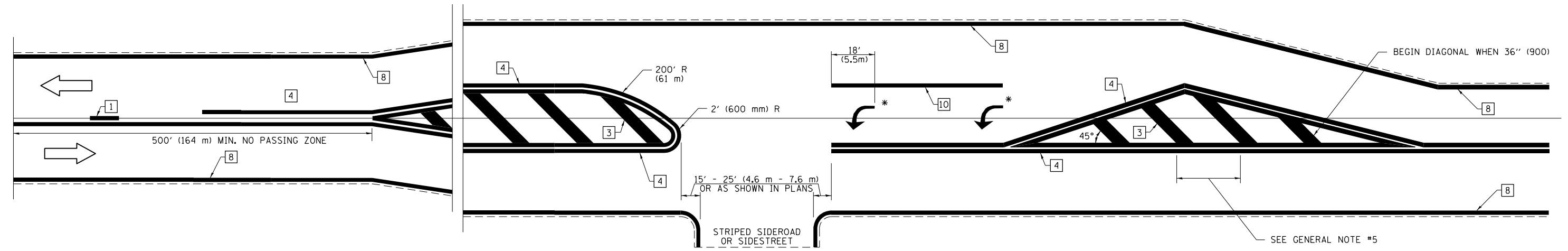

* PLACE AN ARROW 18' (5.5 m) BACK FROM STOP BAR. PLACE ANOTHER ARROW EVEN WITH THE BEGINNING OF THE SOLID WHITE LINE. SPACE ADDITIONAL ARROWS EVENLY UP TO 80' (24.4 m) MAXIMUM SPACING. USE MINIMUM OF 2 ARROWS.

NOT TO SCALE

Note: All dimensions are in INCHES (millimeters) unless otherwise shown.

DISTRICT 7 DETAIL NO. 7800001

MODEL: Default
FILE: \\naafpc-pw-bentley.com\P\INDOT\Documents\DOT Office\Dir\dir_7\Project\74A88\CADD\DATA\CAD\Project\74A88\Sheet\Detail.dgn

USER NAME = Jessica.Hille	DESIGNED -	REVISED -
PLOT SCALE = 40,0000 */ in.	DRAWN -	REVISED -
PLOT DATE = 3/29/2023	CHECKED -	REVISED -
	DATE -	REVISED -

STATE OF ILLINOIS
DEPARTMENT OF TRANSPORTATION

PAVEMENT MARKING AND RAISED REFLECTIVE PAVEMENT MARKERS
(RURAL & URBAN APPLICATIONS)

SCALE: SHEET 3 OF 4 SHEETS STA. TO STA.

F.A.P. RTE.	SECTION	COUNTY	TOTAL SHEETS	SHEET NO.
95	(6.7)RS-2	EFFINGHAM	46	45
CONTRACT NO. 74A88				
ILLINOIS FED. AID PROJECT				

PAVEMENT MARKINGS AT RAILROAD-HIGHWAY GRADE CROSSING

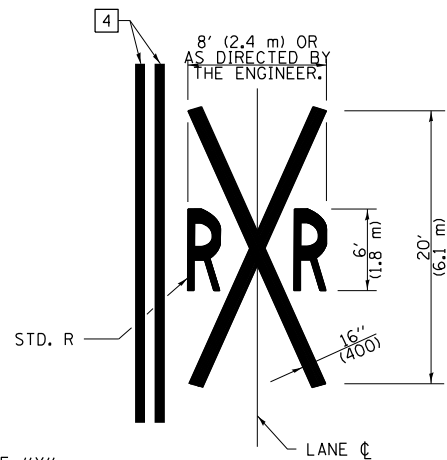
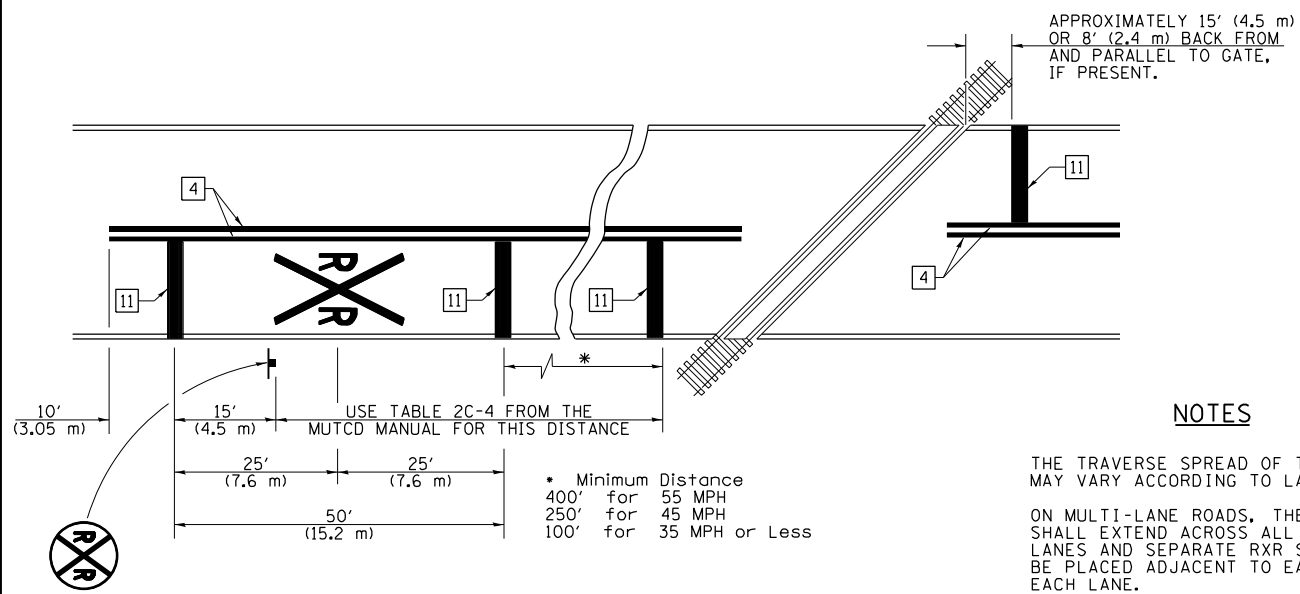

NOTES

THE TRAVERSE SPREAD OF THE "X" MAY VARY ACCORDING TO LANE WIDTH.

ON MULTI-LANE ROADS, THE STOP LINES SHALL EXTEND ACROSS ALL APPROACH LANES AND SEPARATE RXR SYMBOLS SHALL BE PLACED ADJACENT TO EACH OTHER IN EACH LANE.

WHEN THE PAVEMENT MARKING SYMBOL IS USED, A PORTION OF THE SYMBOL SHOULD BE LOCATED DIRECTLY ADJACENT TO THE ADVANCE WARNING SIGN (W10-1) AS PLACED BY TABLE II-1, CONDITION B OF THE MUTCD.

PAVEMENT MARKING LEGEND

- 1 4" (100) SKIP-DASH (YELLOW)
 - 2 4" (100) SOLID (YELLOW)
 - 3 12" (300) DIAGONAL (YELLOW)
 - 4 4" (100) DOUBLE YELLOW (NARROW)
 - 5 12" (300) SOLID WHITE
 - 6 RESERVED
 - 7 6" (150) SKIP-DASH (WHITE)
 - 8 4" (100) SOLID (WHITE)
 - 9 12" (300) DIAGONAL (WHITE)
 - 10 6" (150) SOLID (WHITE)
 - 11 24" (600) STOP BAR (WHITE)
 - 12 8" (200) SOLID (WHITE)
 - 13 4" (100) PARKING WHITE
-

RAILROAD CROSSING WITH INTERCONNECT ONLY

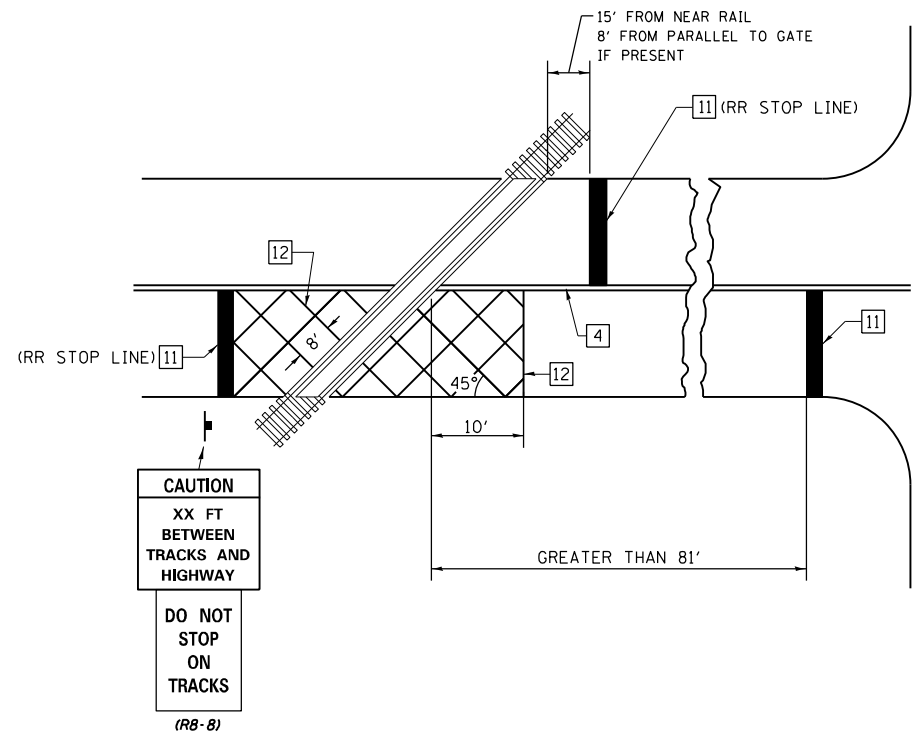

RAILROAD CROSSING WITH INTERCONNECT AND PRE-SIGNALS

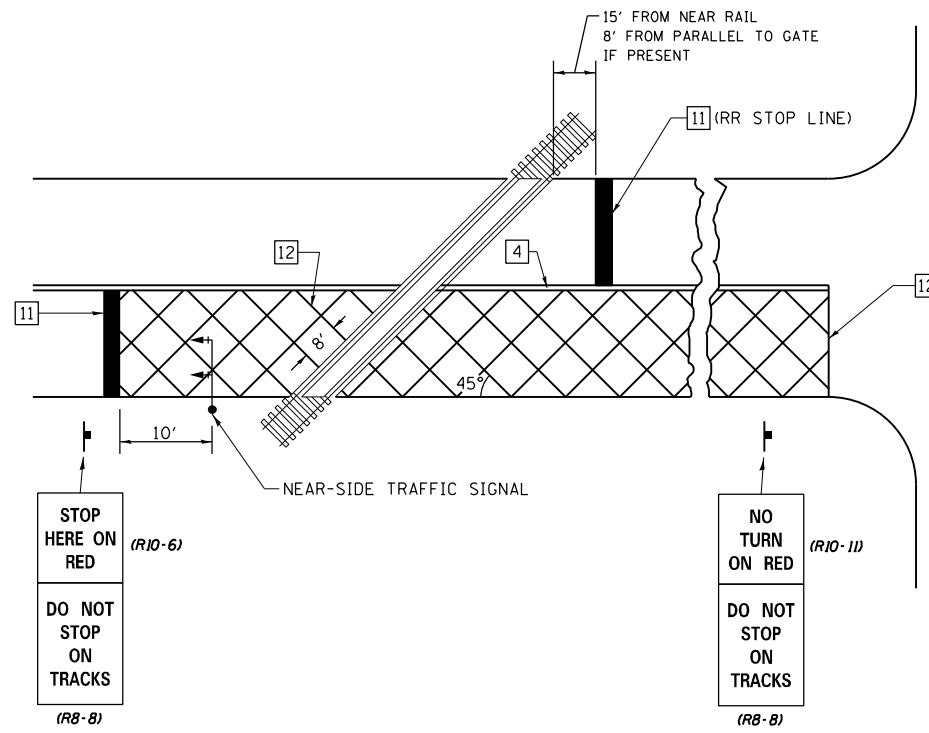

SUPPLEMENTAL PAVEMENT MARKING TREATMENT FOR RAILROAD-HIGHWAY GRADE CROSSING

GENERAL NOTES

1. SUPPLEMENTAL PAVEMENT MARKINGS TO BE INSTALLED ONLY ON APPROACHES TO INTERSECTIONS CONTROLLED BY TRAFFIC SIGNALS WHICH ARE INTERCONNECTED WITH THE RAILROAD WARNING SIGNALS.
2. EXTEND PAVEMENT MARKINGS TO THE INTERSECTION ONLY WHERE NEAR-SIDE TRAFFIC SIGNALS ARE USED.

NOT TO SCALE

Note: All dimensions are in INCHES (millimeters) unless otherwise shown.

DISTRICT 7 DETAIL NO. 7800001

STATE OF ILLINOIS
DEPARTMENT OF TRANSPORTATION

PAVEMENT MARKING AND RAISED REFLECTIVE PAVEMENT MARKERS
(RURAL & URBAN APPLICATIONS)

USER NAME = Jessica.Hille	DESIGNED -	REVISED -
PLOT SCALE = 40,0000 * / in.	DRAWN -	REVISED -
PLOT DATE = 3/29/2023	CHECKED -	REVISED -
	DATE -	REVISED -

F.A.P. RTE.	SECTION	COUNTY	TOTAL SHEETS	SHEET NO.
95	(6.7)RS-2	EFFINGHAM	46	46
CONTRACT NO. 74A88				
ILLINOIS FED. AID PROJECT				

SCALE: SHEET 4 OF 4 SHEETS STA. TO STA.