

STATE OF ILLINOIS
DEPARTMENT OF TRANSPORTATION

F.A.I. RTE.	SECTION	COUNTY	TOTAL SHEETS	SHEET NO.
70	3-5CJS-1	BOND	6	1
		ILLINOIS	CONTRACT NO. 76R38	

FOR INDEX OF SHEETS, SEE SHEET NO. 2

PROPOSED HIGHWAY PLANS

FAI ROUTE 70 (I-70)
SECTION 3-5CJS-1
PROJECT NHPP-3R97(460)
CRACK & JOINT SEALING
BOND COUNTY

C-98-092-22

TRAFFIC DATA

2018: 3050 (ACTUAL)
2023: 3100 (ESTIMATED)
2024: 3500 (ESTIMATED)
SU = 3.6% MU = 3.6%

D-98-060-22



BEGIN PROJECT
STA. 2778 + 74.10
LAT: 38.88410
LONG: 89.33641

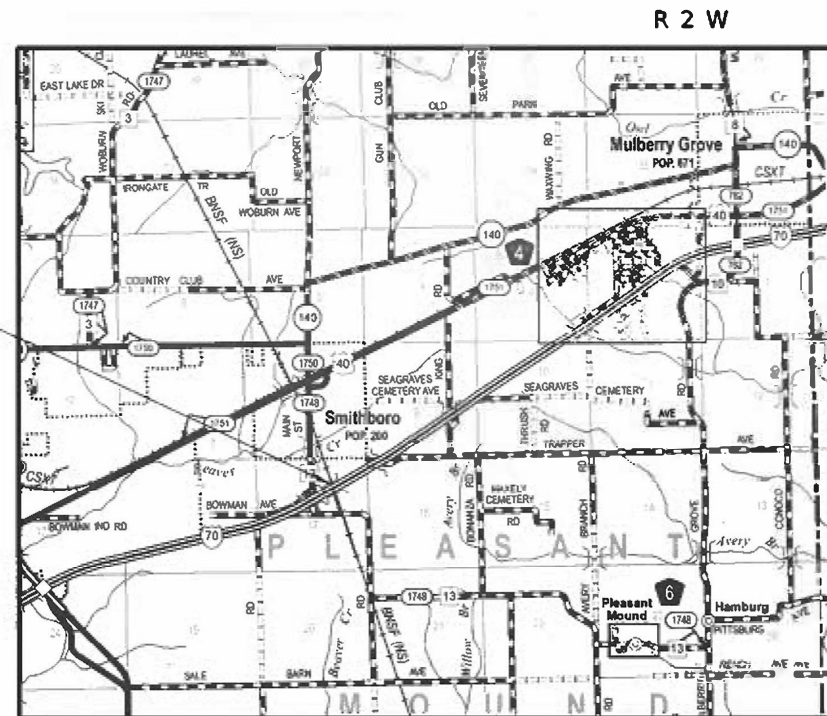

END PROJECT
STA 3308 + 69.57
LAT: 38.916397
LONG: 89.256714

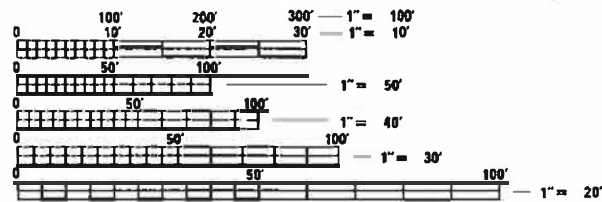

FULL SIZE PLANS HAVE BEEN PREPARED USING STANDARD ENGINEERING SCALES. REDUCED SIZED PLANS WILL NOT CONFORM TO STANDARD SCALES. IN MAKING MEASUREMENTS ON REDUCED PLANS, THE ABOVE SCALES MAY BE USED.

J.U.L.I.E.
JOINT UTILITY LOCATION INFORMATION FOR EXCAVATORS
1-800-892-0123
OR 811

PROJECT ENGINEER: BILLIE OWEN
PROJECT MANAGER: MIKE BERG

GROSS LENGTH = 25,511 FT. = 4.83 MILE
NET LENGTH = 25,511 FT. = 4.83 MILE

CONTRACT NO. 76R38

STATE OF ILLINOIS
DEPARTMENT OF TRANSPORTATION

SUBMITTED MARCH 10 2023

REGIONAL ENGINEER

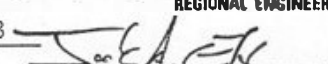
May 12, 2023 
ENGINEER OF DESIGN AND ENVIRONMENT

May 12, 2023 
DIRECTOR OF HIGHWAYS PROJECT IMPLEMENTATION

PRINTED BY THE AUTHORITY
OF THE STATE OF ILLINOIS

INDEX OF SHEETS

- 1 COVER SHEET
- 2 INDEX OF SHEETS, HIGHWAY STANDARDS, GENERAL NOTES & COMMITMENTS
- 3 SUMMARY OF QUANTITIES
- 4 TYPICALS
- 5 SCHEDULE OF QUANTITIES
- 6 CRACK AND JOINT SEALING DETAIL

- 2. TWO CHANGEABLE MESSAGE SIGNS SHALL BE PLACED 14 DAYS IN ADVANCE OF CONSTRUCTION AND 14 DAYS DURING CONSTRUCTION. EXACT LOCATION OF CHANGEABLE SIGNS SHALL BE DETERMINED BY THE ENGINEER.
- 3. NO SURVEY WAS PERFORMED FOR THIS PROJECT. PLANS WERE CREATED USING MICROFILM AND FIELD MEASUREMENTS.
- 4. ESTIMATED CRACK FILLING APPLICATION RATE: 0.4 LB/FT

HIGHWAY STANDARDS

- 000001-08 STANDARD SYMBOLS, ABBREVIATIONS, AND PATTERNS
- 001006 DECIMAL OF AN INCH AND OF A FOOT
- 701426-09 LANE CLOSURE MULTI-LANE, INTERMITTENT OR MOVING OPER. FOR SPEEDS ≥ 45 MPH
- 701901-08 TRAFFIC CONTROL DEVICES

GENERAL NOTES

- 1. UTILITIES KNOWN TO HAVE FACILITIES WITHIN THE PROJECT AREA:

	<u>ABOVE GROUND</u>	<u>BELOW GROUND</u>
AMEREN ILLINOIS	X	X
AT&T ILLINOIS	X	X
FRONTIER COMMUNICATIONS	X	X
DEPT. OF CENTRAL MANAGEMENT SERVICES	X	X
CITY OF GREENVILLE		X
VILLAGE OF SMITHBORO		X
SOUTHWESTERN ELECTRIC COOPERATIVE, INC.	X	X

COMMITMENTS

NONE

REV. - MS

MODEL: 4\MODEL\MNF5
 FILE: Mnf5.plt
 PLOT DATE: 3/9/2023
 I:\Projects\0876938\CADD\DATA\CAD\Sheets\0876938-ht-plan.dgn

USER NAME = Default	DESIGNED - _____	REVISED - _____	STATE OF ILLINOIS DEPARTMENT OF TRANSPORTATION	INDEX OF SHEETS, HIGHWAY STANDARDS, GENERAL NOTES & COMMITMENTS	F.A.I. RTE.	SECTION	COUNTY	TOTAL SHEETS	SHEET NO.
PLOT SCALE = 100.0000' / in.	DRAWN - _____	REVISED - _____			70	3-5CJA-1		6	2
PLOT DATE = 3/9/2023	CHECKED - _____	REVISED - _____			CONTRACT NO. 76R38				
	DATE - _____	REVISED - _____			ILLINOIS FED. AID PROJECT				
				SCALE: _____	SHEET 1 OF 1 SHEETS		STA. _____ TO STA. _____		

90% FED
10% STATE

CONSTR. CODE

CODE NO.	ITEM	UNIT	TOTAL QUANTITY	CONSTR. CODE	
				ROADWAY	RURAL
45100100	CRACK ROUTING (PAVEMENT)	FOOT	165753	0005	165753
45100200	CRACK FILLING	POUND	66301		66301
67100100	MOBILIZATION	L SUM	1		1
70107025	CHANGEABLE MESSAGE SIGN	CAL DA	28		28
X7010216	TRAFFIC CONTROL AND PROTECTION, (SPECIAL)	L SUM	1		1

MODEL: \\MODEL\MAME
FILE: \\MAILS\paul@illinois.gov\Public\paw_beaufay.com\P\W\DOT\Documents\DOT_Offices\Dir\dr. B\Project\0876838\CAD\Drawings\CAD\Drawings\0876838-Sub-Plan.dgn

USER NAME = Default	DESIGNED - _____	REVISED - _____
	DRAWN - _____	REVISED - _____
PLOT SCALE = 100,0000' / in.	CHECKED - _____	REVISED - _____
PLOT DATE = 3/9/2023	DATE - _____	REVISED - _____

**STATE OF ILLINOIS
DEPARTMENT OF TRANSPORTATION**

**INDEX OF SHEETS, HIGHWAY STANDARDS,
GENERAL NOTES & COMMITMENTS**

SCALE: _____ SHEET 1 OF 1 SHEETS STA. _____ TO STA. _____

F.A.I. RTE.	SECTION	COUNTY	TOTAL SHEETS	SHEET NO.
70	3-5CJA-1	BOND	6	2
CONTRACT NO. 76R38				
ILLINOIS FED. AID PROJECT				

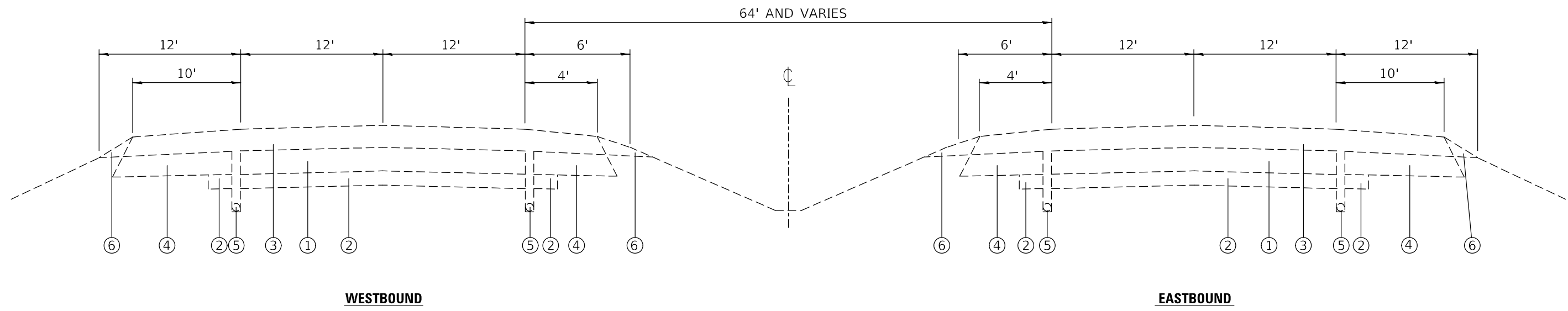

TYPICAL SECTION F.A.I. 70
EAST APPROACH OF THE B.N. RAILROAD TO THE FAYETTE COUNTY LINE
STA. 2778 + 74.10 TO STA. 3033 + 85.00

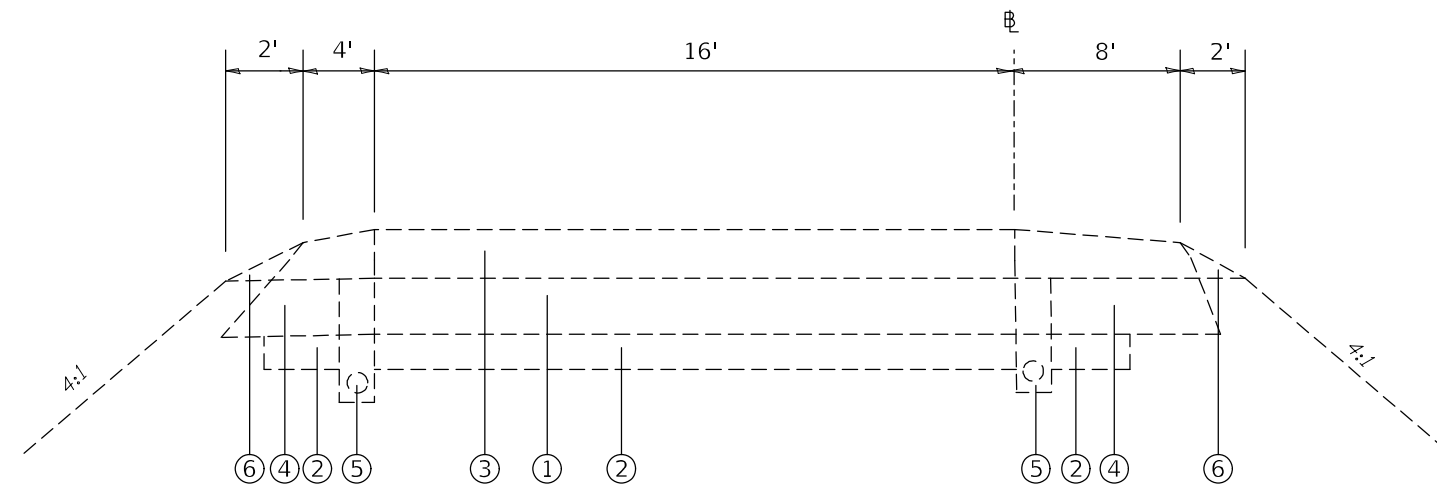

RAMP TYPICAL SECTION
RAMP I, II, III, IV - (CH 10, SN 003-0036)

LEGEND

- ① EXISTING CONTINUOUSLY REINFORCED PORTLAND CEMENT CONCRETE PAVEMENT, 8"
- ② EXISTING STABILIZED SUB-BASE, 4"
- ③ EXISTING HOT-MIX ASPHALT RESURFACING, VARIES 4"-8"
- ④ EXISTING STABILIZED SHOULDERS, 8" MIN.
- ⑤ EXISTING PIPE UNDERDRAINS (SHOWN OFFSET FOR CLARITY)
- ⑥ EXISTING AGGREGATE SHOULDERS

MODEL: \\MODELS\MAME
 FILE: NAME: 3033+85.00\Bentley.com\PLINT\DOT\Documents\DOT Office\Dir\dr: 8\Project\0876838\CADD\Drawings\CAD\Sheet\0876838-ct-10n.dgn

USER NAME = Default	DESIGNED - _____	REVISED - _____
	DRAWN - _____	REVISED - _____
PLOT SCALE = 100,0000' / in.	CHECKED - _____	REVISED - _____
PLOT DATE = 3/9/2023	DATE - _____	REVISED - _____

STATE OF ILLINOIS
DEPARTMENT OF TRANSPORTATION

EXISTING TYPICAL
SECTIONS

SCALE: _____ SHEET _____ OF _____ SHEETS STA. _____ TO STA. _____

F.A.I. RTE. 70	SECTION 3-5CJ5-1	COUNTY BOND	TOTAL SHEETS 6	SHEET NO. 4
CONTRACT NO. 76R38			ILLINOIS FED. AID PROJECT	

SCHEDULE								
LOCATION			LENGTH	LONGITUDINAL CRACKS EDGE LINES	LONGITUDINAL CRACKS CENTERLINE	TRANSVERSE CRACKS	CRACK ROUTING	CRACK FILLING
							FT	FT
2778+74.00	TO	3033+85.00	25511	102044.00	51022.00	9276.73	162342.73	64,937.09
RAMP I - WB EXIT								
03+03.15	TO	07+52.40	449.25	898.50			898.50	359.40
RAMP II - EB ENTRANCE								
11+75.41	TO	16+00.41	425.00	850.00			850.00	340.00
RAMP III - EB EXIT								
03+03.15	TO	07+52.40	449.25	898.50			898.50	359.40
RAMP IV - WB ENTRANCE								
07+49.97	TO	11+31.46	381.49	762.98			762.98	305.19
							165753	66301

MODEL: I:\MODEL\MMF5
 FILE: MMF5.dwg
 PLOT DATE: 3/9/2023
 PROJECT: I:\PROJECT\DOT\DOT Documents\DOT Office\Dir\Dir: E:\Project\DOT\DOT\DOT\CAD\CAD Data\CAD Sheets\DOT76R38-Sub-Plan.dwg

USER NAME = Default	DESIGNED - _____	REVISED - _____
PLOT SCALE = 100,0000' / in.	DRAWN - _____	REVISED - _____
PLOT DATE = 3/9/2023	CHECKED - _____	REVISED - _____
	DATE - _____	REVISED - _____

STATE OF ILLINOIS
DEPARTMENT OF TRANSPORTATION

CRACK & JOINT SEALING DETAIL			
SCALE: NTS	SHEET 1 OF 1 SHEETS	STA. _____	TO STA. _____

F.A.I. RTE.	SECTION	COUNTY	TOTAL SHEETS	SHEET NO.
70	3-5CJS-1	BOND	6	5
CONTRACT NO. 76R38				
ILLINOIS FED. AID PROJECT				

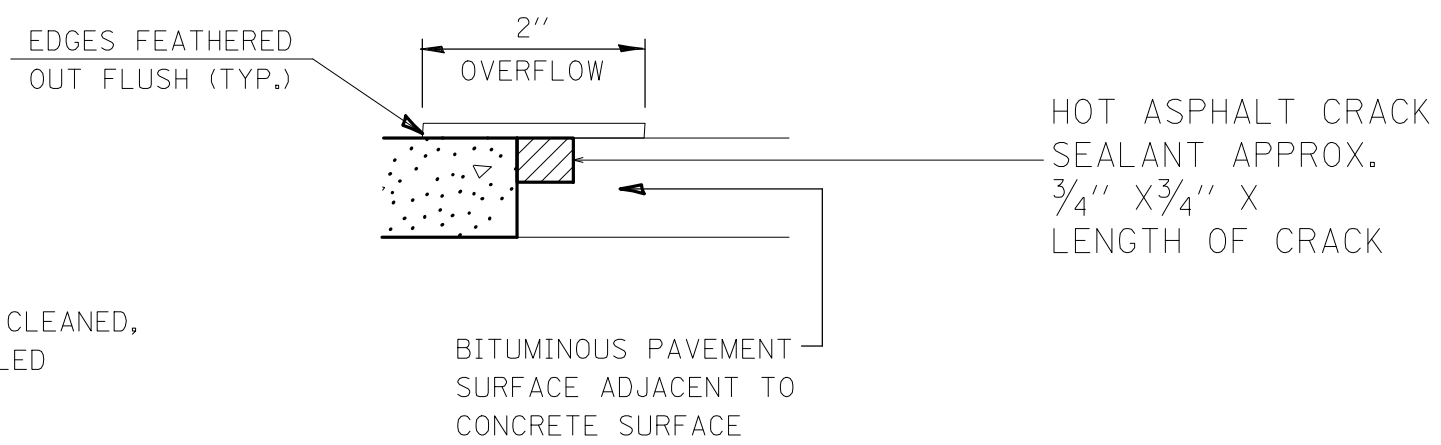
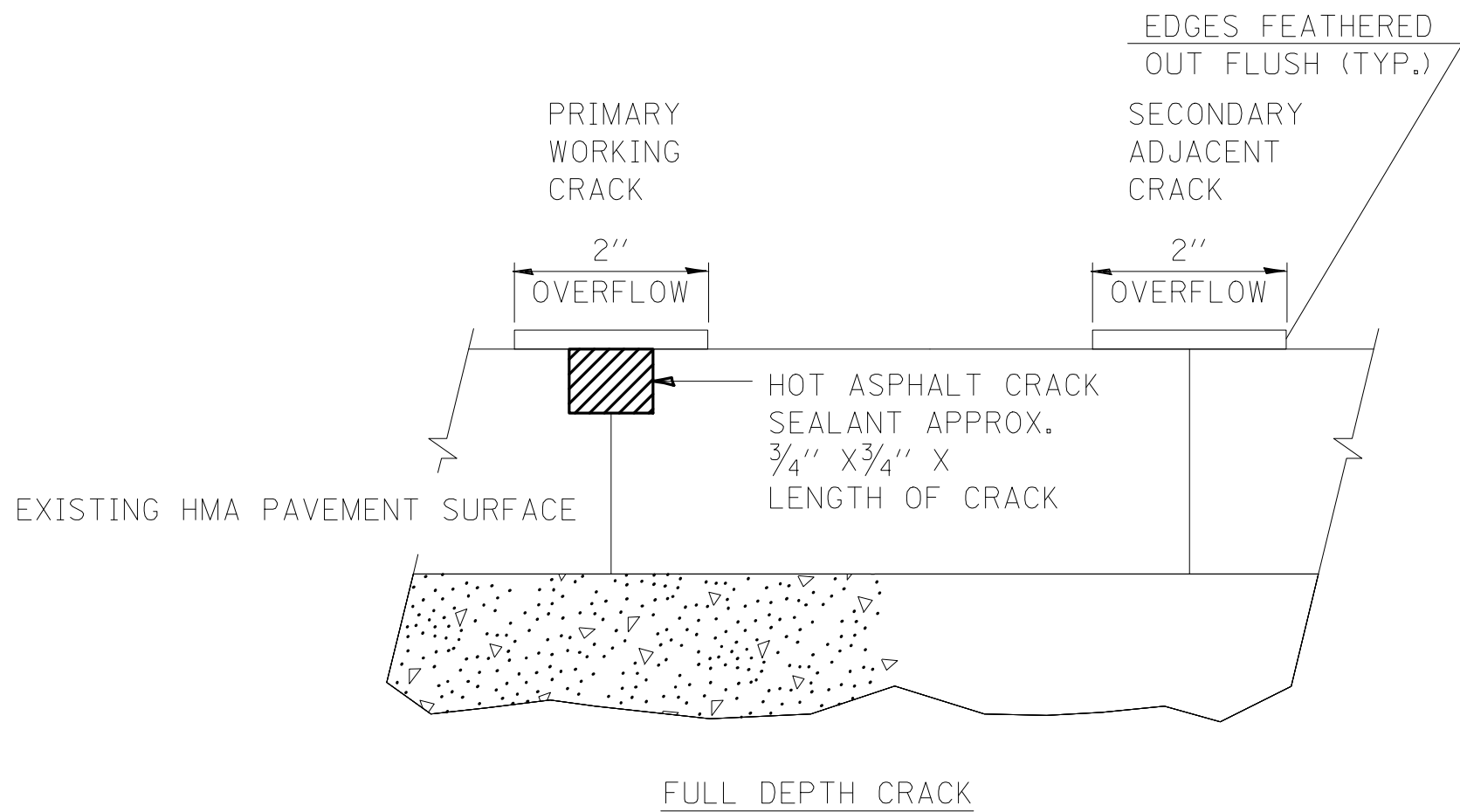

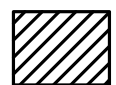
 ROUTED, CLEANED,
AND SEALED

TRANSVERSE/LONGITUDINAL JOINT

MODEL: I:\MODEL\MHFE
FILE: MHFE.dwg
PROJECT: I:\PROJECTS\DOT\Office\Drawings\Project\DOT\Drawings\CADD\Drawings\Sheet\DOT76R38.ctb

USER NAME = Default	DESIGNED - _____	REVISED - _____
	DRAWN - _____	REVISED - _____
PLOT SCALE = 100,0000' / in.	CHECKED - _____	REVISED - _____
PLOT DATE = 3/9/2023	DATE - _____	REVISED - _____

STATE OF ILLINOIS
DEPARTMENT OF TRANSPORTATION

CRACK & JOINT SEALING DETAIL

SCALE: NTS SHEET 1 OF 1 SHEETS STA. _____ TO STA. _____

F.A.I. RTE.	SECTION	COUNTY	TOTAL SHEETS	SHEET NO.
70	3-5CJS-1	BOND	6	6
CONTRACT NO. 76R38				
ILLINOIS FED. AID PROJECT				