

STATE OF ILLINOIS  
DEPARTMENT OF TRANSPORTATION

F.A.P. RTE.	SECTION	COUNTY	TOTAL SHEETS	SHEET NO.
VAR	D-4 BRIDGE PAINTING 2023	VARIOUS	113	1
		ILLINOIS	CONTRACT NO. 68H58	

1 COVER SHEET  
2 GENERAL NOTES  
3-5 SUMMARY OF QUANTITIES  
6 TRAFFIC CONTROL & PROTECTION  
7-8 SCHEDULE OF QUANTITIES  
9 LOCATION MAP & DESCRIPTION, LOCATION 1  
10 LOCATION MAP & DESCRIPTION, LOCATION 2 LOCATION 3 & LOCATION 4  
11 DESCRIPTION, LOCATION 3 & LOCATION 4  
12 DESCRIPTION, LOCATION 5  
13 LOCATION MAP & DESCRIPTION, LOCATION 6  
14 LOCATION MAP & DESCRIPTION, LOCATION 7  
15 LOCATION MAP & DESCRIPTION, LOCATION 8 LOCATION 9 & LOCATION 10  
16 DESCRIPTION, LOCATION 9 & LOCATION 10  
17 LOCATION MAP & DESCRIPTION, LOCATION 11  
18 LOCATION MAP & DESCRIPTION, LOCATION 12 ;LOCATION 13 & LOCATION 14  
19 DESCRIPTION, LOCATION 13 & LOCATION 14  
20-23 LOCATION #1 STRUCTURE DETAILS  
24-31 LOCATION #2 STRUCTURE DETAILS  
32-38 LOCATION #3 STRUCTURE DETAILS  
39-43 LOCATION #4 STRUCTURE DETAILS  
44-48 LOCATION #5 STRUCTURE DETAILS  
49-59 LOCATION #6 STRUCTURE DETAILS  
60-66 LOCATION #7 STRUCTURE DETAILS  
67-73 LOCATION #8 STRUCTURE DETAILS  
74-79 LOCATION #9 STRUCTURE DETAILS  
80-87 LOCATION #10 STRUCTURE DETAILS  
88-94 LOCATION #11 STRUCTURE DETAILS  
95-101 LOCATION #12 STRUCTURE DETAILS  
102-105 LOCATION #13 STRUCTURE DETAILS  
106-113 LOCATION #14 STRUCTURE DETAILS

**PROPOSED  
HIGHWAY PLANS**

**VARIOUS ROUTES  
SECTION D4 BRIDGE PAINTING 2023  
PROJECT STP-AEWR(180)  
BRIDGE PAINTING  
VARIOUS COUNTIES**

C-94-041-23

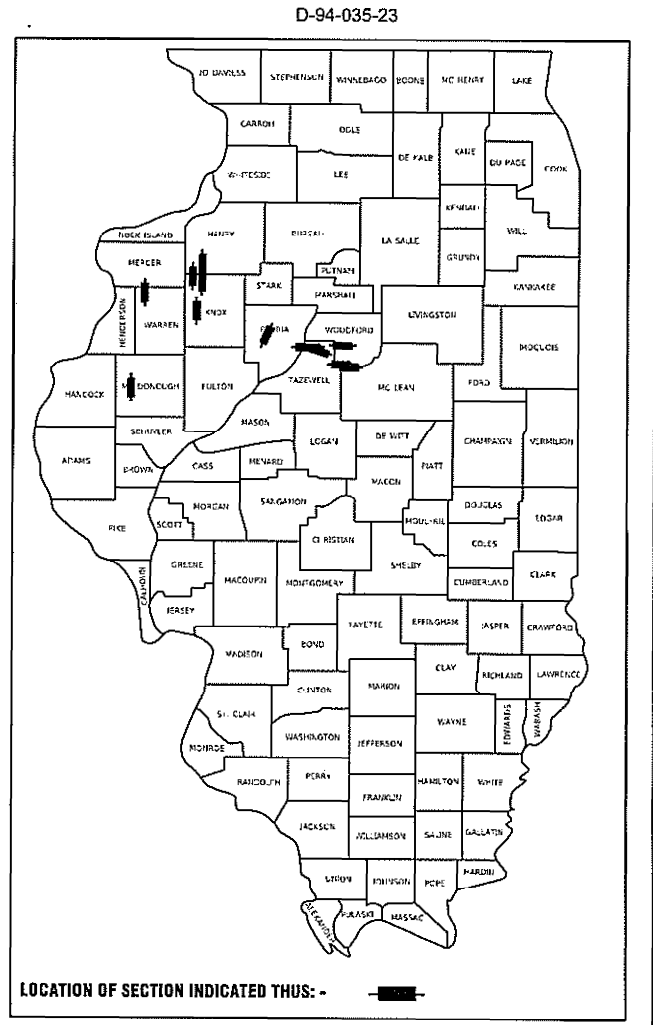

**HIGHWAY STANDARDS**

000001-08 STANDARD SYMBOLS, ABBREVIATIONS AND PATTERNS  
701001-02 OFF-ROAD OPERATIONS, 2L, 2W, MORE THAN 15' (4.5 m) AWAY  
701006-05 OFF-ROAD OPERATIONS, 2L, 2W, 15' (4.5 m) TO 24" (600 mm) FROM PAVEMENT EDGE  
701101-05 OFF-ROAD OPERATIONS, MULTILANE, 15' (4.5 m) TO 24" (600 mm) FROM PAVEMENT EDGE  
701106-02 OFF-ROAD OPERATIONS, MULTILANE, MORE THAN 15' (4.5 m) AWAY  
701206-05 LANE CLOSURE, 2L, 2W: NIGHT ONLY, FOR SPEEDS > 45 MPH  
701321-18 LANE CLOSURE, 2L, 2W: BRIDGE REPAIR WITH BARRIER  
701400-11 APPROACH TO LANE CLOSURE, FREEWAY/EXPRESSWAY  
701402-12 LANE CLOSURE, FREEWAY/EXPRESSWAY, WITH BARRIER  
701411-09 LANE CLOSURE, MULTILANE, AT ENTRANCE OR EXIT RAMP, FOR SPEEDS > 45  
701423-10 LANE CLOSURE, MULTILANE: WITH BARRIER, FOR SPEEDS > 45 MPH TO 55 MPH  
701456-05 PARTIAL EXIT RAMP CLOSURE FREEWAY/EXPRESSWAY  
701601-09 URBAN LANE CLOSURE, MULTILANE, 1W OR 2W WITH NONTRAVERSABLE MEDIAN  
701701-10 URBAN LANE CLOSURE, MULTILANE INTERSECTION  
701901-06 TRAFFIC CONTROL DEVICES  
704001-08 TEMPORARY CONCRETE BARRIER  
701431-05 RAMP CLOSURE FREEWAY/EXPRESSWAY

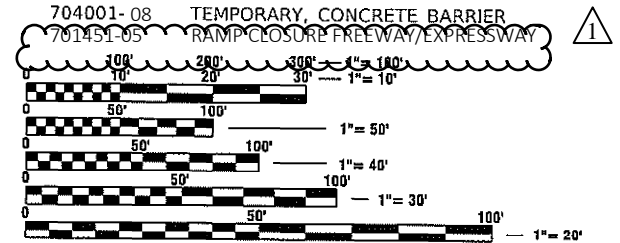

FULL SIZE PLANS HAVE BEEN PREPARED USING STANDARD ENGINEERING SCALES. REDUCED SIZED PLANS WILL NOT CONFORM TO STANDARD SCALES. IN MAKING MEASUREMENTS ON REDUCED PLANS, THE ABOVE SCALES MAY BE USED.

J.U.L.I.E.  
JOINT UTILITY LOCATION INFORMATION FOR EXCAVATORS  
1-800-892-0123  
OR 811

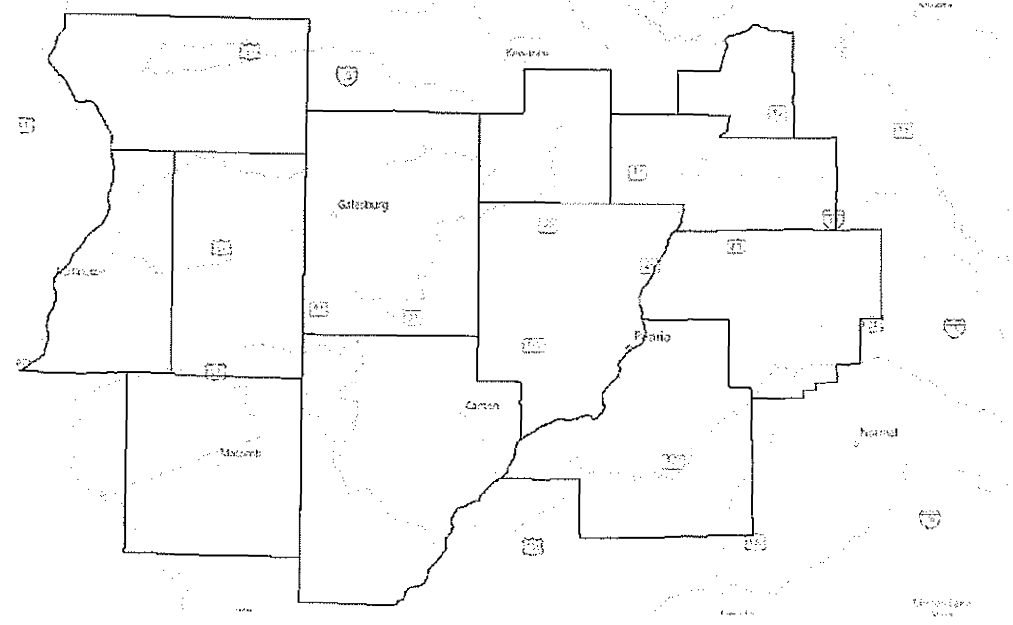

**PROJECT DESCRIPTION:**

**PAINTING OF VARIOUS STRUCTURES  
IN DISTRICT 4**

STATE OF ILLINOIS  
DEPARTMENT OF TRANSPORTATION

SUBMITTED March 22, 2023  
Naxiel E. Barnette, Inc.  
REGIONAL ENGINEER

May 12, 2023 [Signature]  
ENGINEER OF DESIGN AND ENVIRONMENT

May 12, 2023 [Signature]  
DIRECTOR OF HIGHWAYS PROJECT IMPLEMENTATION

**PROJECT ENGINEER: MARK ECKHOFF (309)573-8753**  
**PROJECT MANAGER: BYRON SMITH (309)573-8753**  
**CATALOG NO. 036384-00D**  
**CONTRACT NO. 68H58**

Mark C. Lee 3/21/2023  
MARK C. LEE DATE  
REGISTERED PROFESSIONAL ENGINEER  
STATE OF ILLINOIS NO. 062-060864  
LICENSE EXPIRES NOVEMBER 30, 2023

**KLINGNER  
& ASSOCIATES, P.C.**  
Engineers • Architects • Surveyors  
www.klingner.com  
Galesburg, Illinois  
49 North Prairie Street 309.342.4042  
Quincy, IL Hannibal, MO  
Burlington, IA Peella, IA Columbia, MO  
Davenport, IA Carbonado, IL  
DESIGN FIRM NO. 184-2738

**PRINTED BY THE AUTHORITY  
OF THE STATE OF ILLINOIS**

# TRAFFIC CONTROL & PROTECTION

Location	Structure	Direction	Stage	70100207 TC&P Std. 701402 Each	no pay item TC&P Std. 701400 not measured for payment included with 701402	70400100 Temp Conc Barrier Foot	70400200 Relocate Temp Conc Barrier Foot	70600250 Impact Atten Test Level 3 Each	70600350 Relocate Imp Att. TL 3 Each	70100325 TC&P Std 701423 Each	70100420 TC&P Std 701411 Each	70100825 TC&P Std. 701456 L.Sum	70102630 TC&P Std. 701601 L.Sum	70102635 TC&P Std. 701701 L.Sum	70106500 TC&P Std. 701321 Each	70100820 TC&P Std. 701451 Each	70107025 Changeable Message Sign Cal Day	
# 1	037-0105	EB	I	1.0		300	-	1.0	-	-	-	-	-	-	-	-	-	7 day advance notice
		EB	II	-	on I-74 EB	-	150	-	1.0	-	-	-	-	-	-	-	-	-
	037-0105	WB	I	1.0		300	-	1.0	-	-	-	-	-	-	-	-	-	7 day advance notice
		WB	II	-	on I-74 WB	-	150	-	1.0	-	-	-	-	-	-	-	-	7 day advance notice
# 2	048-0010	EB	I	-	on I-74 EB	-	-	-	-	-	-	-	-	-	-	-	-	under 048-0009 EB 7 notice
		EB	II	-	-	-	-	-	-	-	-	-	-	-	-	-	-	-
	048-0010	WB	I	-	on I-74 WB	300	-	1.0	-	1.0	1.0	1.0	1.0	-	-	-	-	7 day advance notice
		WB	II	-	-	-	150	-	1.0	-	-	1.0	-	-	-	-	-	-
# 3	048-0009	EB	I	-	on I-74 EB	300	-	1.0	-	2.0	1.0	1.0	-	-	-	-	-	7 day advance notice
		EB	II	-	-	-	150	-	1.0	-	-	1.0	-	-	-	-	-	-
	048-0009	WB	I	-	on I-74 WB	-	-	-	-	-	-	-	-	-	-	-	-	under 048-0010 7 notice
		WB	II	-	-	-	-	-	-	-	-	-	-	-	-	-	-	-
# 4	048-0026	NB	I	-	on US 150 NB	-	-	-	-	-	-	-	-	-	-	-	-	7 day advance notice
		NB	II	-	-	-	-	-	-	-	-	-	-	-	-	-	-	-
	048-0026	SB	I	-	on US 150 SB	300	150	1.0	1.0	-	-	-	-	-	-	2.0	-	7 day advance notice
		SB	II	-	-	-	-	-	-	-	-	-	-	-	-	-	-	-
# 5	040-0063	EB	I	1.0	on I-74 EB	300	-	1.0	-	-	-	-	-	-	-	-	-	7 day advance notice
		EB	II	-	on I-74 EB	-	150	-	1.0	-	-	-	-	-	-	-	-	-
	048-0063	WB	I	1.0	on I-74 WB	300	-	1.0	-	-	-	-	-	-	-	-	-	7 day advance notice
		WB	II	-	on I-74 WB	-	150	-	1.0	-	-	-	-	-	-	-	-	-
# 6			I	-	DELETED	-	-	-	-	-	-	-	-	-	-	-	-	-
# 7	072-0201	EB/WB	I	-	on AIRPORT ROAD.	-	-	-	-	-	-	-	-	1.0	-	-	-	7 day advance notice
# 8	090-0073	WB	I	-	US 24	600	300	2.0	2.0	1.0	1.0	-	-	-	-	-	8.0	2-7 day advance notice
			II	-	-	-	-	-	-	-	-	-	-	-	-	-	-	-
# 9	090-0074	EB	I	-	US 24	600	300	2.0	2.0	1.0	1.0	-	-	-	-	-	7.0	7 day advance notice
			II	-	-	-	-	-	-	-	-	-	-	-	-	-	-	-
# 10	090-0124	EB	I	-	US 24	300	-	1.0	-	1.0	-	-	-	-	-	-	-	7 day advance notice
			II	-	-	-	150	-	-	1.0	-	-	-	-	-	-	-	-
	090-0124	WB	I	-	US 24	300	-	1.0	-	1.0	-	-	-	-	-	-	-	7 day advance notice
			II	-	-	-	-	150	-	1.0	-	-	-	-	-	-	-	-
# 11			I	-	DELETED	-	-	-	-	-	-	-	-	-	-	-	-	
12	102-0012	EB	I	1.0	on I-74 EB	300	-	1.0	-	-	-	-	-	-	-	-	-	7 day advance notice
			II	-	on I-74 EB	-	150	-	1.0	-	1.0	-	-	-	-	-	-	-
	102-0012	WB	I	1.0	on I-74 WB	300	-	1.0	-	-	-	-	-	-	-	-	-	7 day advance notice
			II	-	on I-74 WB	-	150	-	1.0	-	1.0	-	-	-	-	-	-	-
13	102-0034	EB	I	1.0	on I-74 EB	300	-	1.0	-	-	-	-	-	-	-	-	-	7 day advance notice
			II	-	on I-74 EB	-	150	-	1.0	-	1.0	-	-	-	-	-	-	-
	102-0034	WB	I	1.0	on I-74 WB	300	-	1.0	-	-	-	-	-	-	-	-	-	7 day advance notice
			II	-	on I-74 WB	-	150	-	1.0	-	1.0	-	-	-	-	-	-	-
14	102-0046	EB/WB	I	-	on US-24	450	150	1.0	1.0	-	-	-	-	-	2.0	-	-	2-7 day advance notice
			II	-	-	-	-	-	-	-	-	-	-	-	-	-	-	-
TOTALS				8.0		5550	2700	18.0	18.0	7.0	6.0	4.0	1.0	1.0	6.0	15.0	140 Cal Day	

FILE NAME: U:\PROJECTS\2023\TRAFFIC CONTROL\TRAFFIC CONTROL SUMMARY.dgn



USER NAME = rbailey	DESIGNED = RTB	REVISED =
PLOT SCALE = 100.0000' / in.	DRAWN = RTB	REVISED =
PLOT DATE = 3/21/2023	CHECKED = MCL	REVISED =
	DATE = 3/21/2023	REVISED =

**STATE OF ILLINOIS  
 DEPARTMENT OF TRANSPORTATION**

TRAFFIC CONTROL & PROTECTION		
SCALE: NONE	SHEET 1 OF 1 SHEETS	STA. N/A TO STA. N/A

F.A.P. RTE.	SECTION	COUNTY	TOTAL SHEETS	SHEET NO.
VAR	D-4 BRIDGE PAINTING 2023	VAR	113	6
			CONTRACT NO. 68H58	
ILLINOIS FED. AID PROJECT				