

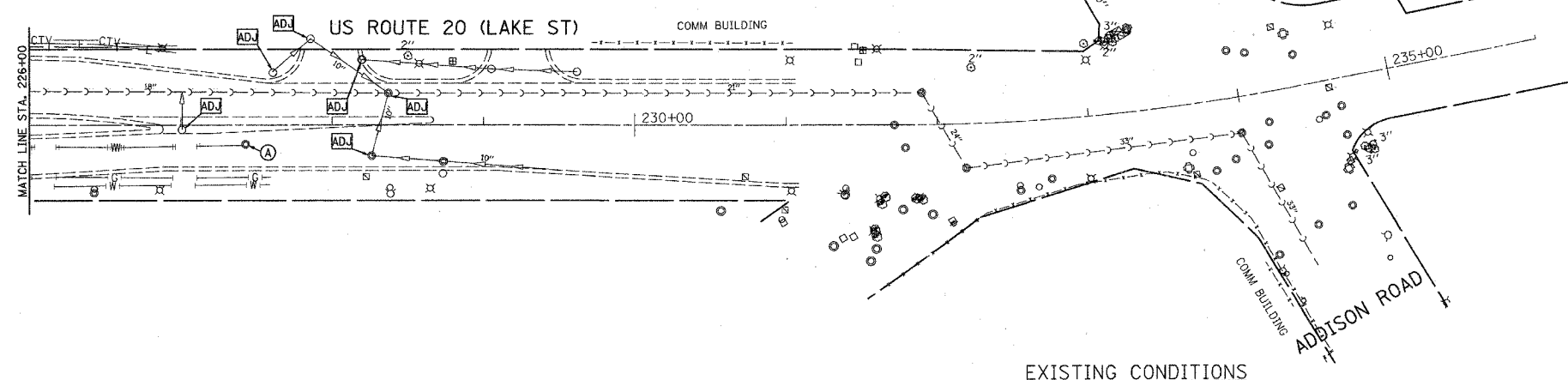

IMPROVEMENT LIMIT
STA 228+50.00



EXISTING CONDITIONS

IMPROVEMENT LIMIT
STA 228+50.00

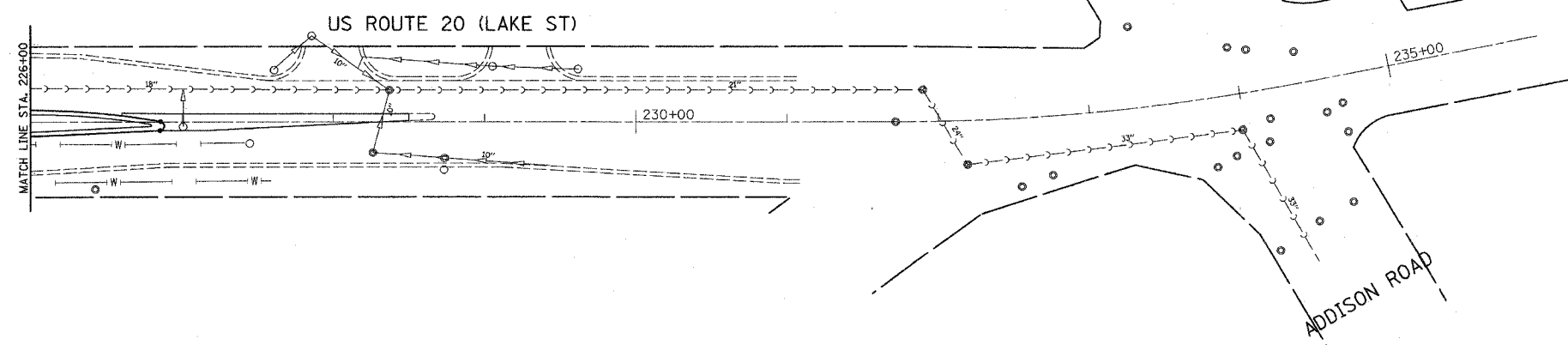

PROPOSED IMPROVEMENT

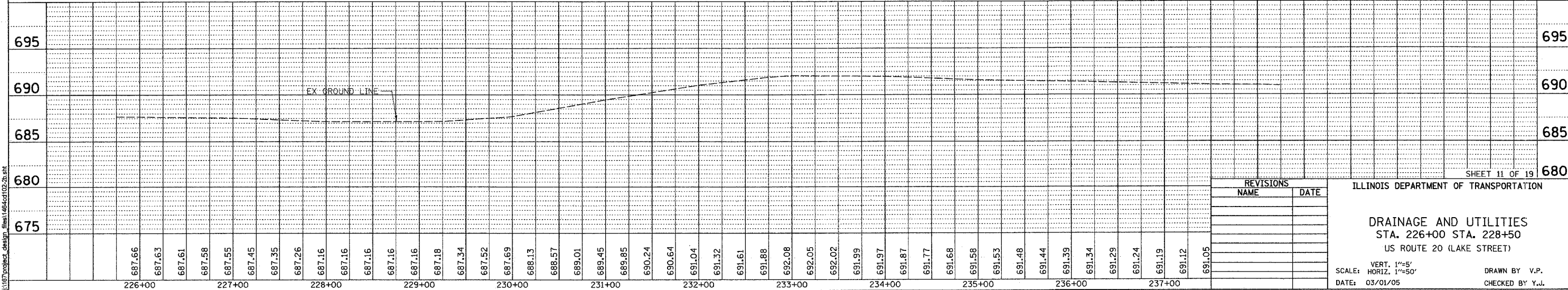
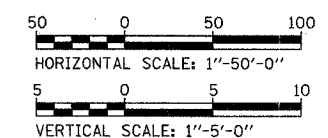

EX GROUND LINE

SHEET 11 OF 19

REVISIONS	
NAME	DATE

ILLINOIS DEPARTMENT OF TRANSPORTATION
DRAINAGE AND UTILITIES
STA. 226+00 STA. 228+50
US ROUTE 20 (LAKE STREET)
VERT. 1"=5'
SCALE: HORIZ. 1"=50'
DATE: 03/01/05
DRAWN BY V.P.
CHECKED BY Y.J.

PLANNED	BY	DATE
DESIGNED		
ALIGNED		
NOTED		
FILE NAME		

PROFILE	BY	DATE
NOTED		
FILE NAME		

1167-profile_drawing_116614610502-zh.sht