

TOTAL SHEETS	NO.
3537	170
COUNTY	DUPAGE
SECTION	51-R-4
FALL RITE	ILLINOIS FED. AID PROJECT
CONTRACT NO. 82295	

PART OF THE SE 1/4 OF SEC. 20, TWP. 40 N., R. 11 E. OF THE 3RD. P.M., IN DuPAGE COUNTY, ILLINOIS.

**MANGAN'S ADDISON ADDITION**  
Recorded August 7, 1925  
as Document No. 197516

SEE SHEET C8

SEE SHEET C9

**OWNER'S LAKE STREET ADDITION**  
Recorded March 10, 1925  
as Document No. 185437

See Sheet C9  
for Parcel  
19R0223D &  
19R0223E-A thru  
19R0223E-D

SEE SHEET C13

See Sheet C13  
for Parcel  
19R0223A & B  
& 19R0231E

**BROWN'S SUBDIVISION**  
Recorded July 21, 1985  
as Document No. R85-79100

**JURSICH'S SUBDIVISION**  
Recorded November 17, 1989  
as Document No. R89-43673

PARCEL NUMBER	OWNER	TOTAL HOLDINGS ACRES	PART TAKEN ACRES	AREA IN EXISTING R.O.W. ACRES	REMAINDER AREA ACRES	ASSIGNMENT AREA SQUARE FEET	EASEMENT PURPOSE	PERMANENT INDEX NUMBER	PROPERTY ACQUIRED BY
19R0229D & 19R0229E	LaSalle Bank National Association, as Trustee under the provisions of a Trust Agreement dated the 7th day of February, 2003 and known as Trust Number 130985	0.399	0.031	N/A	0.368	0.007	Driveway Construction	03-20-414-025	
19R0230	St. Paul Federal Bank for Savings	0.554	0.046	N/A	0.508	N/A	N/A	03-20-414-023	

\* Area of Proposed Dedication

**Schedule of Ties**

Point Number	Tie to point	Tie Distance (feet)
1	T2	15.76
	T3	65.68
2	T1	65.61
	T2	33.00
	T3	13.14

All Ties to Point Nos. 1 & 2 are a "MAG" Nail (Set) in Bituminous Parking Lot.

**COORDINATE TABLE**

STATION	OFFSET	NORTH	EAST
188+15.37	50.99' LL	1,920,297.691	1,074,063.285
188+67.22	60.00' LL	1,920,371.406	1,074,168.632
189+00.37	54.34' LL	1,920,307.922	1,074,168.626
189+02.19	49.33' LL	1,920,302.197	1,074,188.621
190+84.28	60.00' LL	1,920,223.250	1,074,542.010
190+90.32	49.16' LL	1,920,211.691	1,074,351.998

**EXISTING R.O.W. RECORDED INFORMATION**

Parcel	Document No.	Date Recorded
19R0229	2-92-0	March 10, 1926
19R0229	186-79100	July 21, 1985
19R0230	209250	March 10, 1926
---	189437	March 10, 1925
---	197516	August 7, 1925
---	186-21473	June 6, 1966
---	R69-46673	November 17, 1989
---	R74-12943	March 28, 1974
---	R87-186344	November 30, 1987

**LAKE MILL ASSESSMENT PLAT**  
Recorded January 5, 1979  
as Document No. R79-01560  
Parcel 1

**PATROS ADDITION TO ADDISON**  
Recorded March 10, 1926  
as Document No. 208250

LEGEND

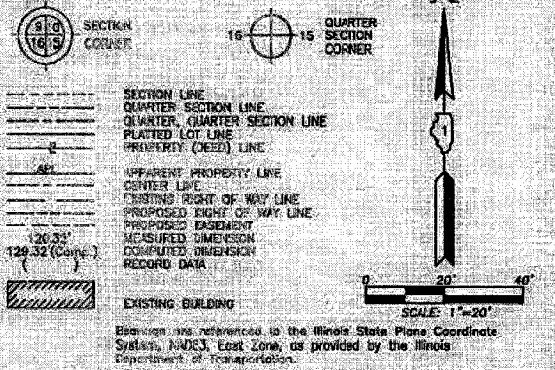

- IRON PIPE OR ROD FOUND
- CUT CROSS FOUND OR SET
- THESE MARKS REFERENCE FOUND OR SET MONUMENTAL SET 5/8 INCH IRON ROD PLUSH WITH GROUND TO BE FOUND IRON STAKE IDENTIFIED BY COLORED PLASTIC CAP BEARING SURVEYOR'S REGISTRATION NUMBER.
- THESE MARKS IN CULTIVATED AREAS, REFERENCE FOUND OR SET MONUMENTAL BURNED 5/8 INCH IRON ROD 20 INCHES BELOW GROUND TO BE FOUND IRON STAKE IDENTIFIED BY COLORED PLASTIC CAP BEARING SURVEYOR'S REGISTRATION NUMBER.
- STAKING OF PROPOSED RIGHT OF WAY, SET DIVISION OF HIGHWAYS SURVEY MARKER TO MONUMENT THE POSITION SHOWN, IDENTIFIED BY INSCRIPTION DATA AND SURVEYOR'S REGISTRATION NUMBER.
- STAKING OF PROPOSED RIGHT OF WAY IN CULTIVATED AREAS, BURNED 5/8 INCH IRON ROD 20 INCHES BELOW GROUND TO MARK FUTURE SURVEY MARKER POSITION IDENTIFIED BY COLORED PLASTIC CAP BEARING SURVEYOR'S REGISTRATION NUMBER.
- PERMANENT SURVEY MARKER, I.C.O.T. 510 2135 (TO BE SET BY OTHERS)
- RIGHT OF WAY STAKING PROPOSED TO BE SET.

STATE OF ILLINOIS }  
COUNTY OF LAKE }  
THIS IS TO CERTIFY THAT WE, JORGENSEN & ASSOCIATES, INC., AN ILLINOIS PROFESSIONAL DESIGN AND LAND SURVEYING CORPORATION, NUMBER 184-2771, HAVE SURVEYED THE PLAT OF HIGHWAYS SHOWN HEREIN IN SECTION 20, TOWNSHIP 40N., RANGE 11E. THIRD PRINCIPAL MERIDIAN, DUPAGE COUNTY, THAT THE SURVEY IS TRUE AND COMPLETE AS SHOWN TO THE BEST OF MY KNOWLEDGE AND BELIEF, THAT THE PLAT CORRECTLY REPRESENTS SAID SURVEY, THAT ALL MONUMENTS FOUND AND ESTABLISHED ARE OF PERMANENT QUALITY AND OCCUPY THE POSITIONS SHOWN THEREON AND THAT THE MONUMENTS ARE SUFFICIENT TO ENABLE THE SURVEY TO BE RETRACED IN ACCORDANCE WITH THE DEPARTMENT OF TRANSPORTATION, STATE OF ILLINOIS, DATED AT LAKE VILLA, ILLINOIS THIS \_\_\_\_\_ DAY OF \_\_\_\_\_, 20\_\_ A.D.

PRESIDENT  
ILLINOIS PROFESSIONAL LAND SURVEYOR NO. 25-2797  
LICENSE EXPIRATION DATE: NOVEMBER 30, 2004

NOTE: COORDINATES ARE GROUND VALUES AND CAN BE CONVERTED TO GRID VALUES BY MULTIPLYING THE PUBLISHED GROUND COORDINATES BY A SCALE FACTOR OF 0.9998772, AS PROVIDED BY THE ILLINOIS DEPARTMENT OF TRANSPORTATION.

**COORDINATE TABLE**

STATION	OFFSET	NORTH	EAST
174+09.42	42.67' LL	1,920,541.206	1,074,066.465
184+19.20	42.50' LL	1,920,518.306	1,074,066.443
184+23.28	49.90' LL	1,920,514.396	1,074,073.439
184+67.40	42.59' LL	1,920,470.260	1,074,066.397
184+67.40	49.59' LL	1,920,470.254	1,074,073.397
186+05.11	33.14' LL	1,920,404.017	1,073,972.861
186+75.38	50.61' LL	1,920,414.268	1,073,990.344
187+18.99	38.71' RL	1,920,315.022	1,073,984.890
187+40.04	90.70' LL	1,920,417.758	1,074,066.347
187+41.29	0.14' LL	1,920,336.084	1,074,023.271
187+41.85	0.58' RL	1,920,337.260	1,074,023.271
187+60.24	34.47' LL	1,920,378.280	1,074,066.308
187+93.90	60.00' LL	1,920,364.728	1,074,098.401

JORGENSEN & ASSOCIATES, INC.  
120 PARK AVENUE  
LAKE VILLA, ILLINOIS 60146  
(631) 356-3371

**PLAT OF HIGHWAYS**  
STATE OF ILLINOIS  
DEPARTMENT OF TRANSPORTATION  
F.A.P. 21 (U.S. ROUTE 20)  
SECTION 51-R-4  
PROJECT  
STATION 18+00  
STATION 187+00  
SCALE: 1"=20'

DUPAGE COUNTY  
JOB NO. R-91-005-92  
TO STATION 21+00  
TO STATION 191+00  
SHEET C12 OF C30

**BUREAU OF LAND ACQUISITION**  
201 WEST CENTER COURT  
SCHAUMBURG, ILLINOIS 60196