

F.A.U. RTE. NO.	SECTION	COUNTY	TOTAL SHEETS	SHEET NO.
3537	5Y-R-4	DUPAGE	377	257
STA 123+00		TO STA 152+00		
FED. ROAD DIST. NO.	ILLINOIS	FED. AID PROJECT		
CONTRACT NO. 62295				

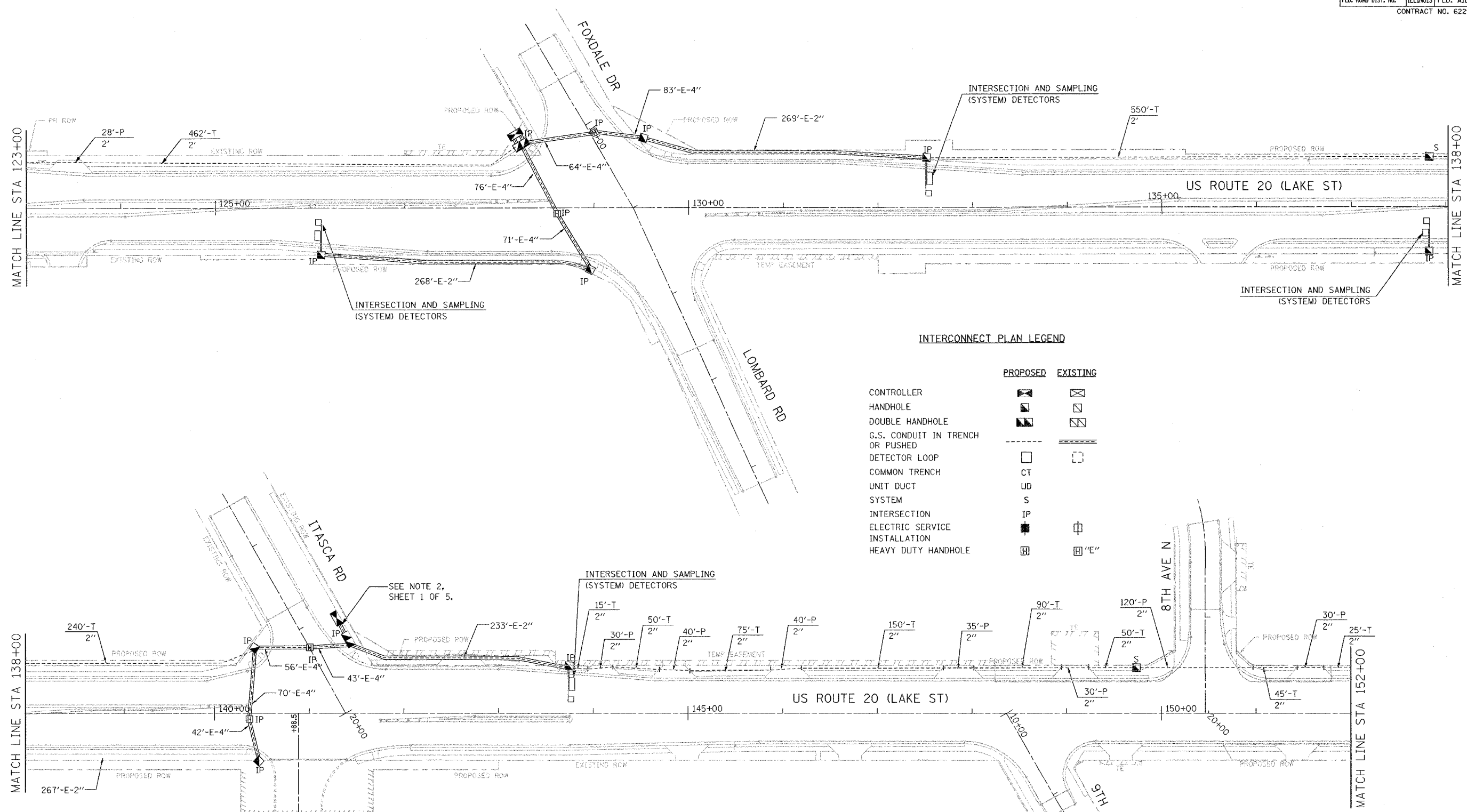

INTERCONNECT PLAN LEGEND

	PROPOSED	EXISTING
CONTROLLER	☒	☒
HANDHOLE	☐	☐
DOUBLE HANDHOLE	☐	☐
G.S. CONDUIT IN TRENCH OR PUSHED	---	---
DETECTOR LOOP	☐	☐
COMMON TRENCH	CT	
UNIT DUCT	UD	
SYSTEM	S	
INTERSECTION	IP	
ELECTRIC SERVICE INSTALLATION	⊕	⊕
HEAVY DUTY HANDHOLE	⊕	⊕ "E"

THE TRAFFIC SIGNAL CONTROL EQUIPMENT FOR THE FUTURE PROJECT SHALL BE "ECONOLITE" TO MATCH THE EXISTING ADJACENT SYSTEM.

REVISIONS	
NAME	DATE

ILLINOIS DEPARTMENT OF TRANSPORTATION
INTERCONNECT PLAN
 US ROUTE 20 (LAKE STREET)
 SCALE: 1"=50'
 DATE: 03/01/05
 DRAWN BY: MJH
 DESIGNED BY: MJH
 CHECKED BY: RN