

F.A.U. RTE.	SECTION	COUNTY	TOTAL SHEETS	SHEET NO.
1487	66R	DUPAGE	412	130
STA. 23+00.00		TO STA. 144+00.00		
FED. ROAD DIST. NO.		ILLINOIS	FED. AID PROJECT	
CONTRACT NO. 62376				

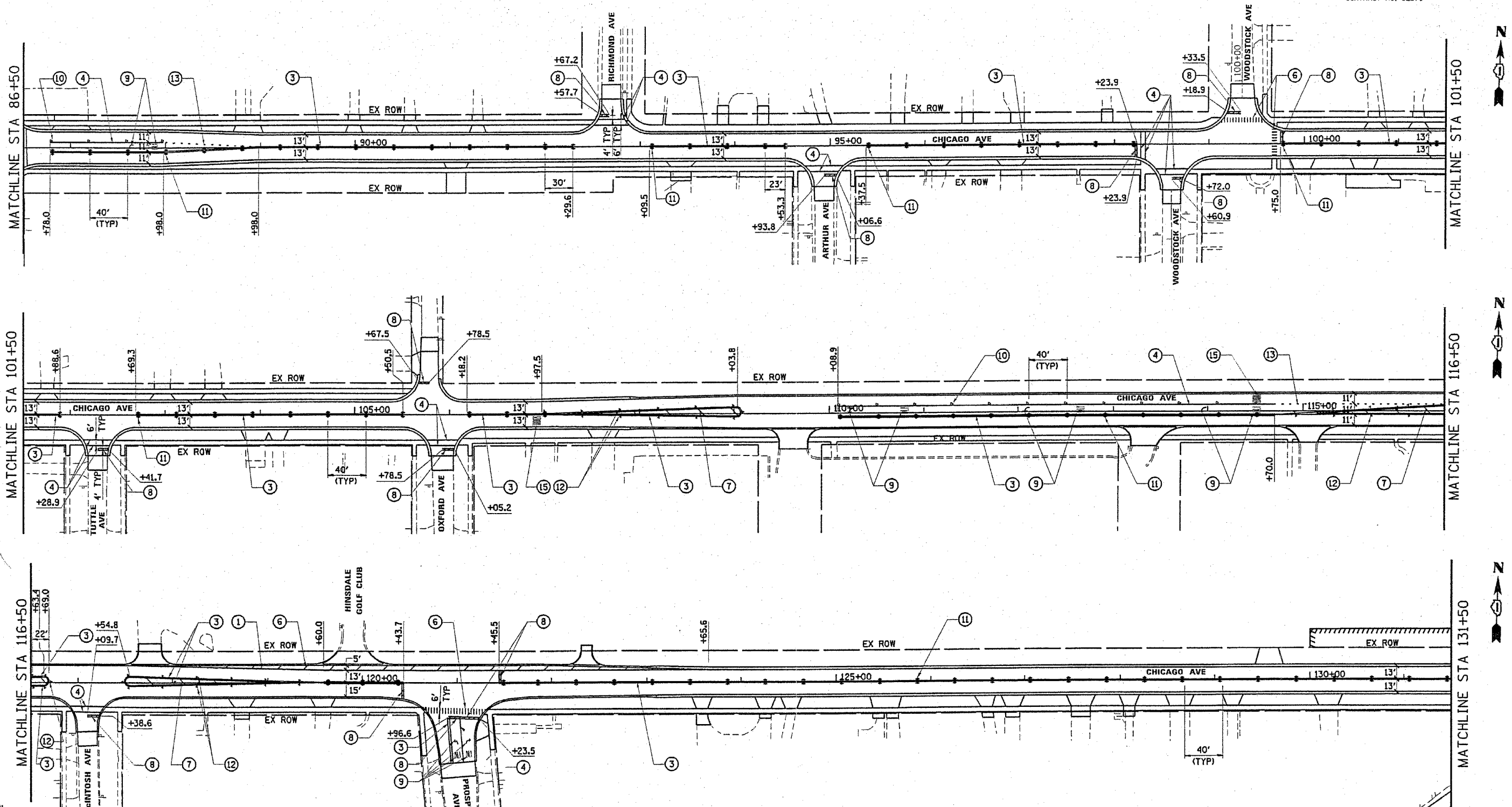

- LEGEND:**
- ① POLYUREA PAVEMENT MARKING, TYPE I, WHITE LINE, 4", FT
  - ② POLYUREA PAVEMENT MARKING, TYPE I, YELLOW LINE, 4", FT
  - ③ POLYUREA PAVEMENT MARKING, TYPE I, DOUBLE YELLOW LINE, 4" @ 11", FT
  - ④ POLYUREA PAVEMENT MARKING, TYPE I, WHITE LINE, 6", FT
  - ⑤ RAISED REFLECTIVE PAVEMENT MARKER (BRIDGE), AMBER, EACH - TWO-WAY AMBER MARKER
  - ⑥ POLYUREA PAVEMENT MARKING, TYPE I, WHITE LINE, 12", FT
  - ⑦ POLYUREA PAVEMENT MARKING, TYPE I, YELLOW LINE, 12", FT
  - ⑧ POLYUREA PAVEMENT MARKING, TYPE I, WHITE LINE, 24", FT
  - ⑨ POLYUREA PAVEMENT MARKING, TYPE I LETTERS AND SYMBOLS WHITE, (11.8+8.8)=20.6 SQ FT, EACH COMBINATION
  - ⑩ RAISED REFLECTIVE PAVEMENT MARKER, CRYSTAL, EACH - ONE-WAY CRYSTAL MARKER
  - ⑪ RAISED REFLECTIVE PAVEMENT MARKER, AMBER, EACH - TWO-WAY AMBER MARKER
  - ⑫ RAISED REFLECTIVE PAVEMENT MARKER, AMBER, EACH - ONE-WAY AMBER MARKER
  - ⑬ POLYUREA PAVEMENT MARKING, TYPE I, WHITE LINE, 6", 2' LONG, 6' SPACING
  - ⑭ POLYUREA PAVEMENT MARKING, TYPE I, WHITE LINE, 6", 10' LONG, 30' SPACING
  - ⑮ POLYUREA PAVEMENT MARKING, TYPE I, LETTERS AND SYMBOLS WHITE (18.3) SQ FT

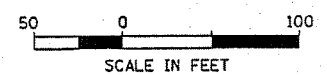

Whole File Registration No. 84-0953

**Stanley Consultants** INC.

558 West Highways Road, Suite 730  
Chicago, Illinois 60639-2933  
www.stanleyconsultants.com

REVISIONS	
NAME	DATE

ILLINOIS DEPARTMENT OF TRANSPORTATION

**PAVEMENT MARKING  
MAPLE AVENUE / CHICAGO AVENUE  
SHEET 3 OF 4**

SCALE: 1"=50'  
DATE: 27-APR-2005

DRAWN BY: E.D.  
CHECKED BY: A.M.