

| | | | | |
|---------------------|----------|---------------------------|--------------|-----------|
| E.A.P. RTE. | SECTION | COUNTY | TOTAL SHEETS | SHEET NO. |
| 350 | 3321-1BS | COOK | 24 | 11 |
| STA. 560±87 | | TO STA. 639±23 | | 62430 |
| FED. ROAD DIST. NO. | | ILLINOIS FED. AID PROJECT | | |

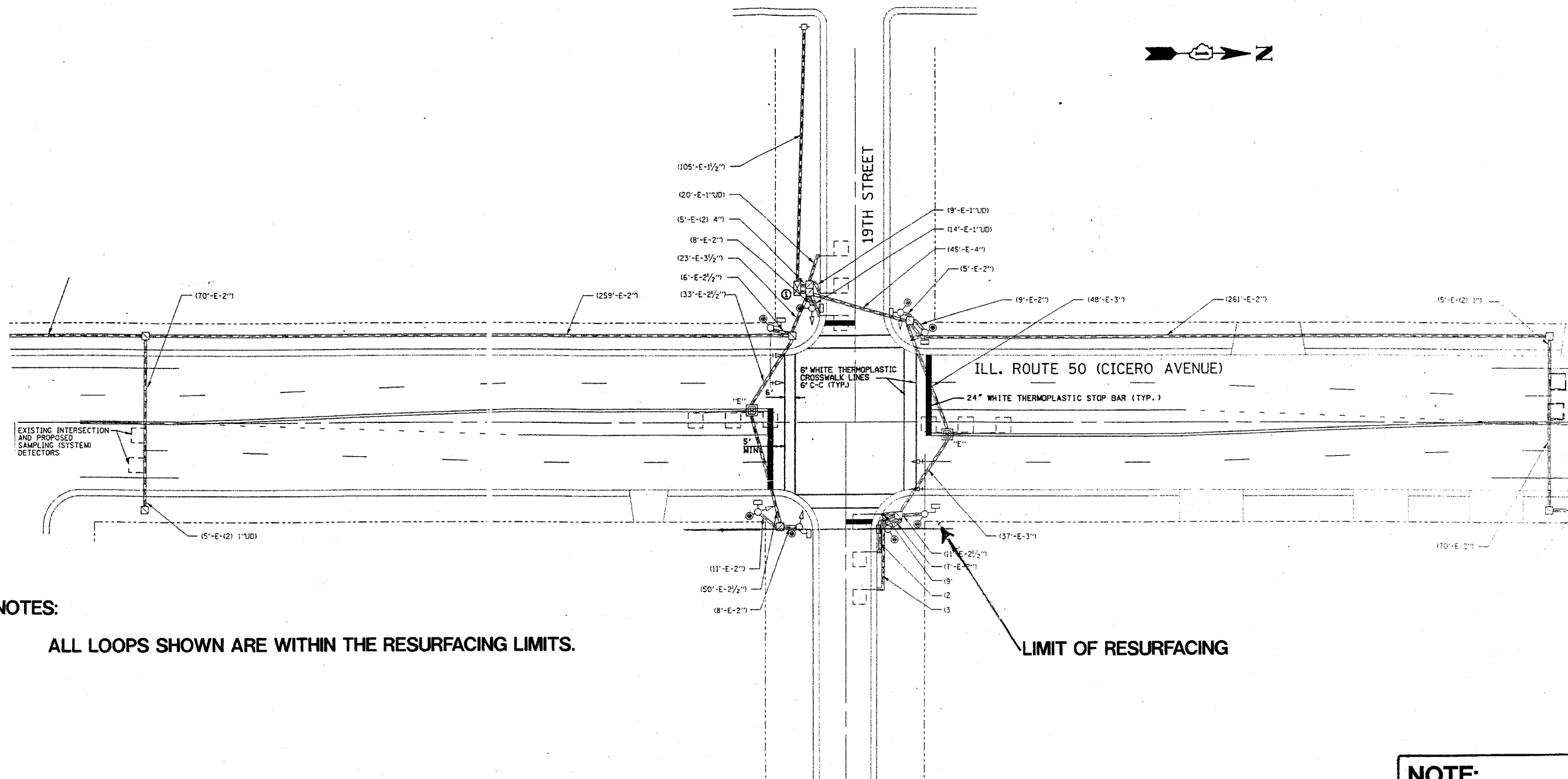

NOTES:
 ALL LOOPS SHOWN ARE WITHIN THE RESURFACING LIMITS.

LIMIT OF RESURFACING

NOTE:
 THIS PLAN IS FOR THE PURPOSE OF REPLACING THE DETECTOR LOOPS. ALL OTHER INFORMATION SHOWN IS NOT RELATED AND WILL BE DISREGARDED.

REPLACE ALL DETECTOR LOOPS AS SHOWN

(WITHIN THE RESURFACING LIMITS)

| CODE NO. | QUANTITY | UNIT | ITEM |
|----------|----------|------|---------------------------|
| 88600600 | 522 | FOOT | DETECTOR LOOP REPLACEMENT |

SCALE: 1" =
 DATE

DESIGNED BY:
 DRAWN BY:
 CHECKED BY:



ILLINOIS DEPARTMENT OF TRANSPORTATION
 DETECTOR LOOPS AT:
 IL RT 50 (CICERO AVE)
 & 19th STREET