

MATCHLINE NB STA. 2271+00.00

MATCHLINE NB STA. 2277+00.00

EXISTING CONDITIONS  
PROPOSED IMPROVEMENTS

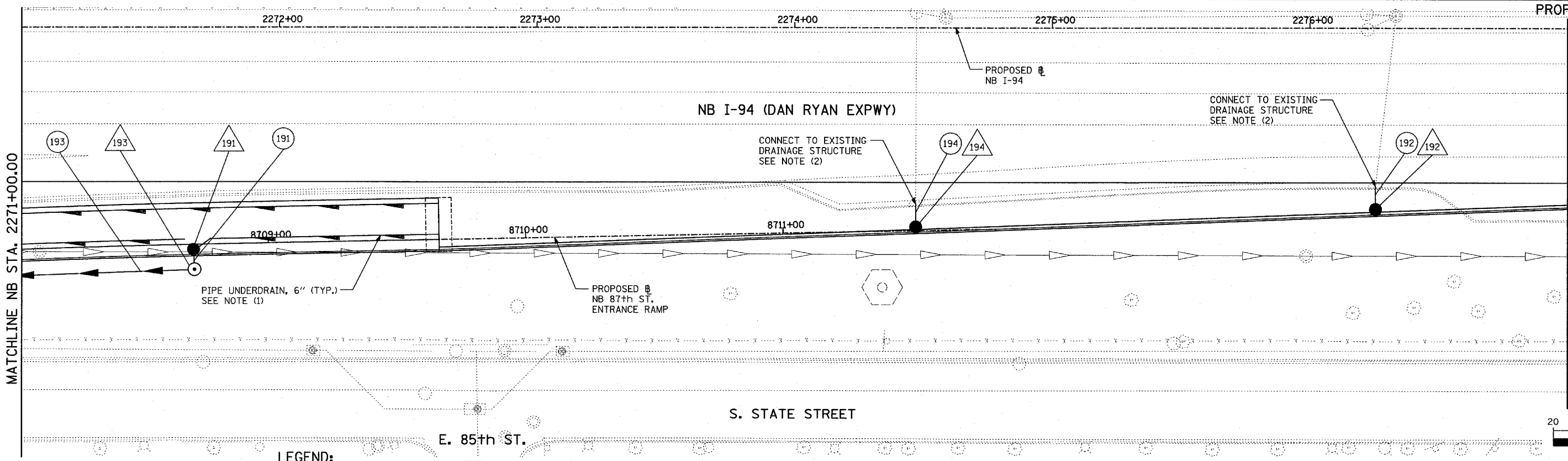

MATCHLINE NB STA. 2271+00.00

MATCHLINE NB STA. 2277+00.00

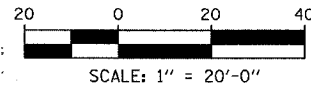
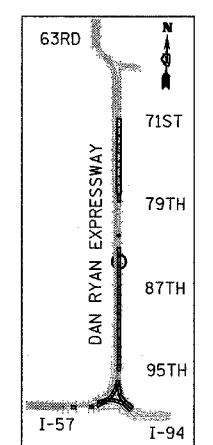

- LEGEND:**
- EXISTING COMBINED SEWER
  - PROPOSED STORM SEWER NUMBER (X=SHEET NO., Y=PIPE NO.)
  - PROPOSED STRUCTURE NUMBER (X=SHEET NO., Y=STRUCTURE NO.)
  - PIPE STUBOUT TO BE PLUGGED
  - UTILITY REMOVAL
  - UTILITY REMOVAL PLUG
  - HIGH MAST LIGHT TOWER FOUNDATION (BY OTHERS - SEE CONTRACT 62583)
  - HIGH MAST LIGHT TOWER FOUNDATION, WALL MOUNTED
  - HIGH MAST LIGHT TOWER FOUNDATION (BY OTHERS - SEE CONTRACT 62583)
  - F.V. FIELD VERIFY

- NOTES:**
- FOR CLARITY, PIPE UNDERDRAINS ARE SHOWN OFFSET FROM THEIR PROPOSED LOCATIONS. FOR DETAILED PLACEMENT, SEE SHEET "PIPE UNDERDRAINS ALONG RAMP'S DETAIL."
  - CORE DRILL AND CONNECT TO EXISTING DRAINAGE STRUCTURE. CONNECTION COST SHALL BE INCLUDED IN THE COST TO CONSTRUCT THE STORM SEWER.

REVISIONS	
NAME	DATE
REVISOR	04/15/05

ILLINOIS DEPARTMENT OF TRANSPORTATION  
 F.A.I. 94 (DAN RYAN EXPRESSWAY)  
 DRAINAGE AND UTILITY PLANS  
 NB 87th STREET ENTRANCE RAMP  
 NB I-94 STA. 2271+00.00 TO 2277+00.00

SCALE: 1"=20'  
 DATE: MARCH 18, 2005  
 DRAWN BY: MB  
 CHECKED BY: DA

TYLIN INTERNATIONAL