

F.A.I. RTE.	SECTION	COUNTY	TOTAL SHEETS	SHEET NO.
94	*	COOK	907	349
STA. 12030+00.00 TO STA. 1243+00.00		ILLINOIS FED. AID PROJECT		
FED. ROAD DIST. NO.		ILLINOIS FED. AID PROJECT		
* (1516.1, 1717 & 1818) R-9		62695		

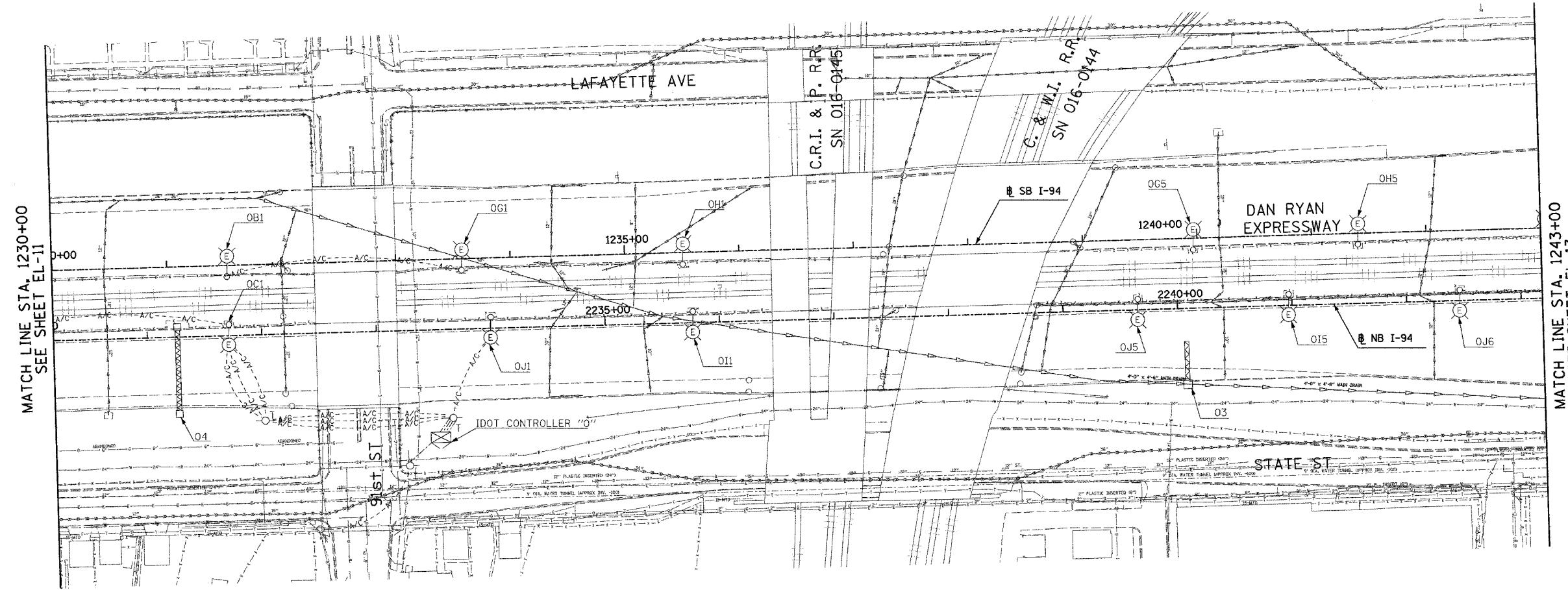

- NOTES:
- SEE DRAWINGS EI-100 AND EI-101 FOR ELECTRICAL SYMBOLS AND ABBREVIATIONS.



MATCH LINE STA. 1230+00
SEE SHEET EL-11

MATCH LINE STA. 1243+00
SEE SHEET EL-13

NO ELECTRICAL WORK ON THIS SHEET
FOR REFERENCE ONLY



17B/EL-12

REVISIONS	
NAME	DATE
REVISED	5/06/05

ILLINOIS DEPARTMENT OF TRANSPORTATION
F.A.I. 94 (DAN RYAN EXPRESSWAY)
ROADWAY LIGHTING AND SURVEILLANCE PLANS
EXISTING CONDITIONS AND DEMOLITION

SCALE: 1"=50' DRAWN BY: VG
DATE: MARCH 25, 2005 CHECKED BY: TM

SINGH
SINGH & ASSOCIATES, INC.
CONSULTING ENGINEERS

300 W. ADAMS ST.
CHICAGO, IL 60606
TEL: (312) 629-0240
FAX: (312) 629-8449

J:\175\dgm\102753b_012-01a.dwg 5/16/2005 11:25:27 AM