

Benchmarks: BM 3549 Set "+" westerly flange bolt of hydrant at southwest intersection of 87th St. and Lafayette Ave., El. 9.49

Existing Structure: None.

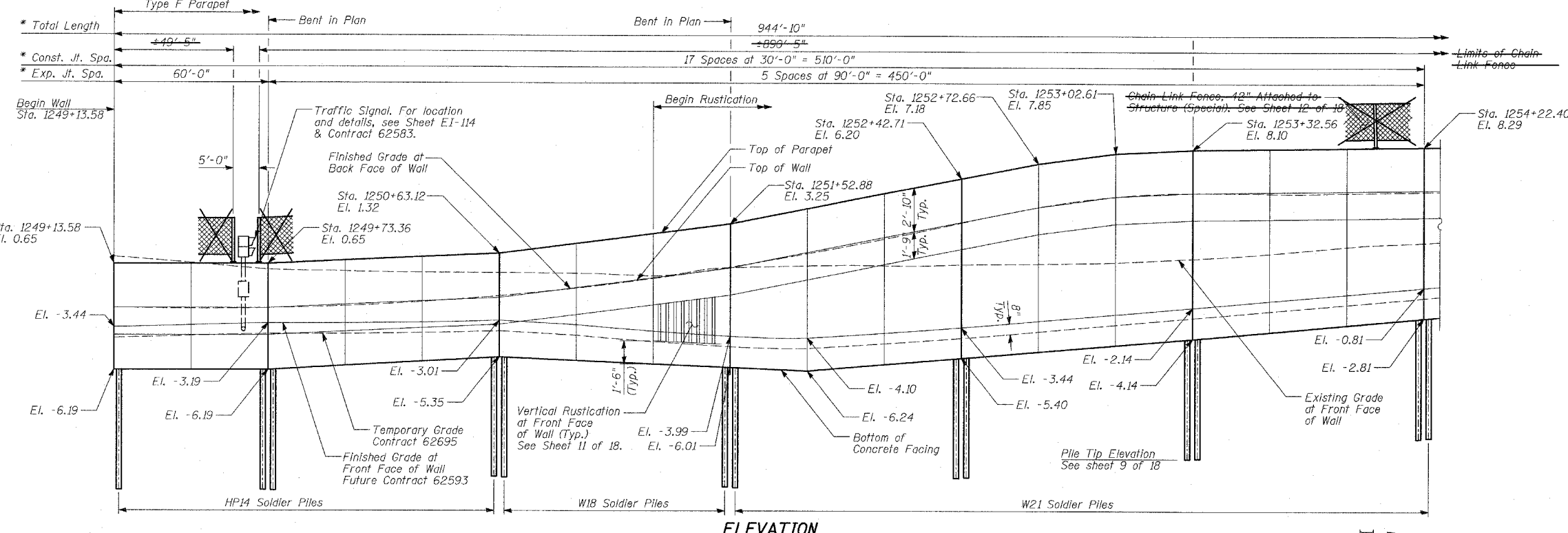

ELEVATION (Sta. 1249+13.58 to Sta. 1254+22.40)

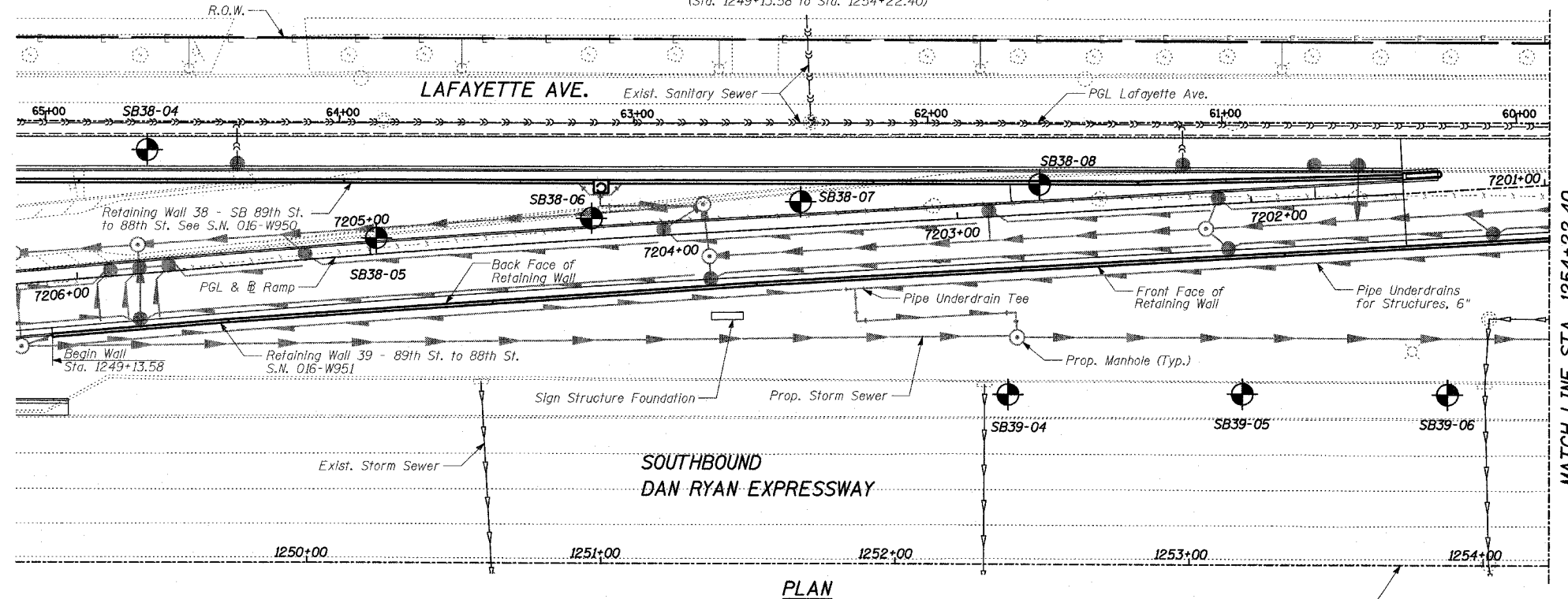

PLAN (Sta. 1249+13.58 to Sta. 1254+22.40)

F.A.I. RTE.	SECTION	COUNTY	TOTAL SHEETS	SHEET NO.
94		COOK	907	536
STA. 1200+00.00 TO STA. 1365+00				
FED. ROAD DIST. NO.		ILLINOIS	FED. AID PROJECT	
(1161, 1717 & 1818) R-9			62695	

TOTAL BILL OF MATERIAL

ITEM	UNIT	TOTAL
Structure Excavation	CU YD	618
Concrete Structures	CU YD	372
Protective Coat	SQ YD	1,220
Rustication Finish	SQ FT	2,611
Stud Shear Connectors	EACH	1,178
Untreated Timber Lagging	SQ FT	4,754
Furnishing Soldier Piles (HP Section)	FOOT	434
Furnishing Soldier Piles (W Section)	FOOT	3,541
Reinforcement Bars, Epoxy Coated	POUND	52,320
Geocomposite Wall Drain	SQ YD	581
Pipe Underdrains for Structures, 6"	FOOT	945
Drilling and Setting Soldier Piles (in Soil)	CU FT	19,826
Chain Link Fence, 42" Attached to Structure (Special)	FOOT	947

DESIGN SPECIFICATION

AASHTO 2002 Standard Specifications for Highway Bridges

DESIGN STRESSES

FIELD UNITS

f_c = 3,500 psi
f_y = 60,000 psi (Reinforcement)
f_y = 36,000 psi (M270 Grade 36) Soldier Piles

LOADING

Max. Soil Pressure Under Footing = 700 psf

INDEX OF SHEETS

- 1. GENERAL PLAN
- 2. GENERAL PLAN
- 3. PLAN AND ELEVATION STA. 1249+13.58 TO STA. 1250+63.12
- 4. PLAN AND ELEVATION STA. 1250+63.12 TO STA. 1252+42.71
- 5. PLAN AND ELEVATION STA. 1252+42.71 TO STA. 1254+22.40
- 6. PLAN AND ELEVATION STA. 1254+22.40 TO STA. 1256+02.08
- 7. PLAN AND ELEVATION STA. 1256+02.08 TO STA. 1257+57.82
- 8. PLAN AND ELEVATION STA. 1257+57.82 TO STA. 1258+50.93
- 9. PILE LAYOUT, DETAILS & BILL OF MATERIAL
- 10. WALL CROSS SECTIONS & DETAILS
- 11. RUSTICATION DETAILS
- 12. CHAIN LINK FENCE, 42" ATTACHED TO STRUCTURE (SPECIAL)
- 13. BORING LOGS SB38-04 & SB38-06
- 14. BORING LOGS SB38-08 & SB39-04
- 15. BORING LOGS SB39-05 & SB39-06
- 16. BORING LOGS SB39-07 & SB39-08
- 17. BORING LOGS SB39-09 & SB39-10
- 18. BORING LOGS SB39-11 & SB39-12

LEGEND

- Boring Location
- * Measured along Front Face of Wall.

GENERAL NOTES:

- Reinforcement bars shall conform to the requirements of AASHTO M31 or M322 Grade 60.
- Plan dimensions and details relative to existing structure have been taken from existing plans and are subject to nominal construction variations. It shall be the Contractor's responsibility to verify such dimensions and details in the field and make necessary approved adjustments prior to construction or ordering of materials. Such variations shall not be cause for additional compensation for a change in the scope of the work; however, the Contractor will be paid for the quantity actually finished at the unit price bid for the work.
- The Contractor is responsible for the design and performance of the lagging using no less than 3" nominal rough-sawn thickness and the minimum tabulated unit stress in bending (f_b), used in the design of timber lagging shall be 1000 psi.
- The soldier piles shall be cleaned and given one shop coat of Inorganic Zinc-Rich primer.
- All exposed concrete edges shall be chamfered 3/4" except as noted.
- Protective Coat shall be applied to exposed surfaces of the concrete facing.
- Existing utilities in conflict with soldier pile wall construction shall be abandoned or relocated according to directions given on the roadway plans.
- All construction joints shall be bonded.
- All elevations shown are based on the Chicago City Datum of 0.00 which is 579.19 feet above mean tide New York. (NAVD 88)
- The wall shall be backfilled (where applicable) prior to placing the concrete facing.
- The Contractor is responsible to coordinate all electrical crossings with this Contract and with Contract 62583.

Project Location Range 14E 3rd P.M.

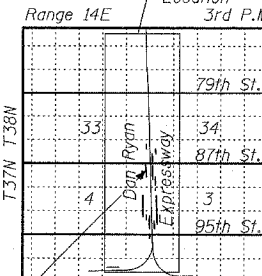

LOCATION SKETCH



Signed: Phillip D. Frey
Date: 3/25/05
For drawings 1 thru 18 of 18

REVISIONS	
NAME	DATE

ILLINOIS DEPARTMENT OF TRANSPORTATION
F.A.I. 94 (DAN RYAN EXPRESSWAY)
RETAINING WALL ALONG LAFAYETTE AVE.
89TH ST. TO 87TH ST.
WALL 39 - GENERAL PLAN
STA. 1249+13.58 TO STA. 1254+50.93
S.N. 016-W951
SCALE: N.T.S.
DATE: MARCH 25, 2005

DESIGNED BY: MI, TB
DRAWN BY: DJR, TB
CHECKED BY: TD, MI