

SURVEYED
 PROFILE
 CHECKED
 NO. NOTED
 STRUCTURE NOTATIONS CHECKED

F.A.I. RTE.	SECTION	COUNTY	TOTAL SHEETS	SHEET NO.
90/94	•	COOK	907	851
STA. 1200+00.00		TO STA. 1365+00		
FED. ROAD DIST. NO. ILLINOIS FED. AID PROJECT				
• (1516.1, 1717 & 1818) R-9				62695

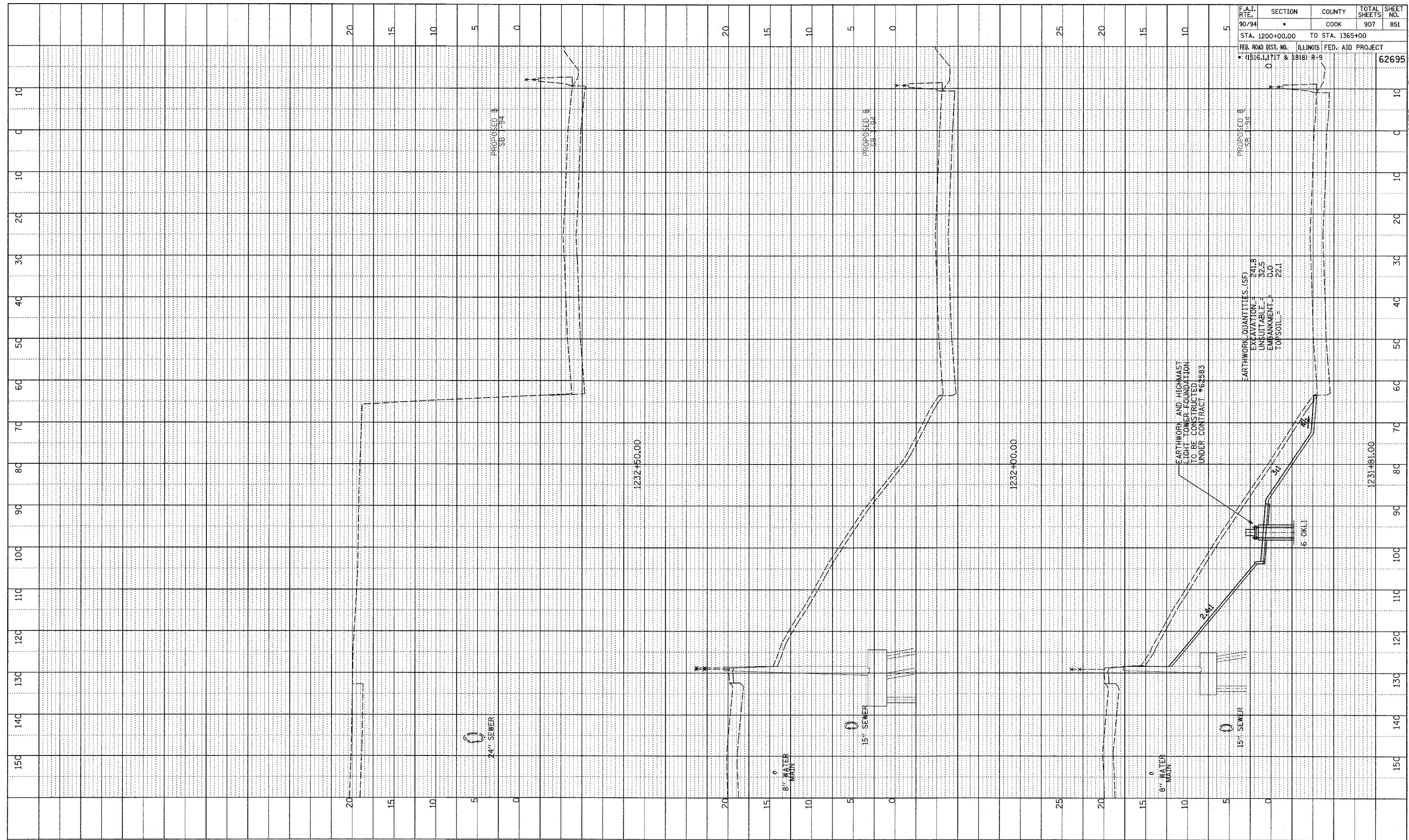

TYLIN INTERNATIONAL

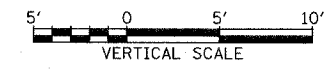
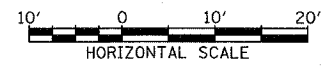

SB 95th ST. EXIT RAMP
STA. 1231+81 TO STA. 1232+50

P:\02313\road\cvt\p\gk\11\p\ss\90-94.dgn