

THE FOLLOWING ITEMS SHALL BE REMOVED BY THE CONTRACTOR AND SHALL BE DISPOSED OF BY THEM OUTSIDE THE RIGHT-OF-WAY AT THEIR EXPENSE. THE SALVAGE VALUE OF THE REMOVED EQUIPMENT SHALL BE REFLECTED IN THE CONTRACT BID PRICE.

- 2 EACH SIGNAL HEAD, 1-FACE, 3-SECTION, BRACKET MOUNTED
- 1 EACH SERVICE INSTALLATION

THE FOLLOWING EXISTING TRAFFIC SIGNAL EQUIPMENT SHALL BE REMOVED BY THE CONTRACTOR, SHALL REMAIN THE PROPERTY OF THE STATE AND SHALL BE DELIVERED BY THE CONTRACTOR TO THE STATE'S TRAFFIC SIGNAL MAINTENANCE CONTRACTOR'S MAIN FACILITY AS PER THE TRAFFIC SIGNAL SPECIFICATIONS.

- 1 EACH CONTROLLER AND CABINET, COMPLETE

| | | | | |
|---------------------|------------|------------------|--------------|-----------|
| F.A.U. RTE. | SECTION | COUNTY | TOTAL SHEETS | SHEET NO. |
| 1332 | 2004-022TS | COOK | 20 | 9 |
| STA. | TO STA. | | | |
| FED. ROAD DIST. NO. | ILLINOIS | FED. AID PROJECT | | |
| CONTRACT NO. 62741 | | | | |

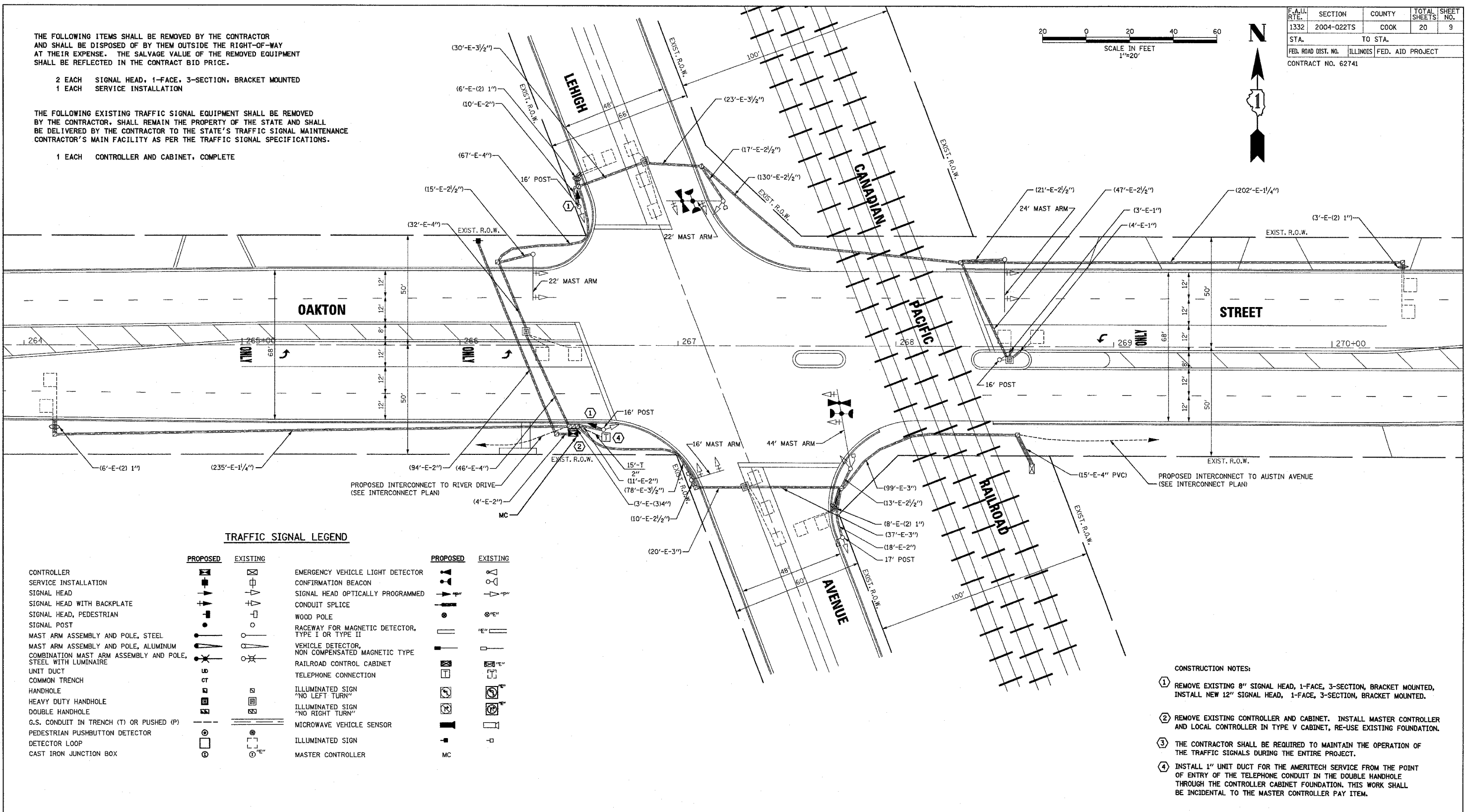
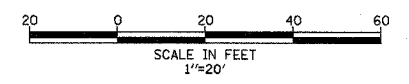

TRAFFIC SIGNAL LEGEND

| PROPOSED | EXISTING | DESCRIPTION | PROPOSED | EXISTING | DESCRIPTION |
|----------|----------|--|----------|----------|--|
| [Symbol] | [Symbol] | CONTROLLER | [Symbol] | [Symbol] | EMERGENCY VEHICLE LIGHT DETECTOR |
| [Symbol] | [Symbol] | SERVICE INSTALLATION | [Symbol] | [Symbol] | CONFIRMATION BEACON |
| [Symbol] | [Symbol] | SIGNAL HEAD | [Symbol] | [Symbol] | SIGNAL HEAD OPTICALLY PROGRAMMED |
| [Symbol] | [Symbol] | SIGNAL HEAD WITH BACKPLATE | [Symbol] | [Symbol] | CONDUIT SPLICE |
| [Symbol] | [Symbol] | SIGNAL HEAD, PEDESTRIAN | [Symbol] | [Symbol] | WOOD POLE |
| [Symbol] | [Symbol] | SIGNAL POST | [Symbol] | [Symbol] | RACEWAY FOR MAGNETIC DETECTOR, TYPE I OR TYPE II |
| [Symbol] | [Symbol] | MAST ARM ASSEMBLY AND POLE, STEEL | [Symbol] | [Symbol] | VEHICLE DETECTOR, NON COMPENSATED MAGNETIC TYPE |
| [Symbol] | [Symbol] | MAST ARM ASSEMBLY AND POLE, ALUMINUM | [Symbol] | [Symbol] | RAILROAD CONTROL CABINET |
| [Symbol] | [Symbol] | COMBINATION MAST ARM ASSEMBLY AND POLE, STEEL WITH LUMINAIRE | [Symbol] | [Symbol] | TELEPHONE CONNECTION |
| [Symbol] | [Symbol] | UNIT DUCT | [Symbol] | [Symbol] | ILLUMINATED SIGN "NO LEFT TURN" |
| [Symbol] | [Symbol] | COMMON TRENCH | [Symbol] | [Symbol] | ILLUMINATED SIGN "NO RIGHT TURN" |
| [Symbol] | [Symbol] | HANDHOLE | [Symbol] | [Symbol] | MICROWAVE VEHICLE SENSOR |
| [Symbol] | [Symbol] | HEAVY DUTY HANDHOLE | [Symbol] | [Symbol] | ILLUMINATED SIGN |
| [Symbol] | [Symbol] | DOUBLE HANDHOLE | [Symbol] | [Symbol] | MASTER CONTROLLER |
| [Symbol] | [Symbol] | G.S. CONDUIT IN TRENCH (T) OR PUSHED (P) | [Symbol] | [Symbol] | |
| [Symbol] | [Symbol] | PEDESTRIAN PUSHBUTTON DETECTOR | [Symbol] | [Symbol] | |
| [Symbol] | [Symbol] | DETECTOR LOOP | [Symbol] | [Symbol] | |
| [Symbol] | [Symbol] | CAST IRON JUNCTION BOX | [Symbol] | [Symbol] | |

- CONSTRUCTION NOTES:**
- 1 REMOVE EXISTING 8" SIGNAL HEAD, 1-FACE, 3-SECTION, BRACKET MOUNTED, INSTALL NEW 12" SIGNAL HEAD, 1-FACE, 3-SECTION, BRACKET MOUNTED.
 - 2 REMOVE EXISTING CONTROLLER AND CABINET. INSTALL MASTER CONTROLLER AND LOCAL CONTROLLER IN TYPE V CABINET, RE-USE EXISTING FOUNDATION.
 - 3 THE CONTRACTOR SHALL BE REQUIRED TO MAINTAIN THE OPERATION OF THE TRAFFIC SIGNALS DURING THE ENTIRE PROJECT.
 - 4 INSTALL 1" UNIT DUCT FOR THE AMERITECH SERVICE FROM THE POINT OF ENTRY OF THE TELEPHONE CONDUIT IN THE DOUBLE HANDHOLE THROUGH THE CONTROLLER CABINET FOUNDATION. THIS WORK SHALL BE INCIDENTAL TO THE MASTER CONTROLLER PAY ITEM.

| REVISIONS | |
|-----------|------|
| NAME | DATE |
| | |
| | |
| | |
| | |
| | |
| | |
| | |
| | |
| | |

SETON ENGINEERING
 SERVICE CORPORATION
 CIVIL ENGINEERS
 19 S. BETHWELL STREET
 PALATINE, ILLINOIS 60067
 VOICES 847-776-7200 FAX: 847-776-7239
 SETON PROJECT # 2004008-001-006

ILLINOIS DEPARTMENT OF TRANSPORTATION
TRAFFIC SIGNAL MODIFICATION PLAN
 OAKTON STREET AT LEHIGH AVENUE
 MORTON GROVE, ILLINOIS
 SCALE: 1"=20'
 DATE 09-20-2004
 DRAWN BY BR
 DESIGNED BY VO
 CHECKED BY TJM