

02182

F.A. RTE.	SECTION	COUNTY	TOTAL SHEETS	SHEET NO.
			18	18
STA.		TO STA.		
FED. ROAD DIST. NO.	ILLINOIS	FED. AID PROJECT		

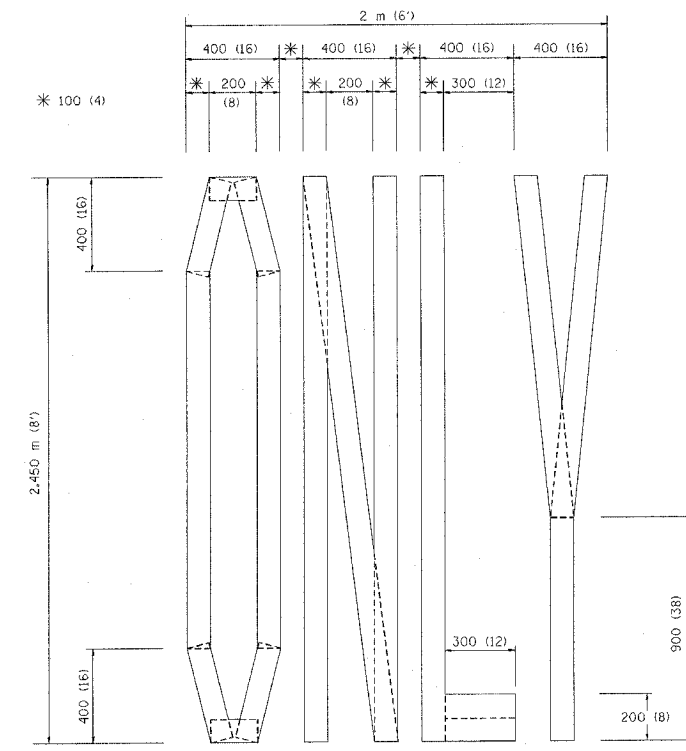

QUANTITY  
 100 (4) LINE = 19.7 m (64.1 ft.)  
 1.97 sq. m (21.1 sq. ft.)

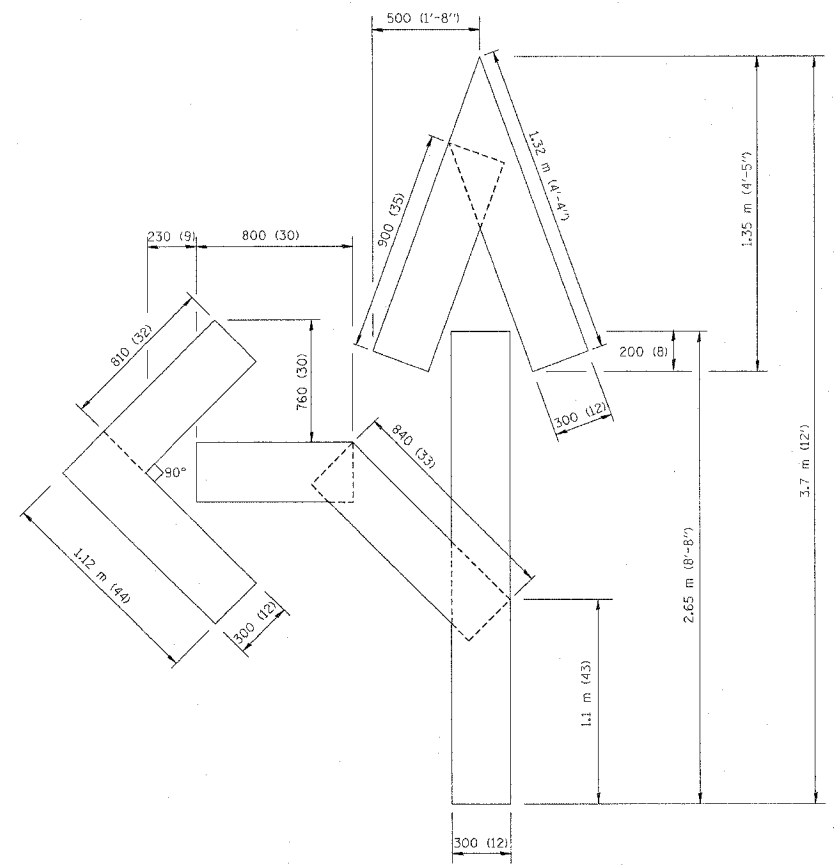

QUANTITY  
 100 (4) LINE = 25.3 m (82.5 ft.)  
 2.53 sq. m (27.5 sq. ft.)

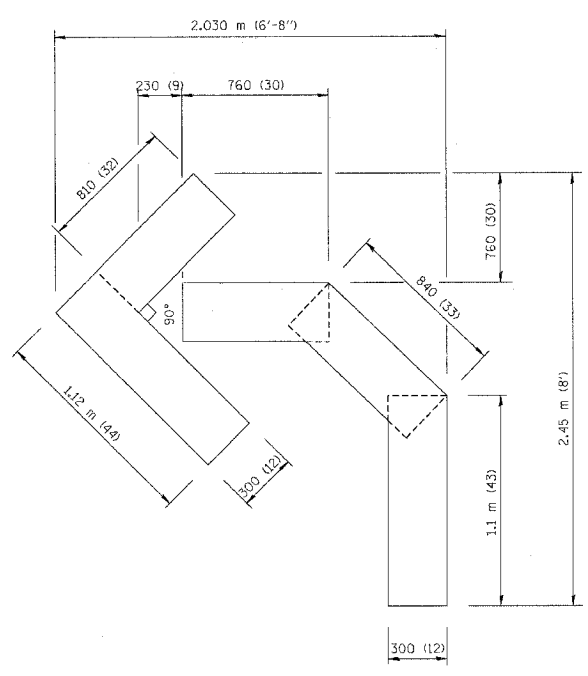

QUANTITY  
 100 (4) LINE = 13.9 m (45.5 ft.)  
 1.39 sq. m (15.2 sq. ft.)

All dimensions are in millimeters (inches) unless otherwise shown.

ILLINOIS DEPARTMENT OF TRANSPORTATION

PAVEMENT MARKING  
 LETTERS AND SYMBOLS  
 FOR TRAFFIC STAGING

REVISIONS	
NAME	DATE
T. RAMMACHER	09/18/94
J. OBERLE	06/01/96
T. RAMMACHER	06/05/96
T. RAMMACHER	11/04/97
T. RAMMACHER	03/02/98
E. GOMEZ	08/28/00

SCALE: NONE  
 DATE: 10/18/2002

DRAWN BY CADD  
 CHECKED BY TC-16

REVISION DATE: 08/28/00