

F.A.I. RTE.	SECTION	COUNTY	TOTAL SHEETS	SHEET NO.
90/94	2004-060PM	COOK	30	19
STA.	TO STA.			
FED. ROAD DIST. NO. 1	ILLINOIS	FED. AID PROJECT	62799	

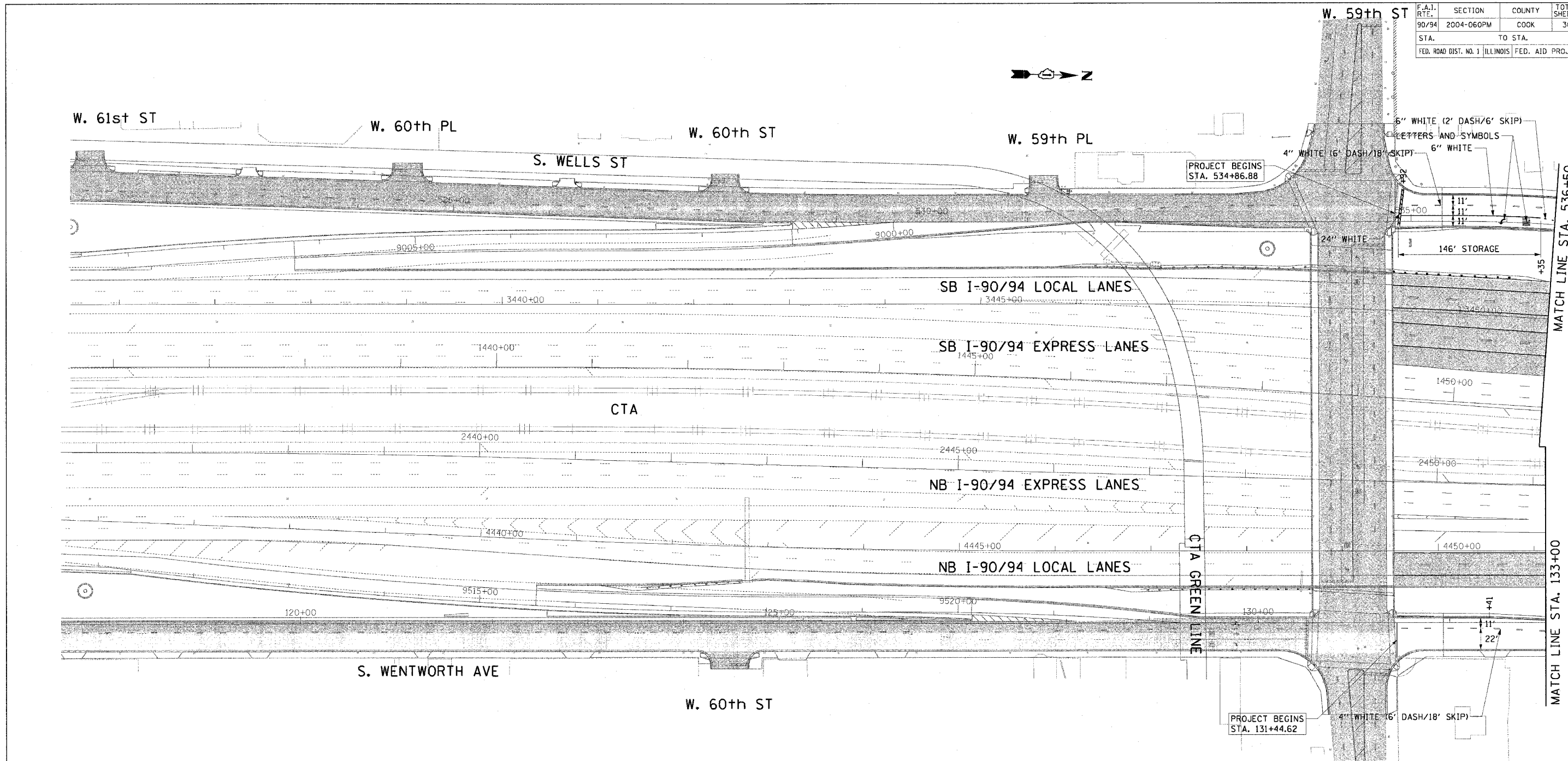

KEY
 [Symbol] PAVEMENT MARKINGS (BY OTHERS)

- NOTES:**
1. ALL PAVEMENT MARKINGS SHALL BE POLYUREA TYPE 1.
 2. SEE DISTRICT 1 STANDARD TC-24 FOR PAVEMENT MARKING DETAILS AND LOCATIONS.
 3. PAVEMENT MARKING ON CROSS STREET BRIDGES ARE SHOWN ON PAVEMENT MARKING PLAN SHEET 8 OF 8.
 4. STOP BAR DIMENSIONS ARE TO THE CENTER OF THE STOP BAR.
 5. STATION CALLOUTS ARE BASED ON THE WELLS ST AND WENTWORTH AVE BASELINES UNLESS OTHERWISE NOTED.
 6. STOP BARS SHALL BE PLACED 4' IN ADVANCE OF AND PARALLEL TO THE CROSSWALK UNLESS OTHERWISE NOTED.

REVISIONS	
NAME	DATE

ILLINOIS DEPARTMENT OF TRANSPORTATION
 F.A.I. 90/94 (DAN RYAN EXPRESSWAY)
 59th ST TO 47th ST (FRONTAGE RD AND RAMP)
PAVEMENT MARKING PLANS
 SCALE: 1"=50'
 DATE: March 4, 2005
 DRAWN BY: SDH
 CHECKED BY: NJH

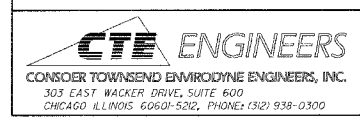

I:\P\0466\CHINA\CHINA-CRTR-9\Add_Ctrr_9\95\59th\59th-Pavement_Markings\PI950502.DWG
 3/4/2005 8:04:52 AM