

FAI RTE	SECTION	COUNTY	TOTAL SHEETS	SHEET NO.
80/94	0203.1B	COOK	200	23
STA.	120+500	TO STA.	120+250	
FED ROAD DIST. NO.	ILLINOIS FED. AID PROJECT			

**LEGEND**

	PAVEMENT REMOVAL
	PAVEMENT BREAKING
	PAVED SHOULDER REMOVAL
	TREE REMOVAL HECTARES
BORXXXXX	SOIL BORING / PAVEMENT CORE NUMBER
XXX	ASPHALT PAVEMENT THICKNESS (MM) UNLESS OTHERWISE NOTED
	BORING / CORE

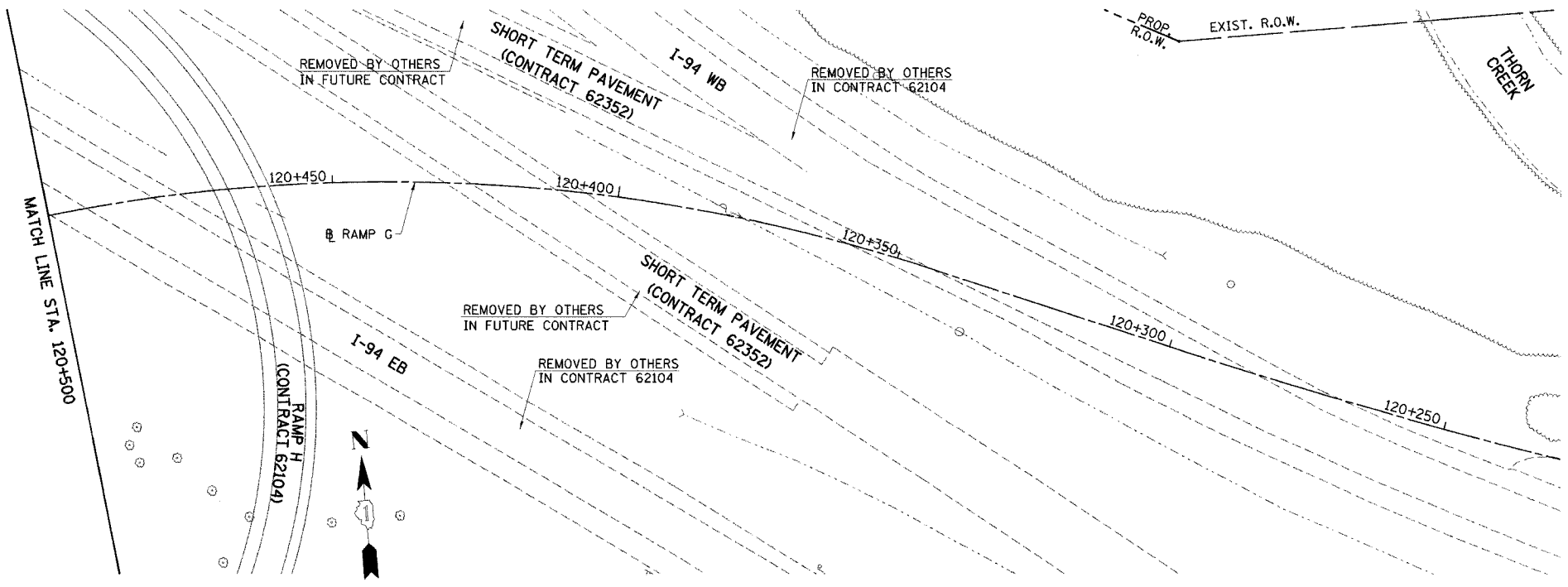

- NOTES:**
- ALL STATIONING AND OFFSET MEASUREMENTS OFF RAMP G UNLESS OTHERWISE NOTED.
  - ALL DIMENSIONS ARE IN METERS (m) UNLESS OTHERWISE NOTED.
  - ALL TREE DIAMETERS ARE IN MILLIMETERS (mm) UNLESS OTHERWISE NOTED.
  - WHERE EXISTING SIGNS INTERFERE WITH CONSTRUCTION OPERATIONS, SEE ARTICLE 107.25 OF THE STANDARD SPECIFICATIONS.
  - SEE CONTRACT 62664 FOR LIGHTING REMOVAL.
  - ALL CONCRETE GUTTER OR COMBINATION CONCRETE CURB AND GUTTER ENCOUNTERED UNDER THE EXISTING BITUMINOUS SURFACE SHALL BE REMOVED AND INCLUDED IN THE COST OF PAVEMENT REMOVAL.

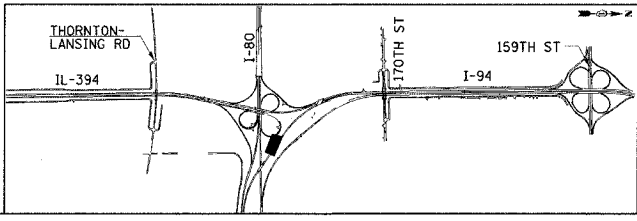
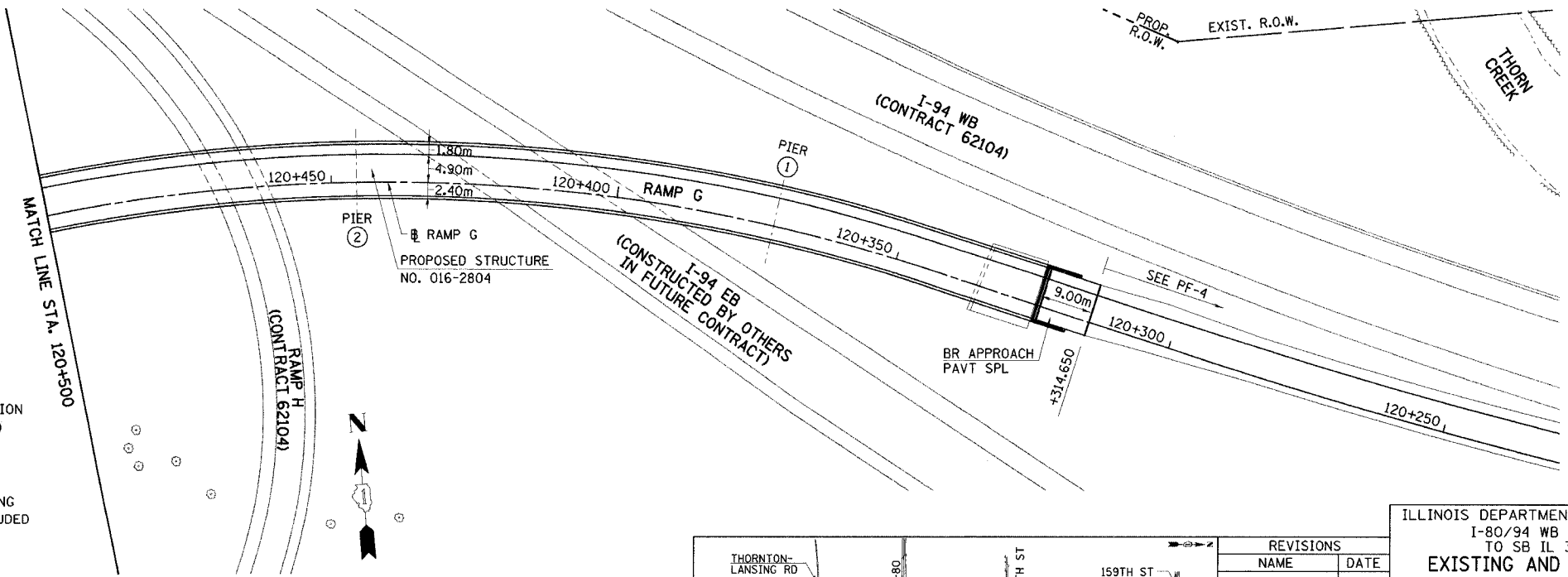

REVISIONS	
NAME	DATE

ILLINOIS DEPARTMENT OF TRANSPORTATION  
 I-80/94 WB FLYOVER RAMP  
 TO SB IL 394 (RAMP G)  
**EXISTING AND PROPOSED PLAN**  
**RAMP G**  
**STA. 120+500 TO STA. 120+250**

HORIZ SCALE: 1:500  
 VERT SCALE:  
 DATE: MARCH 23, 2005

DRAWN BY: JYMC  
 CHECKED BY: JES

