

FAI RTE	SECTION	COUNTY	TOTAL SHEETS	SHEET NO.
80/94	0203.1B	COOK	200	30
STA. 121+050		TO STA. 120+750		
FED ROAD DIST. NO.		ILLINOIS FED. AID PROJECT		

F.A.I. 80/94 (KINGERY EXPRESSWAY) SOIL PROFILE  
ILLINOIS DEPARTMENT OF TRANSPORTATION, COOK COUNTY

HORIZ SCALE: 1:20  
VERT SCALE: 1:10

Wang Engineering, Inc.  
1145 Main Street  
Lombard, IL 60148  
630-953-9928

DRAWN BY: M.L.S.  
CHECKED BY: L.T.

BASED ON DRAWINGS PREPARED BY HNTB CORPORATION 255-08-04

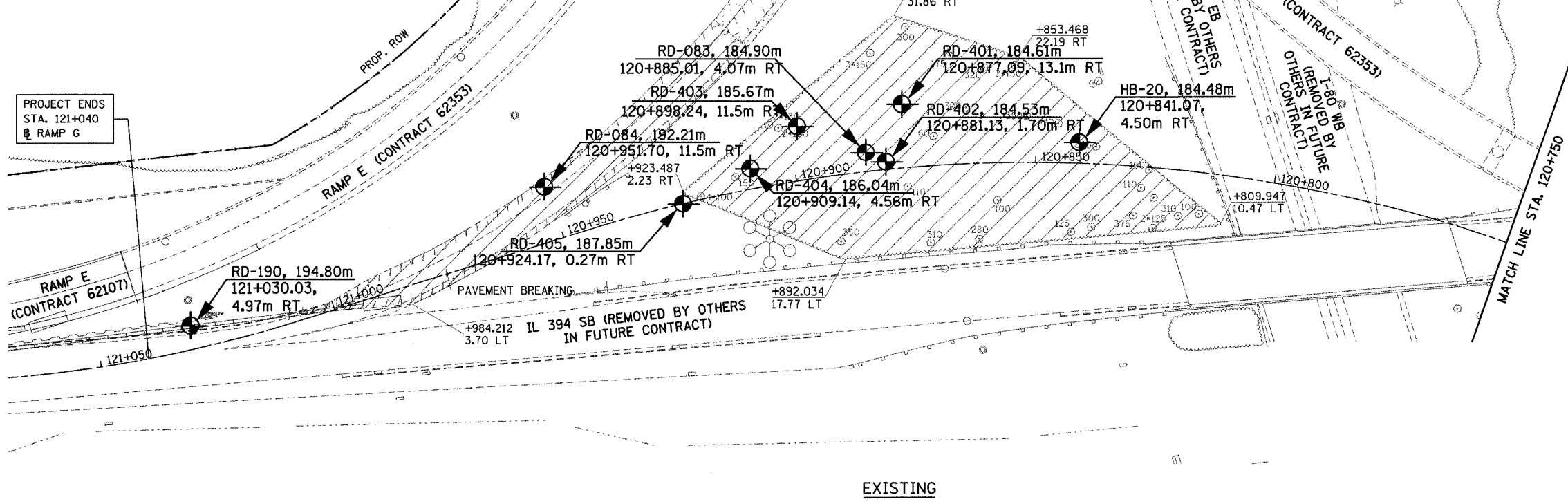

- NOTES:
1. ALL STATIONING AND OFFSET MEASUREMENTS OFF RAMP G UNLESS OTHERWISE NOTED.
  2. ALL DIMENSIONS ARE IN METERS (m) UNLESS OTHERWISE NOTED.

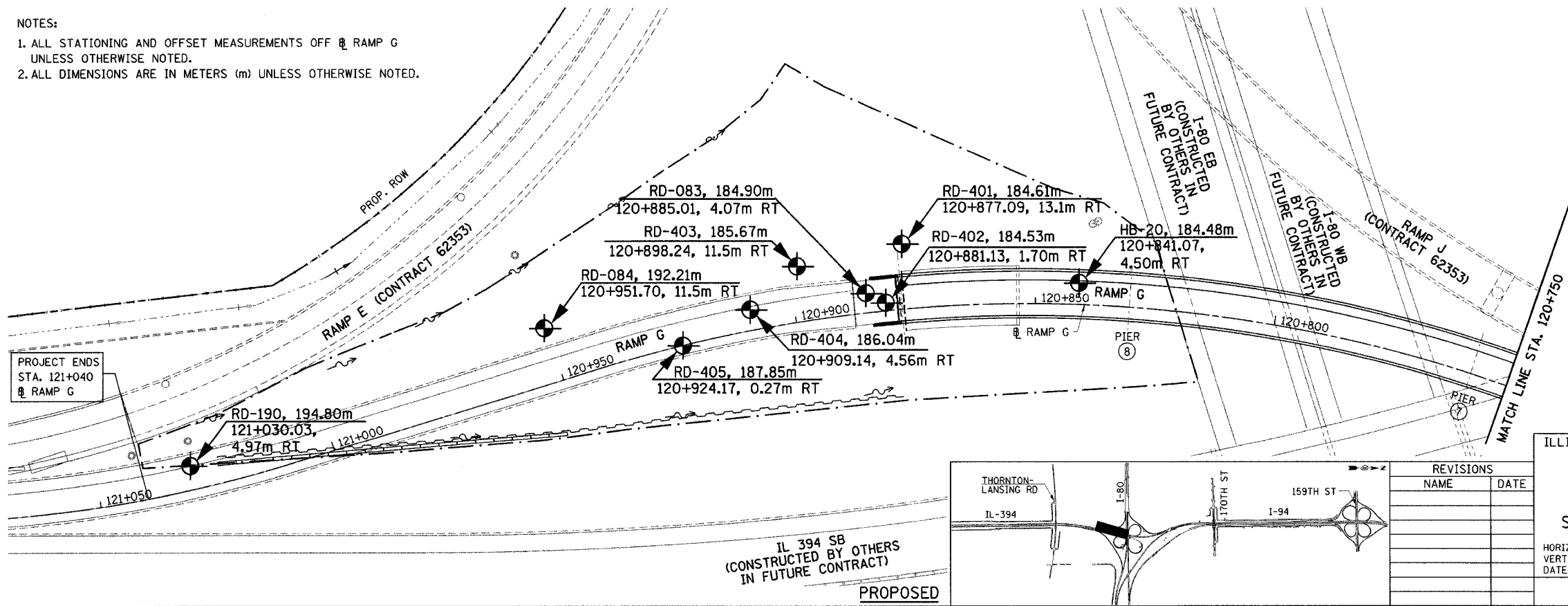

REVISIONS	
NAME	DATE

SB-1  
ILLINOIS DEPARTMENT OF TRANSPORTATION  
I-80/94 WB FLYOVER RAMP  
TO SB IL 394 (RAMP G)  
SOIL BORING PLAN  
RAMP G  
STA. 121+050 TO STA. 120+750

HORIZ SCALE: 1:500  
VERT SCALE:  
DATE: MARCH 23, 2005

DRAWN BY:  
CHECKED BY: