

| | | | | |
|--------------------|---------|---------------------------|--------------|-----------|
| F.A.I. RTE | SECTION | COUNTY | TOTAL SHEETS | SHEET NO. |
| 80/94 | 0203.1B | COOK | 200 | 32 |
| STA. 120+314.500 | | TO STA. 120+575 | | |
| FED ROAD DIST. NO. | | ILLINOIS FED. AID PROJECT | | |

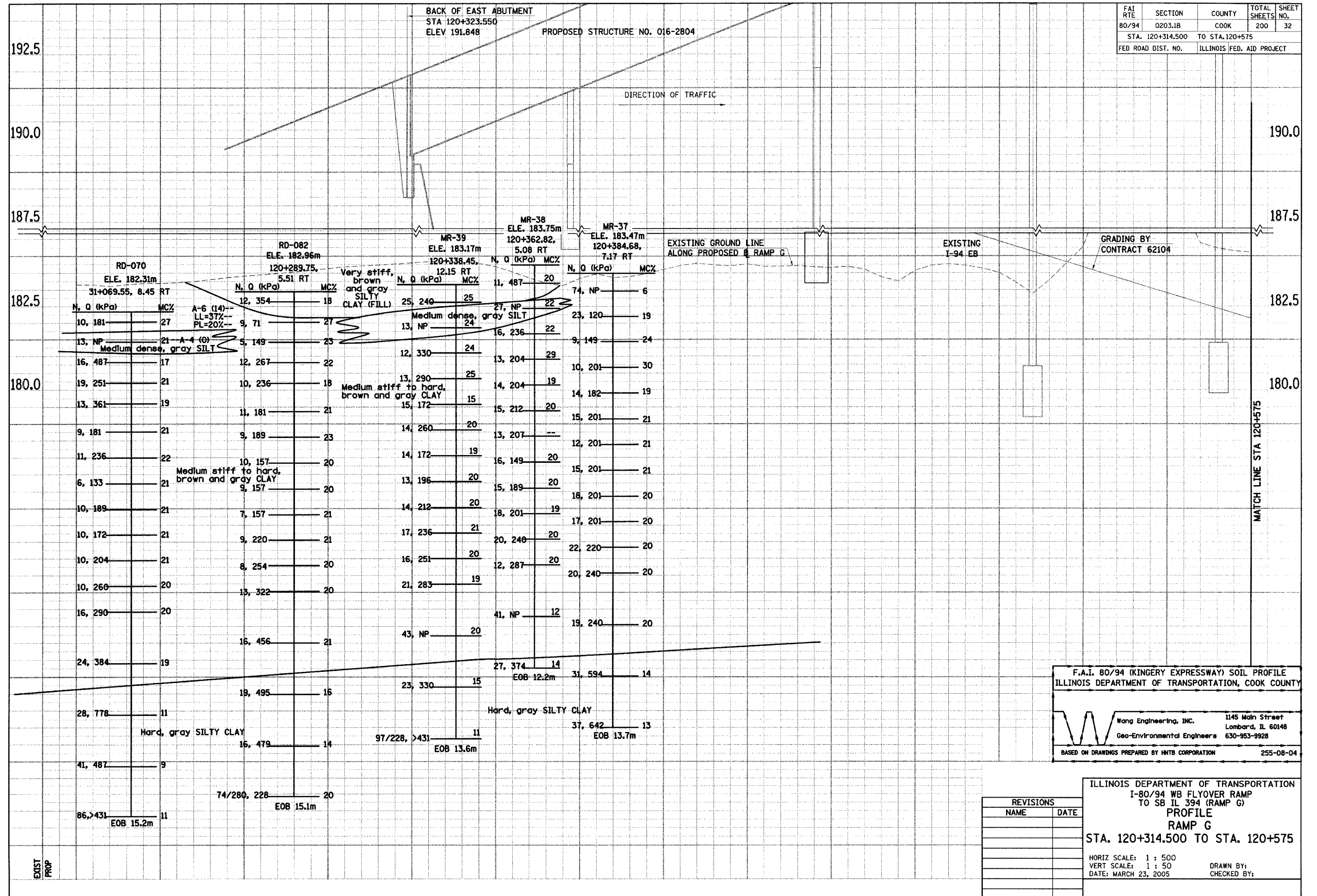

F.A.I. 80/94 (KINGERY EXPRESSWAY) SOIL PROFILE
ILLINOIS DEPARTMENT OF TRANSPORTATION, COOK COUNTY

Wang Engineering, Inc. 1145 Main Street
Lombard, IL 60148
Geo-Environmental Engineers 630-953-9928

BASED ON DRAWINGS PREPARED BY HNTB CORPORATION 255-08-04

ILLINOIS DEPARTMENT OF TRANSPORTATION
I-80/94 WB FLYOVER RAMP
TO SB IL 394 (RAMP G)
PROFILE
RAMP G
STA. 120+314.500 TO STA. 120+575

HORIZ SCALE: 1 : 500
VERT SCALE: 1 : 50
DATE: MARCH 23, 2005

DRAWN BY:
CHECKED BY:

| REVISIONS | |
|-----------|------|
| NAME | DATE |
| | |
| | |
| | |
| | |
| | |