

FAI RTE	SECTION	COUNTY	TOTAL SHEETS	SHEET NO.
80/94	0203.1B	COOK	200	39
STA.	120+750	TO STA.	120+500	
FED ROAD DIST. NO.	ILLINOIS FED. AID PROJECT			

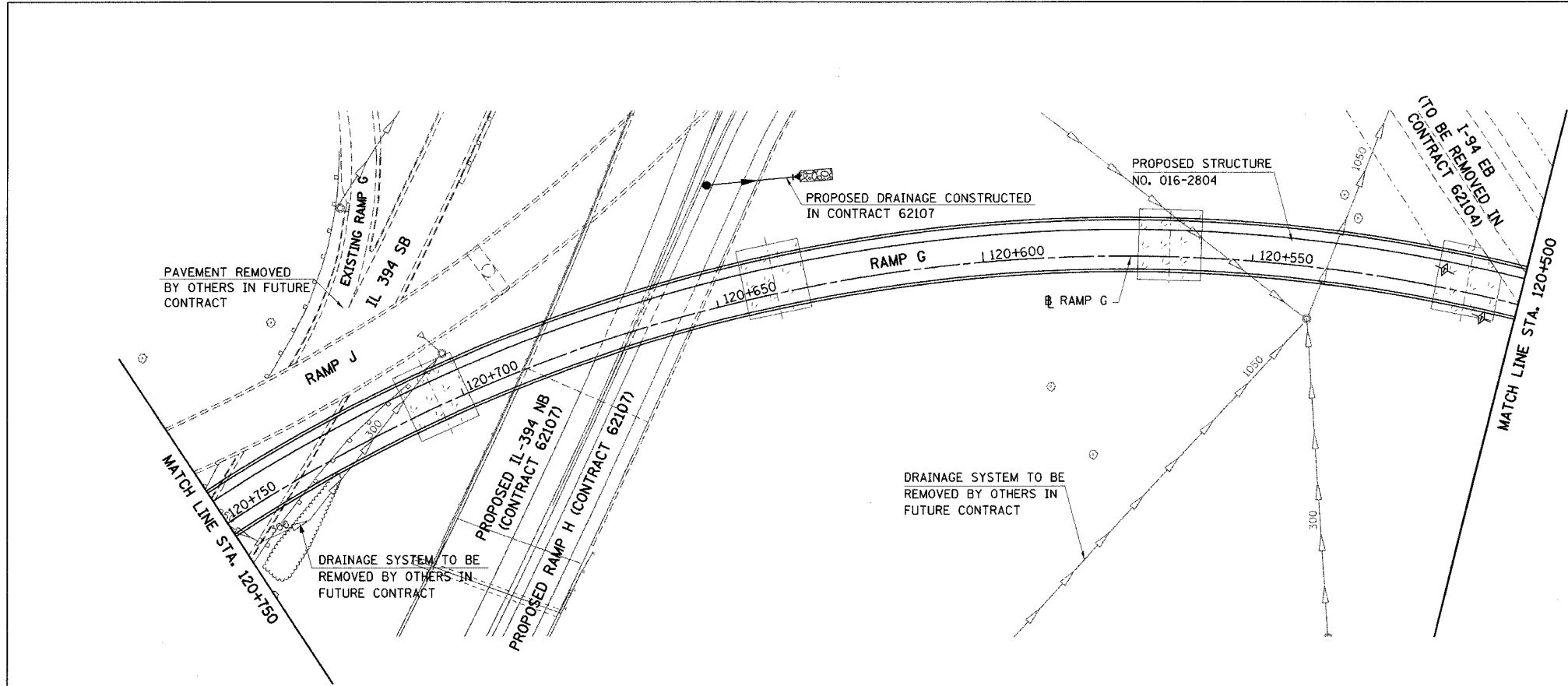

DURING CONSTRUCTION

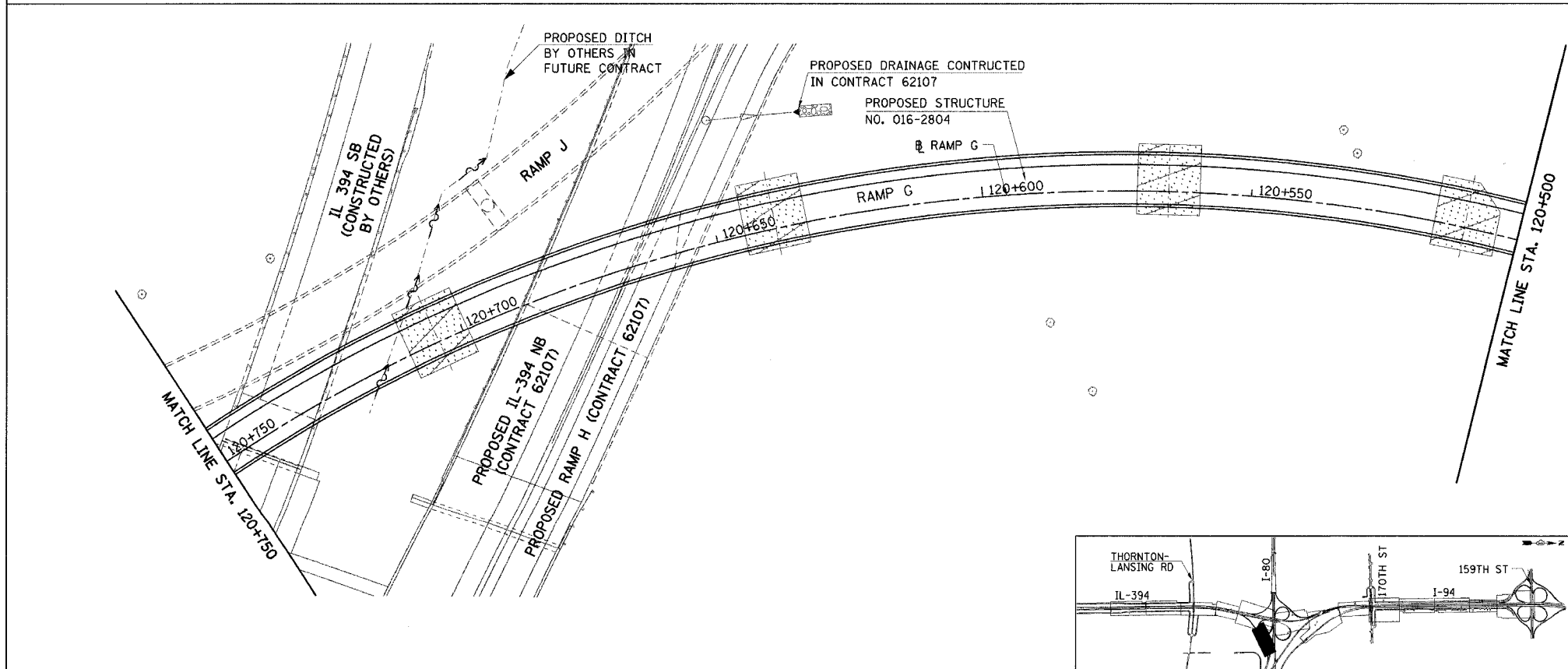

FINAL CONDITION

- NOTES:
1. ALL STATIONING AND OFFSET MEASUREMENTS OFF @ RAMP G UNLESS OTHERWISE NOTED.
  2. ALL DIMENSIONS ARE IN METERS (m) UNLESS OTHERWISE NOTED.
  3. SEEDING UNDER RAMP G IS TO BE PLACED 3 METERS SURROUNDING THE PROPOSED PIER LOCATIONS.
  4. CONTRACTOR TO COORDINATE EROSION CONTROL WORK WITH ADJACENT CONTRACTS.

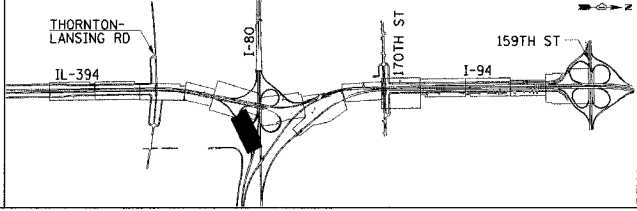

REVISIONS	
NAME	DATE

EC-4  
ILLINOIS DEPARTMENT OF TRANSPORTATION  
I-80/94 WB FLYOVER RAMP  
TO SB IL 394 (RAMP G)  
**DRAINAGE AND EROSION  
CONTROL PLANS - RAMP G**  
STA. 120+750 TO STA. 120+500  
HORIZ SCALE: 1:500  
VERT SCALE: NONE  
DATE: MARCH 23, 2005  
DRAWN BY: JYMC  
CHECKED BY: MAM  
**HNTB**