

FBI RTE	SECTION	COUNTY	TOTAL SHEETS	SHEET NO.
80/94	0203.1B	COOK	200	57
STA. 120+600		TO STA. 120+900		
FED ROAD DIST. NO.		ILLINOIS FED. AID PROJECT		

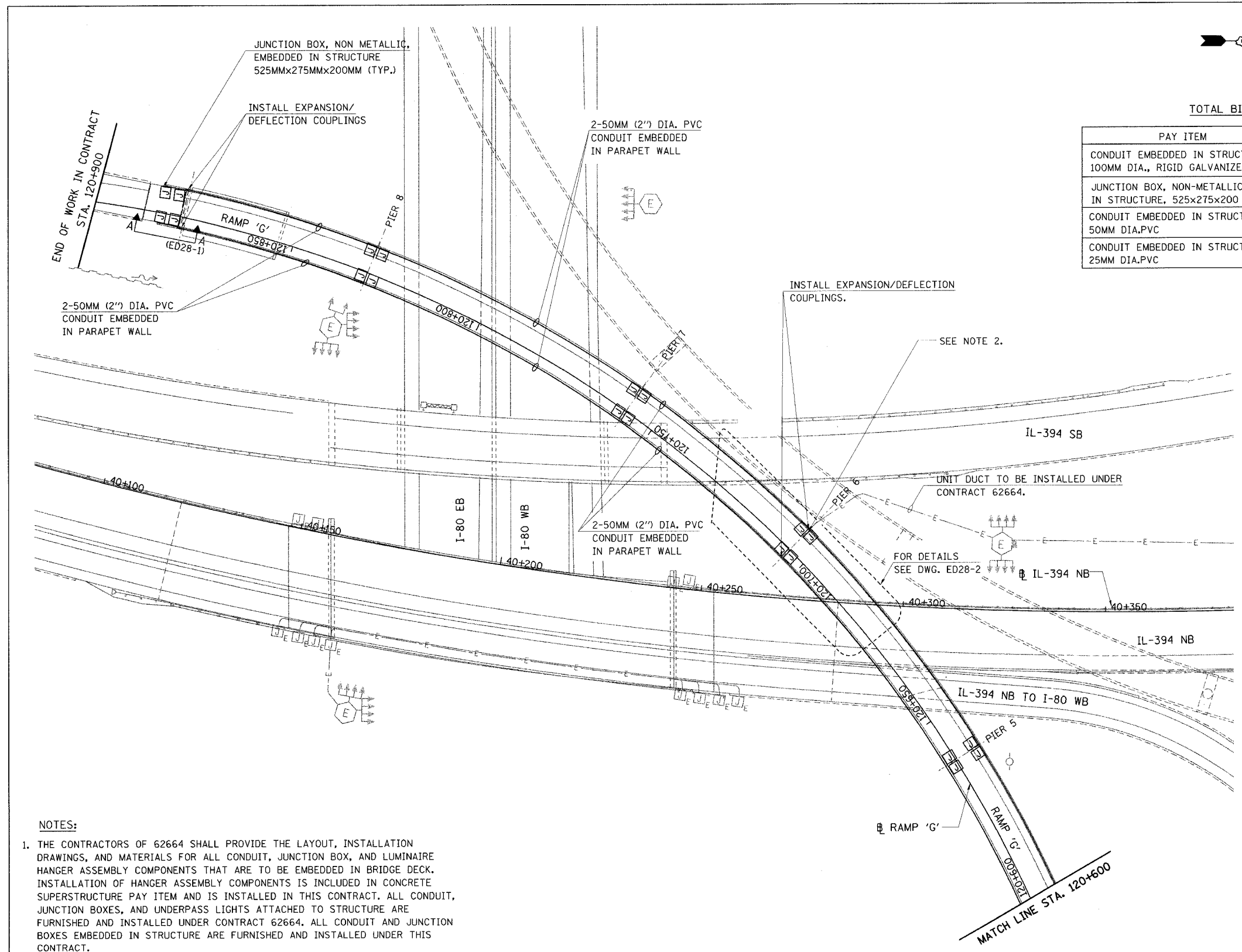

TOTAL BILL OF MATERIALS

PAY ITEM	UNITS	TOTAL
CONDUIT EMBEDDED IN STRUCTURE, 100MM DIA., RIGID GALVANIZED STEEL	METER	112
JUNCTION BOX, NON-METALLIC, EMBEDDED IN STRUCTURE, 525x275x200	EACH	40
CONDUIT EMBEDDED IN STRUCTURE, 50MM DIA.PVC	METER	2293
CONDUIT EMBEDDED IN STRUCTURE, 25MM DIA.PVC	METER	11



NOTES:

1. THE CONTRACTORS OF 62664 SHALL PROVIDE THE LAYOUT, INSTALLATION DRAWINGS, AND MATERIALS FOR ALL CONDUIT, JUNCTION BOX, AND LUMINAIRE HANGER ASSEMBLY COMPONENTS THAT ARE TO BE EMBEDDED IN BRIDGE DECK. INSTALLATION OF HANGER ASSEMBLY COMPONENTS IS INCLUDED IN CONCRETE SUPERSTRUCTURE PAY ITEM AND IS INSTALLED IN THIS CONTRACT. ALL CONDUIT, JUNCTION BOXES, AND UNDERPASS LIGHTS ATTACHED TO STRUCTURE ARE FURNISHED AND INSTALLED UNDER CONTRACT 62664. ALL CONDUIT AND JUNCTION BOXES EMBEDDED IN STRUCTURE ARE FURNISHED AND INSTALLED UNDER THIS CONTRACT.
2. A CONDUIT ASSEMBLY WILL BE MOUNTED TO PIER TO FEED PROPOSED UNDERPASS LIGHTS UNDER CONTRACT 62664. ALL INSERTS USED TO MOUNT CONDUITS WILL BE PRE-CAST INTO THE CONCRETE. NO DRILLED IN TYPE INSERTS WILL BE PERMITTED. THE PIER CONDUIT HANGER ASSEMBLIES WILL BE FURNISHED AND INSTALLED UNDER CONTRACT 62664. A CONDUIT STUB FROM JUNCTION BOX LOCATED IN PARAPET TO UNDERSIDE OF BRIDGE DECK WILL BE INSTALLED AT THIS LOCATION UNDER THIS CONTRACT. SEE DETAILS A & B ON DRAWING ED28-1 FOR CONDUIT LOCATED IN BRIDGE DECK.

RL28-1

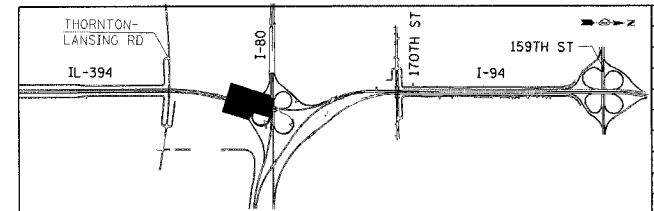

REVISIONS	
NAME	DATE

ILLINOIS DEPARTMENT OF TRANSPORTATION  
 I-80/94 WB FLYOVER RAMP  
 TO SB IL 394 (RAMP G)  
**CONDUIT AND JUNCTION BOX PLAN**  
 STA. 120+600 TO 120+900

HORIZ SCALE: 1:500  
 VERT SCALE: NONE  
 DATE: MARCH 23, 2005

DRAWN BY: SPR  
 CHECKED BY: BB

**HNTB**