

Benchmarks: BM 3553 Set "+" northwest bolt of traffic signal/light base at northeast intersection of 87th St. and State St. El. 8.47

Existing Structure: None.

Begin Wall Sta. 2270+12.20

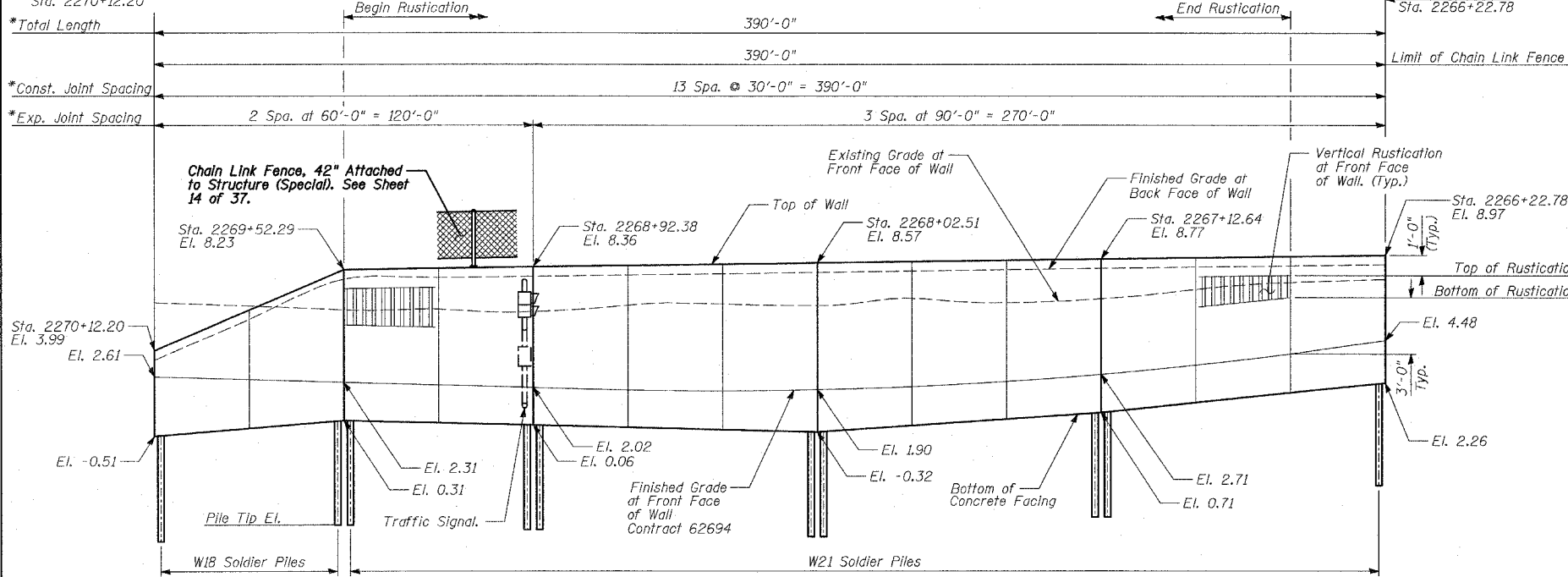

ELEVATION

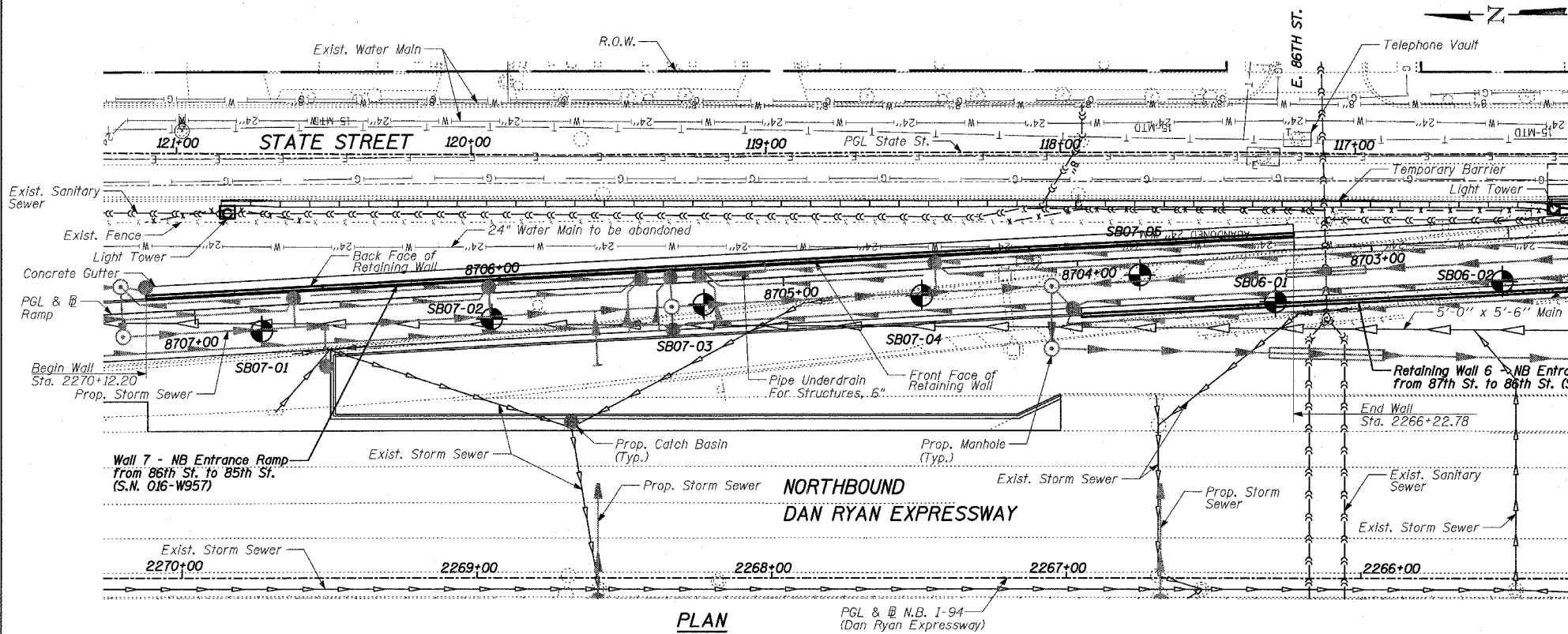

PLAN

LEGEND

- Boring Location
- * Measured along Front Face of Wall.

TYLIN INTERNATIONAL

F.A.I. RTE.	SECTION	COUNTY	TOTAL SHEETS	SHEET NO.
94		COOK	37	13
STA. 2210+00.00 TO STA. 2356+00.00				
FED. ROAD DIST. NO. ILLINOIS FED. AID PROJECT				
(1516.1, 1717 & 1818) I-3				
				62932

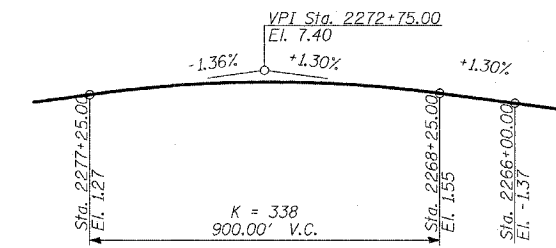

PROFILE GRADE

(N.B. I-94)

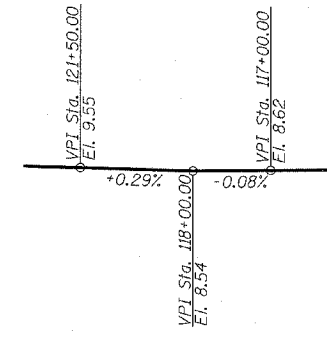

PROFILE GRADE

(State Street)

DESIGN SPECIFICATION

AASHTO 2002 Standard Specifications for Highway Bridges

DESIGN STRESSES

FIELD UNITS

- $f'_c = 3,500$ psi
- $f_y = 60,000$ psi (Reinforcement)
- $f_y = 36,000$ psi (M270 Grade 36) Soldier Piles

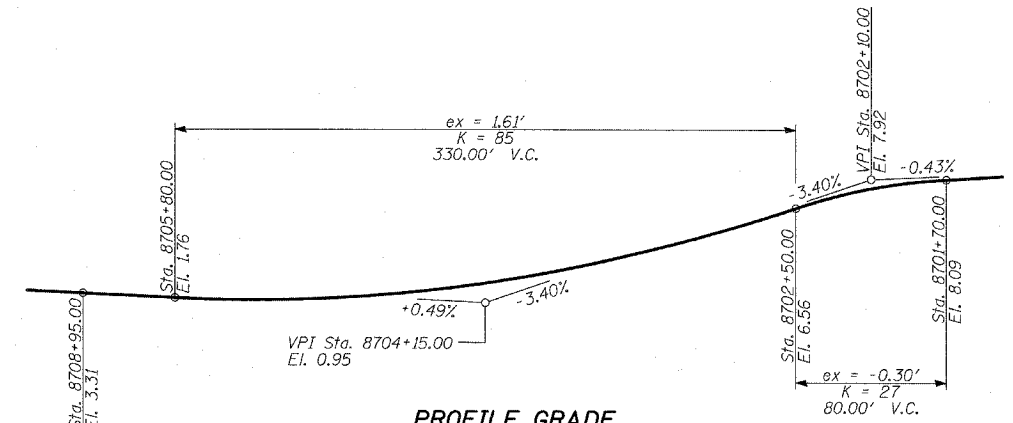

PROFILE GRADE

(Ramp)

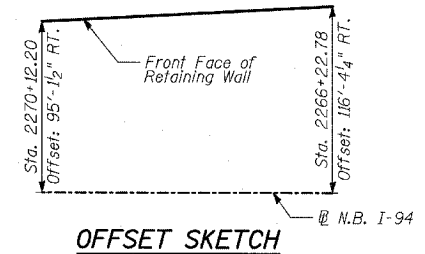

OFFSET SKETCH

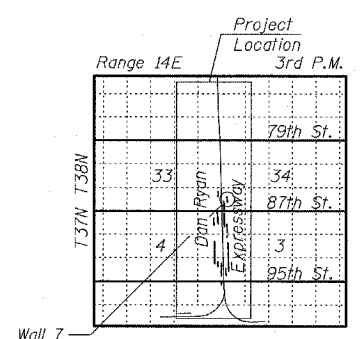

LOCATION SKETCH

REVISIONS	
NAME	DATE

ILLINOIS DEPARTMENT OF TRANSPORTATION
F.A.I. 94 (DAN RYAN EXPRESSWAY)
RETAINING WALL ALONG STATE ST.
ENTRANCE RAMP FROM 86TH ST. TO 85TH ST.
WALL 7 - GENERAL PLAN
STA. 2270+12.20 TO STA. 2266+22.78
 S.N. 016-W957 DESIGNED BY: MI, TB
 SCALE: N.T.S. DRAWN BY: TB, DJR
 DATE: APRIL 15, 2005 CHECKED BY: TD, MI

04/15/2005 07:29:04 AM