

Benchmarks: BM 3556 Set "+" easterly flange bolt of hydrant at northeast corner of 75th St. and State St. El. 9.06

Existing Structure: None.

Begin Wall
Offset: 150.99' Rt.
Sta. 2355+21.18

Chain Link Gate Assembly (Special)
See Sheets 28, 29, 32 & 33 of 37.

Chain Link Gate Assembly (Special)
See Sheets 28, 29, 32 & 33 of 37.

End Wall
Offset: 150.99' Rt.
Sta. 2350+71.18

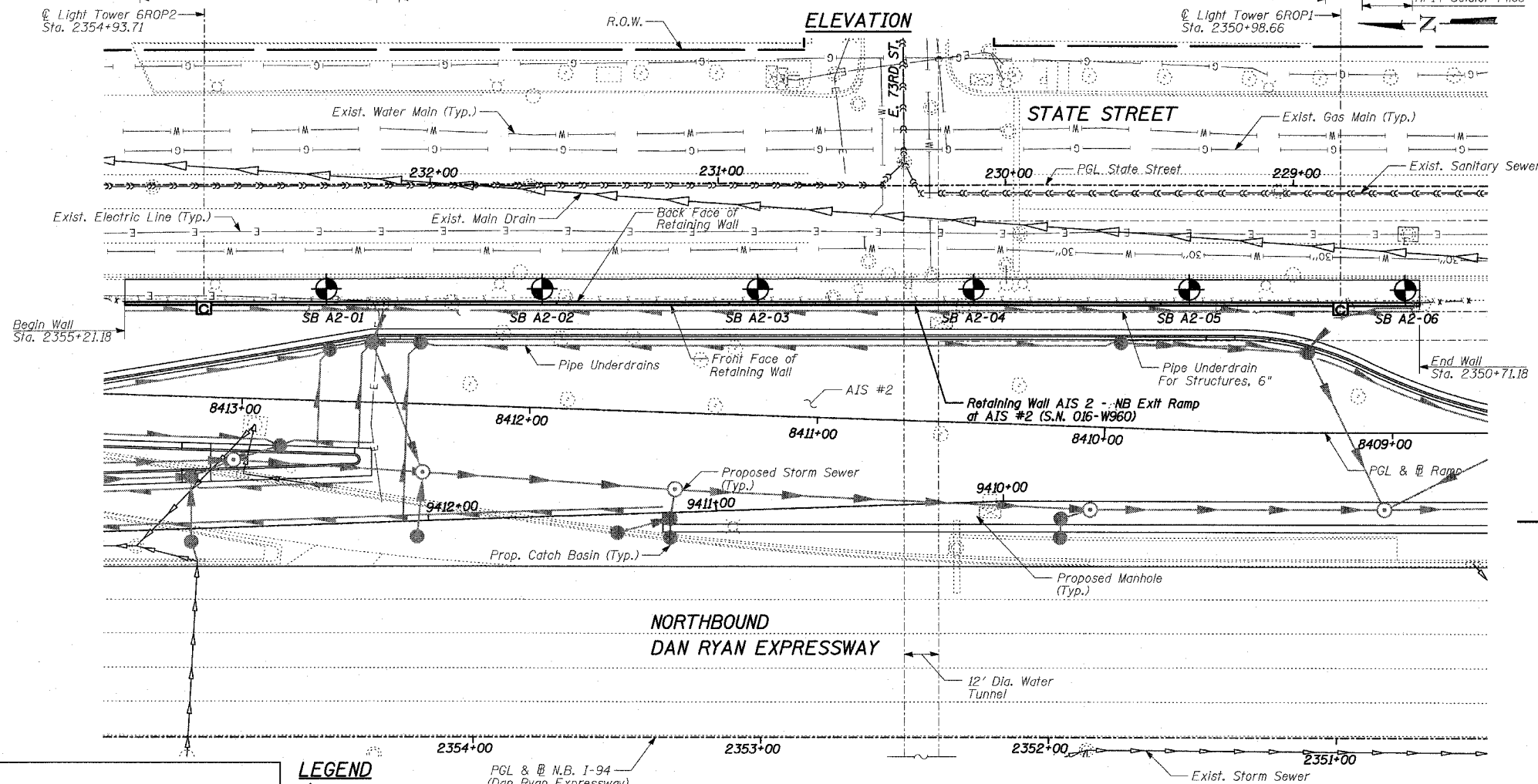
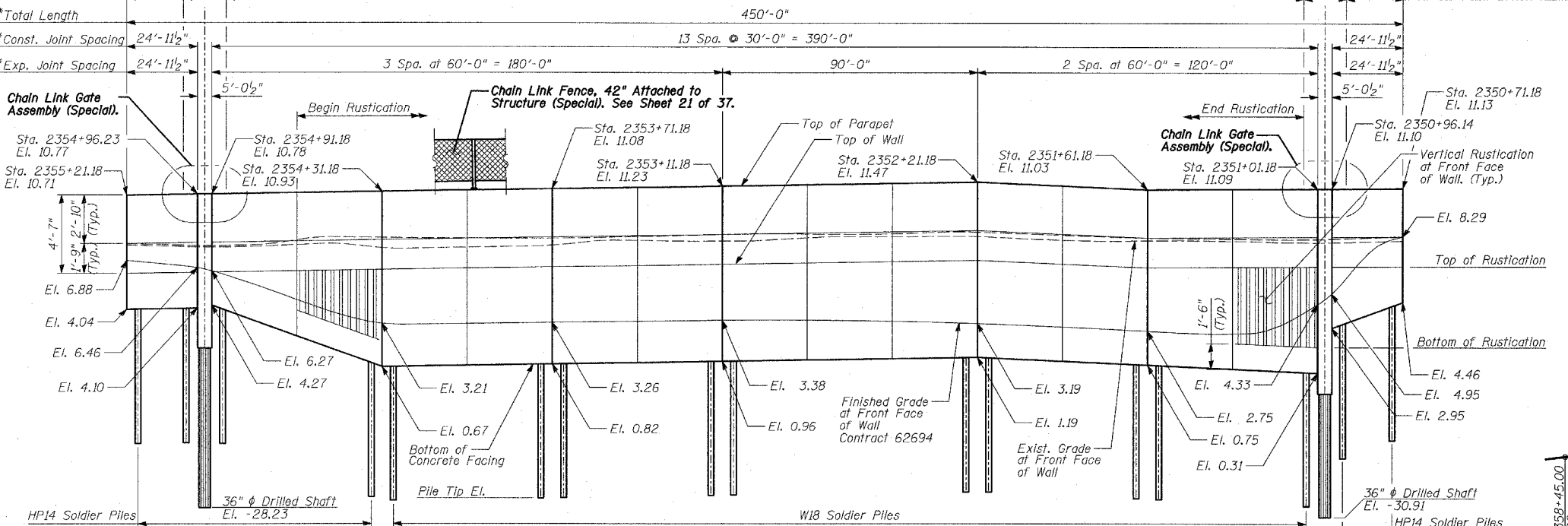

TYLIN INTERNATIONAL

LEGEND
 Boring Location
 Measured along Front Face of Wall.

PLAN

F.A.I. RTE.	SECTION	COUNTY	TOTAL SHEETS	SHEET NO.
94		COOK	37	20
STA. 2210+00.00 TO STA. 2356+00.00				
FED. ROAD DIST. NO. ILLINOIS FED. AID PROJECT				
▪ (1516.1, 1717 & 1818) I-3				
62932				

DESIGN SPECIFICATION

AASHTO 2002 Standard Specifications for Highway Bridges

DESIGN STRESSES

FIELD UNITS
 $f'_c = 3,500$ psi
 $f_y = 60,000$ psi (Reinforcement)
 $f_y = 36,000$ psi (M270 Grade 36) Soldier Piles

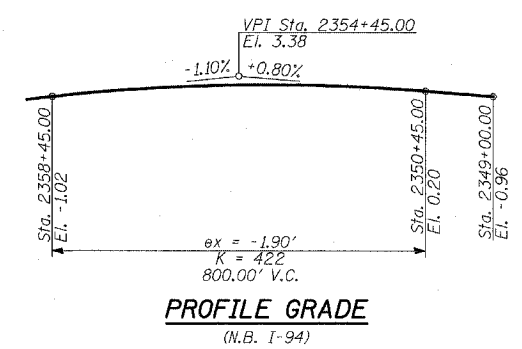

PROFILE GRADE
(N.B. I-94)

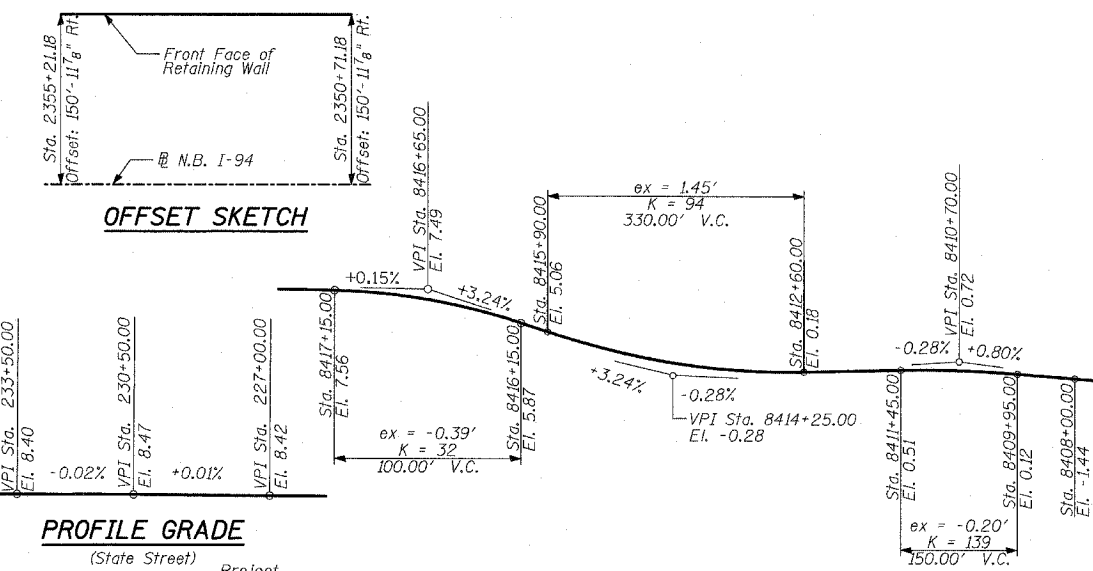

OFFSET SKETCH

PROFILE GRADE
(State Street)

PROFILE GRADE
(Ramp)

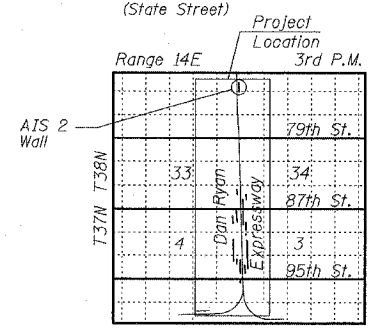

LOCATION SKETCH

REVISIONS	
NAME	DATE

ILLINOIS DEPARTMENT OF TRANSPORTATION
F.A.I. 94 (DAN RYAN EXPRESSWAY)
RETAINING WALL ALONG STATE ST.
EXIT RAMP AT AIS #2
AIS 2 - GENERAL PLAN
STA. 2355+21.18 TO STA. 2350+71.18
 S.N. 016-W960 DESIGNED BY: MI, DJR
 SCALE: N.T.S. DRAWN BY: DJR, TB
 DATE: APRIL 15, 2005 CHECKED BY: TD, MI

04/15/2005 07:29:57 AM