

MATCHLINE RAMP STA. 8701+00

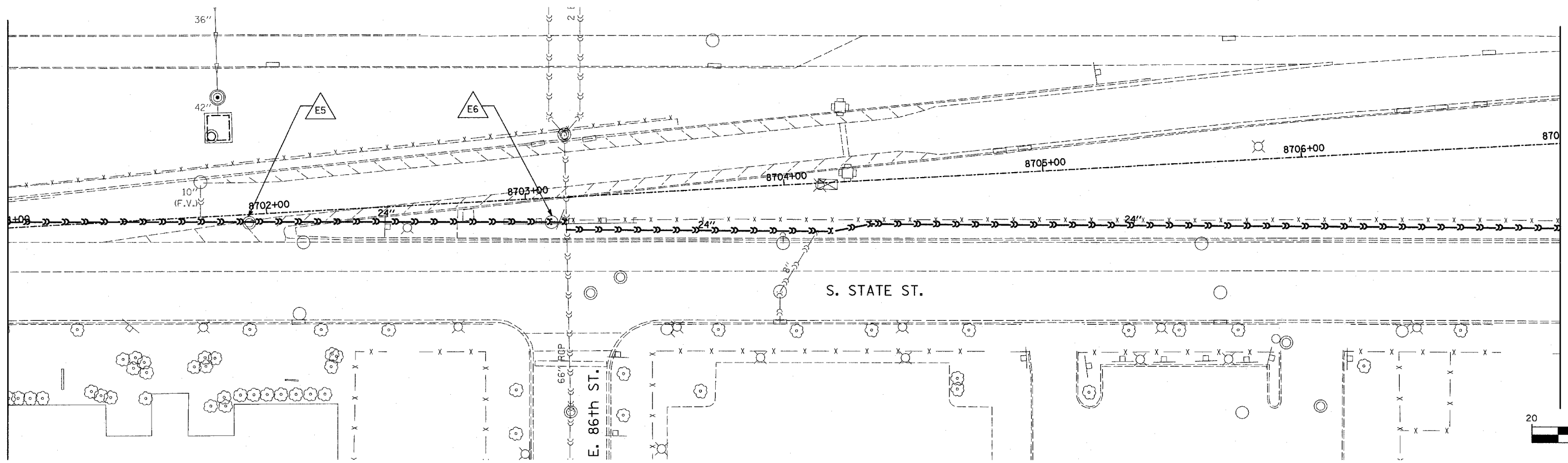

MATCHLINE RAMP STA. 8701+00

MATCHLINE RAMP STA. 8707+00

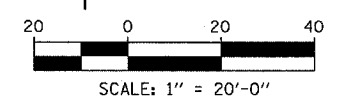
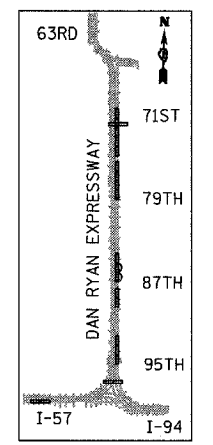

- LEGEND:**
- — — — — EXISTING COMBINED SEWER
 - — — — — EXISTING COMBINED SEWER TO BE TELEVIEWED
 - △ XY MANHOLE STRUCTURE NO.

REVISIONS	
NAME	DATE

ILLINOIS DEPARTMENT OF TRANSPORTATION
 F.A.I. 94 (DAN RYAN EXPRESSWAY)
**SEWER TELEVIEWING
 87TH ENTRANCE RAMP**

SCALE: 1"=20'-0"
 DATE: APRIL 15, 2005

DRAWN BY: DE, AMB
 CHECKED BY: TGB

TYLIN INTERNATIONAL

4/17/2005 9:44:28 AM