

EVENLYN J. WILKEN

WALTER W. PAUL

F.A. RTE.	SECTION	COUNTY	TOTAL SHEETS	SHEET NO.
549	J16RS-1	OGL	593	74
STA. 419+00		TO STA. 435+00		
FED. ROAD DIST. NO.		ILLINOIS FED. AID PROJECT		

DRAINAGE AREA = 1.62 sq mi		LOW GRADE ELE (FT) 878.88 @ Top of PE Culvert					
FLOOD FREQUENCY (YEAR)	Q C.F.	OPENING (SQ FT) EXI	NAT. H. ELEV.	HEAD (FT) EXIST	HEAD (FT) PROP	HEADWATER ELE (FT) EXIS	HEADWATER ELE (FT) PROP
TEN-YEAR	10	480	93.4	92.8	875.80	0.00	0.00
DESIGN	30	605	104.0	96.0	876.39	0.00	0.04
BASE	100	797	108.0	96.0	876.84	0.24	0.95
OVERTOP EX							
OVERTOP PR	190	892		96.0	877.20		1.78
							878.98

Existing Structure Velocity (10-Yr): 6.7 fps
 Proposed Structure Velocity (10-Yr): 9.7 fps

REMARKS: 1. The existing 2-cell 8x6 ft. box culvert carrying a Private Entrance is oversized. The proposed structure is a 2-cell 8x8 ft. box culvert with precast end sections.
 2. The design year flood elevation is lower than the highway elevation.

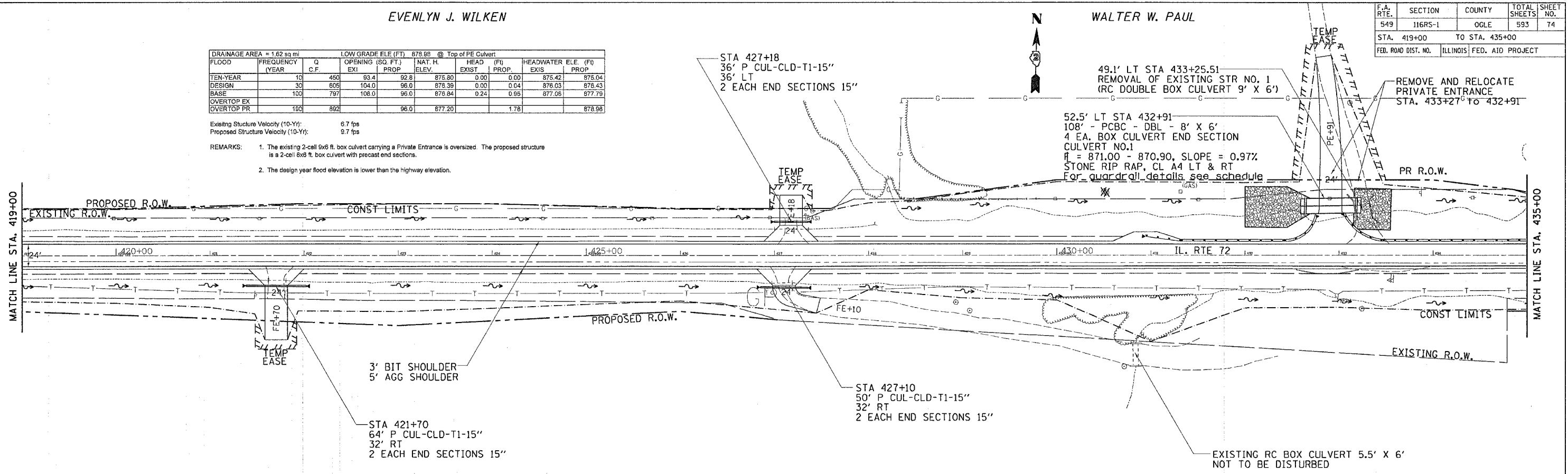

BARTELS FARMING CORP.

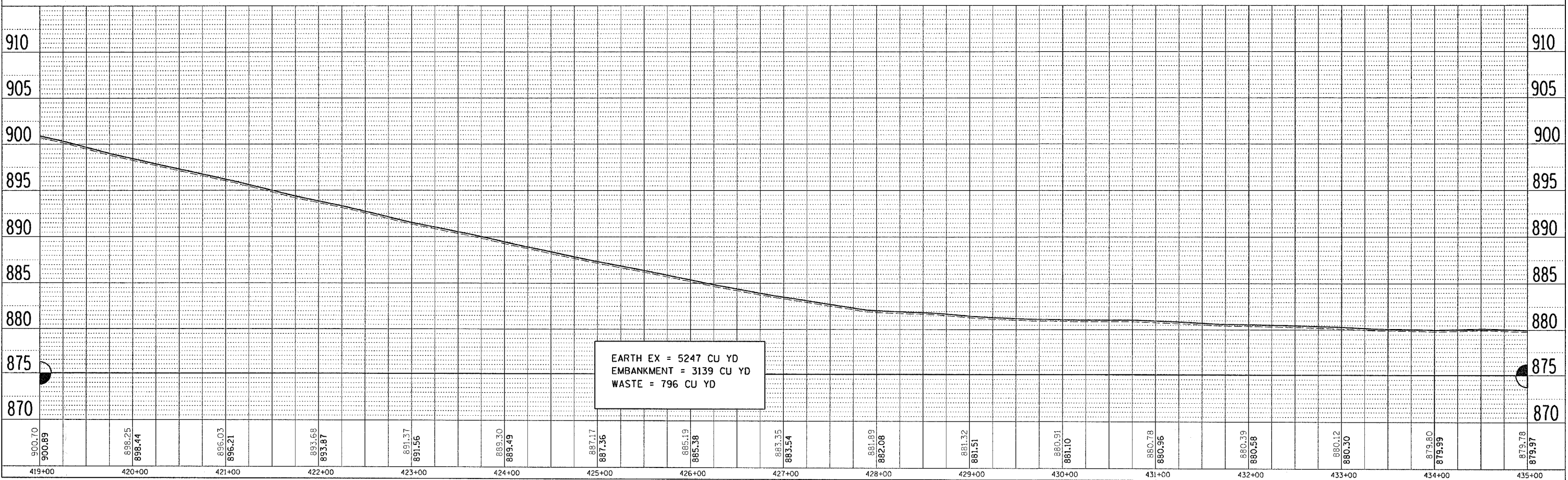

DATE	BY

DATE	BY

DATE-TIME
 COND-SEC
 REF-REF