

F.A. RTE.	SECTION	COUNTY	TOTAL SHEETS	SHEET NO.
549	116RS-1	OGLD	593	91
STA. 691+00		TO STA. 707+00		
FED. ROAD DIST. NO.		ILLINOIS FED. AID PROJECT		

ALL RAILROAD COMMUNICATION POLES LOCATED WITHIN TEMPORARY EASEMENT LIMITS, INCLUDING WIRING AND GUY WIRES, SHALL BE REMOVED BY AND BECOME THE PROPERTY OF THE CONTRACTOR. THIS WORK SHALL BE INCLUDED IN THE UNIT COST PER CUBIC YARD FOR EARTH EXCAVATION. LT. STA. 697+00 TO THE END OF THE PROJECT.

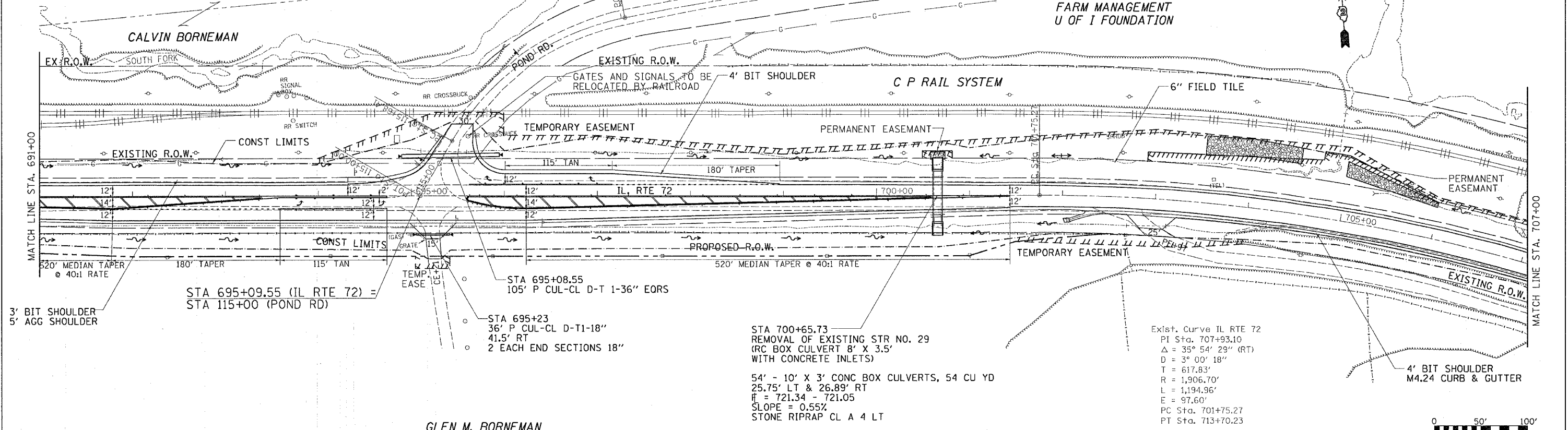

PLAN	DATE	BY
SURVEYED		
NOTED		
DESIGNED		
CHECKED		
APPROVED		

PROFILE	DATE	BY
SURVEYED		
NOTED		
DESIGNED		
CHECKED		
APPROVED		

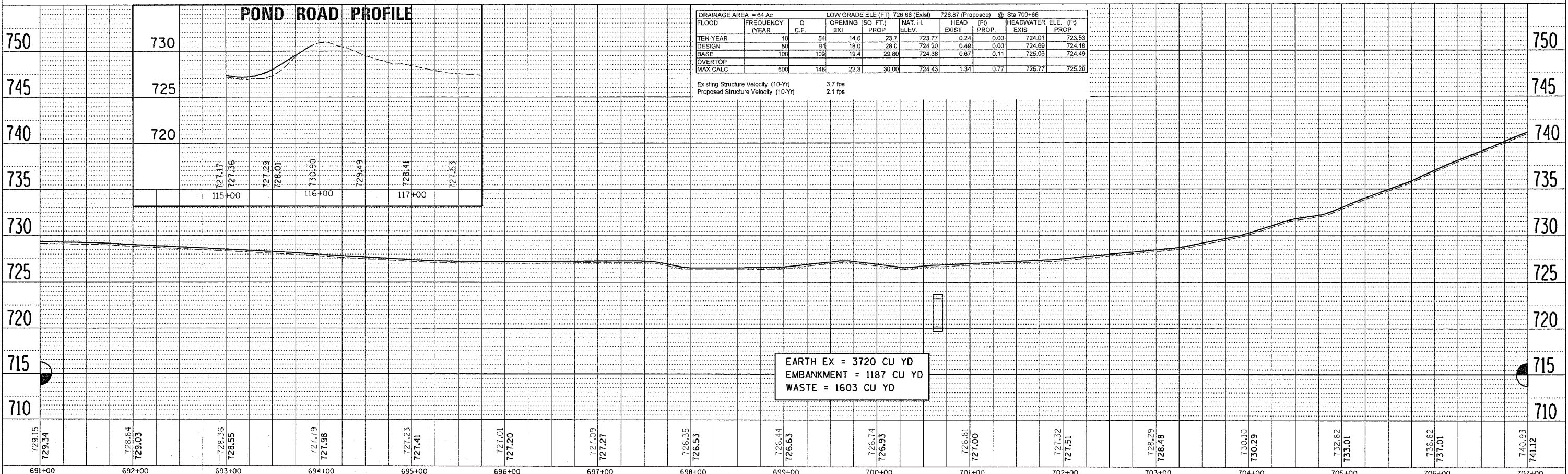

DRAINAGE AREA = 64 Ac		LOW GRADE ELE (F) 726.68 (Exist) 726.87 (Proposed) @ Sta 700+66								
FLOOD YEAR	FREQUENCY	Q C.F.	OPENING (SQ. FT.) EXI PROP	NAT. H. ELEV	HEAD EXIST (F)	HEAD PROP (F)	HEADWATER ELE. (F) EXIS PROP			
10	10	54	14.8	23.7	723.77	0.24	0.00	724.01	723.53	
50	50	91	18.0	28.0	724.20	0.48	0.00	724.69	724.18	
100	100	103	19.4	28.80	724.38	0.67	0.11	725.05	724.49	
OVERTOP										
MAX CALC		600	148	22.3	30.00	724.43	1.34	0.77	726.77	725.20

Existing Structure Velocity (10-Yr) 3.7 fps  
Proposed Structure Velocity (10-Yr) 2.1 fps

EARTH EX = 3720 CU YD  
EMBANKMENT = 1187 CU YD  
WASTE = 1603 CU YD