

FAP RTE.	SECTION	COUNTY	TOTAL SHEETS	SHEET NO.
553	120RS-3	OGLE	145	33
STA.	TO STA.			
FED. ROAD DIST. NO.	ILLINOIS	FED. AID PROJECT		

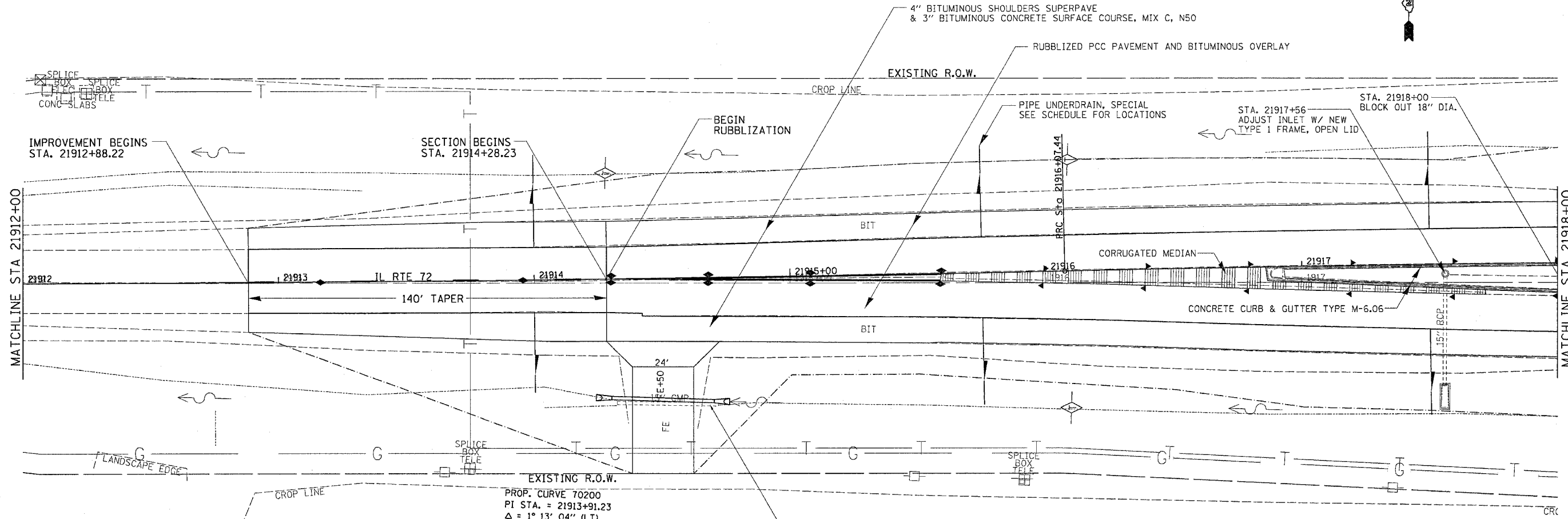

PROP. CURVE 70200
 PI STA. = 21913+91.23
 $\Delta = 1^\circ 13' 04''$ (LT)
 $D = 0^\circ 16' 54''$
 $R = 20,343.89'$
 $T = 216.22'$
 $L = 432.42'$
 $E = 1.15'$
 $e = \dots$
 $T.R. = \dots$
 $S.E. RUN = \dots$
 $P.C. STA = 21911+75.02$
 $P.T. STA = 21916+07.44$

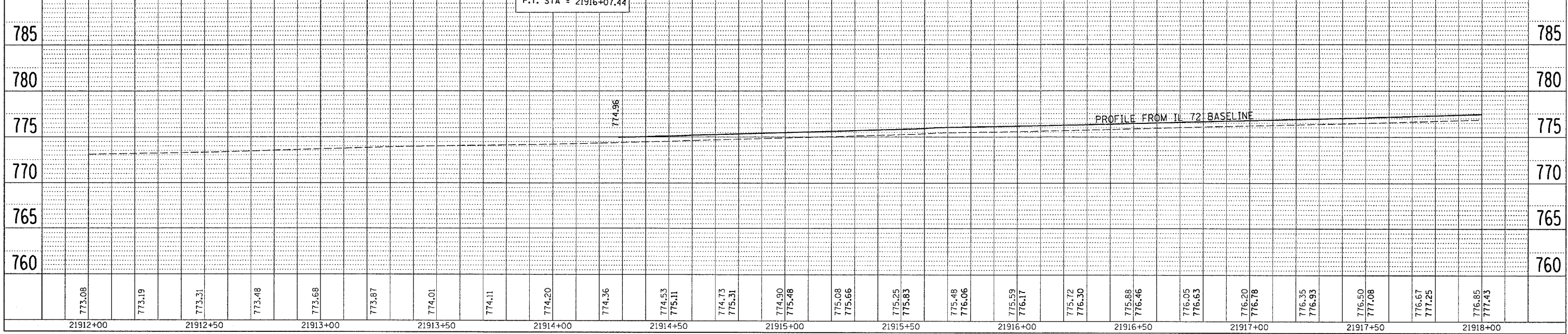
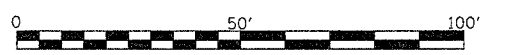

DATE	BY

DATE	BY

DATE TIME
 08/12/08 10:30
 08/12/08 10:30
 08/12/08 10:30
 08/12/08 10:30
 08/12/08 10:30