

IL RT. 17 (CHESTNUT STREET)

66403

F.A.P. RTE.	SECTION	COUNTY	TOTAL SHEETS	SHEET NO.
649	(67) T&I	MARSHALL	74	34
STA. 545+00		TO STA. 548+00		
FED. ROAD DIST. NO.		ILLINOIS FED. AID PROJECT		
D-93-D53-01		CONTRACT NUMBER		

FINAL SURVEY PLOTTED AREAS CHECKED BY DATE

NOTE BOOK NO.

ORIGINAL SURVEY PLOTTED AREAS CHECKED BY DATE

NOTE BOOK NO.

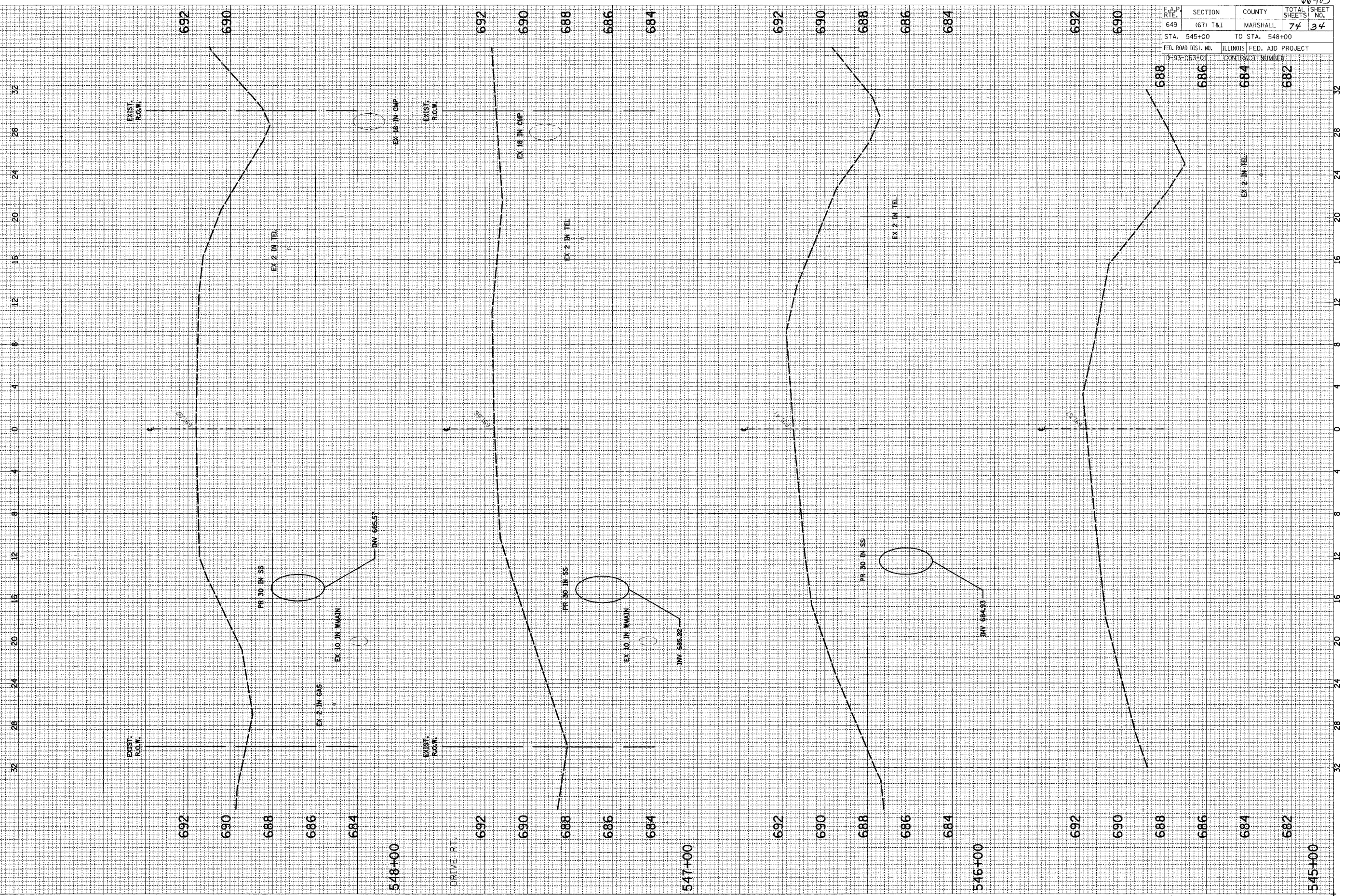

SCALE: HORIZ. 1"=40'
VERT. 1"=12'