

F.A.P. RTE.	SECTION	COUNTY	TOTAL SHEETS	SHEET NO.
649	(67) T&I	MARSHALL	74	39
STA. 557+82		TO STA. 559+58		
FED. ROAD DIST. NO.		ILLINOIS FED. AID PROJECT		
D-93-053-01		CONTRACT NUMBER		

FINAL SURVEY	DATE
CURVEY	BY
NOTE BOOK	
AREAS CHECKED	
NO.	

ORIGINAL SURVEY	DATE
CURVEY	BY
NOTE BOOK	
AREAS CHECKED	
NO.	

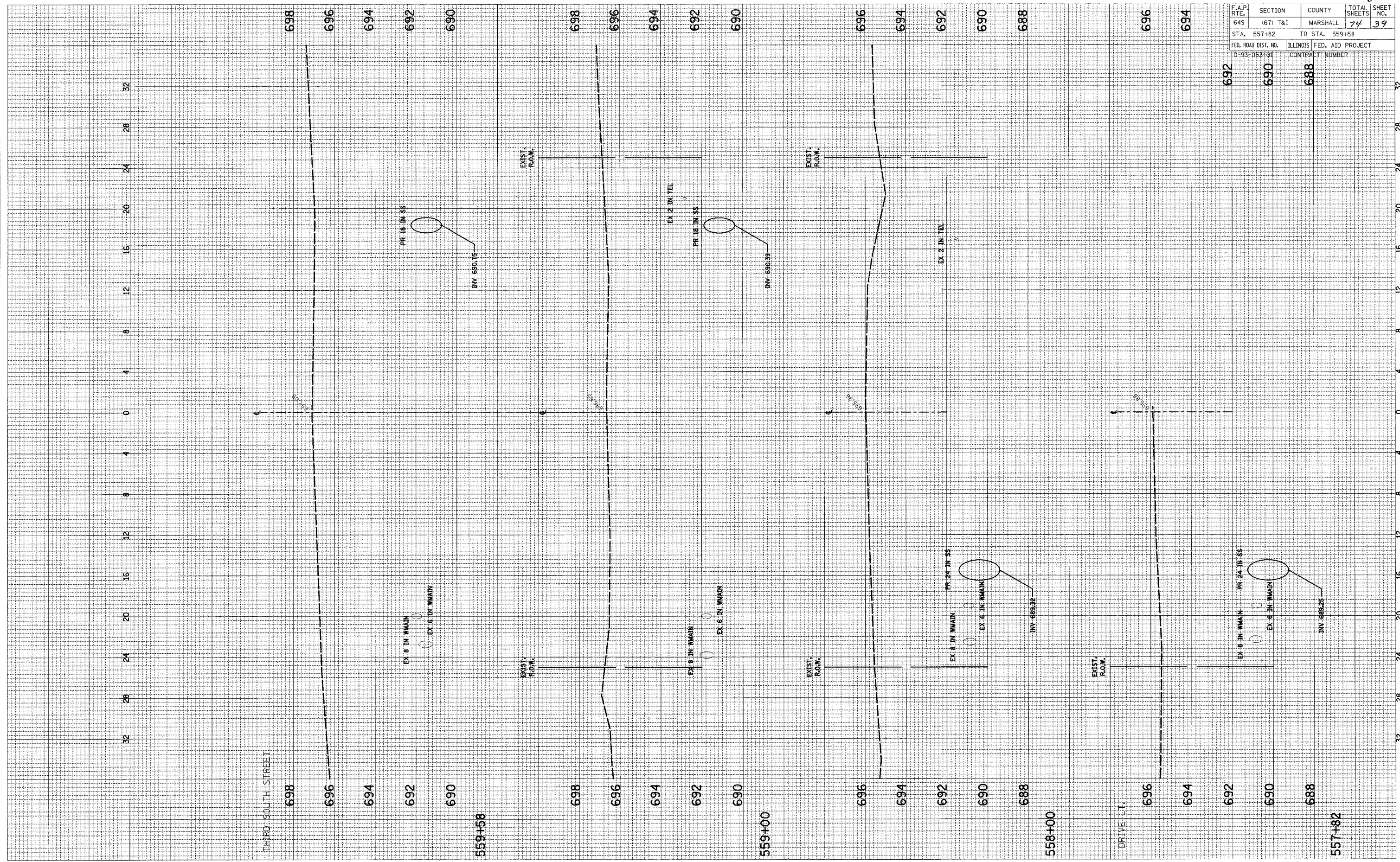

SCALE: HORIZ. 1/4" = 12' VERT. 1/2" = 12'