

IL RT. 17 (CHESTNUT STREET)

66403

F.A.P. R.T.E.	SECTION	COUNTY	TOTAL SHEETS	SHEET No.
649	(67) T&I	MARSHALL	74	45
STA. 572+00		TO STA. 573+70		
FED. ROAD DIST. NO.		ILLINOIS	FED. AID PROJECT	
D-93-D53-01		CONTRACT NUMBER		

FINAL SURVEY DATE
 SURVEYED BY
 TEMPLATE NO.
 AREAS CHECKED
 NO.

ORIGINAL SURVEY DATE
 SURVEYED BY
 TEMPLATE NO.
 AREAS CHECKED
 NO.

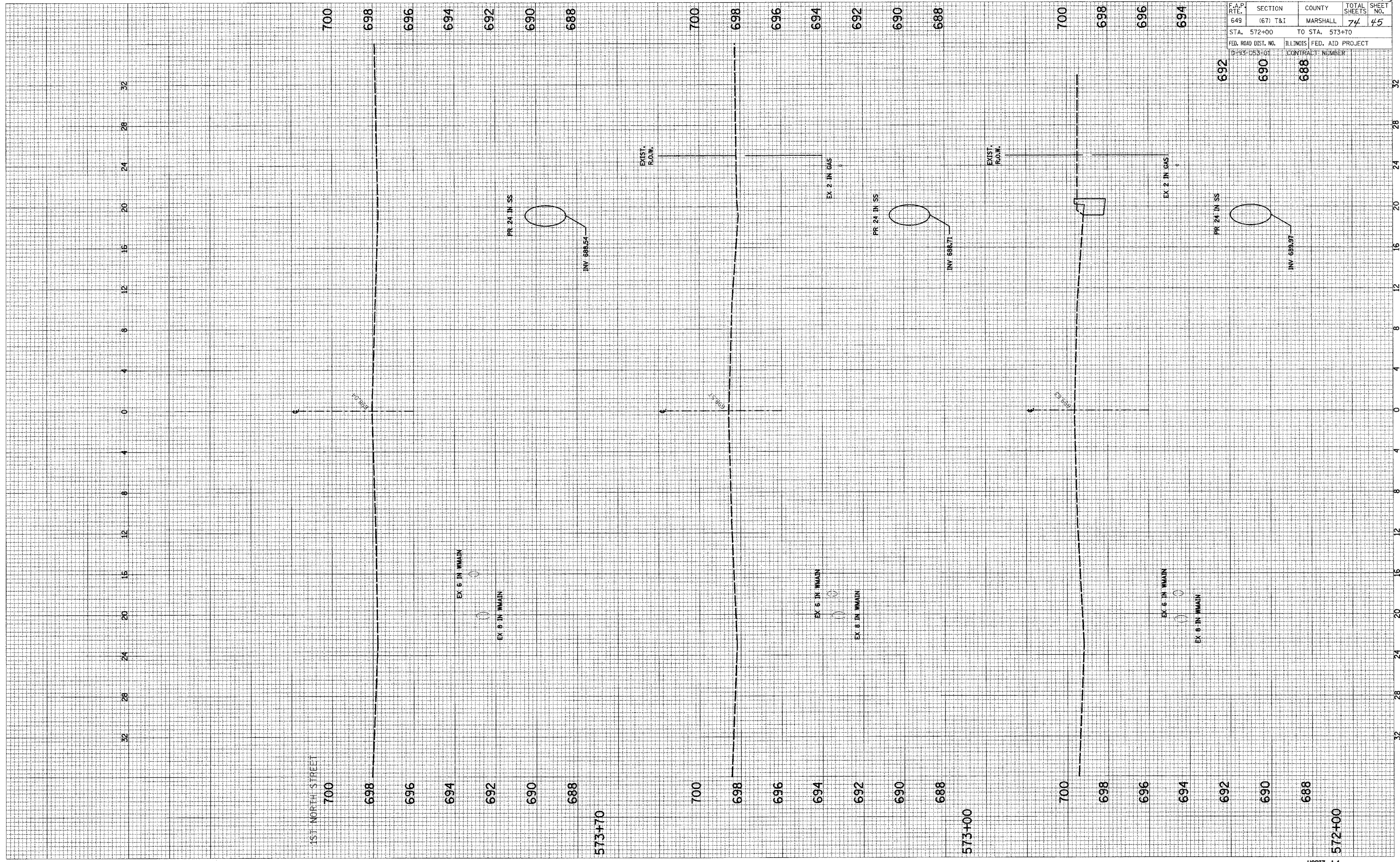

SCALE: HORIZ. 1"=40'
 VERT. 1"=4'