

IL RT. 17 (CHESTNUT STREET)

10/10/03

F.A.P. RTE.	SECTION	COUNTY	TOTAL SHEETS	SHEET NO.
649	(67) T&I	MARSHALL	74	47
STA. 576+70		TO STA. 578+00		
FED. ROAD DIST. NO.		ILLINOIS FED. AID PROJECT		
D-93-053-01		CONTRACT NUMBER		

FINAL SURVEY NO. _____
 SURVEYED BY _____ DATE _____
 TEMPLATE NO. _____
 NOTE BOOK NO. _____
 AREAS CHECKED _____

ORIGINAL SURVEY NO. _____
 SURVEYED BY _____ DATE _____
 TEMPLATE NO. _____
 NOTE BOOK NO. _____
 AREAS CHECKED _____

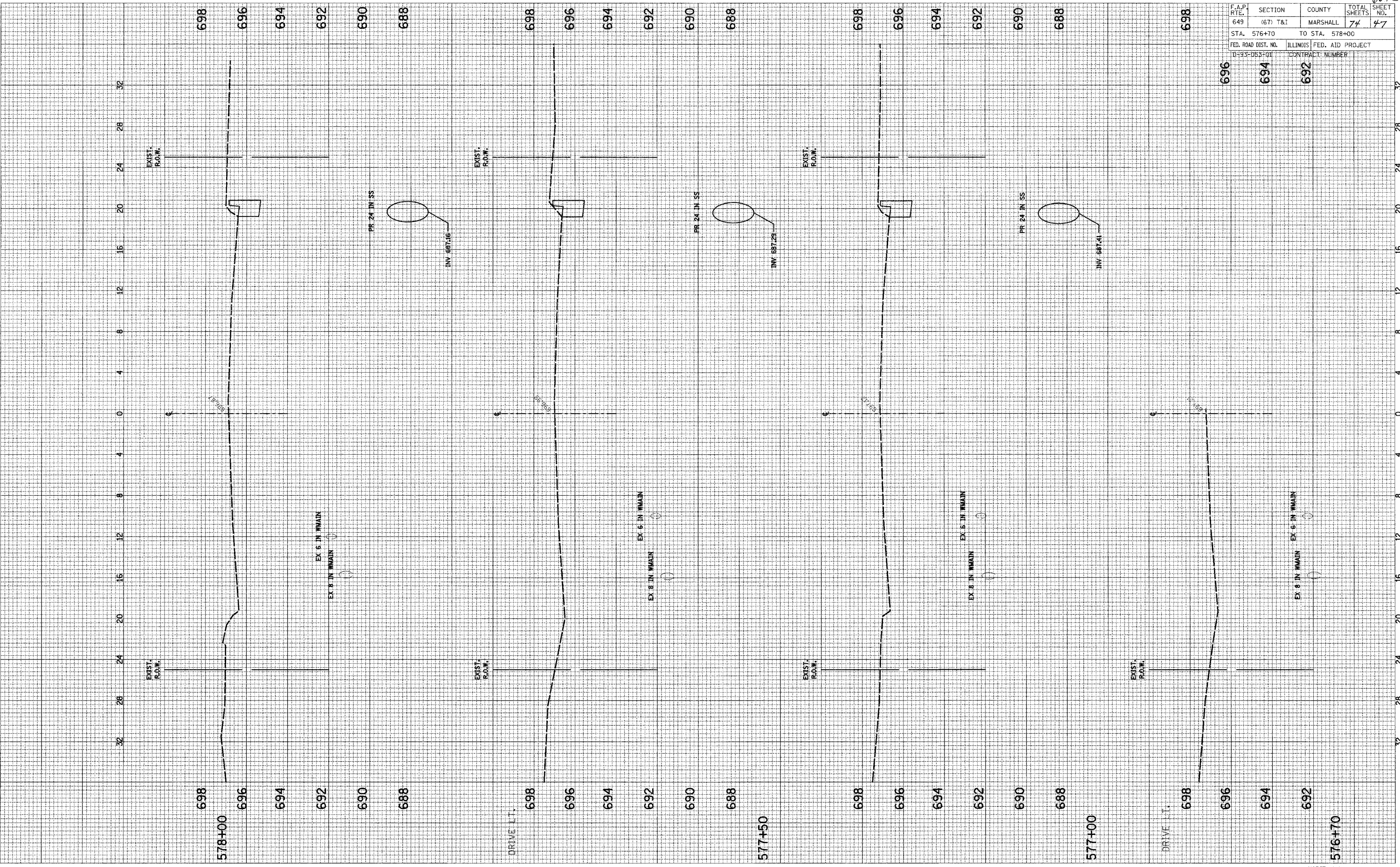

SCALE: HORIZ. 1/4" = 1'-0"
 VERT. 1/2" = 1'-0"