

IL RT. 17 (CHESTNUT STREET)

60403

F.A.P. RTE.	SECTION	COUNTY	TOTAL SHEETS	SHEET NO.
649	(67) T&I	MARSHALL	74	48
STA. 578+40		TO STA. 579+17		
FED. ROAD DIST. NO.		ILLINOIS FED. AID PROJECT		
D-293-D53-01		CONTRACT NUMBER		

FINAL SURVEY	SURVEYED	BY	DATE
NOTE BOOK	PLOTTED		
NO.	AREAS CHECKED		

ORIGINAL SURVEY	SURVEYED	BY	DATE
NOTE BOOK	PLOTTED		
NO.	AREAS CHECKED		

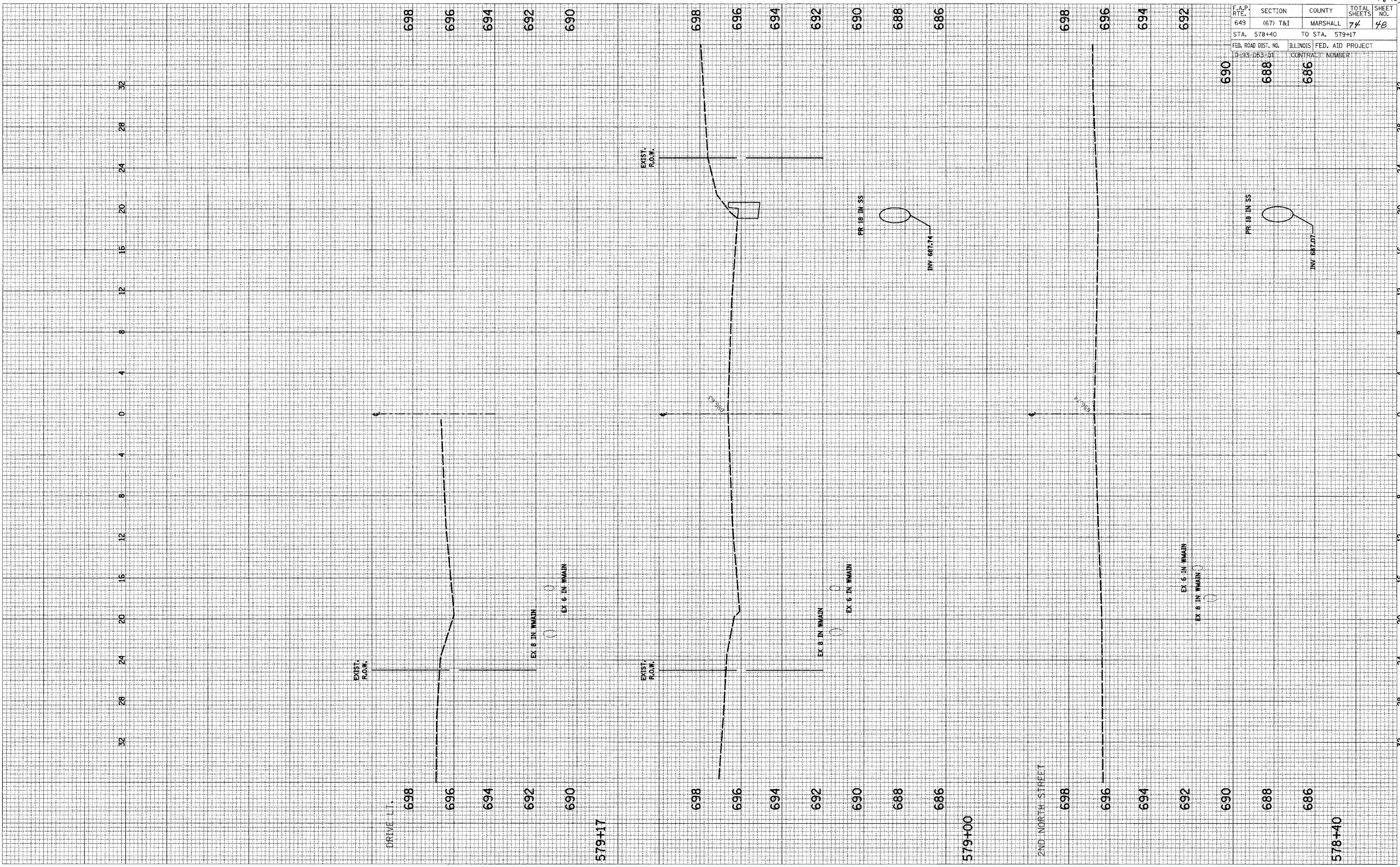

SCALE: HORIZ. 1/4" = 12' VERT. 1/2" = 12'