

2ND NORTH STREET STORM SEWER

66403

F.A.P. RTE.	SECTION	COUNTY	TOTAL SHEETS	SHEET NO.
649	(67) T&I	MARSHALL	74	53
STA. 11+95		TO STA. 13+35		
FED. ROAD DIST. NO.		ILLINOIS FED. AID PROJECT		
D 193 053 01		CONTRACT NUMBER		

FINAL SURVEY SURVEYED PLOTTED NOTE BOOK AREAS CHECKED

BY: _____ DATE: _____

ORIGINAL SURVEY SURVEYED PLOTTED NOTE BOOK AREAS CHECKED

BY: _____ DATE: _____

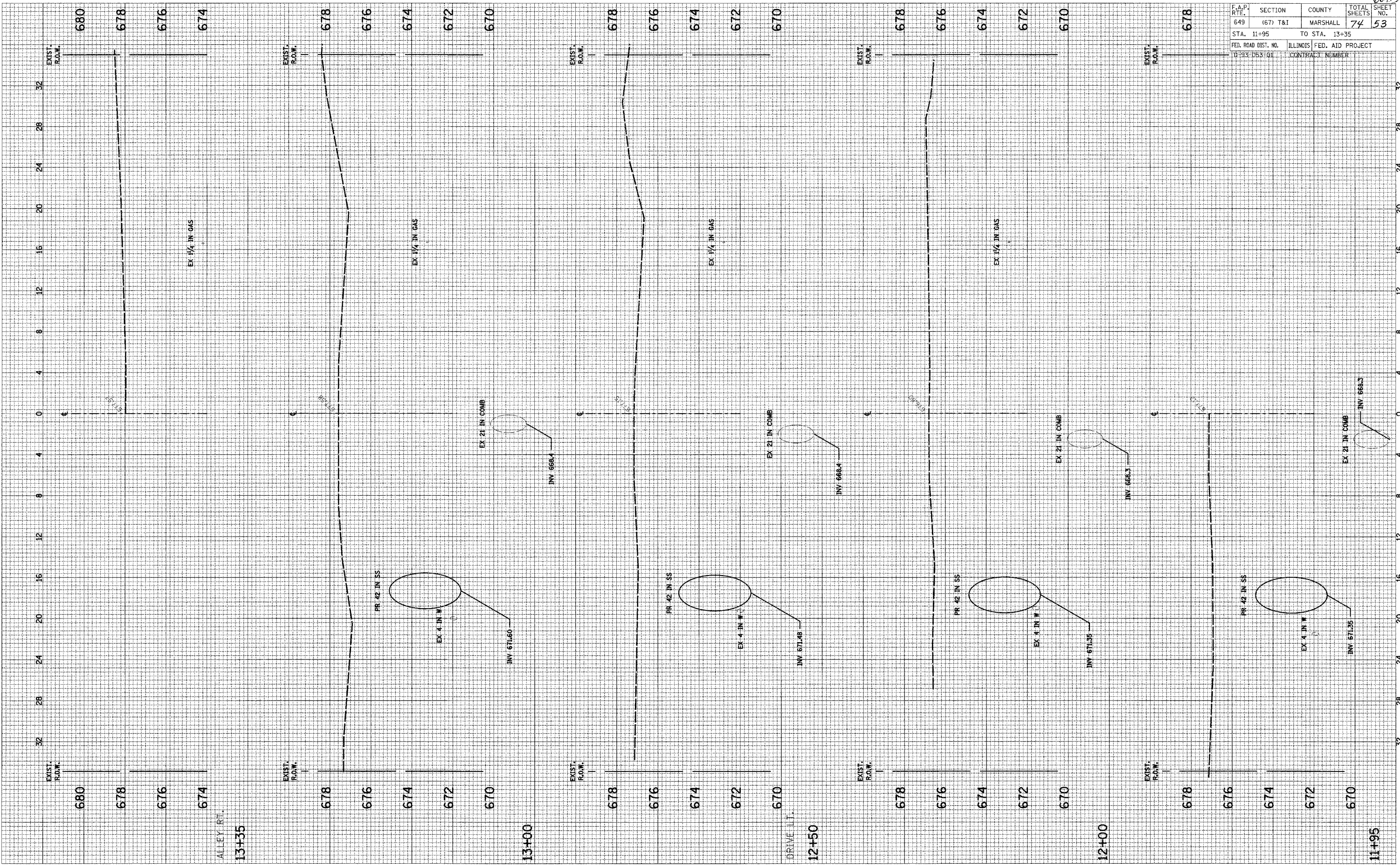

SCALE: HORIZ. 1"=40' VERT. 1"=4'