

2ND NORTH STREET STORM SEWER

66403

BY _____ DATE _____
 SURVEYED _____
 ORIGINAL SURVEY _____
 NOTE BOOK _____
 AREAS CHECKED _____

BY _____ DATE _____
 SURVEYED _____
 ORIGINAL SURVEY _____
 NOTE BOOK _____
 AREAS CHECKED _____

F.A.P. RTE.	SECTION	COUNTY	TOTAL SHEETS	SHEET NO.
649	(67) T&I	MARSHALL	74	65
STA. 34+00		TO STA. 34+90		
FED. ROAD DIST. NO.		ILLINOIS FED. AID PROJECT		
D-93-DE3-01		CONTRACT NUMBER		

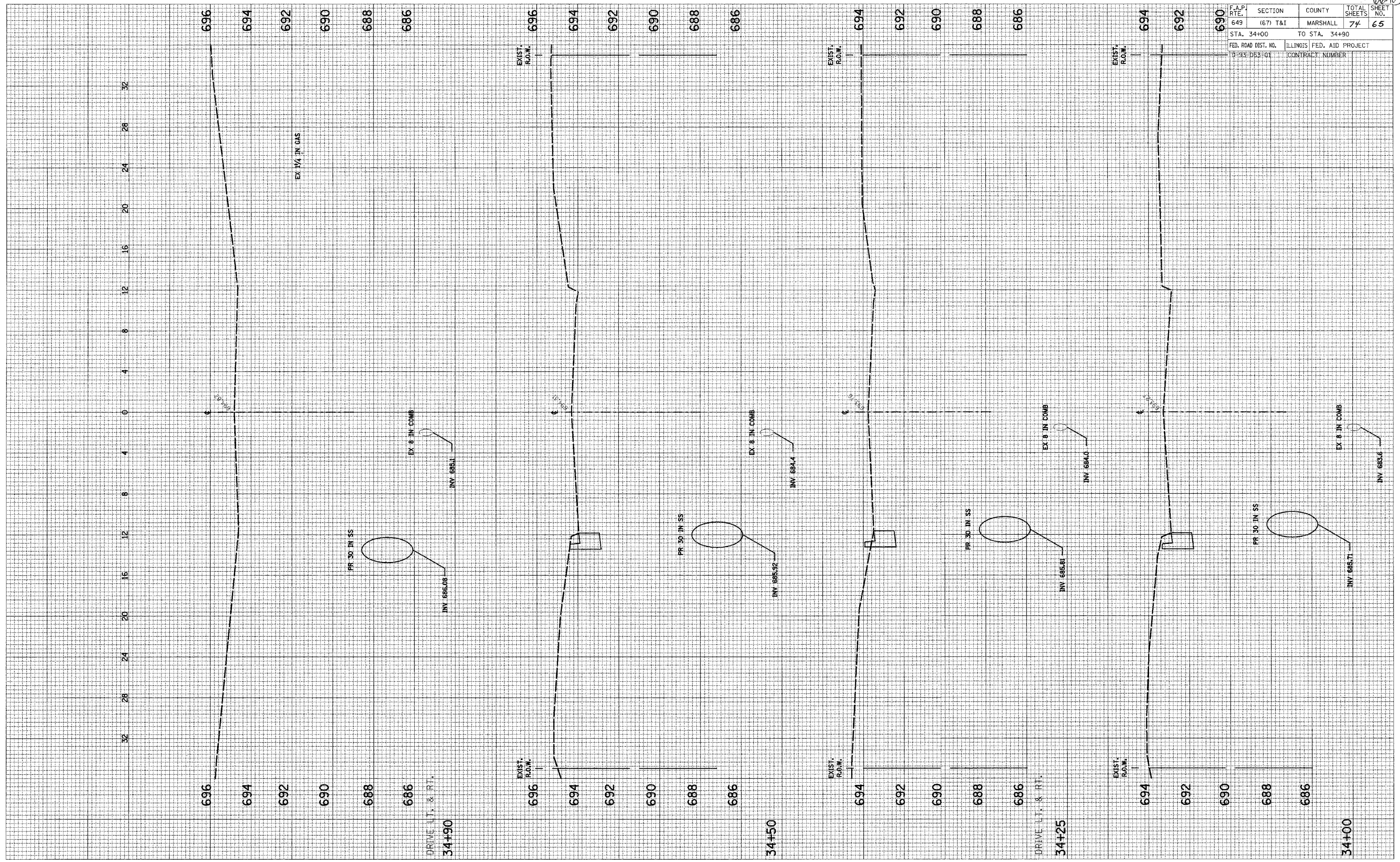

SCALE: HORIZ. 1"=4'
 VERT. 1"=2'