

F.A.P. RTE.	SECTION	COUNTY	TOTAL SHEETS	SHEET NO.
681	(118,119)RS-3	IROQUOIS	18	1

D-93-031-04

STATE OF ILLINOIS
DEPARTMENT OF TRANSPORTATION
DIVISION OF HIGHWAYS

**PROPOSED
HIGHWAY PLANS**

FAP 681 (US 52)
(118,119)RS-3

IROQUOIS COUNTY

C-93-032-04
SMART MILLING & RESURFACING FROM EAST
OF US 45 TO EAST OF IL 1

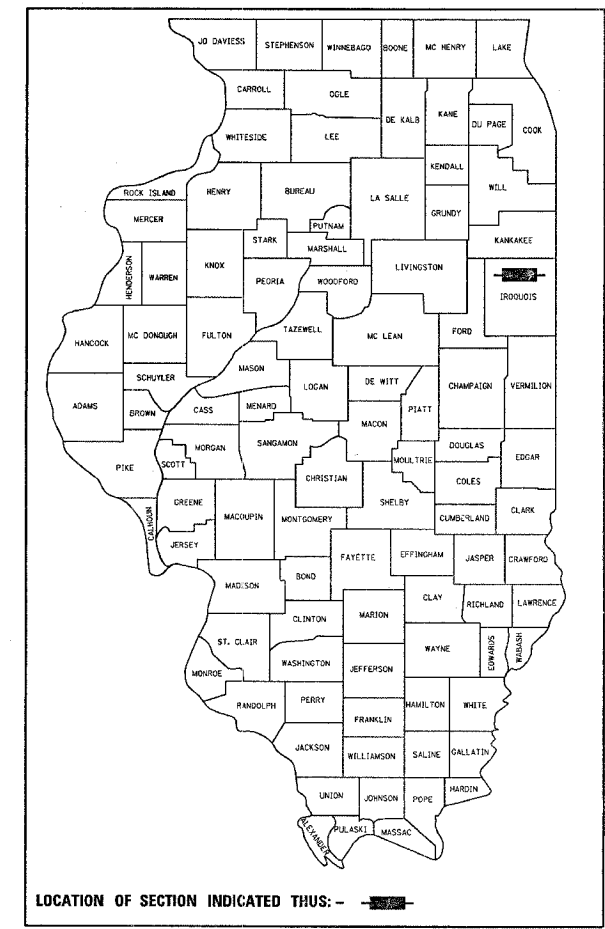

LOCATION OF SECTION INDICATED THUS: - [shaded box] -

RURAL MINOR ARTERIAL
ADT (2001) = 2300
P.V. = 81.25% M.U. = 11.25% S.U. = 7.5%

STATE OF ILLINOIS
DEPARTMENT OF TRANSPORTATION
DIVISION OF HIGHWAYS

SUBMITTED 3/30 2005

Phogary L. Monte
DEPUTY DIRECTOR OF HIGHWAYS, REGION ENGINEER

May 13 2005
Mike Hine
ENGINEER OF DESIGN AND ENVIRONMENT

May 13 2005
Victor Modun
DIRECTOR OF HIGHWAYS, CHIEF ENGINEER

**PRINTED BY THE AUTHORITY
OF THE STATE OF ILLINOIS**

INDEX OF SHEETS

1	COVER SHEET
2	GENERAL NOTES
3	SUMMARY OF QUANTITIES
4	TYPICAL SECTIONS
5-7	SCHEDULES
8	TIE POINTS
9	REFERENCE MAP
10	INTERSECTION LAYOUT
11-13	PAVEMENT MARKING DETAILS
14-18	DETAILS

STANDARDS

000001-04	STANDARD SYMBOLS, ABBREVIATIONS AND PATTERNS
001006	DECIMAL OF AN INCH AND OF A FOOT
280001-02	TEMPORARY EROSION CONTROL SYSTEMS
406201	MAILBOX TURNOUT
667101	PERMANENT SURVEY MARKERS
701001-01	OFF-ROAD OPERATIONS 2L, 2W, MORE THAN 4.5 m (15') AWAY
701006-02	OFF-ROAD OPERATIONS 2L, 2W, 4.5 m (15') TO 600 mm (24") FROM PAVEMENT EDGE
701011-01	OFF-ROAD MOVING OPERATIONS 2L, 2W, DAY ONLY
701301-02	LANE CLOSURE, 2L, 2W, SHORT TIME OPERATIONS
701306-01	LANE CLOSURE, 2L, 2W, SLOW MOVING OPERATIONS DAY ONLY, FOR SPEEDS P 45 MPH
701311-02	LANE CLOSURE, 2L, 2W, MOVING OPERATIONS - DAY ONLY
702001-05	TRAFFIC CONTROL DEVICES
780001-01	TYPICAL PAVEMENT MARKINGS
781001-02	TYPICAL APPLICATIONS, RAISED REFLECTIVE PAVEMENT MARKERS

MICROFILMED _____
REEL NUMBER _____
AWARDED _____
RESIDENT ENGINEER _____
AS BUILT CHANGES WERE MADE
ON THE FOLLOWING SHEETS _____

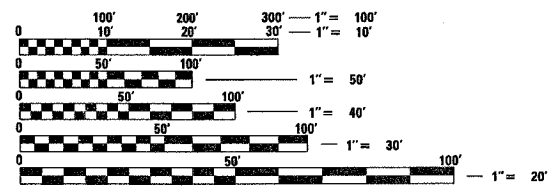

FULL SIZE PLANS HAVE BEEN PREPARED USING STANDARD ENGINEERING SCALES. REDUCED SIZED PLANS WILL NOT CONFORM TO STANDARD SCALES. IN MAKING MEASUREMENTS ON REDUCED PLANS, THE ABOVE SCALES MAY BE USED.

J.U.L.I.E.
JOINT UTILITY LOCATION INFORMATION FOR EXCAVATION
1-800-892-0123

DISTRICT 3 NO. (815) 434-6131
PROJECT ENGINEER: DAN DRAPER
UNIT CHIEF: MICHELE LINDEMANN
TOWNSHIPS: ASHKUM, MARTINTON

CONTRACT NO. 66430

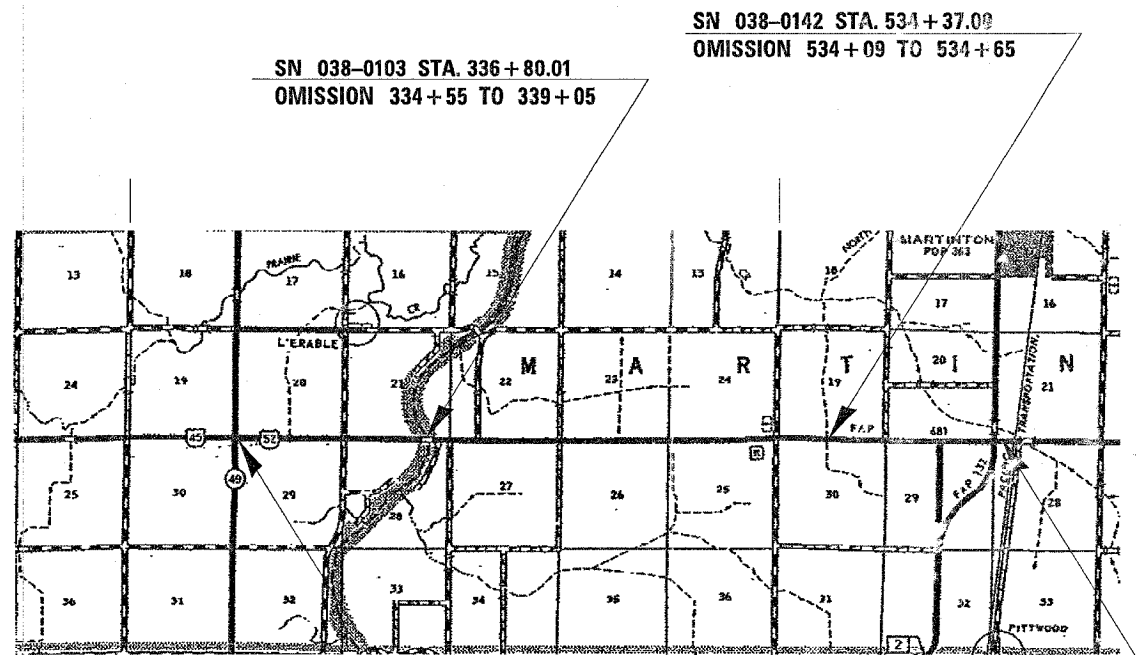

LOCATION MAP
NOT TO SCALE
GROSS LENGTH = 38,287 FT = 7.251 MI
NET LENGTH = 37,781 FT = 7.155 MI

3/11/2005 c:\projects\ec03\04\al\shnts.dgn