

F.A.P. RTE.	SECTION	COUNTY	TOTAL SHEETS	SHEET NO.
681	(118,119)RS-3	IROQUOIS	18	1

D-93-031-04

STATE OF ILLINOIS
DEPARTMENT OF TRANSPORTATION

DIVISION OF HIGHWAYS

**PROPOSED
HIGHWAY PLANS**

FAP 681 (US 52)
(118,119)RS-3

IROQUOIS COUNTY

C-93-032-04
SMART MILLING & RESURFACING FROM EAST
OF US 45 TO EAST OF IL 1

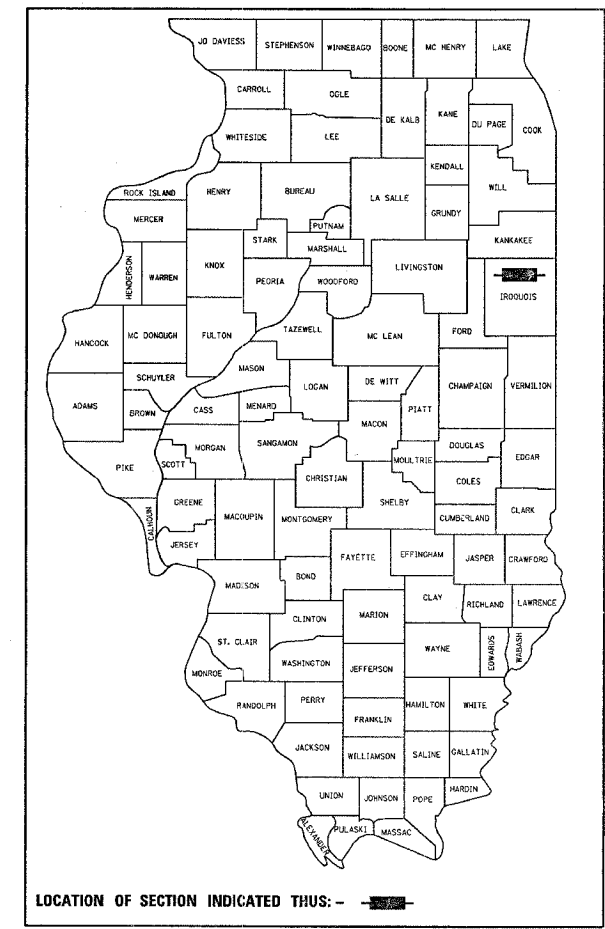

LOCATION OF SECTION INDICATED THUS: - [shaded box] -

RURAL MINOR ARTERIAL
ADT (2001) = 2300
P.V. = 81.25% M.U. = 11.25% S.U. = 7.5%

STATE OF ILLINOIS
DEPARTMENT OF TRANSPORTATION
DIVISION OF HIGHWAYS

SUBMITTED 3/30 2005

Phogary L. Monte
DEPUTY DIRECTOR OF HIGHWAYS, REGION ENGINEER

May 13 2005
Mike Hine
ENGINEER OF DESIGN AND ENVIRONMENT

May 13 2005
Victor Modun
DIRECTOR OF HIGHWAYS, CHIEF ENGINEER

**PRINTED BY THE AUTHORITY
OF THE STATE OF ILLINOIS**

INDEX OF SHEETS

1	COVER SHEET
2	GENERAL NOTES
3	SUMMARY OF QUANTITIES
4	TYPICAL SECTIONS
5-7	SCHEDULES
8	TIE POINTS
9	REFERENCE MAP
10	INTERSECTION LAYOUT
11-13	PAVEMENT MARKING DETAILS
14-18	DETAILS

STANDARDS

000001-04	STANDARD SYMBOLS, ABBREVIATIONS AND PATTERNS
001006	DECIMAL OF AN INCH AND OF A FOOT
280001-02	TEMPORARY EROSION CONTROL SYSTEMS
406201	MAILBOX TURNOUT
667101	PERMANENT SURVEY MARKERS
701001-01	OFF-ROAD OPERATIONS 2L, 2W, MORE THAN 4.5 m (15') AWAY
701006-02	OFF-ROAD OPERATIONS 2L, 2W, 4.5 m (15') TO 600 mm (24") FROM PAVEMENT EDGE
701011-01	OFF-ROAD MOVING OPERATIONS 2L, 2W, DAY ONLY
701301-02	LANE CLOSURE, 2L, 2W, SHORT TIME OPERATIONS
701306-01	LANE CLOSURE, 2L, 2W, SLOW MOVING OPERATIONS DAY ONLY, FOR SPEEDS P 45 MPH
701311-02	LANE CLOSURE, 2L, 2W, MOVING OPERATIONS - DAY ONLY
702001-05	TRAFFIC CONTROL DEVICES
780001-01	TYPICAL PAVEMENT MARKINGS
781001-02	TYPICAL APPLICATIONS, RAISED REFLECTIVE PAVEMENT MARKERS

MICROFILMED _____
REEL NUMBER _____
AWARDED _____
RESIDENT ENGINEER _____
AS BUILT CHANGES WERE MADE
ON THE FOLLOWING SHEETS _____

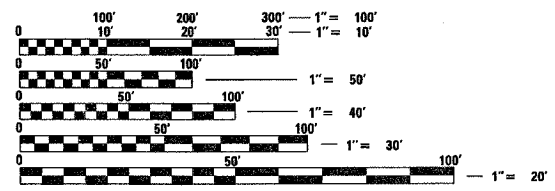

FULL SIZE PLANS HAVE BEEN PREPARED USING STANDARD ENGINEERING SCALES. REDUCED SIZED PLANS WILL NOT CONFORM TO STANDARD SCALES. IN MAKING MEASUREMENTS ON REDUCED PLANS, THE ABOVE SCALES MAY BE USED.

J.U.L.I.E.
JOINT UTILITY LOCATION INFORMATION FOR EXCAVATION
1-800-892-0123

DISTRICT 3 NO. (815) 434-6131
PROJECT ENGINEER: DAN DRAPER
UNIT CHIEF: MICHELE LINDEMANN
TOWNSHIPS: ASHKUM, MARTINTON

CONTRACT NO. 66430

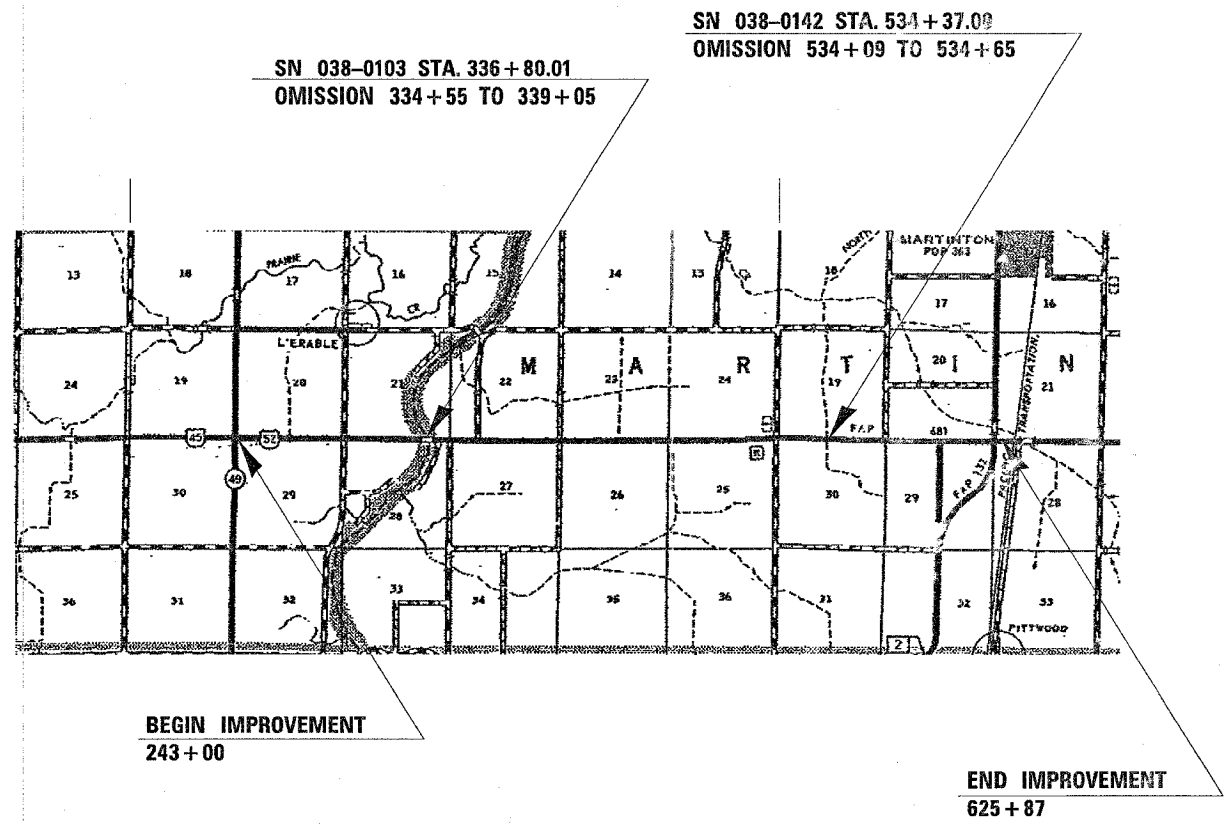

LOCATION MAP
NOT TO SCALE
GROSS LENGTH = 38,287 FT = 7.251 MI
NET LENGTH = 37,781 FT = 7.155 MI

3/11/2005 c:\projects\ec03\04\al\shnts.dgn

F.A.P. RTE.	SECTION	COUNTY	TOTAL SHEETS	SHEET NO.
681	(118,119)RS-3	IROQUOIS	18	2
STA.		TO STA.		
FED. ROAD DIST. NO.		ILLINOIS	FED. AID PROJECT	

GENERAL NOTES

THE THICKNESS OF BITUMINOUS MIXTURES SHOWN ON THE PLANS IS THE NOMINAL THICKNESS. DEVIATIONS FROM THE NOMINAL THICKNESS WILL BE PERMITTED WHEN SUCH DEVIATIONS OCCUR DUE TO IRREGULARITIES IN THE EXISTING SURFACE OR BASE ON WHICH THE BITUMINOUS MIXTURE IS PLACED.

THE BITUMINOUS SURFACE OF ALL MAILBOX TURNOUTS, PRIVATE ENTRANCES, COMMERCIAL ENTRANCES, AND SIDE ROADS SHALL BE MADE NEATLY, IN A WORKMANLIKE MANNER, AND SHALL ACCURATELY CONFORM TO THE SHAPES AND DIMENSIONS SHOWN ON THE PLAN DETAILS. IF REQUIRED BY THE ENGINEER, THE CONTRACTOR SHALL BE REQUIRED TO SAW CUT THE BITUMINOUS SURFACE TO CONFORM TO THE SHAPES AND DIMENSIONS SHOWN ON THE PLAN DETAILS. THIS WORK SHALL BE INCLUDED IN THE COST OF THE BITUMINOUS SURFACE

AGGREGATE (PRIME COAT): FA 20 MAY BE USED IN ADDITION TO THE GRADATIONS LISTED IN THE 3RD PARAGRAPH OF ARTICLE 1003.03(c) OF THE STANDARD SPECIFICATIONS.

THE ENGINEER WILL BE THE SOLE JUDGE CONCERNING CURING TIME FOR THE VARIOUS BITUMINOUS LIFTS.

FOR STABILIZATION, ALL TYPE III BARRICADES SHALL REQUIRE A MINIMUM OF FOUR SAND BAGS PER BARRICADE.

WHERE SECTION OR SUBSECTION MONUMENTS ARE ENCOUNTERED, THE ENGINEER SHALL BE NOTIFIED BEFORE SUCH MONUMENTS ARE REMOVED. THE CONTRACTOR SHALL PROTECT AND CAREFULLY PRESERVE ALL MONUMENTS UNTIL AN AUTHORIZED SURVEYOR OR AGENT HAS WITNESSED OR OTHERWISE REFERENCED THEIR LOCATION. THE CONTRACTOR SHALL BE RESPONSIBLE FOR HAVING AN AUTHORIZED SURVEYOR REESTABLISH ANY SECTION OR SUBSECTION MONUMENTS DESTROYED BY HIS OPERATIONS.

SEEDING SHALL NOT BE PERMITTED AT ANY TIME WHEN THE GROUND IS FROZEN, WET, OR IN AN UNTILLABLE CONDITION. LOCATIONS TO BE SEEDED WILL BE DETERMINED BY THE ENGINEER.

THE FINISHED EARTHWORK SHALL HAVE A VEGETATION SUSTAINING SOIL COVERING THE TOP FOUR INCHES IN AREAS TO BE SEEDED OR SODDED. THE VEGETATION SUSTAINING SOIL REQUIRED WILL NOT BE PAID FOR SEPARATELY BUT SHALL BE INCLUDED IN THE COST OF FURNISHED EXCAVATION.

ON EXISTING PAVEMENT WHICH MAY BE SUPERELEVATED, THE NEW BITUMINOUS PAVEMENT SHALL BE BUILT WITH THE SAME SUPERELEVATION UNLESS NEW SUPERELEVATION RATES ARE GIVEN ON THE PLANS.

ALL ELEVATIONS REFERRING TO U.S.G.S. MEAN SEA LEVEL DATUM.

ABANDONED UNDERGROUND UTILITIES THAT CONFLICT WITH CONSTRUCTION SHALL BE DISPOSED OF OUTSIDE THE LIMITS OF THE RIGHT OF WAY ACCORDING TO ARTICLE 202.03 OF THE STANDARD SPECIFICATIONS AND AS DIRECTED BY THE ENGINEER. THIS WORK WILL NOT BE PAID FOR SEPARATELY BUT SHALL BE INCLUDED IN THE COST OF EARTH EXCAVATION.

ANY REFERENCE TO A STANDARD IN THESE PLANS SHALL BE INTERPRETED TO MEAN THE EDITION AS INDICATED BY THE SUBNUMBER LISTED ON THE INDEX OF SHEETS OR THE COPY OF THE STANDARD INCLUDED IN THESE PLANS.

THE FOLLOWING RATES OF APPLICATION HAVE BEEN USED IN CALCULATING PLAN QUANTITIES:

GRANULAR MATERIALS	2.05	TONS / CU YD
BITUMINOUS MAT PRIME COAT	0.08	GAL / SQ YD OR
	0.375	GAL / SQ YD
AGGREGATE PRIME COAT	0.002	TONS / SQ YD
BITUMINOUS RESURFACING	112	LBS / SQ YD / IN
SHORT TERM PAVEMENT MARKING	10	FT /100 FT OF APPLICATION
MIX FOR CRACKS, JTS & FLGWY	0.0003	TONS / SQ YD
LEVEL BINDER (HAND METHOD)	0.0005	TONS / SQ YD
SUPPLEMENTAL WATERING	3	GAL / SQ YD / APPLICATION
CALCIUM CHLORIDE	2	LB / SQ YD / APPLICATION
TEMPORARY DITCH CHECKS	9	BALES OR
	5	TONS AGGREGATE

THE CONTRACTOR SHALL CONTACT JULIE AT LEAST 48 HOURS PRIOR TO EXCAVATION TO DETERMINE WHICH UTILITIES ARE IN THE AREA.

STATE OF ILLINOIS
DEPARTMENT OF TRANSPORTATION
DISTRICT THREE

PREPARED BY: Thomas R. Sanchez
DISTRICT STUDIES & PLANS ENGINEER

DATE: 03/30/2005

EXAMINED BY: Herbert J. Jones
DISTRICT CONSTRUCTION ENGINEER

Kenneth L. Taylor
DISTRICT MATERIALS ENGINEER

James A. Hester
DISTRICT OPERATIONS ENGINEER

**GENERAL
NOTES**

CONTRACT NO. 66430				
F.A.P. RTE.	SECTION	COUNTY	TOTAL SHEETS	SHEET NO.
681	(118,119)RS-3	IRROUOIS	18	3
STA.		TO STA.		
FED. ROAD DIST. NO.	ILLINOIS	FED. AID PROJECT		

SUMMARY OF QUANTITIES

CODE NO.	ITEM	UNIT	1000
			TOTAL QUANTITY
20400800	FURNISHED EXCAVATION	CU YD	17
25000200	SEEDING, CLASS 2	ACRE	0.12
25000400	NITROGEN FERTILIZER NUTRIENT	POUND	11
25000500	PHOSPHORUS FERTILIZER NUTRIENT	POUND	11
25000600	POTASSIUM FERTILIZER NUTRIENT	POUND	11
25100630	EROSION CONTROL BLANKET	SQ YD	572
35100100	AGGREGATE BASE COURSE, TYPE A	TON	17
40200800	AGGREGATE SURFACE COURSE, TYPE B	TON	16
40600100	BITUMINOUS MATERIALS (PRIME COAT)	GALLON	9760
40600300	AGGREGATE (PRIME COAT)	TON	241
40600400	MIXTURE FOR CRACKS, JOINTS, AND FLANGEWAYS	TON	35
40600895	CONSTRUCTING TEST STRIP	EACH	1
40600980	BITUMINOUS SURFACE REMOVAL - BUTT JOINT	SQ YD	451
40600990	TEMPORARY RAMP	SQ YD	318
40800040	INCIDENTAL BITUMINOUS SURFACING	TON	227
44000003	BITUMINOUS SURFACE REMOVAL 3/4"	SQ YD	105878
44000006	BITUMINOUS SURFACE REMOVAL 1 1/2"	SQ YD	13347
48101200	AGGREGATE SHOULDERS, TYPE B	TON	1427
66700095	PERMANENT SURVEY MARKERS	EACH	3
67100100	MOBILIZATION	L SUM	1
70100460	TRAFFIC CONTROL AND PROTECTION, STANDARD 701306	L SUM	1
70300100	SHORT-TERM PAVEMENT MARKING	FOOT	9326
70300210	TEMPORARY PAVEMENT MARKING - LETTERS AND SYMBOLS	SQ FT	186

SUMMARY OF QUANTITIES

CODE NO.	ITEM	UNIT	1000
			TOTAL QUANTITY
70300220	TEMPORARY PAVEMENT MARKING - LINE 4"	FOOT	82714
70300240	TEMPORARY PAVEMENT MARKING - LINE 6"	FOOT	9060
70300250	TEMPORARY PAVEMENT MARKING - LINE 8"	FOOT	935
70300260	TEMPORARY PAVEMENT MARKING - LINE 12"	FOOT	1269
70300280	TEMPORARY PAVEMENT MARKING - LINE 24"	FOOT	160
70301000	WORK ZONE PAVEMENT MARKING REMOVAL	SQ FT	1554
78000100	THERMOPLASTIC PAVEMENT MARKING - LETTERS AND SYMBOLS	SQ FT	186
78000200	THERMOPLASTIC PAVEMENT MARKING - LINE 4"	FOOT	10540
78000400	THERMOPLASTIC PAVEMENT MARKING - LINE 6"	FOOT	38
78000500	THERMOPLASTIC PAVEMENT MARKING - LINE 8"	FOOT	935
78000600	THERMOPLASTIC PAVEMENT MARKING - LINE 12"	FOOT	1269
78000650	THERMOPLASTIC PAVEMENT MARKING - LINE 24"	FOOT	160
78001110	PAINT PAVEMENT MARKING - LINE 4"	FOOT	72174
78001130	PAINT PAVEMENT MARKING - LINE 6"	FOOT	9022
78100100	RAISED REFLECTIVE PAVEMENT MARKER	EACH	670
78200300	PRISMATIC CURB REFLECTOR	EACH	16
78300200	RAISED REFLECTIVE PAVEMENT MARKER REMOVAL	EACH	670
X4066414	BITUMINOUS CONCRETE SURFACE COURSE, SUPERPAVE, MIX "C", N50	TON	9871
X4066735	LEVELING BINDER (HAND METHOD), SUPERPAVE N50	TON	59
Z0021700	EXPANSION JOINT REHABILITATION	FOOT	104
Z0055300	RUMBLE STRIP	EACH	12

• SPECIALTY ITEMS

SUMMARY OF QUANTITIES

F.P. RTE.	SECTION	COUNTY	TOTAL SHEETS	SHEET NO.
681	(118,119)RS-3	IROQUOIS	18	4
STA.		TO STA.		
FED. ROAD DIST. NO.		ILLINOIS	FED. AID PROJECT	

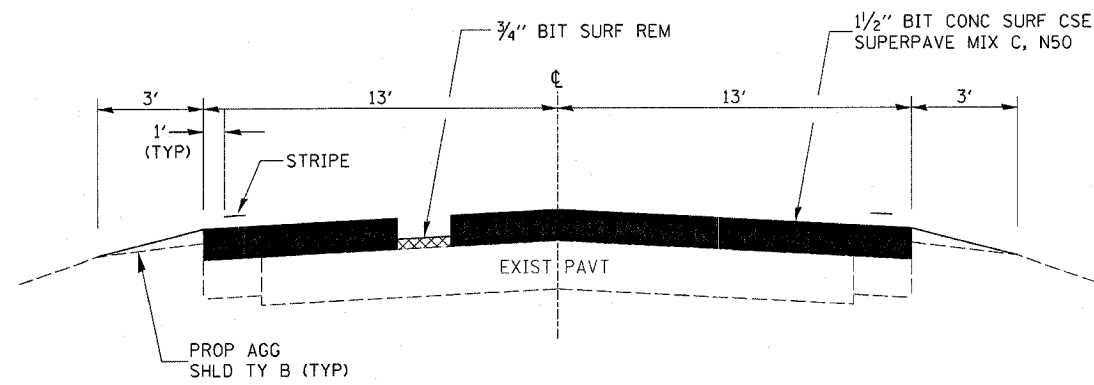

PROPOSED TYPICAL SECTION

243+00 TO 608+63

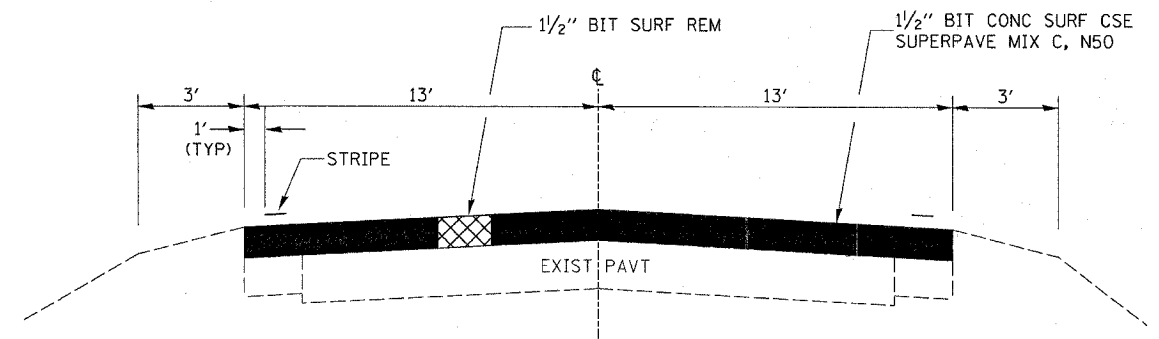

PROPOSED TYPICAL SECTION

608+63 TO 625+87

MIX DESIGN							
MIX	PG GRADE	MAX % RAP ALLOWABLE	DESIGN AIR VOIDS	MIX COMPOSITION	FRICTION AGG	PLANT CONTROL LIMITS	DENSITY CONTROL
SUPERPAVE SURFACE	PG 64-22	15%	4.0% @N50	L 12.5 OR IL 9	MIXTURE C	CLASS 1	CORRELATION

IF RAP OPTION IS SELECTED, THE ASPHALT CEMENT GRADE MAY NEED TO BE ADJUSTED. THIS WILL BE DETERMINED BY THE ENGINEER

TYPICAL SECTIONS

F.A.P. RTE.	SECTION	COUNTY	TOTAL SHEETS	SHEET NO.
681	118.119RS-3	IRROQUOIS	18	5
STA.		TO STA.		
FED. ROAD DIST. NO.		ILLINOIS	FED. AID PROJECT	

LOCATION STA TO STA		LENGTH	RESURF AREA	BIT CONC SURF CSE SUPERPAVE	BIT SURF REM 3/4"	BIT SURF REM 1 1/2"	BIT SURF REM (BUTT JT)	TEMP RAMP
		FOOT	SQ YD	TON	SQ YD	SQ YD	SQ YD	SQ YD
242+70 TO 243+00	BUTT JOINT	30	86.7	7.3			86.7	14.4
243+00 TO 334+25		9125	26361.1	2214.3	26361.1			
334+25 TO 334+55	BUTT JOINT	30	86.7	7.3			86.7	14.4
334+55 TO 339+05	OMISSION S.N. 038-0103							
339+05 TO 339+35	BUTT JOINT	30	86.7	7.3			86.7	14.4
339+35 TO 533+79		19444	56171.6	4718.4	56171.6			
533+79 TO 534+09	BUTT JOINT	30	86.7	7.3			86.7	14.4
534+09 TO 534+65	OMISSION S.N. 038-0142							
534+65 TO 534+95	BUTT JOINT	30	86.7	7.3			86.7	14.4
534+95 TO 608+33		7338	21198.7	1780.7	21198.7			
608+33 TO 608+63	BITUMINOUS TRANSITION	30	86.7	7.3		86.7		
608+63 TO 625+87	MILLING AREA AT IL 1	1724	13260.0	1113.8		13260.0		43.3
TOTAL				9871.0	103731.4	13346.7	433.5	115.3

LOCATION STA TO STA		LENGTH	AGG SHLD
		FOOT	TON
242+70 TO 243+00	BUTT JOINT	30	1.1
243+00 TO 334+25		9125	346.4
334+25 TO 334+55	BUTT JOINT	30	1.1
334+55 TO 339+05	OMISSION S.N. 038-0103		
339+05 TO 339+35	BUTT JOINT	30	1.1
339+35 TO 533+79		19444	738.2
533+79 TO 534+09	BUTT JOINT	30	1.1
534+09 TO 534+65	OMISSION S.N. 038-0142		
534+65 TO 534+95	BUTT JOINT	30	1.1
534+95 TO 608+33		7338	278.6
608+33 TO 608+63	BITUMINOUS TRANSITION	30	1.1
608+63 TO 625+87	MILLING AREA AT IL 1	1724	56.9
TOTAL			1426.7

LOCATION STA TO STA		LENGTH	RESURF AREA	BIT MAT (PR CT)	AGG (PR CT)	MIX FOR CRACKS JTS & FLGWYS	LEVEL BINDER SUPERPAVE (HM)
		FOOT	SQ YD	GALLON	TON	TON	TON
242+70 TO 243+00	BUTT JOINT	30	86.7	7	0.2	0.03	0.04
243+00 TO 334+25		9125	26361.1	2109	52.7	7.91	13.18
334+25 TO 334+55	BUTT JOINT	30	86.7	7	0.2	0.03	0.04
334+55 TO 339+05	OMISSION S.N. 038-0103						
339+05 TO 339+35	BUTT JOINT	30	86.7	7	0.2	0.03	0.04
339+35 TO 533+79		19444	56171.6	4494	112.3	16.85	28.09
533+79 TO 534+09	BUTT JOINT	30	86.7	7	0.2	0.03	0.04
534+09 TO 534+65	OMISSION S.N. 038-0142						
534+65 TO 534+95	BUTT JOINT	30	86.7	7	0.2	0.03	0.04
534+95 TO 608+33		7338	21198.7	1696	42.4	6.36	10.6
608+33 TO 608+63	BITUMINOUS TRANSITION	30	86.7	7	0.2	0.03	0.04
608+63 TO 625+87	MILLING AREA AT IL 1	1724	13260.0	1061	26.5	3.98	6.63
TOTAL				9402	235.1	35.28	58.74

LOCATION	FOOT
SN 038-0103	52
SN 038-0142	52
TOTAL	104

SCHEDULES

3/11/2005 c:\projects\ed03104\ol\shrs.dgn

F.A.P. RITE	SECTION	COUNTY	TOTAL SHEETS	SHEET NO.
681	(118,119)RS-3	IRROQUOIS	18	6
STA.		TO STA.		
FED. ROAD DIST. NO.		ILLINOIS	FED. AID PROJECT	

SIDEROAD AND ENTRANCE SCHEDULE

STA	SIDE	SIDEROAD OR ENTRANCE	MAT	WIDTH FOOT	AREA SQ YD	INC BIT SURF TON	BIT MAT'L (PR CT) GAL	AGG (PR CT) TON	TEMP RAMP SQ YD	BIT SURF REM 3/4" SQ YD	BIT SURF REM BUTT JT SQ YD	AGG BASE CSE TY A TON	AGG SURF TY B TON
294+88	RT	1500 E	A3	24	123	10.3	9.8	0.25	13.3	123			
294+88	LT	1500 E	A3	24	123	10.3	9.8	0.25	13.3	123			
339+68	LT	PE	AGG	17	30	2.5	11.3	0.06					0.5
340+68	RT	1580 E	A3	20	110	9.2	8.8	0.22	11.1	110			
340+71	RT	MBTO	BIT	40	29	2.4	2.3	0.06		29			
341+08	LT	MBTO	BIT	40	29	2.4	2.3	0.06		29			
342+48	RT	PE	BIT	17	30	2.5	2.4	0.06	7.6	22.4	7.6		
343+28	RT	PE/MBTO	BIT	22	98	8.2	7.8	0.2	9.8	88.2	9.8		
344+88	RT	PE	AGG	18	31	2.6	11.6	0.06					0.6
349+08	RT	1600 E	A3	24	123	10.3	9.8	0.25	13.3	123			
349+44	RT	PE	BIT / AGG	23	37	3.1	3	0.07		37			0.7
362+43	LT	1620 E	A3	24	123	10.3	9.8	0.25	13.3	123			
384+08	RT	PE	AGG	42	58	4.9	21.8	0.12					1.3
38+448	RT	PE/MBTO	BIT / AGG	24	54	4.5	4.3	0.11		54			0.8
386+08	LT	PE/MBTO	BIT / AGG	25	55	4.6	4.4	0.11		55			0.8
402+68	RT	1700 E	A3	14	90	7.6	7.2	0.18	7.8	90			
402+68	LT	1700 E	A3	18	103	8.7	8.2	0.21	10	103			
413+98	LT	PE	AGG	16	29	2.4	10.9	0.06					0.5
414+48	RT	MBTO	BIT	25	23	1.9	1.8	0.05		23			
414+88	LT	PE	AGG	25	39	3.3	14.6	0.08					0.8
438+68	LT	PE	AGG	14	27	2.3	10.1	0.05					0.4
438+68	RT	MBTO	BIT	25	23	1.9	1.8	0.05		23			
441+53	LT	PE	AGG	25	39	3.3	14.6	0.08					0.8
441+53	RT	PROP MBTO	BIT	20	41	4.6					17		
479+68	RT	PE/MBTO	BIT / AGG	28	58	4.9	4.6	0.12		58			0.9
503+24	RT	CE	A3	44	60	5	4.8	0.12	24.4	60			
506+46	RT	CE	A3	45	61	5.1	4.9	0.12	25	61			
509+18	RT	1900 E	A3	25	126	10.6	10.1	0.25	13.9	126			
509+18	LT	1900 E	A3	24	123	10.3	9.8	0.25	13.3	123			
511+18	RT	MBTO	BIT	25	23	1.9	1.8	0.05		23			
511+68	LT	PE	AGG	18	31	2.6	11.6	0.06					0.6
513+68	RT	PE/MBTO	BIT / AGG	12	40	3.4	3.2	0.08		40			0.4
529+48	RT	MBTO	BIT	25	23	1.9	1.8	0.05		23			
529+48	RT	PE	AGG	12	24	2	9	0.05					0.4
552+68	RT	PE/MBTO	BIT / AGG	26	56	4.7	4.5	0.11		56			0.8
563+08	LT	2000 E	A3	24	123	10.3	9.8	0.25	13.3	123			
564+08	LT	PE	AGG	18	31	2.6	11.6	0.06					0.6
564+08	LT	MBTO	BIT	25	23	1.9	1.8	0.05		23			
565+68	LT	PE	AGG	18	31	2.6	11.6	0.06					0.6
568+48	RT	PE/MBTO	BIT / AGG	22	52	4.4	4.2	0.1		52			0.7
569+88	RT	PE	AGG	22	36	3	13.5	0.07					0.7
573+22	LT	MBTO	BIT	25	23	1.9	1.8	0.05		23			
573+68	LT	MBTO	BIT	25	23	1.9	1.8	0.05		23			
574+88	LT	PE	AGG	35	50	4.2	18.8	0.1					1.1
576+48	LT	PE	AGG	25	39	3.3	14.6	0.08					0.8
589+48	RT	2050 E	A3	24	123	10.3	9.8	0.25	13.3	123			
589+66	LT	PE/MBTO	BIT / AGG	24	54	4.5	4.3	0.11		54			0.8
616+22		IL 1 (SEE RESURFACING SCHEDULE)											
		TOTAL				227.4	358.1	5.38	202.7	2146.6	17.4	17	15.6

SEEDING SCHEDULE

LOCATION	SIDE	SEEDING CL 2	FURN EXC	EROSION CONTROL BLANKET	NIT FERT NUT	PHOS FERT NUT	POT FERT NUT
		ACRE	CU YD	SQ YD	LB	LB	LB
1500 E	RT	0.011	1.5	52	1	1	1
1500 E	LT	0.011	1.5	52	1	1	1
1580 E	RT	0.011	1.5	52	1	1	1
1600 E	RT	0.011	1.5	52	1	1	1
1620 E	LT	0.011	1.5	52	1	1	1
1700 E	RT	0.011	1.5	52	1	1	1
1700 E	LT	0.011	1.5	52	1	1	1
1900 E	RT	0.011	1.5	52	1	1	1
1900 E	LT	0.011	1.5	52	1	1	1
2000 E	LT	0.011	1.5	52	1	1	1
2050 E	RT	0.011	1.5	52	1	1	1
		0.121	16.5	572	11	11	11

SCHEDULES

F.A.P. RTE.	SECTION	COUNTY	TOTAL SHEETS	SHEET NO.
681	(118,119)RS-3	IROQUOIS	18	7
STA.		TO STA.		
FED. ROAD DIST. NO.		ILLINOIS FED. AID PROJECT		

LOCATION	THERMO PVMT MARK YELLOW 4"	THERMO PVMT MARK WHITE 6"	THERMO PVMT MARK WHITE 8"	THERMO PVMT MARK YELLOW 12" 12"		THERMO PVMT MARK WHITE 24"	THERMO PVMT MARK LETTERS & SYMBOLS SQ FT
	FOOT	FOOT	FOOT	FOOT	FOOT	FOOT	
US 52 & IL 1	10540	38	935	1119	150	160	186
TOTAL	10540	38	935	1269		160	186

STA TO STA	LOCATION	LENGTH FOOT	SHORT TERM PAVEMENT MARKING YELLOW	WORK ZONE PAVEMENT MARKING REMOVAL	TEMPORARY PAVEMENT MARKING 4"	TEMPORARY PAVEMENT MARKING 6"	TEMPORARY PAVEMENT MARKING 8"	TEMPORARY PAVEMENT MARKING 12"	TEMPORARY PAVEMENT MARKING 24"	THERMO PVMT MARK LETTERS & SYMBOLS SQ FT
			FOOT	SQ FT	FOOT	FOOT	FOOT	FOOT	FOOT	FOOT
242+70 TO 334+55		9185	1837	306	18370	2296				
334+55 TO 339+05	OMISSION S.N. 038-0103									
339+05 TO 534+09		19504	3901	650	39008	4876				
534+09 TO 534+65	OMISSION S.N. 038-0142									
534+65 TO 608+63		7398	1480	247	14796	1850				
608+63 TO 625+87	MILLING AREA AT IL 1		2108	351	10540	38	935	1269	160	186
TOTAL			9326	1554	82714	9060	935	1269	160	186

STA TO STA	LOCATION	LENGTH FOOT	PRISMATIC CURB REFLECTORS	RAISED REFLECT PVMT MARKER	RAISED REFLECT PVMT MARKER REM
			EACH	EACH	EACH
242+70 TO 334+55		9185		115	115
334+55 TO 339+05	OMISSION S.N. 038-0103				
339+05 TO 534+09		19504		244	244
534+09 TO 534+65	OMISSION S.N. 038-0142				
534+65 TO 608+63		7398		92	92
608+63 TO 625+87	MILLING AREA AT IL 1		16	219	219
TOTAL			16	670	670

STA TO STA	LOCATION	LENGTH FOOT	PAINT PVMT MARK WHITE 4"	PAINT PVMT MARK YELLOW 6"
			FOOT	FOOT
242+70 TO 334+55		9185	18370	2296
334+55 TO 339+05	OMISSION S.N. 038-0103			
339+05 TO 534+09		19504	39008	4876
534+09 TO 534+65	OMISSION S.N. 038-0142			
534+65 TO 608+63		7398	14796	1850
608+63 TO 625+87	MILLING AREA AT IL 1			
TOTAL			72174	9022

SCHEDULES

3/11/2005 c:\proj\ecrs\ed03\04\01\shrs.dgn

F.A.P. RTE.	SECTION	COUNTY	TOTAL SHEETS	SHEET NO.
681	(118,119)RS-3	IROQUOIS	18	8
STA.		TO STA.		
FED. ROAD DIST. NO.		ILLINOIS FED. AID PROJECT		

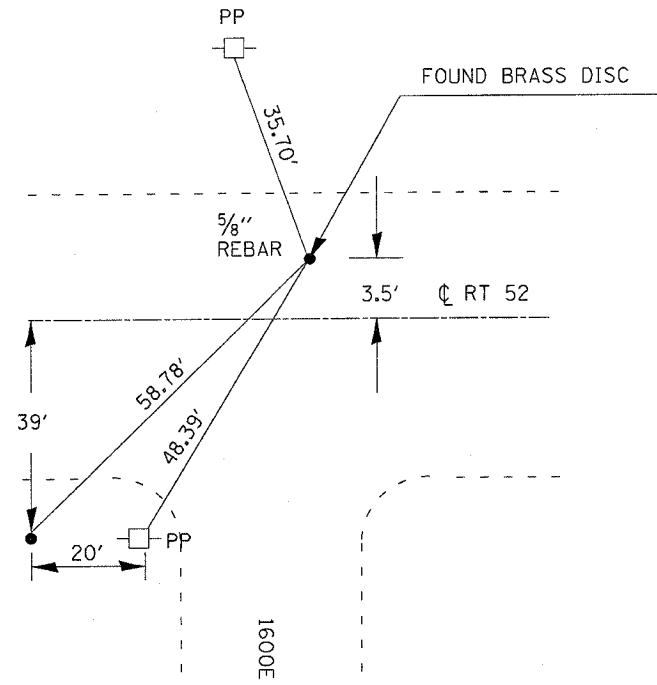

PERMANENT SURVEY MARKER, TY 1
NO MONUMENT RECORD
SE COR SEC 21, T28N, R13W, 2ND PM
IROQUOIS COUNTY

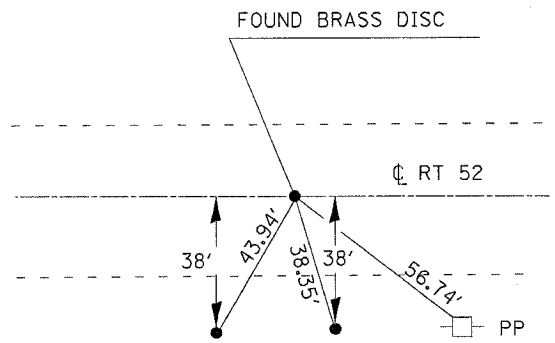

PERMANENT SURVEY MARKER, TY 1
NO MONUMENT RECORD
S1/4 COR SEC 24, T28N, R13W, 2ND PM
IROQUOIS COUNTY

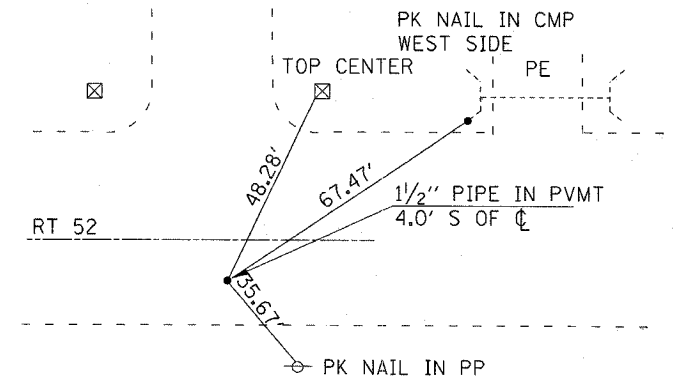

PERMANENT SURVEY MARKER, TY 1
MONUMENT RECORD
SE COR SEC 19, T28N, R12W, 2ND PM
IROQUOIS COUNTY
RECORDER NO 79R2569

TIE POINTS

F.A.P. RTE.	SECTION	COUNTY	TOTAL SHEETS	SHEET NO.
681	(118,119)RS-3	IROQUOIS	18	9
STA.		TO STA.		
FED. ROAD DIST. NO.	ILLINOIS	FED. AID PROJECT		

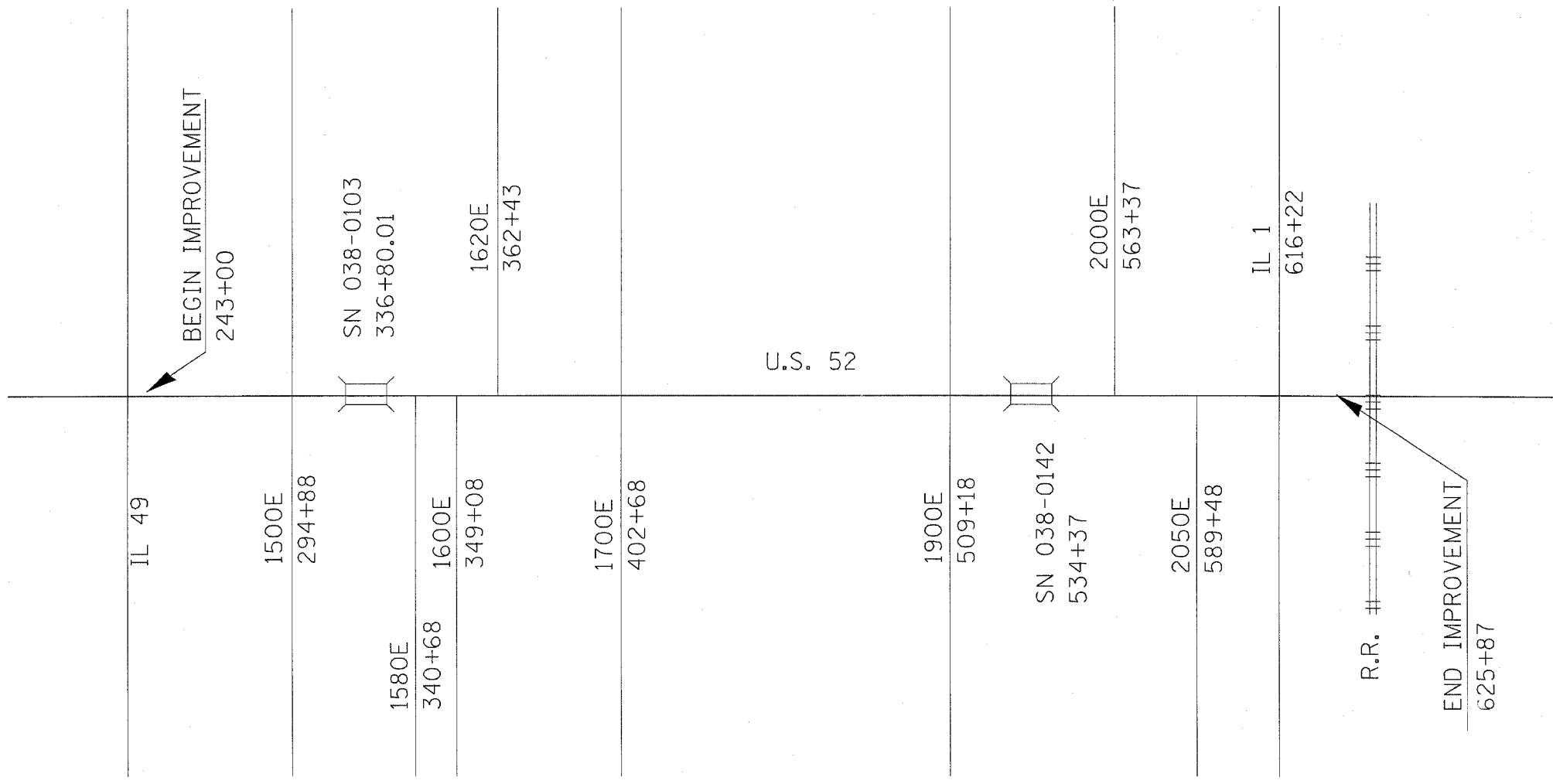

REFERENCE MAP

F.A.P. RTE.	SECTION	COUNTY	TOTAL SHEETS	SHEET NO.
681	(118,119)RS-3	IRROQUOIS	18	10
STA.		TO STA.		
FED. ROAD DIST. NO.		ILLINOIS	FED. AID PROJECT	

END INTERSECTION IMPROVEMENT
NORTH OF U.S. 52 @ SN 038-0020



STA. 616+22 (U.S. 52) AT CL IL RTE 1

BEGIN BIT SURF REM 1/2"
759' WEST OF IL 1 STA 608+63

END IMPROVEMENT 965' EAST OF
IL 1 STA 625+87

ILL RTE 1

U.S. 52

END INTERSECTION IMPROVEMENT
711' SOUTH OF U.S. 52

**INTERSECTION
LAYOUT**

F.A.P. RTE.	SECTION	COUNTY	TOTAL SHEETS	SHEET NO.
681	(118,119)RS-3	IROQUOIS	18	11
STA.		TO STA.		
FED. ROAD DIST. NO.		ILLINOIS FED. AID PROJECT		



MATCH LINE A-A

MATCH LINE C-C

MATCH LINE B-B

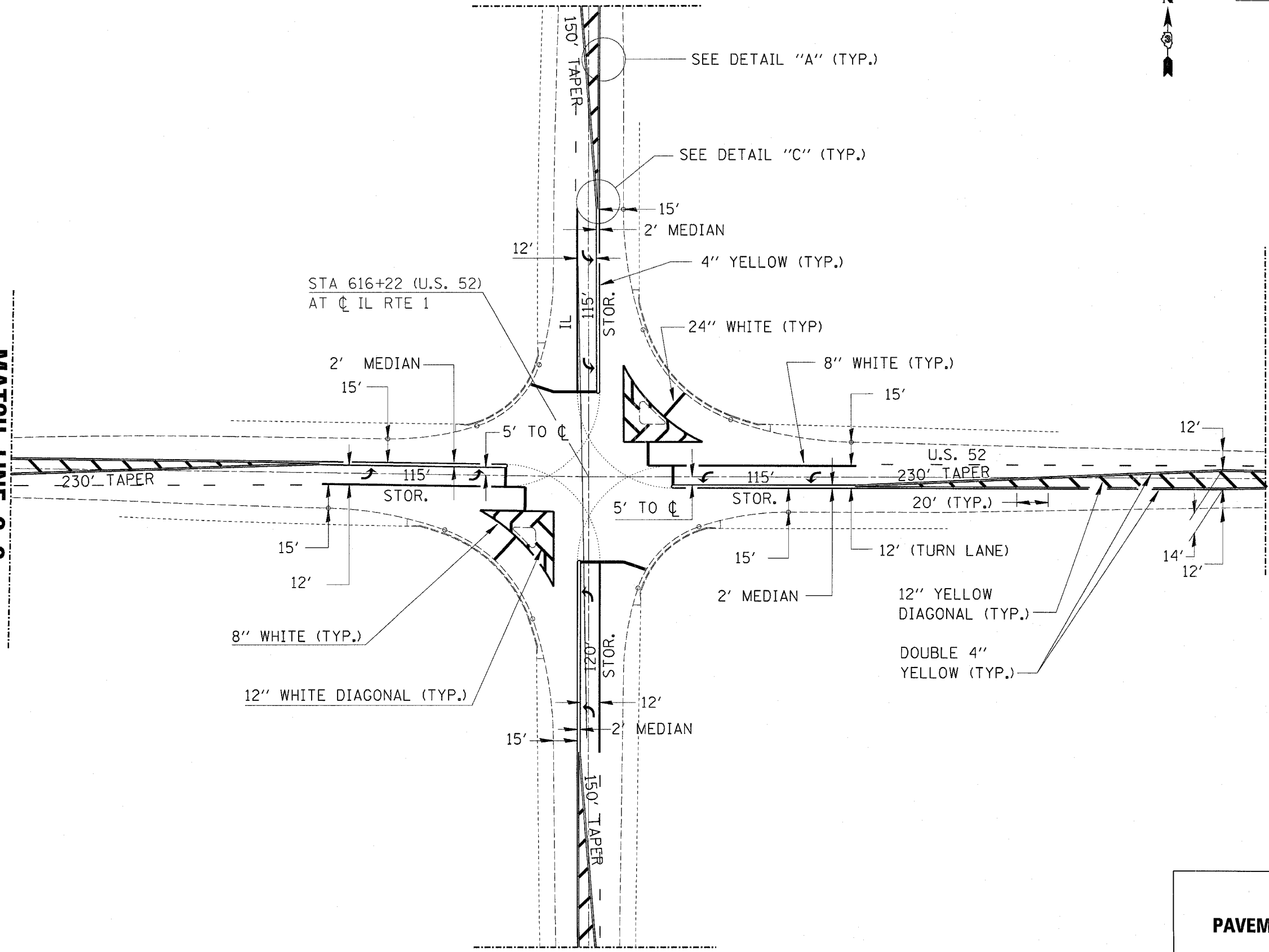

STA 616+22 (U.S. 52)
AT CL IL RTE 1

**PAVEMENT MARKING
DETAILS**

F.A.P. RTE.	SECTION	COUNTY	TOTAL SHEETS	SHEET NO.
681	(118,119)RS-3	IRROQUOIS	18	12
STA.		TO STA.		
FED. ROAD DIST. NO.		ILLINOIS	FED. AID PROJECT	

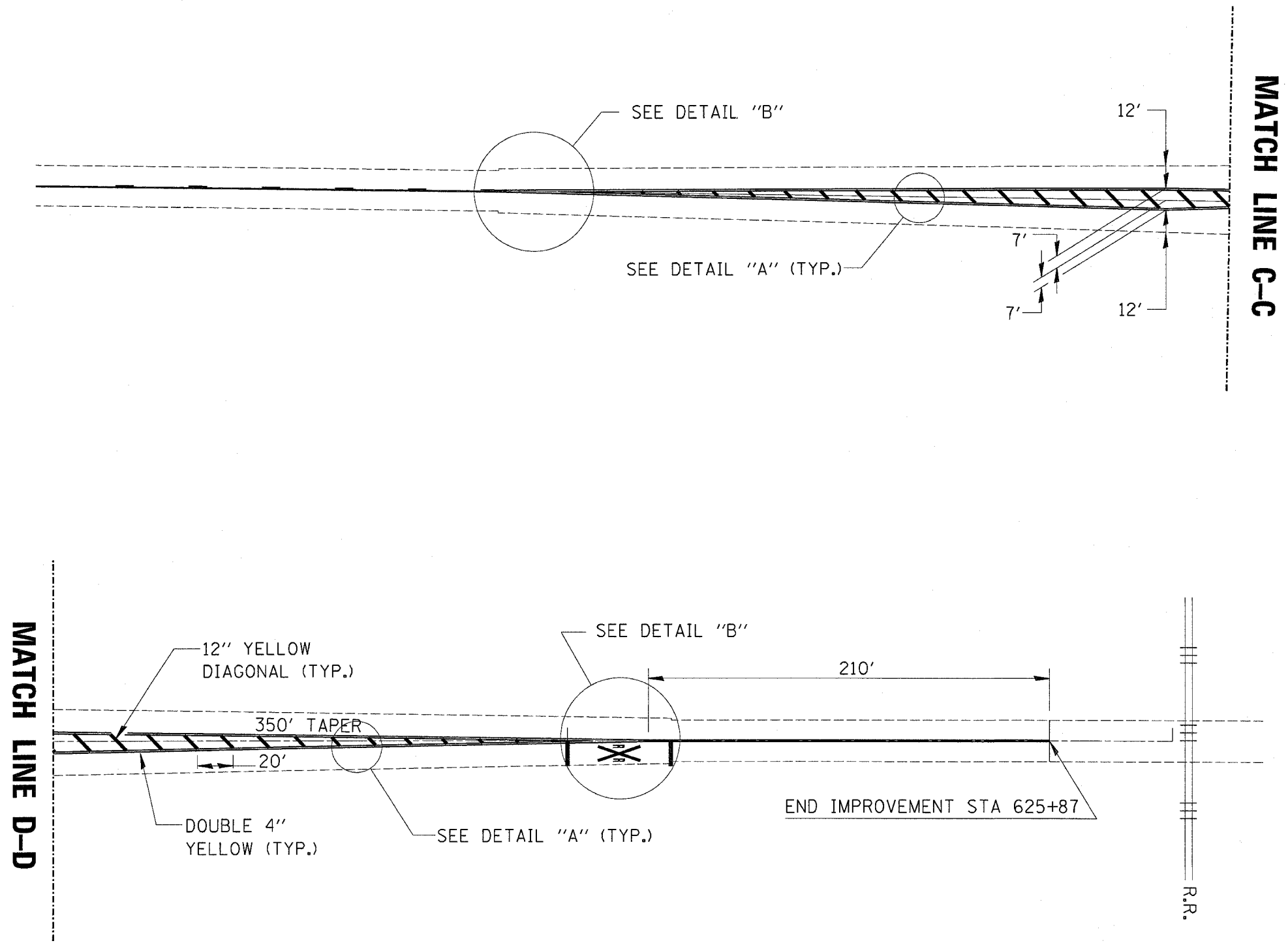

**PAVEMENT MARKING
DETAILS**

F.A.P. RTE.	SECTION	COUNTY	TOTAL SHEETS	SHEET NO.
681	(118,119)RS-3	IROQUOIS	18	13
STA.		TO STA.		
FED. ROAD DIST. NO.	ILLINOIS	FED. AID PROJECT		

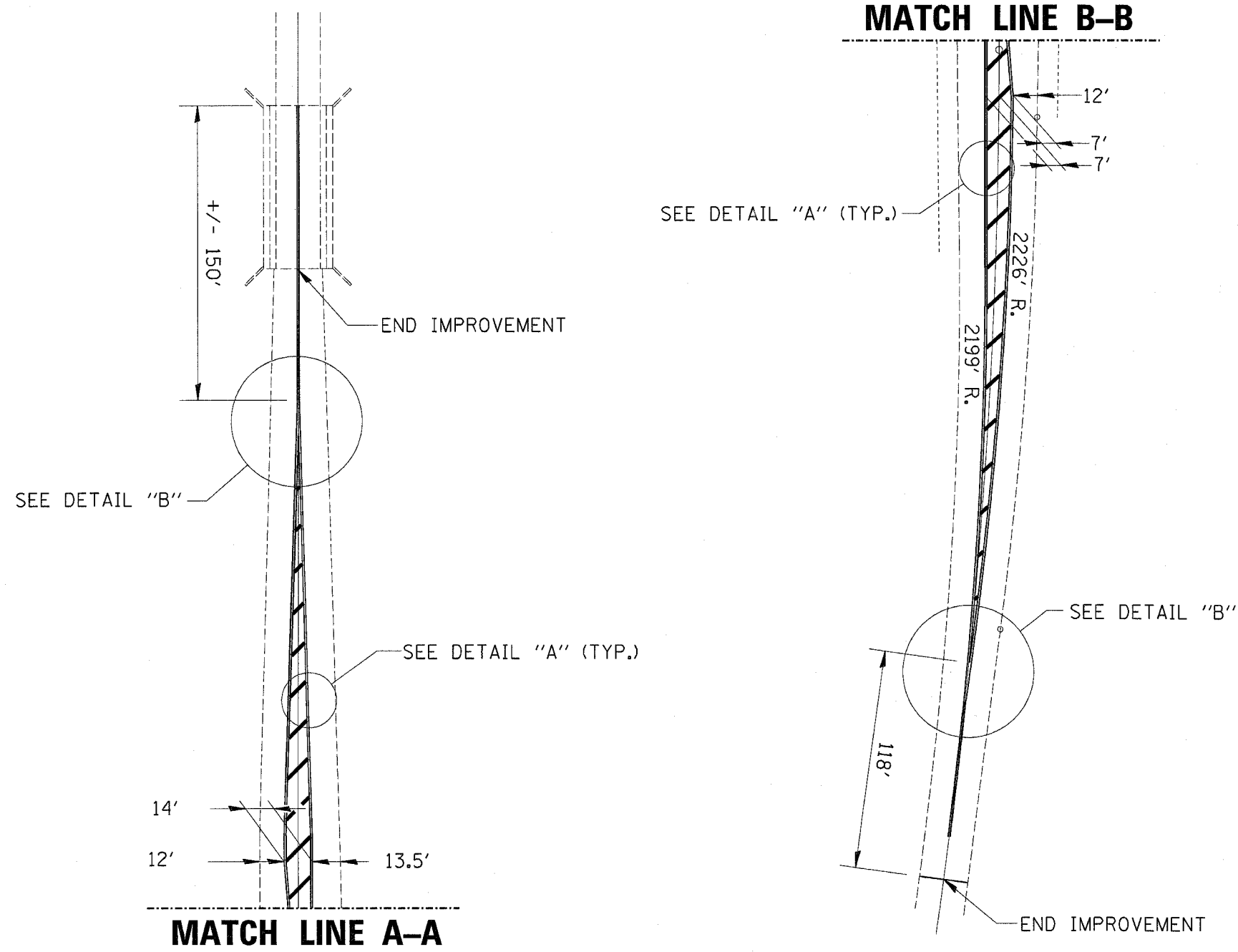

**PAVEMENT MARKING
DETAILS**

F.A.P. RTE.	SECTION	COUNTY	TOTAL SHEETS	SHEET NO.
681	(118,119)RS-3	IROQUOIS	18	14
STA.		TO STA.		
FED. ROAD DIST. NO.		ILLINOIS FED. AID PROJECT		

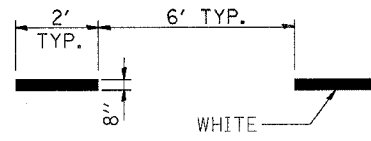

SKIP DASHES AT LEFT TURN LANES

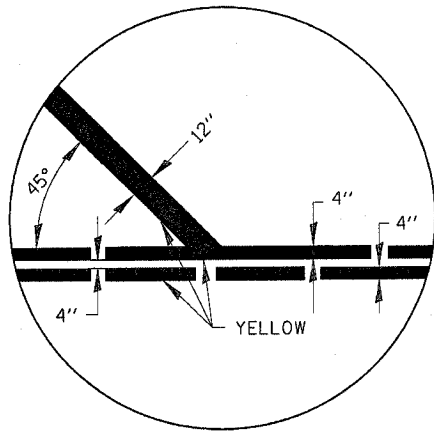

DETAIL "A"

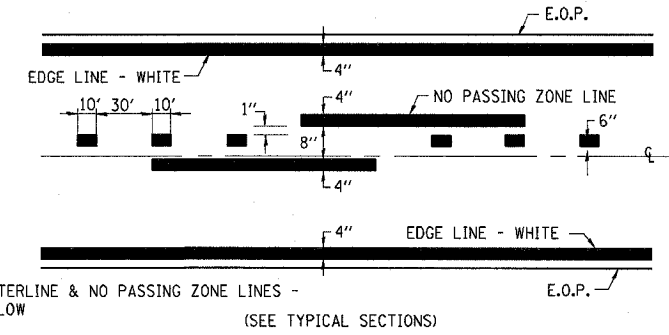

PAVEMENT MARKING

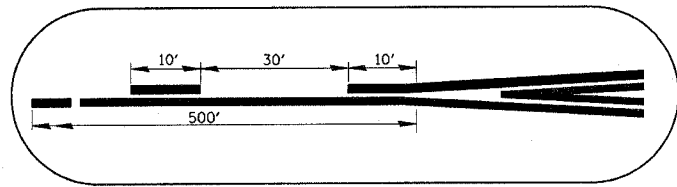

DETAIL "B"

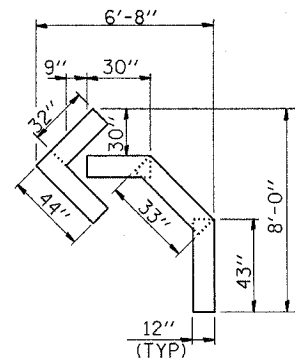

QUANTITY
12" LINE = 16 LIN. FT.
OR 4" LINE = 48 LIN. FT.

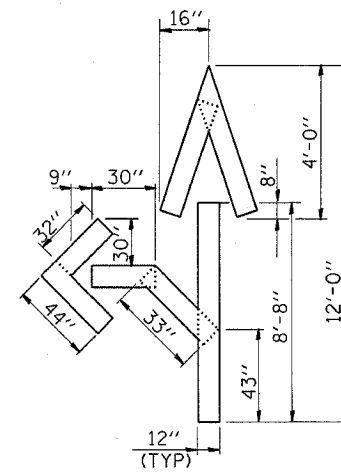

QUANTITY
12" LINE = 29 LIN. FT.
OR 4" LINE = 87 LIN. FT.

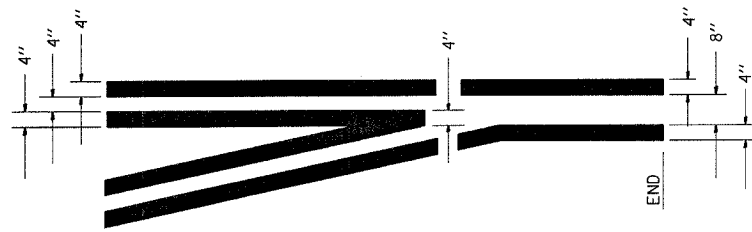

DETAIL "C"

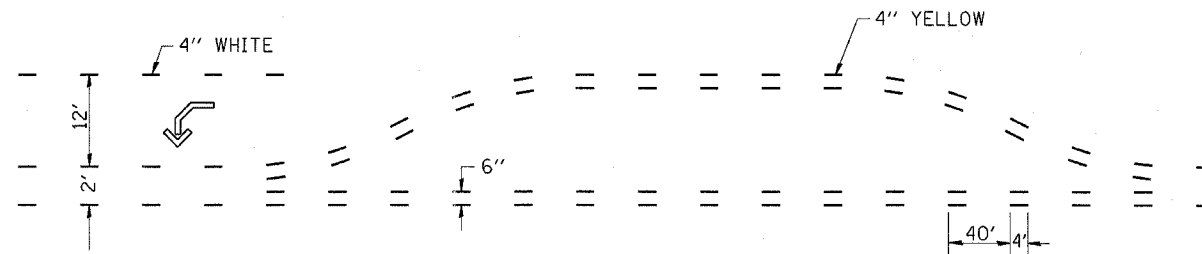

SHORT-TERM PAVEMENT MARKING FOR MEDIANS AND ARROWS

DETAILS

F.A.P. R.T.E.	SECTION	COUNTY	TOTAL SHEETS	SHEET NO.
681	(118,119)RS-3	IROQUOIS	18	15
STA.		TO STA.		
FED. ROAD DIST. NO.		ILLINOIS FED. AID PROJECT		

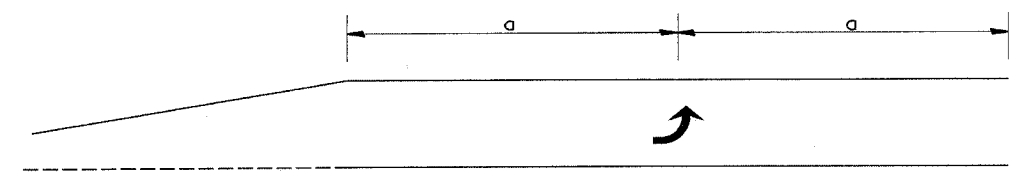

99' AND UNDER

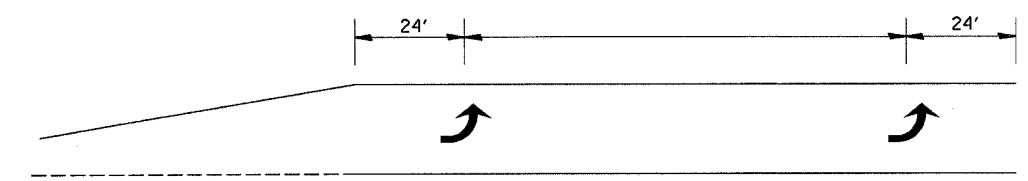

100' TO 149'

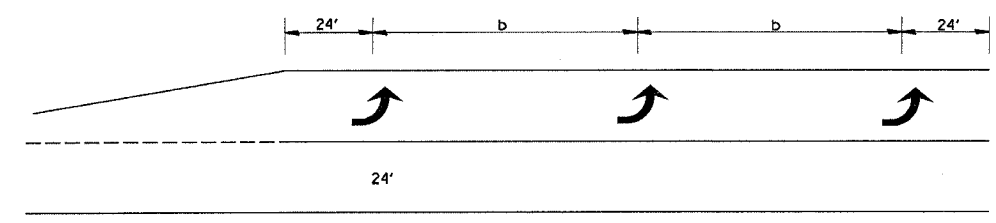

150' AND LONGER

TYPICAL PLACEMENT OF ARROWS IN TURN LANES

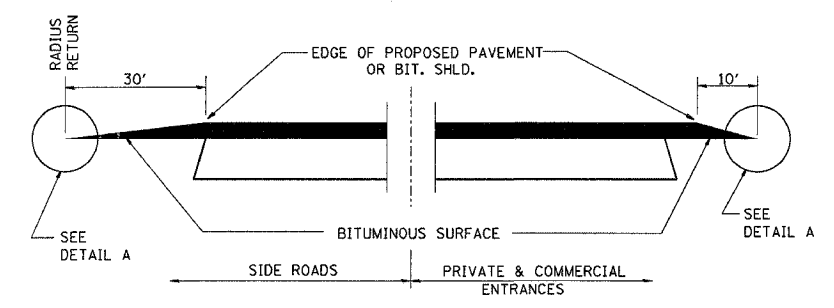

SECTION A-A
DETAILS AT ENTRANCES & SIDE ROADS

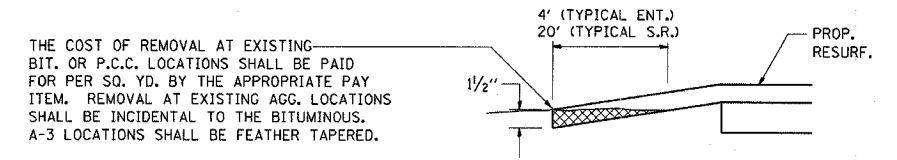

DETAIL A

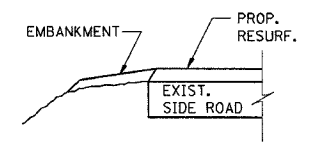

SECTION B-B

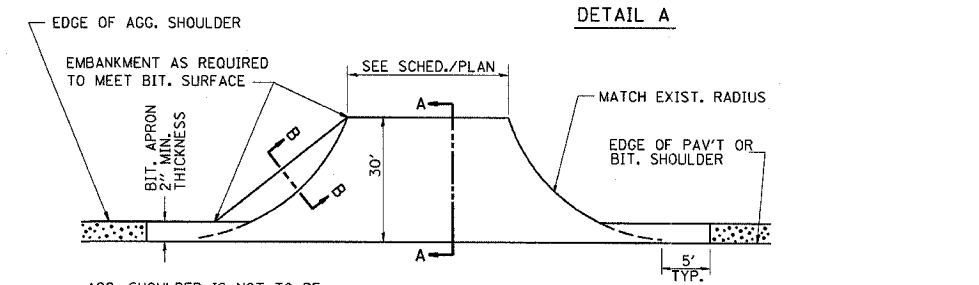

PLAN AT SIDE ROADS

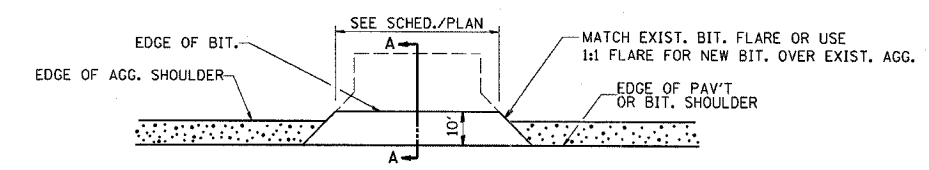

PLAN AT PRIVATE & COMMERCIAL ENTRANCES
(DO NOT RESURFACE FIELD ENTRANCES)

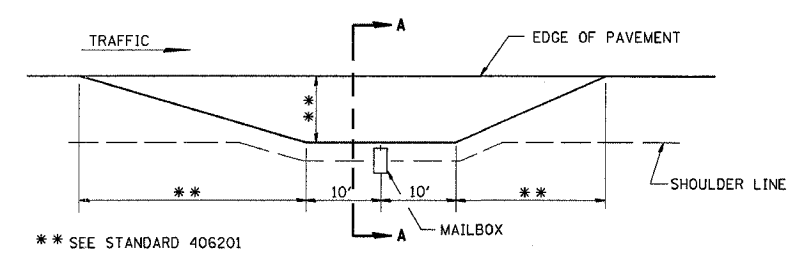

SECTION A-A
MAILBOX TURNOUT DETAILS

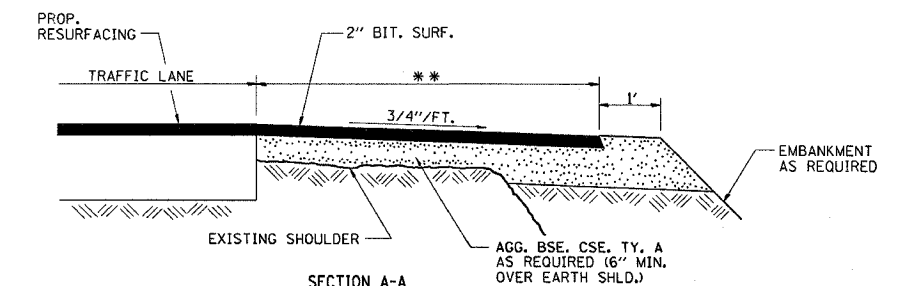

DETAILS

F.A.P. RTE.	SECTION	COUNTY	TOTAL SHEETS	SHEET NO.
681	(118,119)RS-3	IROQUOIS	18	16
STA. TO STA.				
FED. ROAD DIST. NO.			ILLINOIS FED. AID PROJECT	

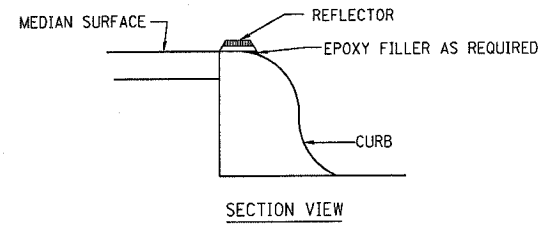

NOTES

1. PRISMATIC REFLECTORS SHALL BE MONO-DIRECTIONAL AND POSITIONED SO THAT THE REFLECTIVE FACE IS FACING THE APPROACHING TRAFFIC.
2. PRISMATIC REFLECTORS SHALL BE SECURED IN PLACE WITH AN EPOXY ADHESIVE.
3. PRISMATIC REFLECTORS SHALL BE EITHER AMBER OR CRYSTAL IN COLOR.

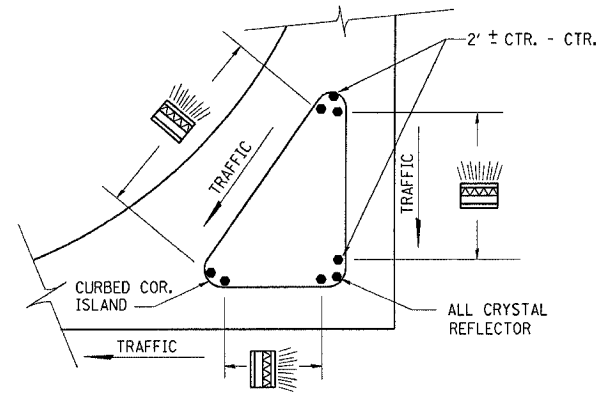

PRISMATIC REFLECTORS

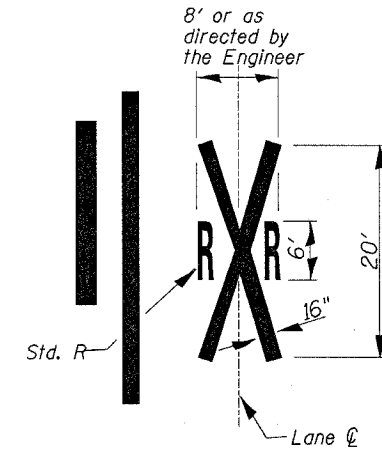

PAVEMENT MARKINGS AT RAILROAD-HIGHWAY GRADE CROSSING

NOTES

The transverse spread of the "x" may vary according to lane width.

On multi-lane roads, the stop lines shall extend across all approach lanes and separate RXR symbols shall be placed adjacent to each other in each lane.

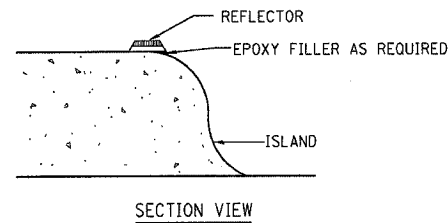

NOTES

1. PRISMATIC REFLECTORS SHALL BE MONO-DIRECTIONAL AND POSITIONED SO THAT THE REFLECTIVE FACE IS FACING THE APPROACHING TRAFFIC.
2. PRISMATIC REFLECTORS SHALL BE SECURED IN PLACE WITH AN EPOXY ADHESIVE.
3. PRISMATIC REFLECTORS SHALL BE EITHER AMBER OR CRYSTAL IN COLOR.

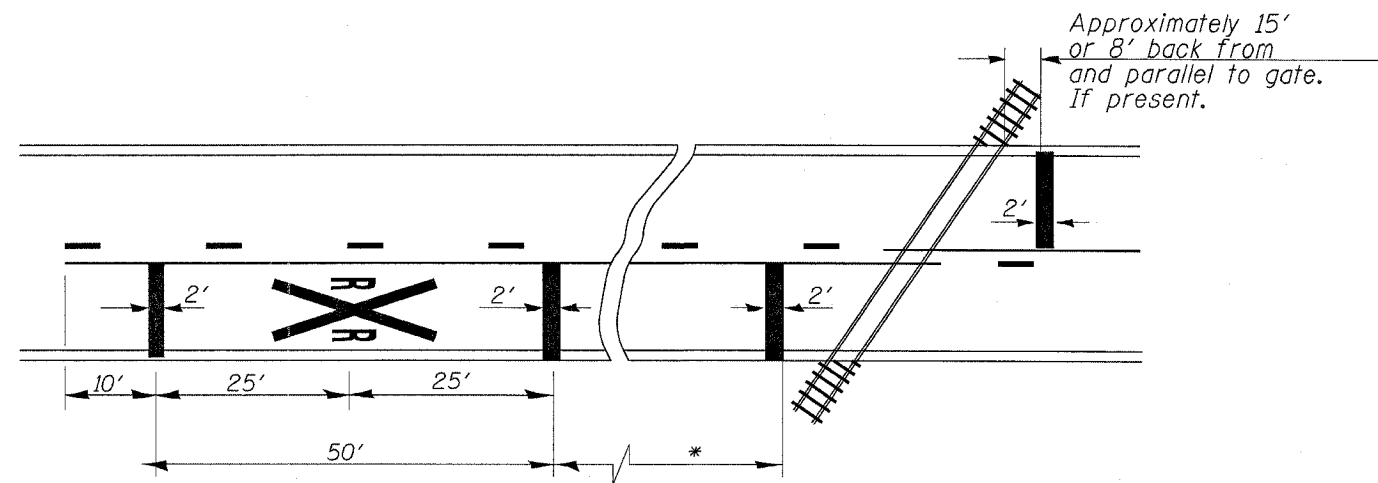

- * Minimum Distance
 400' for 55 MPH
 250' for 45 MPH
 100' for 35 MPH or Less

DETAILS

F.A.P. RTE.	SECTION	COUNTY	TOTAL SHEETS	SHEET NO.
681	(118,119)RS-3	IROQUOIS	18	17
STA.	TO STA.			
FED. ROAD DIST. NO.	ILLINOIS FED. AID PROJECT			

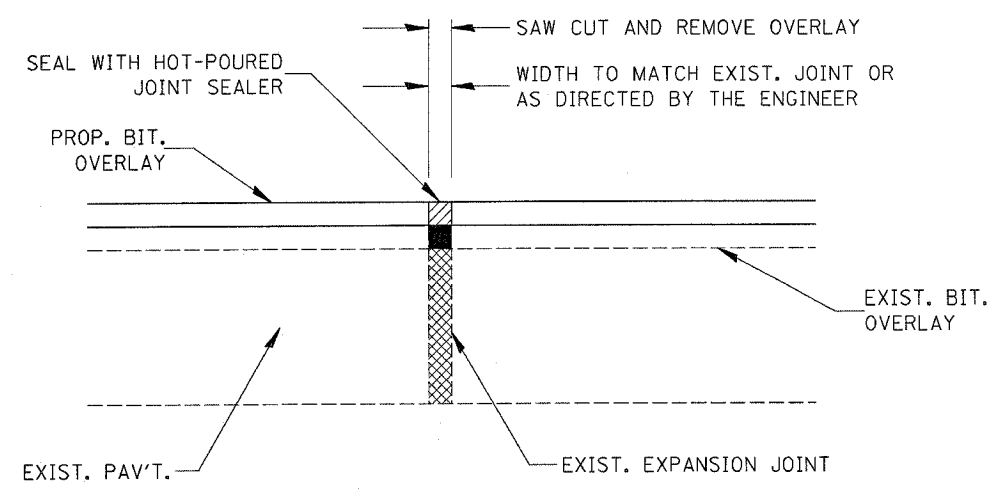

EXPANSION JOINT REHABILITATION DETAIL

GENERAL NOTES:

1. THE NEW BITUMINOUS OVERLAY SHALL BE SAWED, REMOVED, AND THE JOINT AREA CLEANED. PRIOR TO PLACING THE HOT-POURED JOINT SEALER THE JOINT SHALL BE BLOWN OUT WITH COMPRESSED AIR.
2. THIS WORK SHALL BE PAID FOR AT THE CONTRACT UNIT PRICE PER FOOT FOR EXPANSION JOINT REHABILITATION.

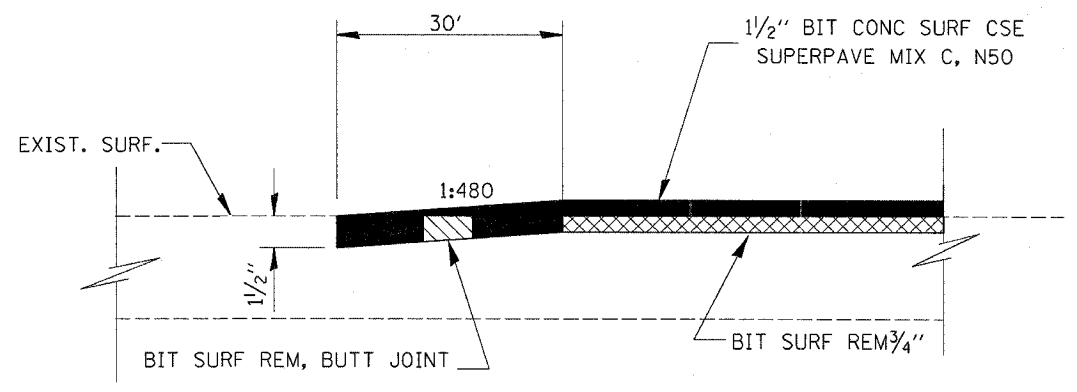

BITUMINOUS SURF REM - BUTT JT

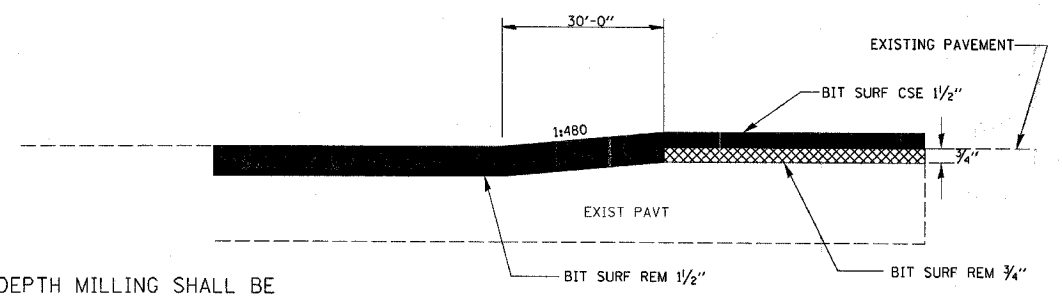

NOTE: VARIABLE DEPTH MILLING SHALL BE PAID FOR AS BIT SURF REM 1/2"

BITUMINOUS SURFACE REMOVAL TRANSITION

608+33 TO 608+63

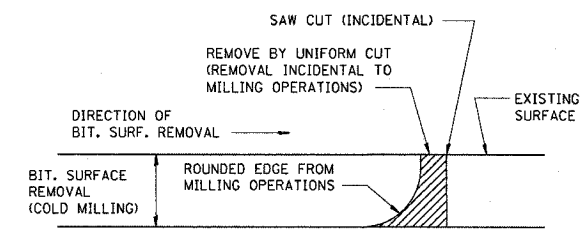

NOTE: WHEN MILLING OPERATIONS PRODUCE A ROUNDED EDGE, THEN A SAW CUT SHALL BE USED TO MANUFACTURE A PERPENDICULAR EDGE AS SHOWN IN THE DETAIL. THE ENGINEER SHALL BE THE SOLE JUDGE CONCERNING THE USE OF THIS DETAIL

BITUMINOUS DETAIL AT BUTT JOINTS

DETAILS

3/11/2005 c:\proj\ectrs\ed03104\o1\shrs.dgn

F.A.P. RTE.	SECTION	COUNTY	TOTAL SHEETS	SHEET NO.
681	(118,119)RS-3	ILROQUOIS	18	18
STA.	TO STA.			
FED. ROAD DIST. NO.	ILLINOIS	FED. AID PROJECT		

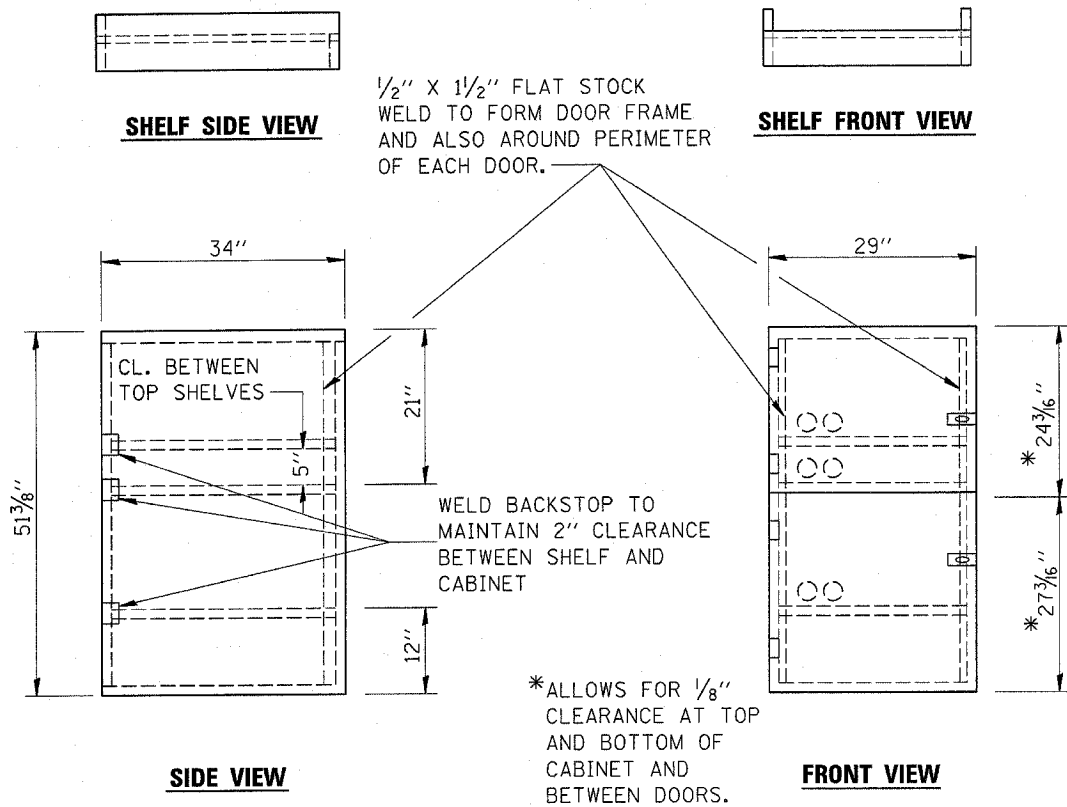

- NOTES:
1. USE 16 GAUGE STEEL FOR CABINET.
 2. THE TOP SHELF SHALL SLIDE IN OR OUT WITH THE TOP DOOR OPEN.
 3. ALL HINGES AND HASPS WILL BE WELDED TO THE CABINET.
 4. ALL EDGES SHALL BE GROUND SMOOTH.
 5. TWO (2" DIA.) ACCESS HOLES WILL BE REQUIRED FOR EACH SHELF.
 6. CABINET SHALL BE PAINTED WITH TWO COATS OF FLAT PAINT.
 7. 2 EACH MATCHING KEY PADLOCKS, WITH 3 KEYS PROVIDED, MASTER MODEL 3 T OR EQUIVALENT.
 8. 4 EACH PLAIN STEEL, NON-REMOVABLE PIN, NO HOLE 4"X4" SQUARE CORNER HINGES TO BE WELDED ON.
 9. 2 EACH EXTRA HEAVY, PLAIN STEEL, FIXED STAPLE, NO HOLE, 7/4" HASPS TO BE WELDED ON.

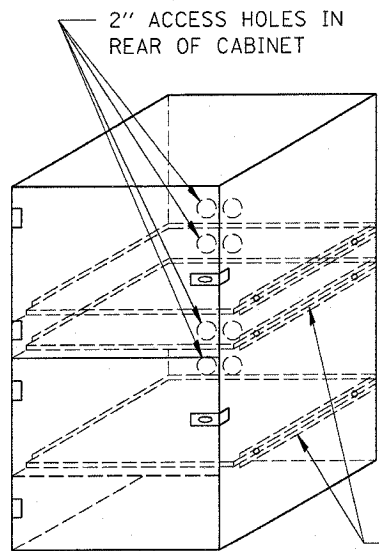

LOCKABLE COMPUTER CABINET

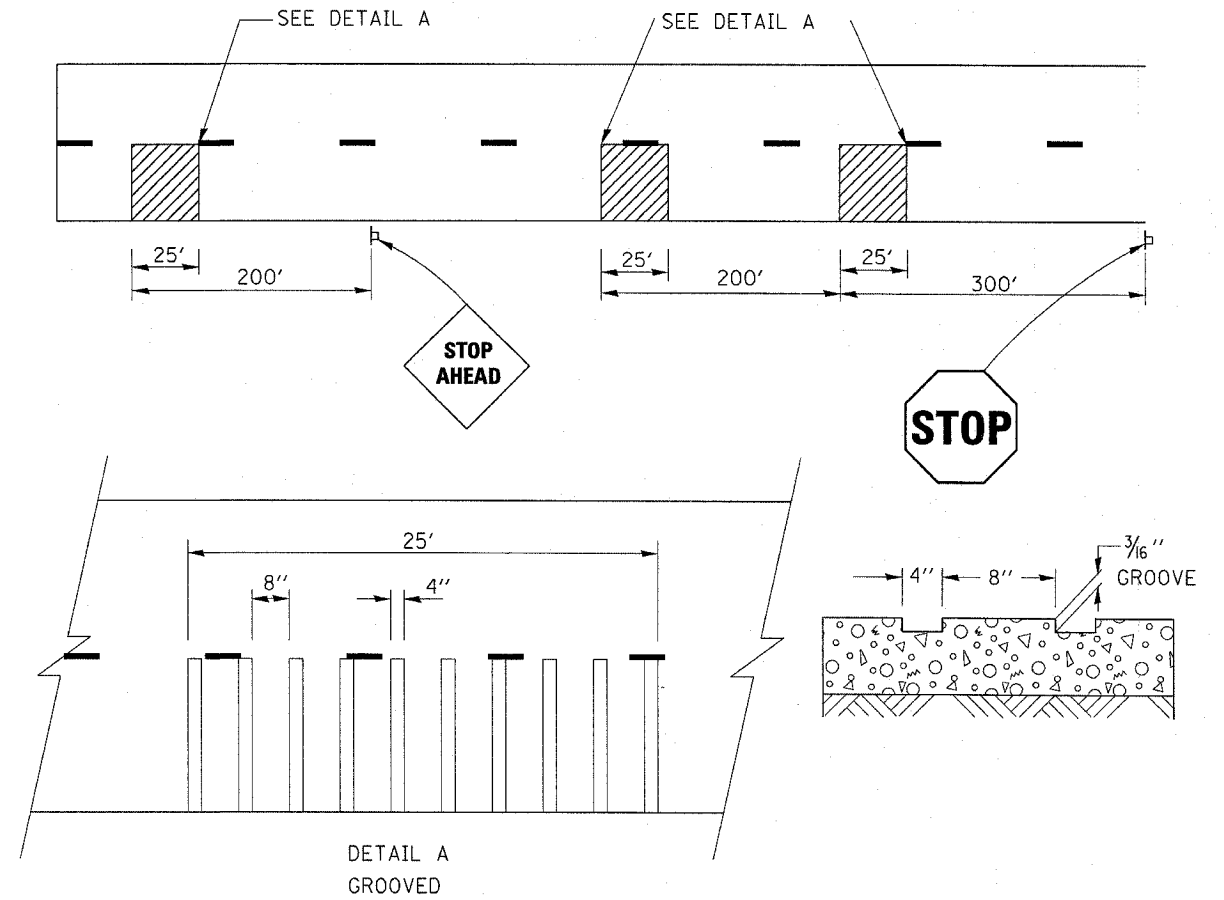

TYPICAL GROOVED RUMBLE STRIP APPLICATION IN ADVANCE OF AN INTERSECTION

REPLACE AT US 52 & IL 1

DETAILS