

F.A.P. RTE.	SECTION	COUNTY	TOTAL SHEETS	SHEET NO.
627	(1-1)I-1	LA SALLE	60	14
STA.		TO STA.		
FED. ROAD DIST. NO.		ILLINOIS	FED. AID PROJECT	
CONTRACT NO. 66550				

**LEGEND**

- XXXX TO BE COVERED
- FLASHING LIGHT
- △ 18"x8" ORANGE FLAG
- TT TYPE III BARRICADE
- DIRECTION ARROW CHANGE

- ① M1-I100 24x24  
M4-10 48x18  
DETOUR
- ② M1-I100 24x24  
M5-1 21x15  
DETOUR
- ③ M2-1 21x12  
M4-8 24x12  
JCT
- ④ M1-I100 24x24  
M6-6 21x15  
DETOUR
- ⑤ M1-I100 24x24  
M6-6 21x15  
DETOUR
- ⑥ M1-I100 24x24  
M4-10 48x18  
DETOUR
- ⑦ M1-I100 24x24  
M5-1 21x15  
DETOUR
- ⑧ STATE PARKS  
STARVED ROCK 3  
MATTHIESSEN 5  
BUFFALO ROCK 8  
ROAD TO PARKS OPEN SEE "SIGN DETAIL"
- ⑨ STATE PARKS  
STARVED ROCK  
BUFFALO ROCK  
MATTHIESSEN  
ROAD TO PARKS OPEN SEE "SIGN DETAIL"
- ⑩ STATE PARKS  
STARVED ROCK  
BUFFALO ROCK  
MATTHIESSEN  
ROAD TO PARKS OPEN SEE "SIGN DETAIL"
- ⑪ STATE PARKS  
STARVED ROCK  
BUFFALO ROCK  
MATTHIESSEN  
ROAD TO PARKS OPEN SEE "SIGN DETAIL"

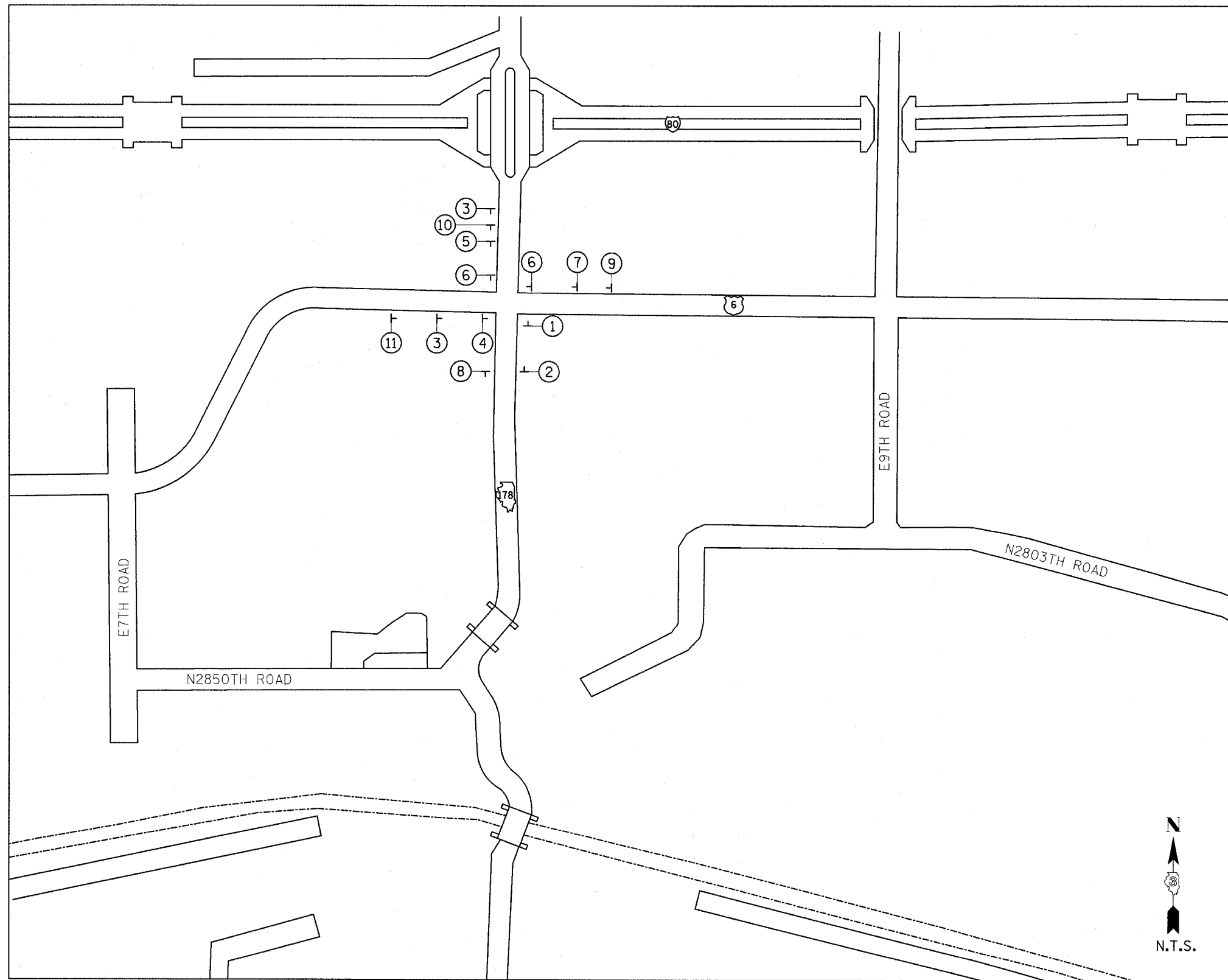

JUNCTION IL 178 & US 6



**SIGN DETAIL**  
SIGN PANEL - TYPE 1

**NOTES:**

- 1.) AREA = 5.25 SQ. FT.
- 2.) TOTAL AREA REQUIRED (4-SIGNS) = 21.0 SQ. FT.
- 3.) 4" SERIES C LETTERS
- 4.) LEGEND = BLACK
- 5.) BACKGROUND = ORANGE

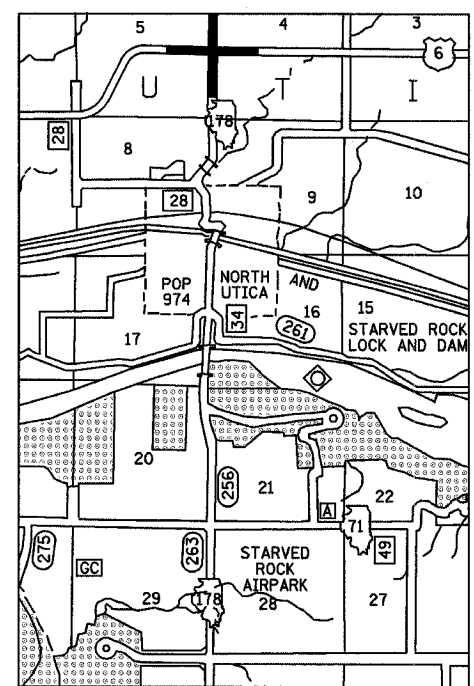

**LOCATION MAP**

**GENERAL NOTES:**

- 1.) ONLY SIGNS THAT ARE TO BE CHANGED OR ADDED ARE SHOWN ON THIS MAP.
- 2.) ALL SIGNS TO BE POST MOUNTED.

**DETOUR MAP**

IL ROUTE 71  
OVER TRIBUTARY TO ILLINOIS RIVER  
F.A.P. ROUTE 627 - SEC. (1-1)I-1  
LA SALLE COUNTY

DESIGNED BY MSW	 2700 McGraw Drive Bloomington, Illinois 61704 309/893-9435, 309/893-1871 fax	FILE NO. 24-6772
DRAWN BY DJM		DATE 03/24/05
CHECKED BY MSW		SHEET NO. 14 of 60