

F.A.P. RTE.	SECTION	COUNTY	TOTAL SHEETS	SHEET NO.
627	(1-1)I-1	LA SALLE	60	51
STA.	TO STA.			
FED. ROAD DIST. NO.	ILLINOIS FED. AID PROJECT			
CONTRACT NO. 66550				

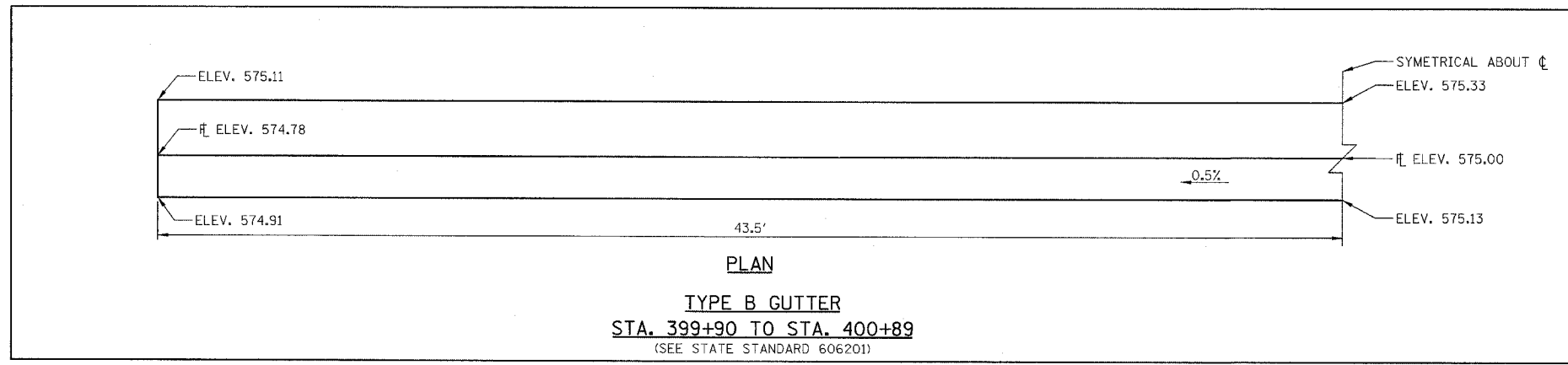
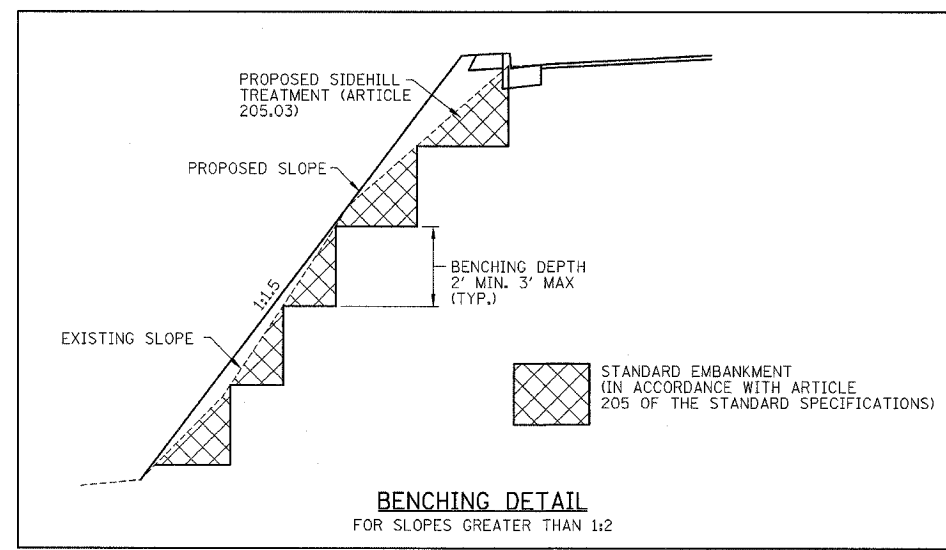
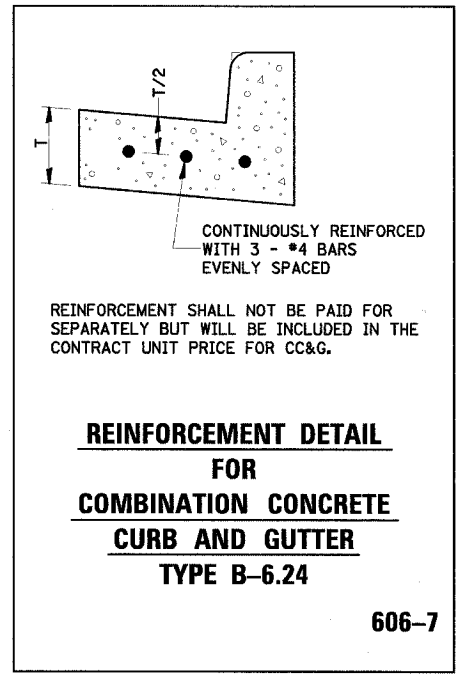

DISTRICT DETAIL AND DETAILS

IL ROUTE 71
OVER TRIBUTARY TO ILLINOIS RIVER
F.A.P. ROUTE 627 - SEC. (1-1)I-1
LA SALLE COUNTY

DESIGNED BY MSW	<p>Farnsworth GROUP 2708 McGraw Drive Bloomington, Illinois 61704 309/883-6426 309/883-9771 fax</p>	FILE NO. 24-6772
DRAWN BY DJM		DATE 03/24/05
CHECKED BY MSW		SHEET NO. 51 OF 60