

F.A.I. RTE.	SECTION	COUNTY	TOTAL SHEETS	SHEET NO.
74	(72-7)R-3	PEORIA	1360	1147
STA.	TO STA.			
	175			
FED. ROAD DIST. NO.	ILLINOIS FED. AID PROJECT			

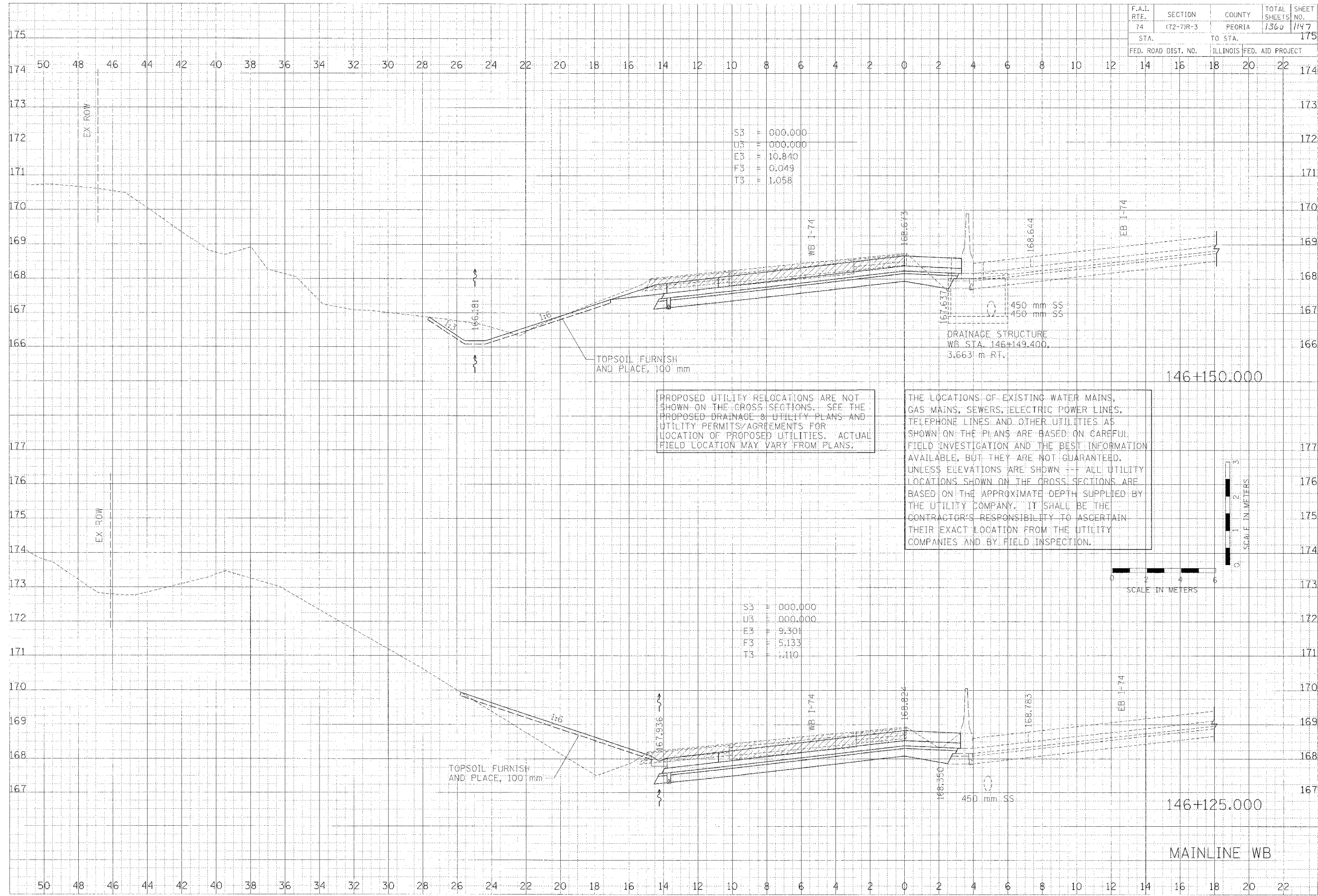

S3 = 000.000
 U3 = 000.000
 E3 = 10.840
 F3 = 0.049
 T3 = 1.058

S3 = 000.000
 U3 = 000.000
 E3 = 9.301
 F3 = 5.133
 T3 = .110

PROPOSED UTILITY RELOCATIONS ARE NOT SHOWN ON THE CROSS SECTIONS. SEE THE PROPOSED DRAINAGE & UTILITY PLANS AND UTILITY PERMITS/AGREEMENTS FOR LOCATION OF PROPOSED UTILITIES. ACTUAL FIELD LOCATION MAY VARY FROM PLANS.

THE LOCATIONS OF EXISTING WATER MAINS, GAS MAINS, SEWERS, ELECTRIC POWER LINES, TELEPHONE LINES, AND OTHER UTILITIES AS SHOWN ON THE PLANS ARE BASED ON CAREFUL FIELD INVESTIGATION AND THE BEST INFORMATION AVAILABLE, BUT THEY ARE NOT GUARANTEED. UNLESS ELEVATIONS ARE SHOWN, ALL UTILITY LOCATIONS SHOWN ON THE CROSS SECTIONS ARE BASED ON THE APPROXIMATE DEPTH SUPPLIED BY THE UTILITY COMPANY. IT SHALL BE THE CONTRACTOR'S RESPONSIBILITY TO ASCERTAIN THEIR EXACT LOCATION FROM THE UTILITY COMPANIES AND BY FIELD INSPECTION.

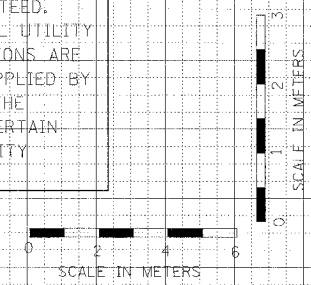

DATE	BY	CHKD
FINN SURVEYED		
LARRY		
NOTE: BRIDGE TEMPLATE		
AREAS		
UNRECORDED		



DATE	BY	CHKD
DESIGNED		
SURVEY		
WITH FIELD		
AREAS		
CHECKED		