

1101-5a-pre1a983-over11.09 4/29/2005 10:42:09 AM

**PRE-STAGE 3** (THESE ITEMS ARE TO BEGIN DURING PRE-STAGE 3, DURATION FROM SEPT. 2005 - NOV 2005;  
**CONSTRUCTION:** REMAINING ITEMS TO BEGIN AFTER WINTER SHUTDOWN IF THEY IMPACT TRAFFIC OPERATIONS

- ① INSTALL TEMPORARY CONCRETE MEDIAN BARRIER FROM STATION 152+272.20 TO STATION 152+445.837 PRIOR TO WINTER SHUTDOWN
- ② CONSTRUCT RETAINING WALL 82 (MUST BE COMPLETED PRIOR TO INITIATION OF STAGE 3A)
- ③ CONSTRUCT RAMP K-2 PIERS
- ④ REMOVE EXISTING MEDIAN AND REPLACE WITH TEMPORARY PAVEMENT
- ⑤ CONSTRUCT CRASH INVESTIGATION SITE (CIS-174-09A) (MUST BE COMPLETED PRIOR TO INITIATION OF STAGE 3A)
- ⑥ REMOVE EXISTING SHOULDERS AND PLACE TEMPORARY PAVEMENT
- ⑦ COMPLETE TEMPORARY TRAFFIC SIGNALS AT NORTH MAIN STREET AND BLACKJACK BOULEVARD AND PROPOSED ISLAND. PROPOSED SIGNALS TO BE CONSTRUCTED
- ⑧ REMOVE AND REPLACE SHOULDERS FROM STATION 4+157 TO 4+264 PRIOR TO MEDIAN CONSTRUCTION
- ⑨ RECONSTRUCT NORTH MAIN STREET MEDIAN FROM STATION 4+013 TO 4+157
- ⑩ CONSTRUCT STORM SEWER CROSSINGS AT STATION 3+655 AND 3+925

**TRAFFIC:**

1. ALL I-74 EASTBOUND AND WESTBOUND LANES WILL BE OPEN TO TRAFFIC ONCE TEMPORARY CONCRETE BARRIER IS PLACED
2. ALL EASTBOUND RAMP AT NORTH MAIN AND CAMP STREETS SHALL BE OPEN DURING PRE-STAGE 3
3. FOR PLACEMENT OF TEMPORARY CONCRETE BARRIER, USE STANDARD 701421
4. FOR REMOVAL AND REPLACEMENT OF SHOULDERS ALONG NORTH MAIN STREET USE STANDARD 701606
5. FOR RECONSTRUCTION OF MEDIAN ALONG NORTH MAIN STREET USE STANDARD 701602
- ① 6. ALL WESTBOUND I-74 RAMP AT N. MAIN ST. AND CAMP ST. SHALL BE KEPT OPEN DURING PRE-STAGE WITH THE EXCEPTION OF THE LIMITED RAMP 20 CLOSURE TO CONSTRUCT THE TEMPORARY CIS.

**GENERAL NOTES:**

SEE SIGNING PLAN FOR STAGED REMOVAL OF EXISTING SIGNS AND STAGED PLACEMENT OF PROPOSED INFORMATION AND GUIDE SIGNS.

THE STAGED CONSTRUCTION SHOWN HERE IS A GENERAL SEQUENCING SUGGESTION.

SEE PLAN SET 2 OF 4 FOR MAINTENANCE OF TRAFFIC FOR WASHINGTON STREET, RAMP L-3, AND L-4.

F.A.I. RTE.	SECTION	COUNTY	TOTAL SHEETS	SHEET NO.
74	(90-11)R-2; 90(13,14,14-1)R-1	TAZEWELL	1366	123
STA. 152+445.837 TO STA. 153+892.180				
FED. ROAD DIST. NO. 4 ILLINOIS FED. AID PROJECT				

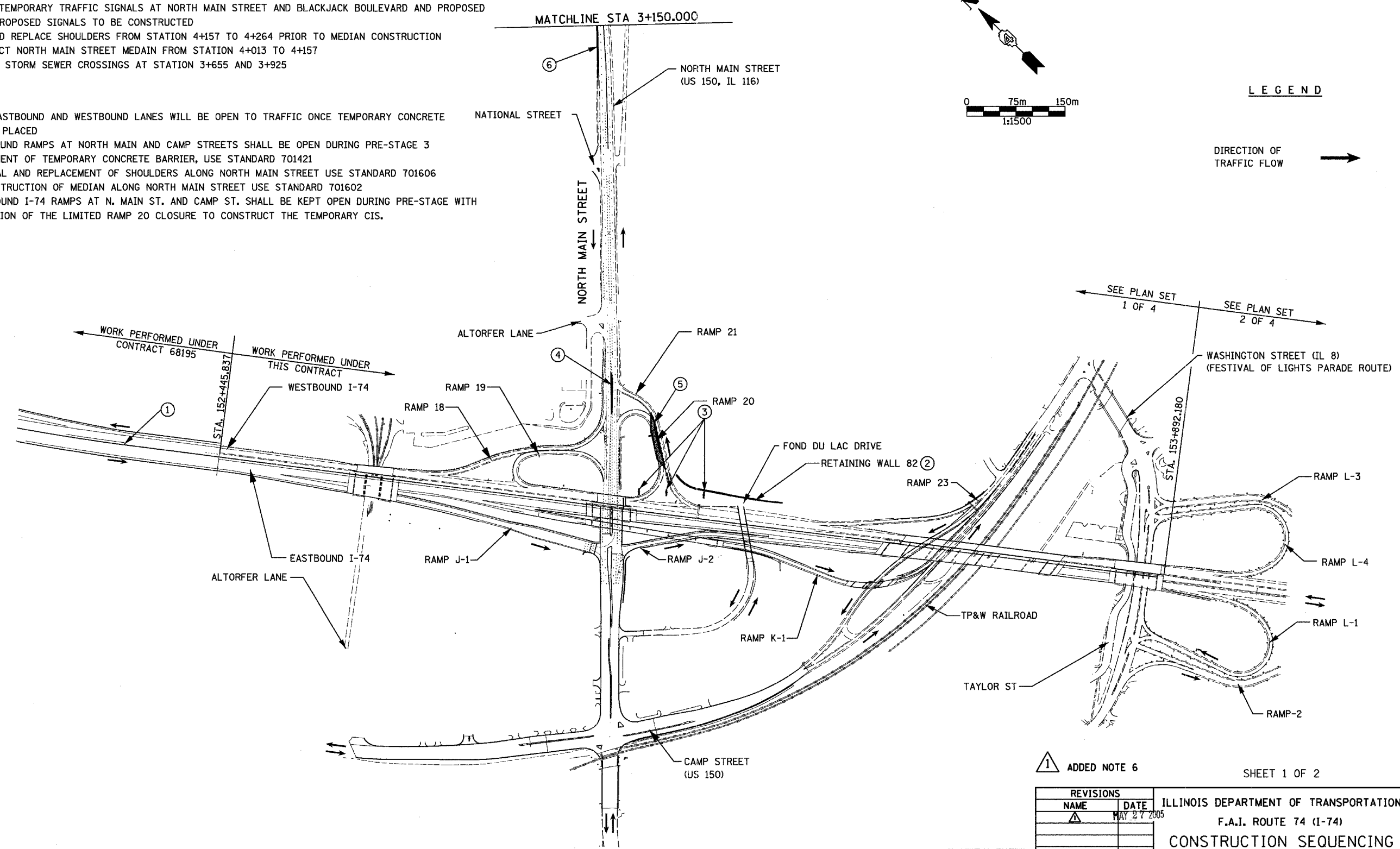

① ADDED NOTE 6

SHEET 1 OF 2

REVISIONS	
NAME	DATE
①	MAY 27 2005

ILLINOIS DEPARTMENT OF TRANSPORTATION  
 F.A.I. ROUTE 74 (I-74)  
**CONSTRUCTION SEQUENCING**  
 STAGE 3A-1 (PRE-STAGE 3)

DATE 12/20/2004  
 DRAWN BY KMO  
 CHECKED BY RTG

