

...:\p1\1101101-5am-1a.dgn 5/27/2005 12:17:24 PM

F.A.I. RTE.	SECTION	COUNTY	TOTAL SHEETS	SHEET NO.
74	*	TAZEWELL	136	154
STA.		TO STA.		
FED. ROAD DIST. NO.		ILLINOIS FED. AID PROJECT		

*(90-1)R-2;90(13,14,14-1)R-1

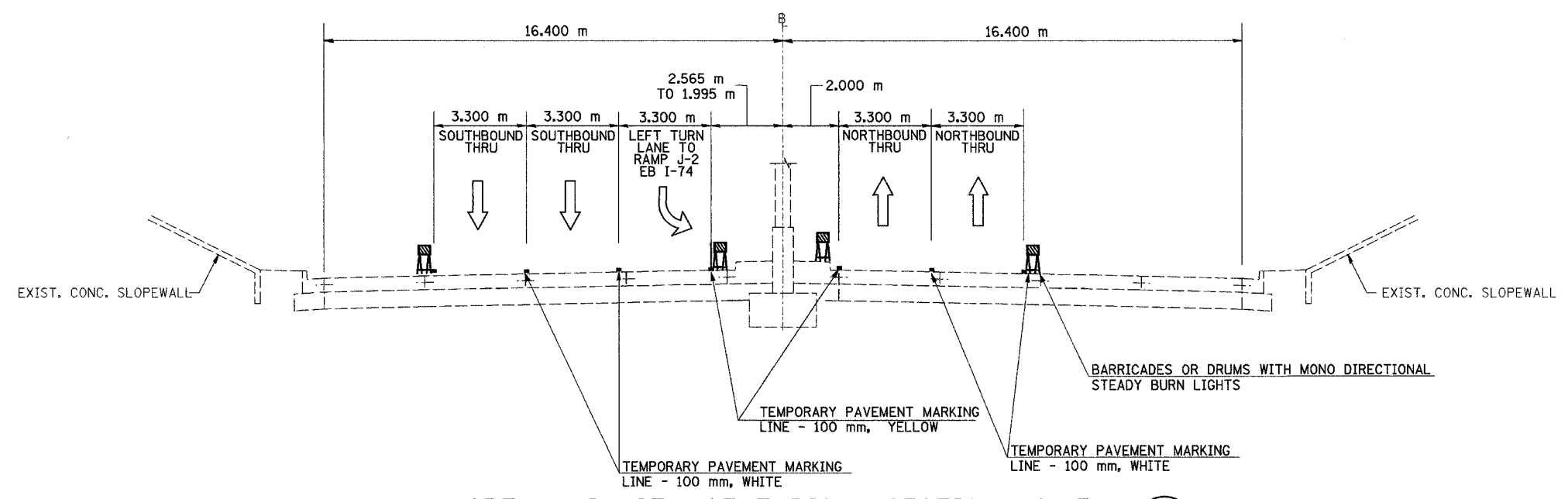

NORTH MAIN ST MOT TYPICAL SECTION NO. 5A (5A)
 STA. 2+402.933 TO STA. 2+412.933

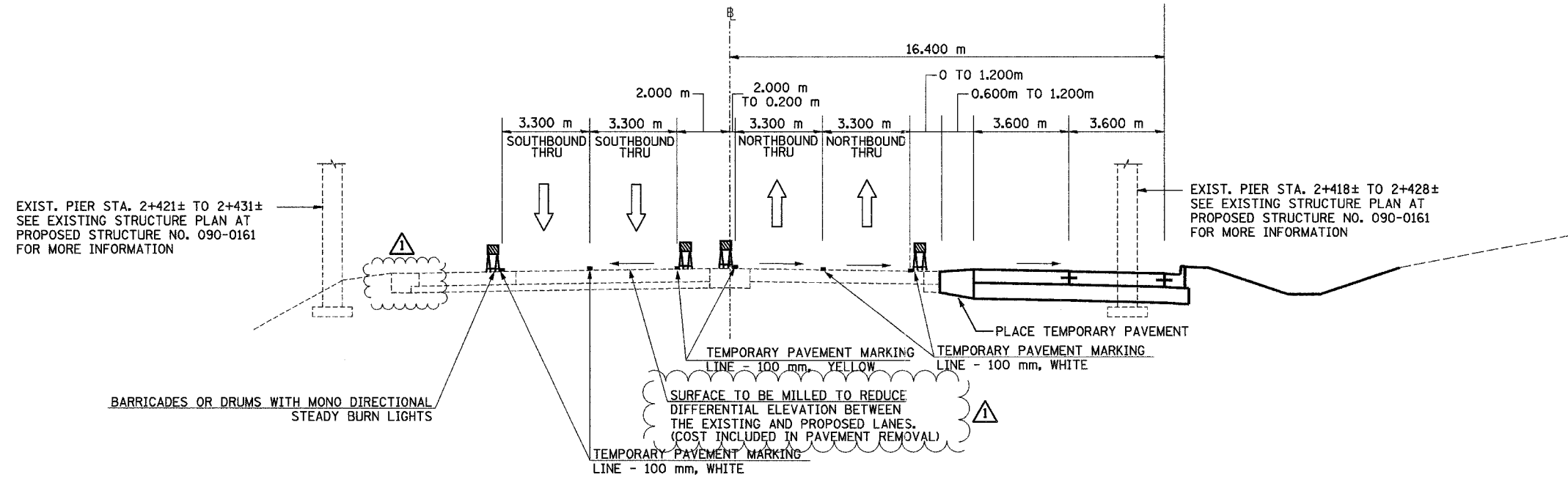

NORTH MAIN ST MOT TYPICAL SECTION NO. 6A (6A)
 STA. 2+412.933 TO STA. 2+579.299

- ▲ -ADDED TEMPORARY PAVEMENT FROM PREVIOUS CONTRACT
- ▲ -ADDED NOTE TO SURFACE MILLING

REVISIONS	
NAME	DATE
▲	MAY 27 2005



ILLINOIS DEPARTMENT OF TRANSPORTATION
 FAI ROUTE 74 (I-74)
 MAINTENANCE OF TRAFFIC
 STAGE 3A-2
 ILL. 116-U.S. 150-NORTH MAIN ST.
 TYPICAL SECTIONS 5A & 6A
 DATE: 12/20/2004
 DRAWN BY: MRF
 CHECKED BY: RTG