

12/20/2004 11:04:50 AM 12/20/2004 11:04:50 AM

| F.A.I. RTE. | SECTION | COUNTY | TOTAL SHEETS | SHEET NO. |
|---|------------------------------|---------------|--------------|-----------|
| 74 | (90-11R-2; 90(13,14,14-1R-1) | TAZEWELL | 1366 | 181 |
| STA. 2+600 | | TO STA. 3+200 | | |
| FED. ROAD DIST. NO. 4 ILLINOIS FED. AID PROJECT | | | | |

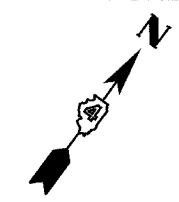
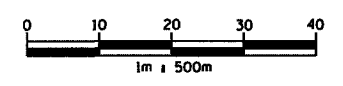

ALTORFER LANE STAGING

- STEP A**
REMOVE EXISTING CC&G ON NORTH SIDE OF EXISTING ALTORFER LANE BEYOND THE LIMITS OF THE NEW PAVEMENT APPROX 33M. CONSTRUCT THE PROPOSED PAVEMENT (A) TO THE LIMITS SHOWN ALONG ALTORFER LANE. DO NOT BUILD THE PROPOSED CC&G ALONG THE NORTH SIDE OF THIS NEW PAVEMENT.
- STEP B**
CONSTRUCT PROPOSED TEMPORARY WIDENING AS SHOWN AS (B) AND TIE INTO ALTORFER LANE USING A 33 M TAPER.
- STEP C**
CONSTRUCT PROPOSED PCC PAVEMENT SHOWN AS (C) WHILE TRAFFIC SPLITS THE AREA.
- STEP D**
CONSTRUCT SOUTHWEST QUADRANT WHILE TRAFFIC IS SHIFTED TO THE NORTH ON AREAS (B) AND (C)
- STEP E**
CONSTRUCTION OF (C) MUST BE COMPLETED OVER WEEKEND PERIOD, TRAFFIC SPLITS THE AREA.
- STEP F**
CONSTRUCT AREA (F) BEGINNING WITH THE NORTHERNMOST PANELS AND CONTINUING SOUTH.
- STEP G**
REMOVE THE TEMPORARY WIDENING AND INSTALL THE PROPOSED CC&G ALONG THE NORTH SIDE OF THE INTERSECTION AND ALTORFER LANE.

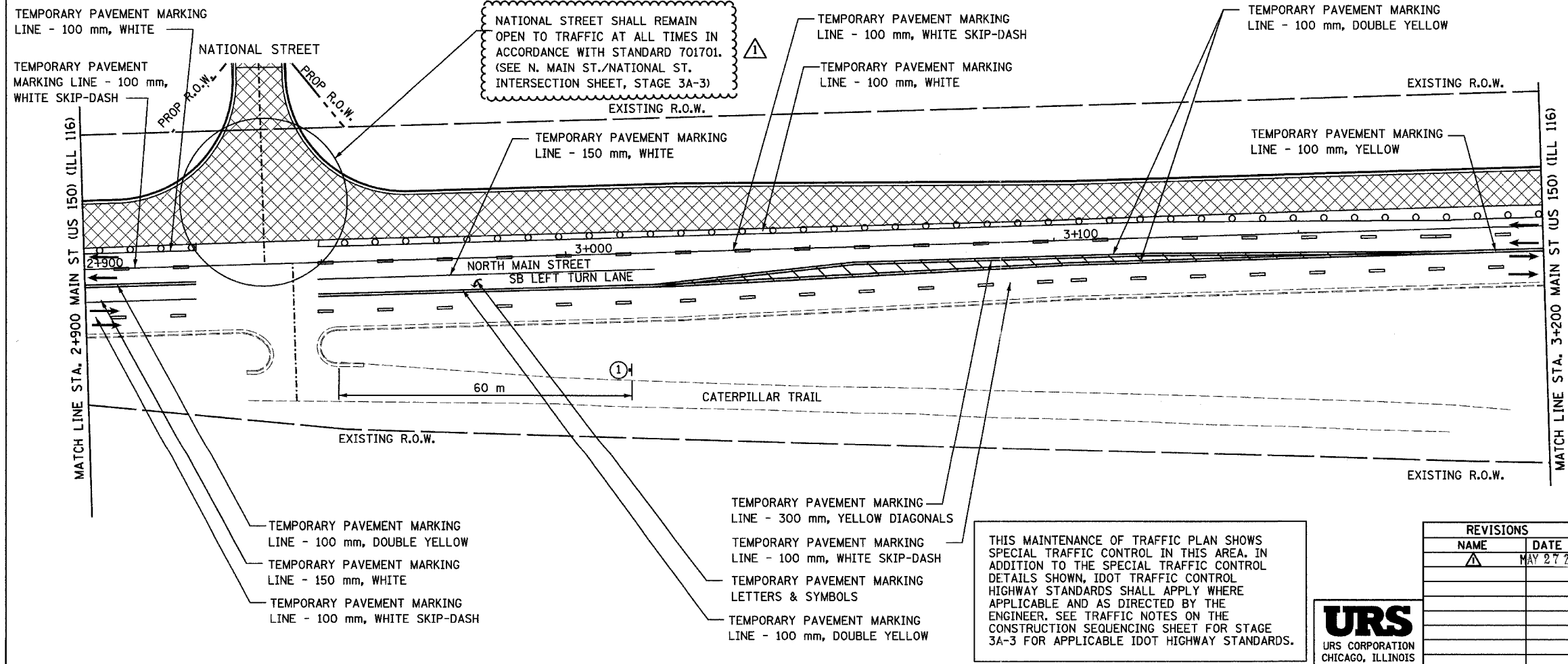
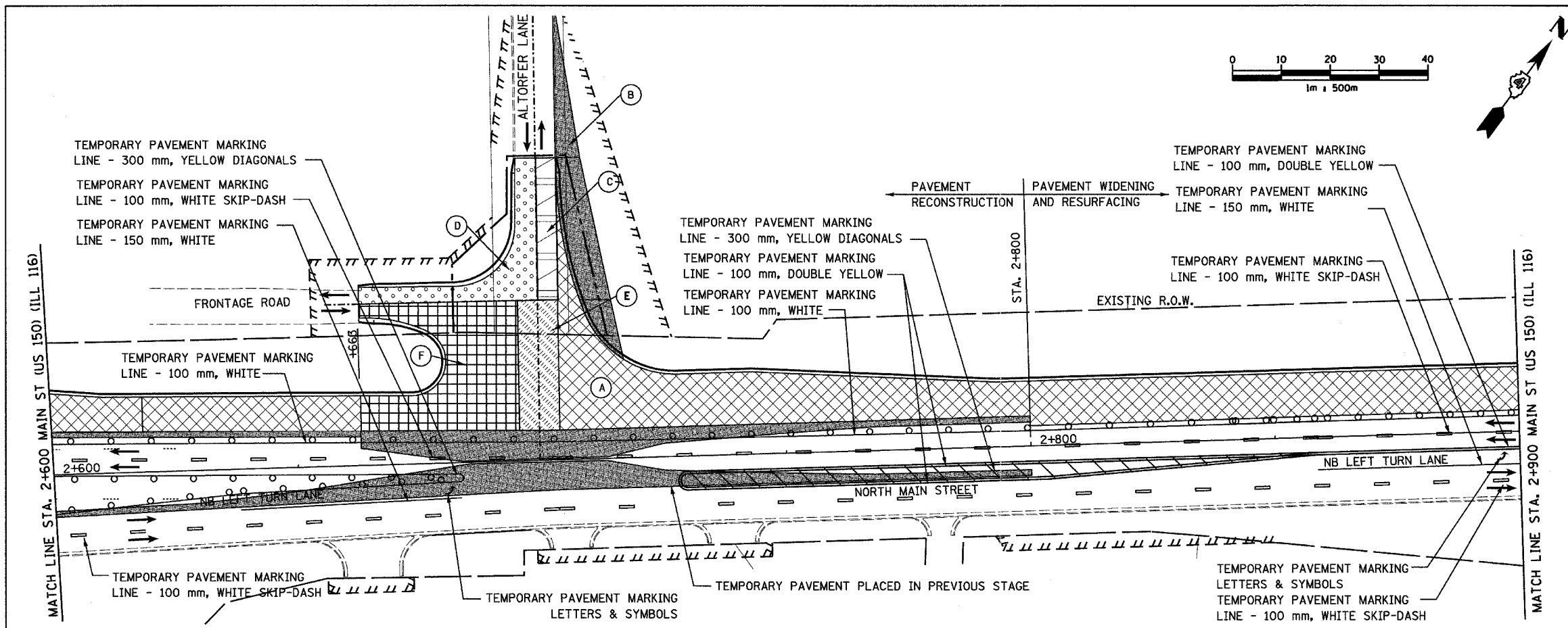

NATIONAL STREET SHALL REMAIN OPEN TO TRAFFIC AT ALL TIMES IN ACCORDANCE WITH STANDARD 701701. (SEE N. MAIN ST./NATIONAL ST. INTERSECTION SHEET, STAGE 3A-3)

THIS MAINTENANCE OF TRAFFIC PLAN SHOWS SPECIAL TRAFFIC CONTROL IN THIS AREA. IN ADDITION TO THE SPECIAL TRAFFIC CONTROL DETAILS SHOWN, IDOT TRAFFIC CONTROL HIGHWAY STANDARDS SHALL APPLY WHERE APPLICABLE AND AS DIRECTED BY THE ENGINEER. SEE TRAFFIC NOTES ON THE CONSTRUCTION SEQUENCING SHEET FOR STAGE 3A-3 FOR APPLICABLE IDOT HIGHWAY STANDARDS.

- NOTES:**
- 1 THE NORTH MAIN STREET/ALTORFER LANE INTERSECTION SHALL REMAIN OPEN AND ACCESSIBLE AT ALL TIMES. ADJUST TRAFFIC CONTROL ITEMS AS INTERSECTION STAGING WARRANTS.
 - 2 CONTRACTOR IS TO MAINTAIN ACCESS TO ALL ENTRANCES, DRIVEWAYS AND SIDE STREETS AT ALL TIMES BY USING LOCALIZED STAGED CONSTRUCTION OR BY OBTAINING CONSENT TO CLOSE AN ENTRANCE FROM THE OWNER SHOULD THERE BE MORE THAN ONE.

LEGEND

| | |
|--|--|
| | WORK ZONE |
| | TEMPORARY PAVEMENT |
| | TEMPORARY PAVEMENT MARKING |
| | TRAFFIC FLOW DIRECTION |
| | SIGN, SEE GENERAL NOTES AND LEGEND SHEET FOR SIGN TYPE |
| | DRUM WITH STEADY BURNING MONO-DIRECTIONAL LIGHT |

REVISIONS

| NAME | DATE |
|------|-------------|
| | MAY 27 2005 |
| | |
| | |
| | |

ILLINOIS DEPARTMENT OF TRANSPORTATION
 F.A.I. ROUTE 74 (I-74)
 MAINTENANCE OF TRAFFIC
 STAGE 3A-3
 NORTH MAIN STREET 2+600 TO 3+200
 DRAWN BY KMO
 DATE 12/20/2004
 CHECKED BY RTG



REVISED STAGING NOTE