

I:\projects\roadway\111102-5mra.dgn 4/28/2005 12:28:30 PM

F.A.I. RTE.	SECTION	COUNTY	TOTAL SHEETS	SHEET NO.
74	*	TAZEWELL	1366	312
STA.		TO STA.		
FED. ROAD DIST. NO.		ILLINOIS FED. AID PROJECT		

*190-10R-2;9013,14,14-10R-1

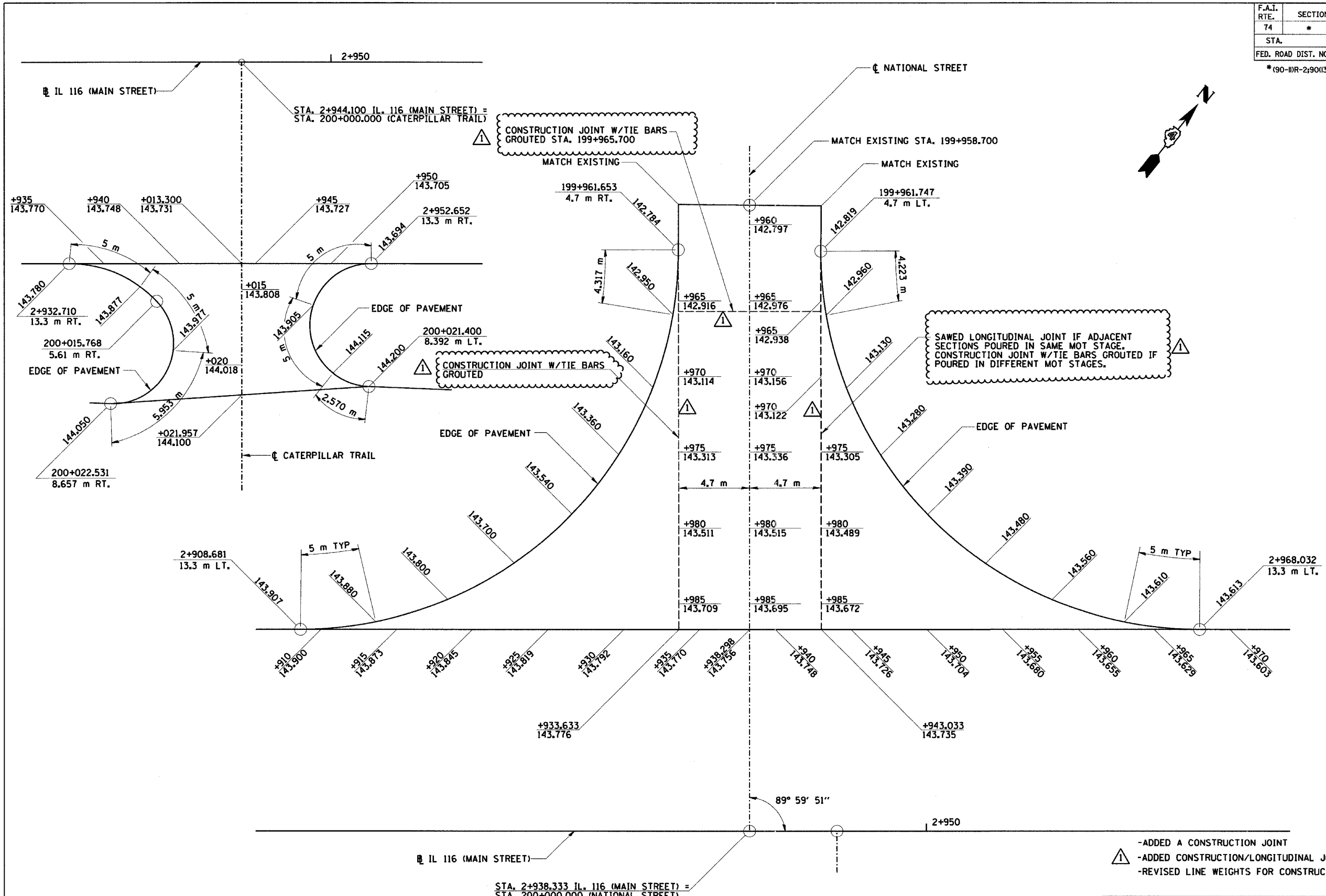

STA. 2+938.333 IL. 116 (MAIN STREET) =
STA. 200+000.000 (NATIONAL STREET)

PLAN VIEW
(SHOWING VERTICAL CONTROL)

- ADDED A CONSTRUCTION JOINT
- ADDED CONSTRUCTION/LONGITUDINAL JOINT CALLOUTS
- REVISED LINE WEIGHTS FOR CONSTRUCTION/LONGITUDINAL JOINTS

SHEET 8 OF 10

REVISIONS	
NAME	DATE
Δ	MAY 27 2005



ILLINOIS DEPARTMENT OF TRANSPORTATION
INTERSECTION DETAILS
NATIONAL STREET &
CATERPILLAR TRAIL
AT MAIN STREET

DRAWN BY SRS
CHECKED BY JJM

DATE 12-20-04