

F.A.I. RTE.	SECTION	COUNTY	TOTAL SHEETS	SHEET NO.
74	D4 BRIDGE REP.	TAZEWELL	24	9
STA. 18+04.50		TO STA. 22+42.00		
FED. ROAD DIST. NO. 4   ILLINOIS   FED. AID PROJECT				

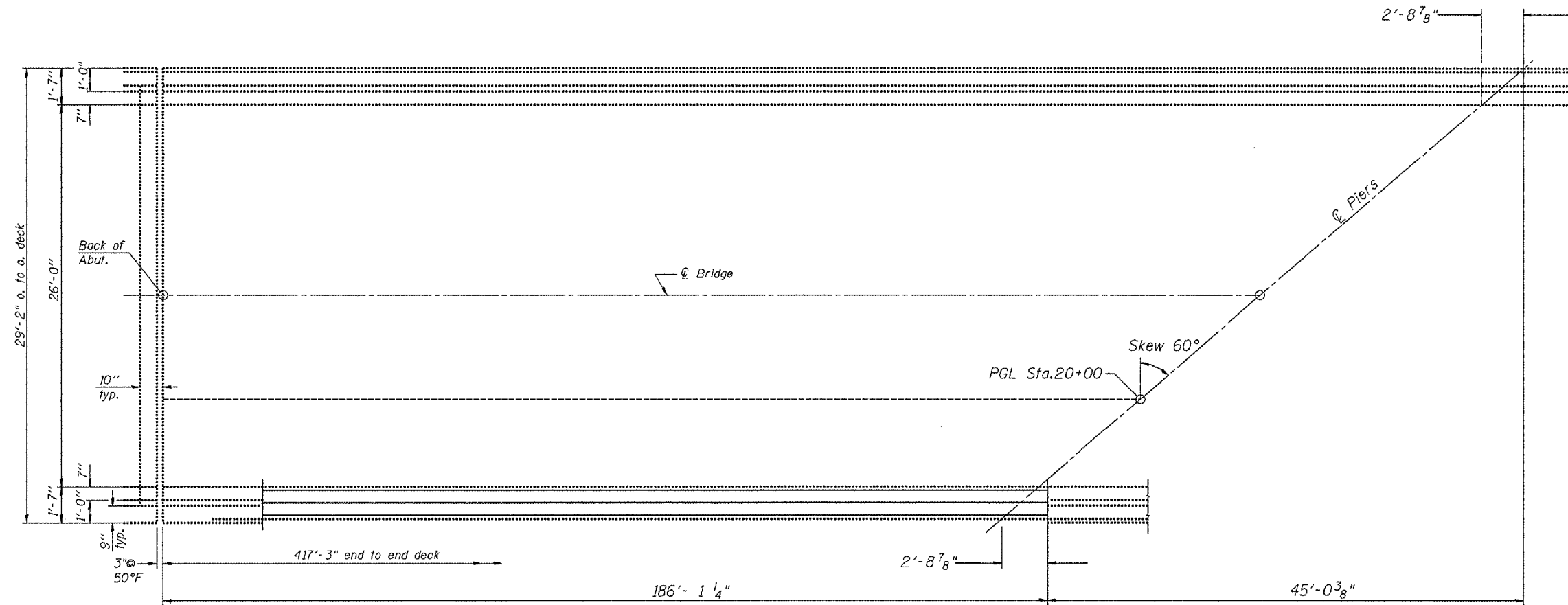

HALF-PLAN OF EXISTING DECK

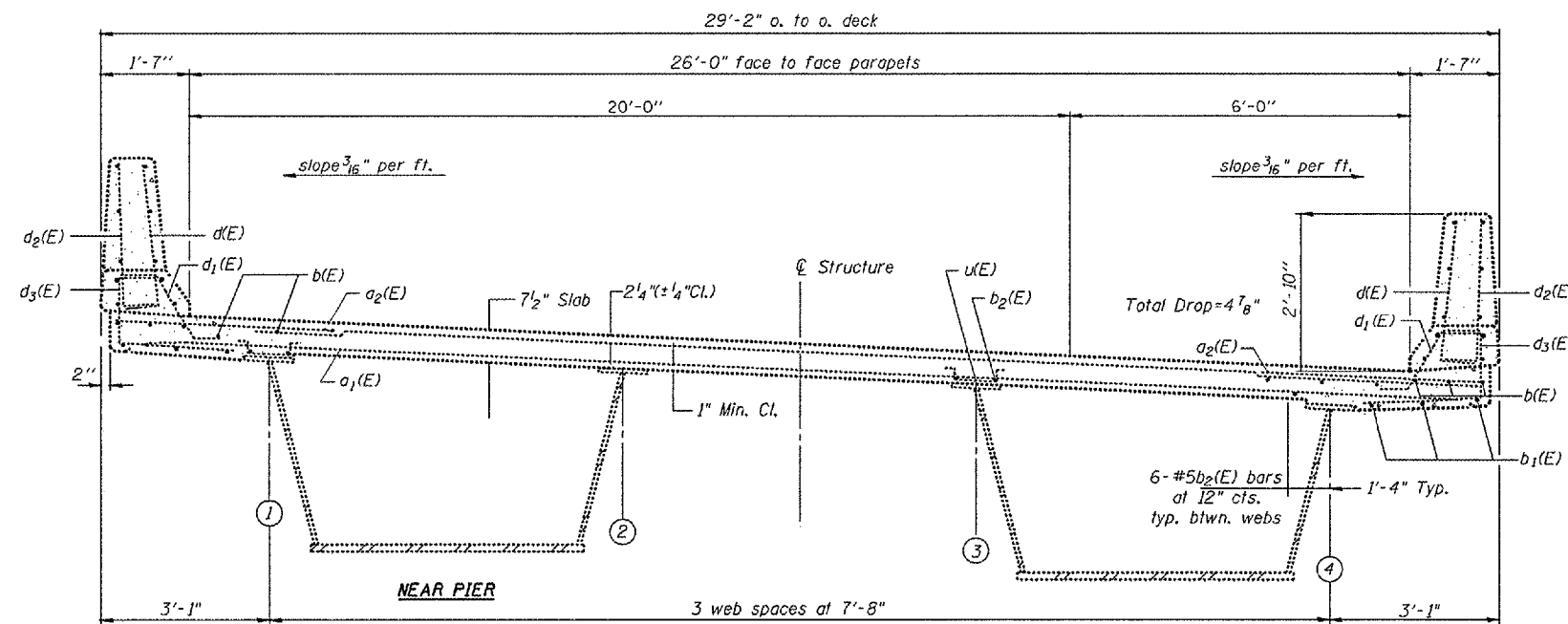

EXISTING CROSS SECTION  
(Looking Southwest)

S.N. 090-0131  
Main St.  
over I-155

REVISIONS	
NAME	DATE

ILLINOIS DEPARTMENT OF TRANSPORTATION

SUPERSTRUCTURE

SCALE: VERT.  
HORIZ.  
DATE 09-09-2004

DRAWN BY CEJ  
CHECKED BY

PLOT DATE \* DATE \*  
PLOT SCALE \* SCALE \*  
REFERENCE \* REF \*