

F.A. RTE.	SECTION	COUNTY	TOTAL SHEETS
			79 42
STA. _____		TO STA. _____	
FED. ROAD DIST. NO. _____		ILLINOIS FED. AID PROJECT	

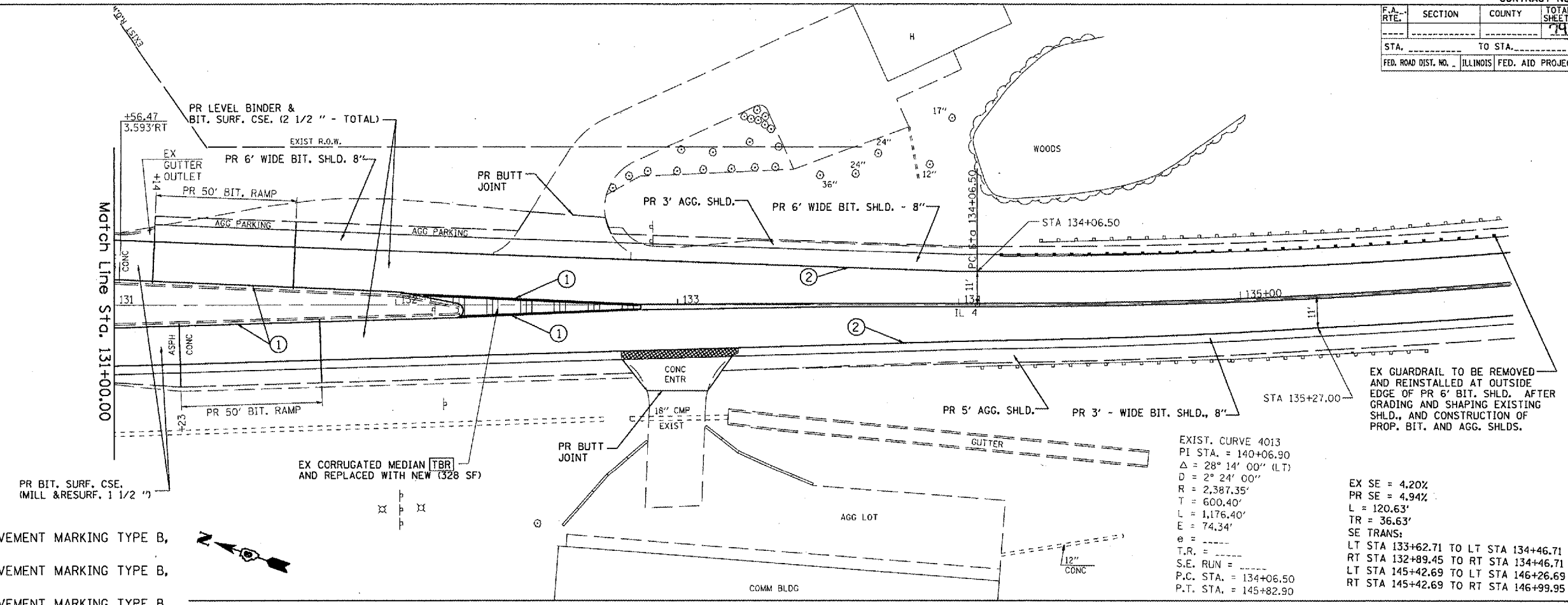

PAVEMENT MARKING

- ① PR PREFORMED PLASTIC PAVEMENT MARKING TYPE B, LINE 5", SOLID YELLOW
- ② PR PREFORMED PLASTIC PAVEMENT MARKING TYPE B, LINE 5", SOLID WHITE
- ③ PR PREFORMED PLASTIC PAVEMENT MARKING TYPE B, LINE 5", SOLID WHITE DIAGONALS AT 5' CTS
- ④ PR PREFORMED PLASTIC PAVEMENT MARKING TYPE B, LINE 6", SOLID WHITE
- ⑤ PR PREFORMED PLASTIC PAVEMENT MARKING TYPE B, LINE 8", SOLID WHITE
- ⑥ PR PREFORMED PLASTIC PAVEMENT MARKING TYPE B, LINE 12", SOLID WHITE DIAGONALS AT 20' CTS
- ⑦ PR PREFORMED PLASTIC PAVEMENT MARKING TYPE B, LINE 24", SOLID WHITE

NOTE: SEE ALIGNMENT DIAGRAM FOR LAYOUT & SE RATES SOUTH OF STA 136+00.00 PLAN & PROFILE SHEET NOT AVAILABLE, EXCEPT AT STA 438+00.00 TO STA 456+00.00 (HONEY CREEK BRIDGE)

EXIST. CURVE 4013
 PI STA. = 140+06.90
 $\Delta = 28^\circ 14' 00''$ (LT)
 $D = 2^\circ 24' 00''$
 $R = 2,387.35'$
 $T = 600.40'$
 $L = 1,176.40'$
 $E = 74.34'$
 $e = \text{---}$
 $T.R. = \text{---}$
 $S.E. RUN = \text{---}$
 $P.C. STA. = 134+06.50$
 $P.T. STA. = 145+82.90$

EX SE = 4.20%
 PR SE = 4.94%
 $L = 120.63'$
 $TR = 36.63'$
 SE TRANS:
 LT STA 133+62.71 TO LT STA 134+46.71
 RT STA 132+89.45 TO RT STA 134+46.71
 LT STA 145+42.69 TO LT STA 146+26.69
 RT STA 145+42.69 TO RT STA 146+99.95