

F.A.P. RTE.	SECTION	COUNTY	TOTAL SHEETS	SHEET NO.
325	*	MONTGOMERY	39	14
STA. 4+000		TO STA. 4+175		
FED. ROAD DIST. NO.		ILLINOIS FED. AID PROJECT		

• 21RS-4; 24RS-7  
CONTRACT NO. 72444

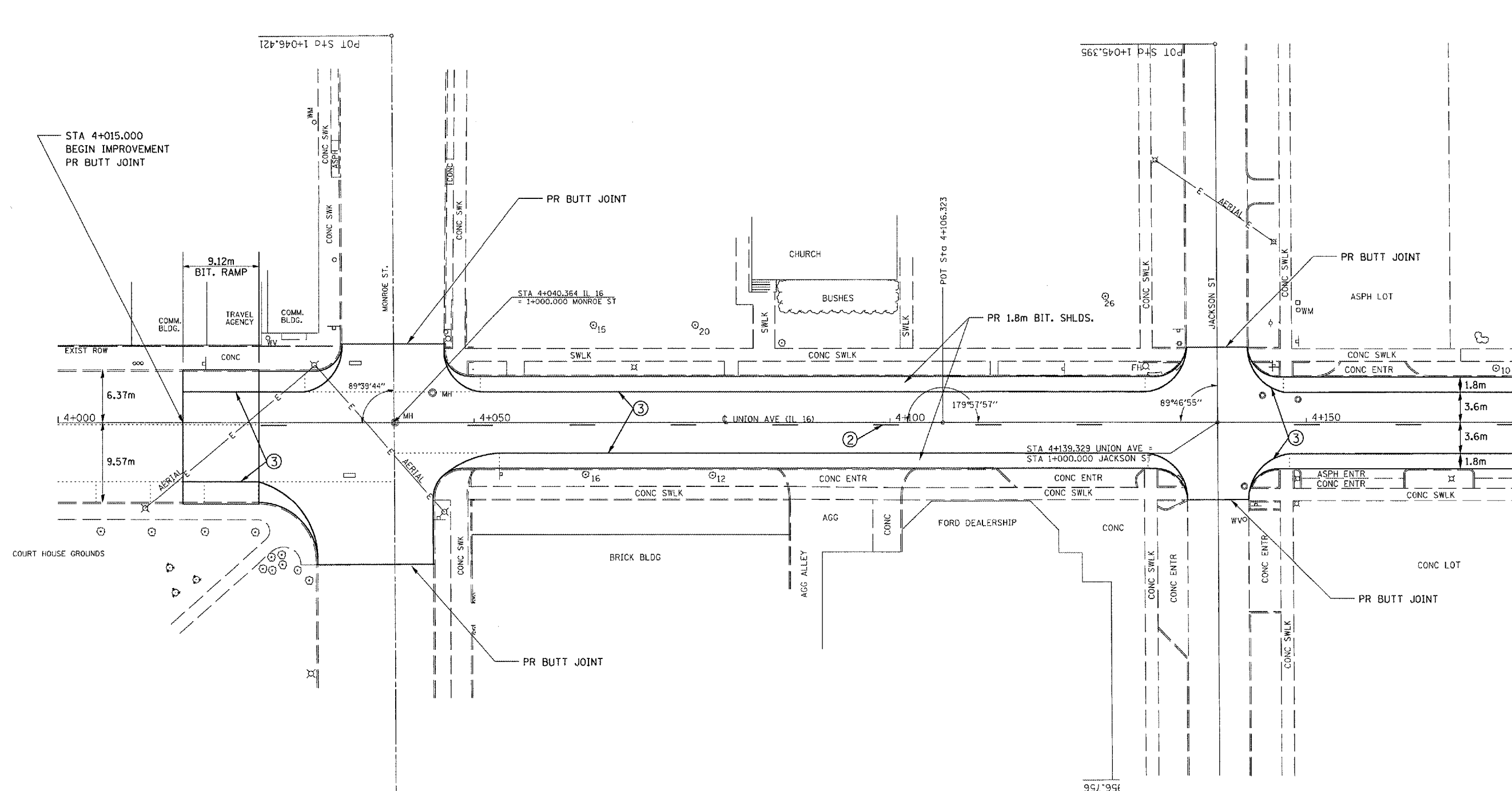

MATCHLINE STA. 4+175

**LEGEND**

- ① PR THERMOPLASTIC PAVEMENT MARKING, LINE - 125mm (SOLID YELLOW)
- ② PR THERMOPLASTIC PAVEMENT MARKING, LINE - 125mm (SKIP-DASH YELLOW)
- ③ PR THERMOPLASTIC PAVEMENT MARKING, LINE - 125mm (SOLID WHITE)
- ④ PR THERMOPLASTIC PAVEMENT MARKING, LINE - 150mm (SOLID WHITE)
- ⑤ PR PREFORMED PLASTIC PAVEMENT MARKING, LINE - 300mm (SOLID YELLOW)
- ⑥ PR PREFORMED PLASTIC PAVEMENT MARKING, LINE - 600mm (SOLID WHITE)
- ⑦ PR PREFORMED PLASTIC PAVEMENT MARKING, LETTERS & SYMBOLS (WHITE)

REVISIONS	
NAME	DATE

ILLINOIS DEPARTMENT OF TRANSPORTATION  
**PLAN SHEETS**  
**SECTION : 21RS-4; 24RS-7**  
**MONTGOMERY COUNTY**  
DRAWN BY  
CHECKED BY  
DATE