

F.A.P. RTE.	SECTION	COUNTY	TOTAL SHEETS	SHEET NO.
325		MONTGOMERY	39	33
STA. 7+325		TO STA.		
FED. ROAD DIST. NO.	ILLINOIS	FED. AID PROJECT		

• 21RS-4; 24RS-7
CONTRACT NO. 72444

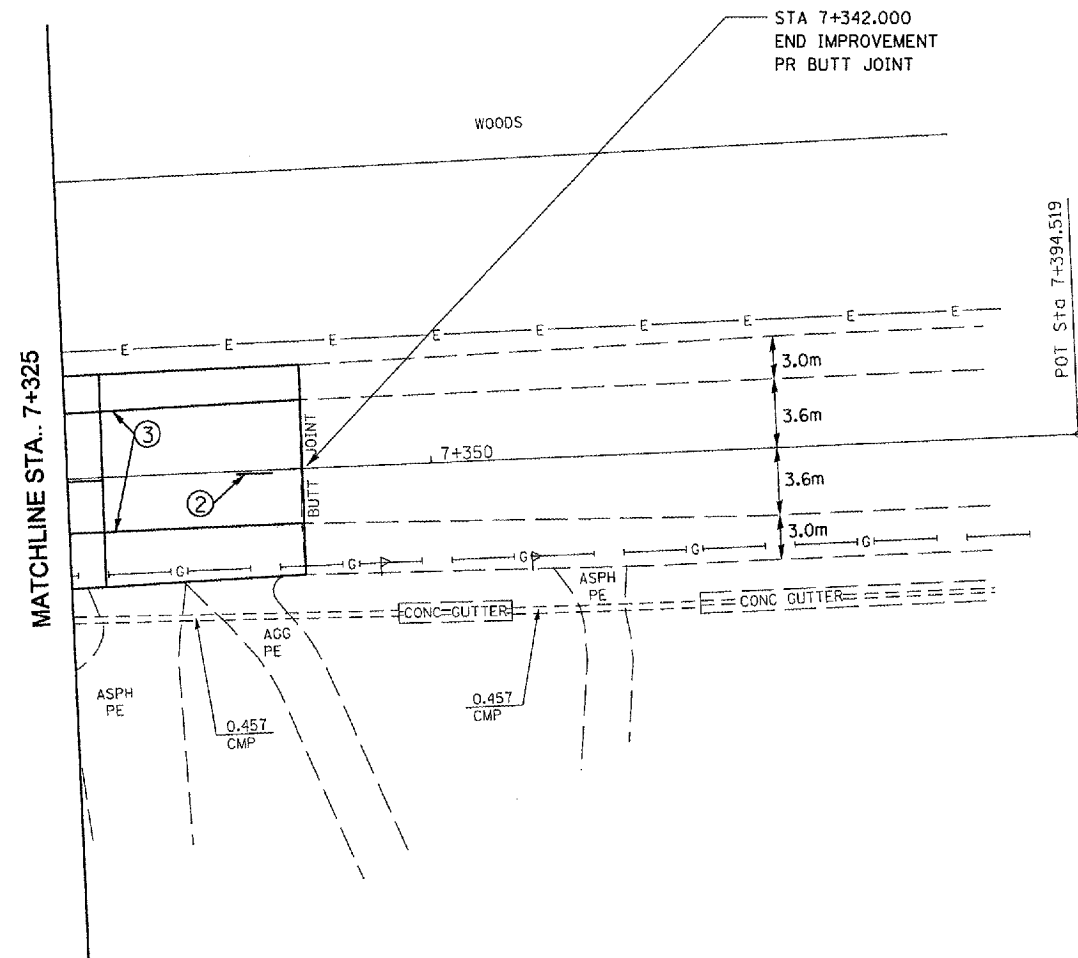

LEGEND

- ① PR THERMOPLASTIC PAVEMENT MARKING, LINE - 125mm (SOLID YELLOW)
- ② PR THERMOPLASTIC PAVEMENT MARKING, LINE - 125mm (SKIP-DASH YELLOW)
- ③ PR THERMOPLASTIC PAVEMENT MARKING, LINE - 125mm (SOLID WHITE)
- ④ PR THERMOPLASTIC PAVEMENT MARKING, LINE - 150mm (SOLID WHITE)
- ⑤ PR PREFORMED PLASTIC PAVEMENT MARKING, LINE - 300mm (SOLID YELLOW)
- ⑥ PR PREFORMED PLASTIC PAVEMENT MARKING, LINE - 600mm (SOLID WHITE)
- ⑦ PR PREFORMED PLACTIC PAVEMENT MARKING, LETTERS & SYMBOLS (WHITE)

REVISIONS	
NAME	DATE

ILLINOIS DEPARTMENT OF TRANSPORTATION
PLAN SHEETS
SECTION : 21RS-4; 24RS-7
MONTGOMERY COUNTY
DRAWN BY _____
CHECKED BY _____
DATE _____